

**Certification and Approval**

Certification Code  
 Certification number  
 Certification standard  
 Protection

EEx de II 2 GD IIC T5  
 SIR A 00 ATEX 1047  
 EN 60079-0, 1, 7  
 IP 66



CABLE JOINTS, CABLE TERMINATIONS, CABLE GLANDS, CABLE CLEATS  
 FEEDER PILLARS, FUSE LINKS, ARC FLASH, CABLE ROLLERS, CUT-OUTS  
 11KV 33KV CABLE JOINTS & CABLE TERMINATIONS  
 FURSE EARTHING  
 www.cableprints.co.uk  
 Thorne and Derrick UK  
 Tel 0044 191 490 1547 Fax 0044 191 477 5371  
 Tel 0044 117 977 4647 Fax 0044 117 977 5582

**Features Options**

Up to 100,000 hours life expectancy  
 Optional internal and/or external Reflector  
 Immediate ignition and re-ignition  
 Fixed or directional mounting options  
 Integral EEx e Terminal chamber

Sealed and flying lead fitted  
 Optional internal /external Reflector  
 Coloured glass option  
 Fixed or directional mounting options

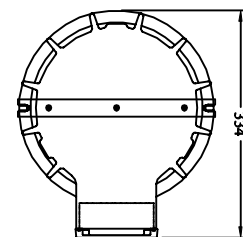
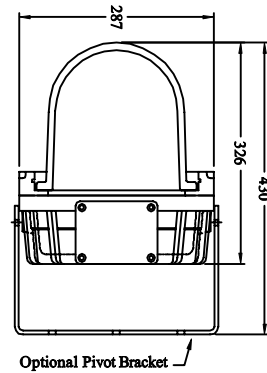

Terminal Block Access

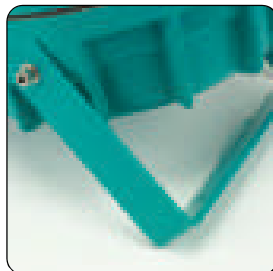

Swivel Stirrup mounting



Threaded flame path

## Technical Data

Supply Voltage	220-240v, 50/60Hz
Operating Temperature	-25°C to +40 °C
Control Gear	High frequency generator driving induction lamp within the luminaire
Lamp Options	55w or 85w induction lamp
Cable Entries	2 x M20 – ISO (1 plugged) as Standard Other threads available.
Terminals	4 (4mm) wire and earth with looping facility Cable crimping required at installation when looping
Mounting Facility	Back mounted fixing strap
Access	Terminals accessed via terminal cover retained by cap screws Lamp and gear accessed via removable glass dome
Material	Corrosion resistant marine grade aluminium body and bezel Toughened Borosilicate glass dome
Finish	2 Pack epoxy paint on primed surface. Standard colour - Aqua Additional costs for non standard colours
Accessories	Internal or external reflector Pivot bracket for directional control Pendant mount Wire Guard
Weight	15.0Kgs
Features	Ultra long life Flicker free start Low energy consumption Constant light independent of voltage fluctuations Automatic safety cut out in case of lamp failure

**Certification and Approval**

Certification Code	EEx de II 2 GD IIC T3 and 4 (See lamp tables for T rating)
Certification number	SIRA 00 ATEX 1048
Certification standard	EN 60079-0, 1,7
Protection	IP 66

**Features Options**

- |  |  |
|--|--|
| <ul style="list-style-type: none"> <li>Rotating Beacon</li> <li>Xenon flashing unit</li> <li>IIC as standard</li> <li>Heavy Duty construction</li> <li>Integral EEx e terminal chamber</li> <li>FOR AMBIENT TEMPERATURE "T" RATINGS SEE TABLES AT REAR OF CATALOGUE</li> </ul> | <ul style="list-style-type: none"> <li>Range of fresnel colours or glass colouring</li> <li>Long Life LED options</li> <li>Range of warning and flash options</li> <li>High ambient version</li> </ul> |
|--|--|

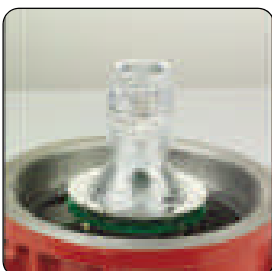
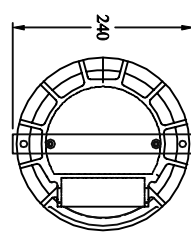
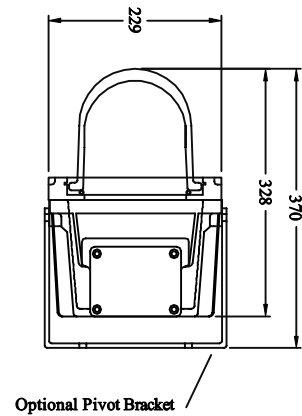

Xenon Flash with Fresnel



LED cluster

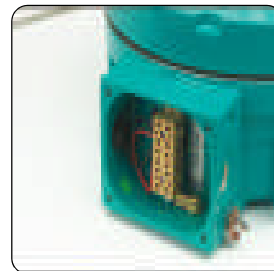

Terminal block housing

## Technical Data

Supply Voltage	Beacons 240v Warning Lights AC – 24 to 277 50/60Hz DC also
Operating Temperature	-45°C to +70 °C
Control Gear (when Fitted)	Electronic flasher unit Rotating Reflector drive
Lamp Options	Beacons: 150w GLS max (ES, E27 or BC) 25w SL (ES, E27 or BC), 20w PLCE Rotating 55w of 70w (supplied)
Cable Entries	2 x M20 – ISO (1 plugged) as Standard Other threads available.
Terminals	4 (4mm) wire and earth with looping facility Cable crimping required at installation when looping
Mounting Facility	Back mounted fixing strap
Access	Terminals accessed via terminal cover retained by cap screws Lamp and gear accessed via removable glass dome
Material	Corrosion resistant marine grade aluminium body and bezel Toughened Borosilicate glass dome
Finish	2 Pack epoxy paint on primed surface. Standard colour - Aqua Additional costs for non standard colours
Accessories	Internal or external reflector Pivot bracket for directional control Pendant mount Wire Guard Glass colouring available
Weight	9.0Kgs
Features	Flashing Xenon – Output 195,000CD peak OR Rotating Reflector beacon. 70°C ambient option available IIC as standard Heavy Duty Construction

**Certification and Approval**

Certification Code	EEx de II 2 GD IIC T3 and 4 (See lamp tables for T rating)
Certification number	SIRA 00 ATEX I 048
Certification standard	EN 60079-0, I, 7
Protection	IP 66

**Features Options**

Range of lamp sources available  
 IIC as standard  
 Heavy duty construction  
 Integral EEx e Terminal chamber

Range of lamp sources  
 Low and high temperature versions  
 Internal and external reflectors  
 Coloured glass range

FOR AMBIENT TEMPERATURE "T" RATINGS SEE TABLES AT REAR OF CATALOGUE

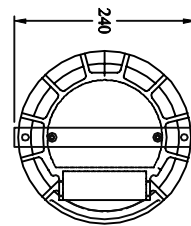
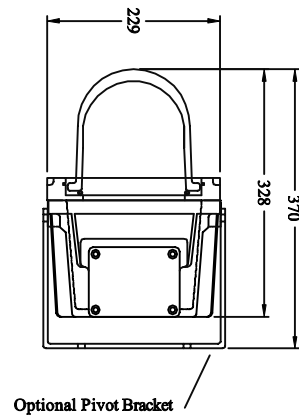

610 Threaded flame path

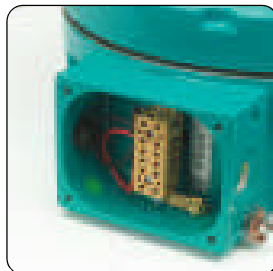

Terminal block access



610 blue lens

## Technical Data

Supply Voltage	240v 50Hz Check for alternative voltages
Operating Temperature	-45°C to +70 °C
Control Gear (when Fitted)	Ballast, ignitor and capacitor can be fitted within the luminaire
Lamp Options	Certified with elliptical lamps (Lamps not provided) 50w, 70w, 110w SON-E and 70w SON-R 50w, 80w ,125w HPMV/MBF 25w SL or 20w PLCE 150w GLS with ES (E27) lamp holder. BC holder also available
Cable Entries	2 x M20 – ISO (1 plugged) as Standard Other threads available.
Terminals	4 (4mm) wire and earth with looping facility Cable crimping required at installation when looping
Mounting Facility	Back mounted fixing strap
Access	Terminals accessed via terminal cover retained by cap screws Lamp and gear accessed via removable glass dome
Material	Corrosion resistant marine grade aluminium body and bezel Toughened Borosilicate glass dome
Finish	2 Pack epoxy paint on primed surface. Standard colour - Aqua Additional costs for non standard colours
Accessories	Internal or external reflector Pivot bracket for directional control Pendant mount Wire Guard
Weight	9kg to 12kgs lamp dependant
Features	70°C ambient option available IIC as standard Heavy duty construction

**Certification and Approval**

Certification Code	EEx de II 2 GD IIC T2 – T6 (See lamp tables for T rating)
Certification number	SIRA 00 ATEX I047
Certification standard	EN 60079-0, I, 7
Protection	IP 66

**Features Options**

Large lamp option range  
 High Ambient options available  
 Rapid re lamping and gear access  
 Integral EEx e Terminal chamber

Large range of lamp options  
 Low and high temperature versions  
 Coloured glass range

FOR AMBIENT TEMPERATURE “T” RATINGS SEE TABLES AT REAR OF CATALOGUE

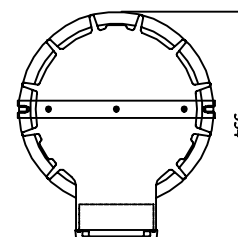
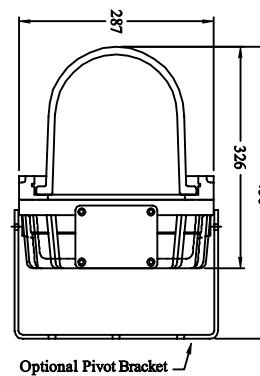

Terminal block access



620 External reflector



Swivel stirrup mounting

# Technical Data

Supply Voltage	240v 50Hz Check for alternative voltages
Operating Temperature	-20°C to +40 °C standard supply For operation at -45°C or up to 90°C consult sales office prior to ordering
Control Gear (when Fitted)	Ballast, ignitor and capacitor can be fitted within the luminaire
Lamp Options	Certified with elliptical lamps (Lamps not provided) 150w SON-E and 250w SON-I 125w and 250w HPMV/MBF Up to 300w GLS, 25w SL or 20w PLCE
Cable Entries	2 x M20 – ISO (1 plugged) as Standard Other threads available.
Terminals	4 (4mm) wire and earth with looping facility Cable crimping required at installation when looping
Mounting Facility	Back mounted fixing strap
Access	Terminals accessed via terminal cover retained by cap screw Lamp and gear accessed via removable glass dome
Material	Corrosion resistant marine grade aluminium body and bezel Toughened Borosilicate glass dome
Finish	2 Pack epoxy paint on primed surface. Standard colour - Aqua Additional costs for non standard colours
Accessories	Internal or external reflector Pivot bracket for directional control Pendant mount Wire Guard
Weight	12.5 to 16.0 kgs
Features	IIC as standard Heavy duty construction Glass colouring available High ambient temperature option available



**Certification and Approval**

Certification Code	EEx de II 2 GD IIC T3 – T6 (See lamp tables for T rating)
Certification number	SIRA 00 ATEX I047
Certification standard	EN 60079-0, I, 7
Protection	IP 66

**Features Options**

Shallow profile for confined space  
 IIC as standard  
 Integral EEx e Terminal chamber  
 Heavy duty construction

Shallow profile for confined spaces  
 Cow and high temperature versions  
 Extended lamp range  
 Coloured glass range

FOR AMBIENT TEMPERATURE “T” RATINGS SEE TABLES AT REAR OF CATALOGUE

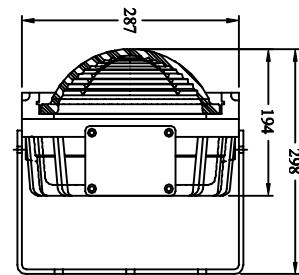

Optional Pivot Bracket

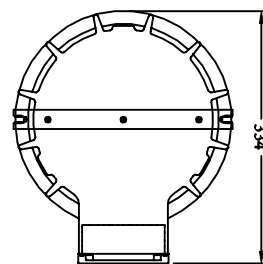

621 with wire guard

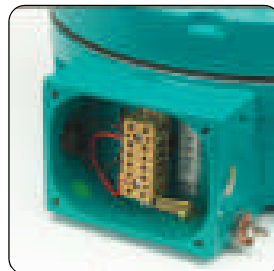

Terminal block access and local external earthing



Coloured glass option

## Technical Data

Supply Voltage	240v 50Hz Check for alternative voltages
Operating Temperature	-20°C to +40 °C standard supply For operation up to 90°C consult sales office prior to ordering
Control Gear (when Fitted)	Ballast, ignitor and capacitor all fitted within the luminaire
Lamp Options	Certified with elliptical lamps (Lamps not provided) 50w or 70w SON 50w, 80w or 125w HPMV/MBF Up to 200w GLS
Cable Entries	2 x M20 – ISO (1 plugged) as Standard Other threads available.
Terminals	4 (4mm) wire and earth with looping facility Cable crimping required at installation when looping
Mounting Facility	Back mounted fixing strap
Access	Terminals accessed via terminal cover retained by cap screw Lamp and gear accessed via removable glass dome
Material	Corrosion resistant marine grade aluminium body and bezel Toughened Borosilicate glass dome
Finish	2 Pack epoxy paint on primed surface. Standard colour - Aqua Additional costs for non standard colours
Accessories	Internal or external reflector Pivot bracket for directional control Pendant mount Wire Guard
Weight	12kgs to 14kgs lamp dependant
Features	IIC as standard Heavy duty construction Glass colouring available High ambient temperature option available

**Certification and Approval**

Certification Code EEx d II 2 G IIB or IIC T5 or T4 L (See lamp tables for T rating)  
 Certification number SIRA 01 ATEX I033  
 Certification standard EN 60079-0, I  
 Protection IP 66

**Features Options**

High Impact Resistant Polycarbonate lens  
 Anodised marine grade Aluminium  
 50,000 hr electronic ballast  
 EOL lamp protection  
 Vibration resistant  
 FOR AMBIENT TEMPERATURE "T" RATINGS SEE TABLES AT REAR OF CATALOGUE

Wide range of voltage options  
 Large range of lamp options  
 IP68 versions  
 Through wiring

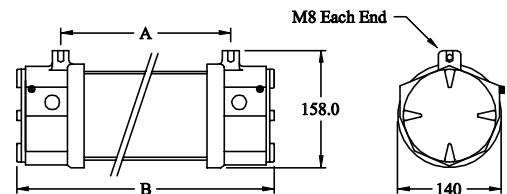

Size	Model	A	B
1	8w	335	448
2	18w	632	752
4	36w	1242	1362
5	58w	1542	1662
6	70w	1806	1926

All dimensions in mm



Easy lamp change system

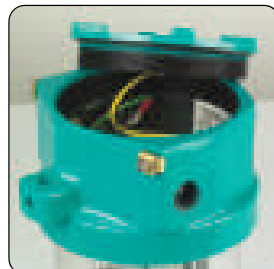

Threaded end cap



Threaded mounting point

# Technical Data

Supply Voltage	230v 50/60Hz Check for alternative voltages															
Operating Temperature	-20°C to +55°C standard supply subject to lamp and ambient temperature combinations (see table opposite).															
Control Gear	Electronic instant start, Switch start															
Lamp Options Cable Entries	8w (T5), 18w, 36w, 58w, 70w (T8) (Lamps not provided), 4 x M20 - 2 each end, (2 plugged) as standard															
Terminals	3 wire and earth. Cable size 4mm <sup>2</sup> max Through wiring option available on 18w to 70w sizes															
Mounting Facility	2 x M8 tapped holes vertical and horizontal at both ends.															
Access	Terminals accessed via threaded end cover as is the gear tray which slides out.															
Material	Corrosion resistant marine grade anodised aluminium body and high impact polycarbonate tube.															
Finish	2 Pack epoxy paint on primed surface. Standard colour - Aqua Additional costs for non standard colours															
Weight	<table border="0"> <tr> <td>Single Lamp</td> <td>1 8w</td> <td>3.0Kgs</td> <td>2 18w</td> <td>5.0Kgs</td> </tr> <tr> <td></td> <td>4 36w</td> <td>7.0Kgs</td> <td>5 58w</td> <td>8.0Kgs</td> </tr> <tr> <td></td> <td>6 70w</td> <td>9.0Kgs</td> <td></td> <td></td> </tr> </table>	Single Lamp	1 8w	3.0Kgs	2 18w	5.0Kgs		4 36w	7.0Kgs	5 58w	8.0Kgs		6 70w	9.0Kgs		
Single Lamp	1 8w	3.0Kgs	2 18w	5.0Kgs												
	4 36w	7.0Kgs	5 58w	8.0Kgs												
	6 70w	9.0Kgs														
Features	Highly versatile luminaire with large lamp and voltage ranges Durable and slim line construction Removable lamp assembly for ease of lamp change. High IP rating															

## Certification and Approval

Certification Code	EEx d II 2 G IIB or IIC T5 or T4 (See lamp tables for T rating)
Certification number	SIRA 01 ATEX I033
Certification standard	EN 60079-0, I
Protection	IP 66

## Features Options

Internally mounted batteries giving 3 hr duration  
EOL lamp protection  
50,000 hour electronic ballast

Wide range of voltage options  
Large range of lamp options  
IP68 versions

FOR AMBIENT TEMPERATURE “T” RATINGS SEE TABLES AT REAR OF CATALOGUE

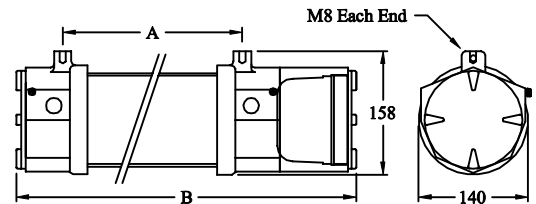

Size	Model	A	B
1	8w	335	535
2	18w	632	839
4	36w	1242	1449
5	58w	1542	1662

All dimensions in mm



Internal charger inverter



Separate battery chamber  
(some sizes)



Terminal block access

## Technical Data

Supply Voltage	230v 50/60Hz Check for alternative voltages. Suitable for central battery operation															
Operating Temperature	-20°C to +55°C standard supply subject to lamp and ambient temperature combinations (see table opposite).															
Control Gear	Electronic instant start, Switch start. One lamp lit in emergency mode															
Lamp Options	8w (T5), 18w, 36w, 58w, (Lamps not provided)															
Cable Entries	4 x M20 - 2 each end, (2 plugged) as standard															
Terminals	3 wire and earth. Cable size 4mm <sup>2</sup> max Through wiring option available on 18w to 70w sizes															
Mounting Facility	2 x M8 tapped holes vertical and horizontal at both ends.															
Access	Terminals accessed via threaded end cover as is the gear tray which slides out.															
Material	Corrosion resistant marine grade anodised aluminium body and high impact polycarbonate tube.															
Finish	2 Pack epoxy paint on primed surface. Standard colour - Aqua Additional costs for non standard colours															
Weight	<table border="0"> <tr> <td>Size 1</td> <td>8w</td> <td>5.1Kgs</td> </tr> <tr> <td>Size 2</td> <td>18w</td> <td>6.8Kgs</td> </tr> <tr> <td>Size 3</td> <td>36w</td> <td>10.0Kgs</td> </tr> <tr> <td>Size 4</td> <td>58w</td> <td>10.4Kgs</td> </tr> <tr> <td>Size 5</td> <td>70w</td> <td>12.5Kgs</td> </tr> </table>	Size 1	8w	5.1Kgs	Size 2	18w	6.8Kgs	Size 3	36w	10.0Kgs	Size 4	58w	10.4Kgs	Size 5	70w	12.5Kgs
Size 1	8w	5.1Kgs														
Size 2	18w	6.8Kgs														
Size 3	36w	10.0Kgs														
Size 4	58w	10.4Kgs														
Size 5	70w	12.5Kgs														
Features	Highly versatile luminaire with large lamp and voltage ranges Durable and slim line construction Removable lamp assembly for ease of lamp change. High IP Rating															

**Certification and Approval**

Certification Code	EEx d II 2 G IIB or IIC T6 - T5 or T4 (See lamp tables for T rating)
Certification number	SIRA 01 ATEX I033
Certification standard	EN 60079-0, I
Protection	IP 66

**Features Options**

Extended life using PL lamps  
 IIC as standard  
 Higher output – smaller fitting  
 50,000 hour electronic ballast

Range of voltages  
 Through wiring  
 IP68 versions  
 Range of mountings

FOR AMBIENT TEMPERATURE “T” RATINGS SEE TABLES AT REAR OF CATALOGUE

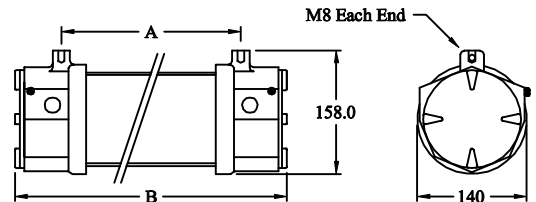

Size	Model	A	B
1	8w	335	448
2	18w	632	752

All dimensions in mm



Gear tray access  
 and amp access



Lamp retaining clips  
 on tray



Through wiring connection  
 plug

## Technical Data

Supply Voltage	230v 50Hz Check for alternative voltages. Suitable for central battery operation.						
Operating Temperature	-25°C to +52°C subject to lamp and ambient temperature combinations						
Control Gear	Electronic instant start, Switch start						
Lamp Options	11w, 18w, 26w, 36w, 55w PL-S, PL-L, PL-C (Lamps not provided)						
Cable Entries	2 x M20 – ISO (1 plugged) as Standard Other threads available.						
Terminals	3 wire and earth. Cable size 4mm <sup>2</sup> max Through wiring option available on 8w to 55w sizes						
Mounting Facility	2 x M8 tapped holes vertical and horizontal at both ends.						
Access	Terminals accessed via threaded end cover as is the gear tray which slides out						
Material	Corrosion resistant marine grade aluminium body and high impact polycarbonate tube.						
Finish	2 Pack epoxy paint on primed surface. Standard colour - Aqua Additional costs for non standard colours						
Weight	<table border="0"> <tr> <td>Size 1</td> <td>11w, 18w, 26w</td> <td>4.5Kgs</td> </tr> <tr> <td>Size 2</td> <td>18w, 26w, 55w,</td> <td>6.8Kgs</td> </tr> </table>	Size 1	11w, 18w, 26w	4.5Kgs	Size 2	18w, 26w, 55w,	6.8Kgs
Size 1	11w, 18w, 26w	4.5Kgs					
Size 2	18w, 26w, 55w,	6.8Kgs					
Features	IIC as standard Heavy duty construction High ambient temperature option available						



**Certification and Approval**

Certification Code	EEx de II 2 GD IIB T2 – T3 (See lamp tables for T rating)
Certification number	SIRA 01 ATEX 1035
Certification standard	EN 60079-0, 1, 7
Protection	IP 66

**Features Options**

Rapid re – lamping through threaded access cover  
 Narrow/Wide angle beam adjustment  
 Symmetrical reflector as standard  
 Integral EEx e Terminal chamber

Mounting bracket options  
 0.9 power factor when fitted

FOR AMBIENT TEMPERATURE “T” RATINGS SEE TABLES AT REAR OF CATALOGUE

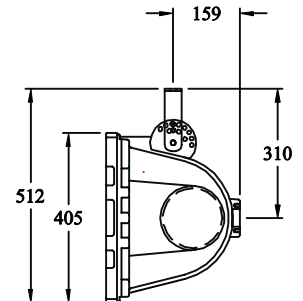
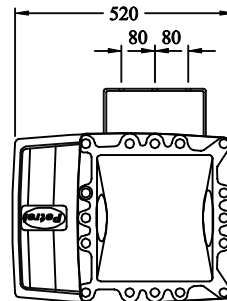

Lamp access cover



Beam adjustment

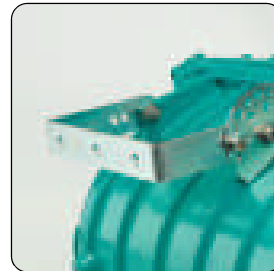

Angular adjustment  
 mounting plate

# Technical Data

Supply Voltage	230v 50Hz Check for alternative voltages and frequency.
Operating Temperature	-20°C to +55°C standard supply but subject to lamp, voltage and ambient temperature combinations .
Control Gear	Integral within the luminaire and optional power factor correction
Lamp Options	Tubular: SON, MBI, HPMV, Tungsten. Symmetrical reflector fitted to all versions. (Lamps not provided)
Cable Entries	2 x M20 – ISO (1 plugged) as Standard Other threads available.
Terminals	2 wire and earth. Cable size 6mm 2 max with looping facility
Mounting Facility	Rear pole mounting directly to body or for adjustable angle version order with “U” shaped stirrup and graduated angle bracket.
Access	Terminals accessed via EEx e terminal cover with 4 stainless steel fixings. Lamp change via threaded lamp cover for reduced maintenance time.
Material	Corrosion resistant marine grade aluminium body and covers and toughened Borosilicate glass.
Finish	2 Pack epoxy paint on primed surface. Standard colour - Aqua Additional costs for non standard colours.
Weight	SON, MBI, HPMV 33Kgs Tungsten 29Kgs
Features	Adjustable beam width Symmetrical reflector fitted to all versions Heavy Duty construction Directionally adjustable with stirrup mounting bracket

### Certification and Approval

Certification Code	EEx ed II 2G 3D IIC T5 – T4 (See lamp tables for T rating)
Certification number	SIRA 00 ATEX 3071. IECEx SIR 08.0089
Certification standard	EN 60079-0, 11:2006. EN60079-1, 7:2007. EN61241-1:2004. IEC 60079-0:2007
Protection	IP 65

### Features Options

- |  |                              |
|--|------------------------------|
| Integral isolation switch as standard                      | Alternative voltages         |
| Single point locking action                                | Through wiring               |
| EOL lamp shut down   | Omission of isolation switch |
| High light output  |                              |
| Integral battery with 3 hr. duration on emergency versions |                              |

FOR AMBIENT TEMPERATURE "T" RATINGS SEE TABLES AT REAR OF CATALOGUE

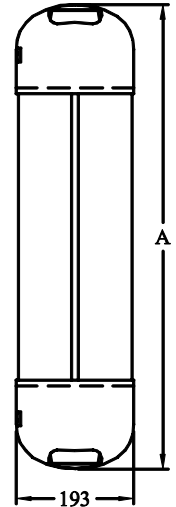
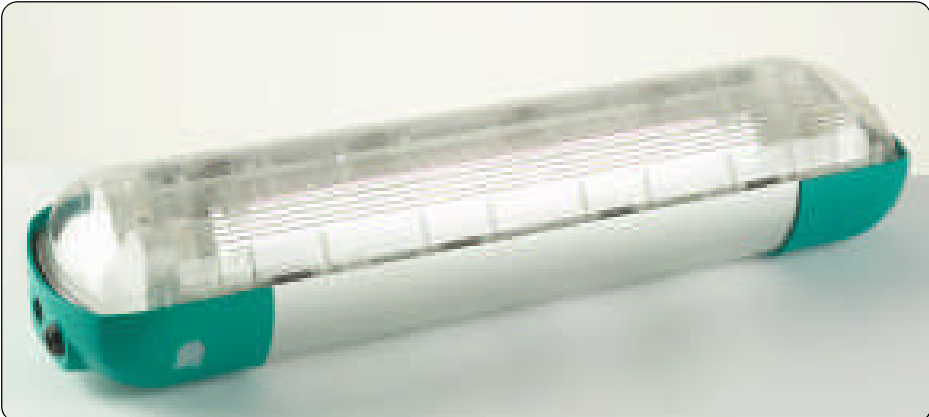

Size	Length	Fixing centres 100 up to
2x18w	760	450
2x36w	1365	1055
2x58w	1665	1355

All dimensions in mm



Single point diffuser release



Terminal block access



Rear mounting channel  
for T bolt

## Clip In Rapid Conduit System - Table of sizes and finishes

Round Boxes	Size	Finish	Part Number
Terminal box - 1 Way	20mm	Zinc Plate	9121G
Through box - 2 Way	20mm	Zinc Plate	9123G
Angle box - 2 Way	20mm	Zinc Plate	9125G
Tee box - 3 way	20mm	Zinc Plate	9129G
Intersection box - 4 way	20mm	Zinc Plate	9132G
<b>Couplers</b>			
Standard	20mm	Zinc Plate	9402G
Standard	25mm	Zinc Plate	9403G
Standard	20mm	Black	9402B
Standard	25mm	Black	9403B
<b>Running</b>			
Running	20mm	Zinc Plate	9412G
Running	25mm	Zinc Plate	9413G
Running	20mm	Black	9412B
Running	25mm	Black	9413B
<b>Flanged with Brass Bush</b>			
Flanged with Brass Bush	20mm	Zinc Plate	9432G
Flanged with Brass Bush	25mm	Zinc Plate	9433G
Flanged with Brass Bush	20mm	Black	9432B
Flanged with Brass Bush	25mm	Black	9433B
<b>Adaptors</b>			
Male Tread to Clip In	20mm	Zinc Plate	9002G
Male Tread to Clip In	25mm	Zinc Plate	9003G
Male Tread to Clip In	20mm	Black	9002B
Male Tread to Clip In	25mm	Black	9003B

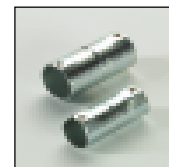

## 621 Bulkhead

Certified with elliptical or tubular lamps.

Max. 200w GLS	T4 @ Ta = 34°C
50w or 70w SON	T4 @ Ta = 40°C
or	T3 @ Ta = 60°C
50w or 80w HPMV/MBF	T4 @ Ta = 40°C
or	T3 @ Ta = 60°C
125w HPMV/MBF	T4 @ Ta = 40°C
Max. 25w SL or 20w PLCE	T6 @ Ta = 70°C
or	T5 @ Ta = 60°C
All with ES (E27) lampholder.	
Up to 200w BC also available.	T4 @ Ta = 34°C
High temperature version (at extra cost).	
200w GLS	T3 @ Ta = 60°C
70w SON	T3 @ Ta = 90°C
80w HPMV/MBF	T3 @ Ta = 90°C
125w HPMV/MBF	T3 @ Ta = 70°C
25w SL or 20w PLCE	T5 @ Ta = 60°C
Lamps not included	
N.B. For Ta up to 60°C cable must be suitable for 116°C operation. Above Ta 60°C cable must be suitable for 146°C operation.	

## 7 series Fluorescent

Lamp source options:	Certification data:	All options certified for -25°C
	8w T5 @ Ta=40°C	T4 @ Ta=52°C EEx d IIC
	18w T6 @ Ta=40°C	T5 @ Ta=55°C EEx d IIC
	36w T6 @ Ta=40°C	T5 @ Ta=55°C EEx d IIB
	58w T6 @ Ta=40°C	T5 @ Ta=55°C EEx d IIB
	70w T5 @ Ta=40°C	T4 @ Ta=55°C EEx d IIB

## Emergency Range

Lamp source options:	Certification data:	All options certified for -25°C
	8w T6 @ Ta=40°C	T6 @ Ta=52°C EEx d IIC
	18w T6 @ Ta=40°C	T5 @ Ta=55°C EEx d IIC
	36w T6 @ Ta=40°C	T5 @ Ta=55°C EEx d IIB
	58w T6 @ Ta=40°C	T5 @ Ta=55°C EEx d IIB

## 7 series Compact

Lamp source options:	Standard fluorescent	
Size 1	1 or 2 x 11w max PL-S	T4 @ Ta=52°C
	1 or 2 x 18w max PL-L	
	1 or 2 x 26w max PL-C	T5 @ Ta=40°C
Size 2	1 or 2 x 36w max PL-L	T6 @ Ta=40°C
	1 or 2 x 55w max PL-L (HF only)	T6 @ Ta=40°C
	Emergency fluorescent	
Size 1	1 x 18w max PL-L EM	T4 @ Ta=52°C
Size 2	1 x 2 x 36w max PL-L EM	T6 @ Ta=40°C

## 8 series Flood Light

Lamp source options:	
80w, 250w HPMV	T3 @ Ta = 55°C (D=T147°C)
With ES (E27) lampholder.	
150w, 250w SON	T3 @ Ta = 55°C (D=T147°C)
250w MBI	T3 @ Ta = 55°C (D=T147°C)
500w Tung Halogen	T3 @ Ta = 55°C (D=T175°C)
250w HPMV	T3 @ Ta = 55°C (D=T147°C)
400w SON/MBI	T3 @ Ta = 40°C (D=T147°C)
400w, HPMV	T3 @ Ta = 40°C (D=T147°C)
500w, Tung Halogen	T3 @ Ta = 55°C (D=T173°C)
150w, 250w SON	T3 @ Ta = 40°C (D=T127°C)

## 9 series Fluorescent

All options certified for -20°C to +55°C
All variations: T5 @ Ta 25°C
T4 @ Ta 55°C

## 9R series Fluorescent

All options certified for -20°C to +55°C
EEx ed IIC T5 @ Ta 25°C or T4 @ 55°C

## Technical Data

Supply Voltage	230v 50/60Hz standard, 110v , 254v and 277v optional on some 18w and 36w. 60-Hz also optional. Suitable for central battery operation.	
Operating Temperature	-20°C to +55°C standard supply subject to ambient temperature requirements.	
Control Gear	Electronic instant start ballast and integral charger inverter for emergency versions. EOL cut off. 3hr operation with internal battery subject to ambient temperature.	
Lamp Options	Twin 18w, 36w, 58w (Lamps not provided)	
Cable Entries	2 x M20 at each end (3 plugged as Standard)	
Terminals	3 wire and earth. Cable size 4mm <sup>2</sup> max Through wiring option available	
Mounting Facility	2 x M8 "Quick fit" bolts available on variable centres for ease of mounting.	
Access	Terminals accessed via quick release diffuser and reflector.	
Material	Anodised corrosion resistant Aluminium and high impact polycarbonate diffuser and body mouldings. UV Resistant.	
Finish	Standard colour – Aqua body mouldings natural aluminium for body centre section	
Weight	Standard	Emergency
	2x 18w 6.8Kgs	7.0Kgs
	2 x 36w 10.4Kgs	11.2Kgs
	2 x 58w 12.0Kgs	13.0Kgs
Features	Excellent light output Heavy duty rigid construction Internal automatic isolation (may be omitted upon request) 110v , 254v and 277v available.	

**Certification and Approval**

Certification Code EEx ed II 2G 3DIIC T5 – T4 (See lamp tables for T rating)  
 Certification number SIRA 00 ATEX 3106  
 Certification standard EN 60079-0, I I:2006. EN60079-1, 7:2007.  
 Protection IP 54

**Features Options**

Flush fitting – minimizing dust build up  
 EOL lamp shut down  
 Integral battery with 3hr duration on emergency versions  
 FOR AMBIENT TEMPERATURE “T” RATINGS SEE TABLES AT REAR OF CATALOGUE

Alternative voltages  
 Through wiring  
 Omission of isolation switch

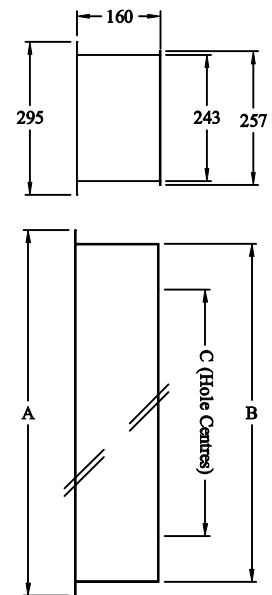

Size	A	B	C
2 x 18	802	752	642
2 x 36	1402	1352	1242
2 x 58	1702	1652	1542

All dimensions in MM



Terminal block access



Rear mounting foot



Ballast & lamp holder pack

## Technical Data

Supply Voltage	230v 50/60Hz standard, 110v , 254v and 277 v optional on some 18w and 36w. 60Hz also optional. Suitable for central battery operation.												
Operating Temperature	-20°C to +55°C standard supply subject to ambient temperature requirements.												
Control Gear	Electronic instant start ballast and integral charger inverter for emergency versions. EOL cut off. 3hr operation with internal battery subject to ambient temperature.												
Lamp Options	Twin 18w, 36w, 58w T8 (Lamps not provided)												
Cable Entries	2 x M20 clearance holes at each end (3 plugged as Standard)												
Terminals	3 wire and earth. Cable size 4mm <sup>2</sup> max Through wiring option available												
Mounting Facility	4 fixing holes on rear of enclosure.												
Access	Remove toughened glass front panel and quick release diffuser.												
Material	Polyester coated steel and toughened glass in an aluminium frame.												
Finish	Standard colour – White polyester coated												
Weight	<table border="0"> <thead> <tr> <th></th> <th>Standard</th> <th>Emergency</th> </tr> </thead> <tbody> <tr> <td>2x 18w</td> <td>12.0Kgs</td> <td>10.0Kgs</td> </tr> <tr> <td>2 x 36w</td> <td>14.0Kgs</td> <td>13.0Kgs</td> </tr> <tr> <td>2 x 58w</td> <td>15.0Kgs</td> <td>15.0Kgs</td> </tr> </tbody> </table>		Standard	Emergency	2x 18w	12.0Kgs	10.0Kgs	2 x 36w	14.0Kgs	13.0Kgs	2 x 58w	15.0Kgs	15.0Kgs
	Standard	Emergency											
2x 18w	12.0Kgs	10.0Kgs											
2 x 36w	14.0Kgs	13.0Kgs											
2 x 58w	15.0Kgs	15.0Kgs											
Features	<p>Flush fitting closing panel minimising dust and bacterial build up            Heavy duty rigid construction            Internal automatic isolation (may be omitted upon request)            110v , 254v and 277v available.</p>												



**Certification and Approval**

Certification Code EEx nC II 3GD T4 -40°C to +55°C  
 Certification number Epsilon 02 ATEX I 167  
 Certification standard EN 60079-0, 15  
 Protection IP 65

**Features Options**

Unrestricted breathing  
 No vacuum test required  
 Integral battery with 3hr duration on emergency versions

Closed cell gasket  
 Push fit gear tray  
 Stainless steel clips

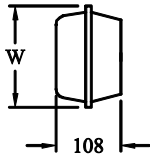
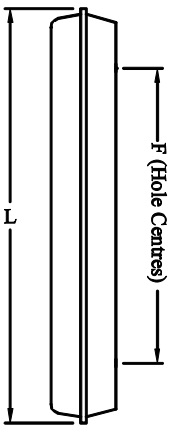

Size	L	W	F
1x36w	1312	102	800
1x58w	1612	102	1100
2x18w	702	172	500
2x36w	1312	172	800
2x58w	1612	172	1100

All dimensions in mm

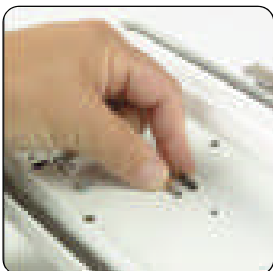

Gear tray clips



Lamp mounting



Diffuser clips

# Technical Data

Supply Voltage	230v 50/60Hz standard. Suitable for central battery operation.	
Operating Temperature requirements.	-40°C to +55°C standard supply subject to ambient temperature	
Control Gear	Electronic instant start ballast and integral charger inverter for emergency versions. EOL cut off. 3hr operation with internal battery subject to ambient temperature.	
Lamp Options	Twin 18w, 36w, 58w T8 (Lamps not provided) Single 36w and 58w T8 (Lamps not provided)	
Cable Entries	1 x M20 clearance holes at each end (1 plugged as Standard)	
Terminals	3 wire and earth. Cable size 4mm <sup>2</sup> max Through wiring option available	
Mounting Facility	2 drill through fixing points on rear of enclosure or "snap on" stainless steel brackets or heavy duty "gull wing" bracket available	
Access	Quick release stainless steel clips to free diffuser and spring clips release gear tray.	
Material	GRP moulded body, polycarbonate diffuser and coated steel control gear tray. Stainless steel diffuser and tray retaining clips	
Finish	Standard colour – Light grey non coated moulding	
Weight	Standard	Emergency
	2x 18w 2.8gs	3.8Kgs
	2 x 36w 3.6gs	4.6Kgs
	2 x 58w 5.0Kgs	5.6Kgs
	1 x 36w 3.2kgs	4.0Kgs
	1 x 58w 3.4Kgs	4.2Kgs
Features	Resilient construction Poured seal or closed cell gasket Unrestricted breathing for minimum inspection requirements Easily maintained.	

**Certification and Approval**

Certification Code	EEx nC II 3GD T6 or T3 (See lamp tables for T rating)
Certification number	03 ATEX TF457/01
Certification standard	EN 60079-0, I5
Protection	IP 68 to I5M subject to appropriate glanding

**Features Options**

Heavy duty cast iron construction  
 Low projection and rounded profile  
 Ideal for culvert and water treatment works  
 High IP rating for arduous conditions

Alternative voltages  
 Through wiring  
 Lamp source variants

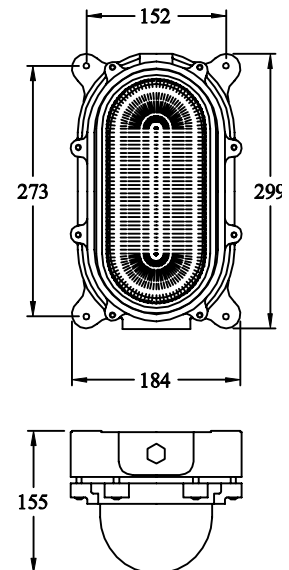

Cable entry

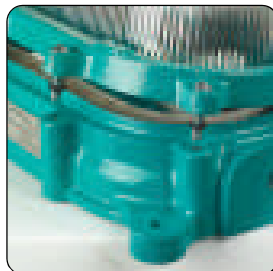

Lamp access

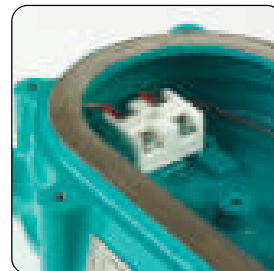

Terminal block access

## Technical Data

Supply Voltage	230v 50Hz standard..
Operating Temperature	-20°C to +40°C standard supply subject to ambient temperature requirements.
Control Gear	For use with GLS lamp or 25w compact fluorescent. No control gear required.
Lamp Options	150w GLS or 25w compact fluorescent, 70w SON (Lamps not supplied)
Cable Entries	x M20 Threaded entry. Available both ends as option
Terminals	2 wire and earth. Cable size 4mm <sup>2</sup> max
Mounting Facility	4 cast in fixing lugs to take M8 screws.
Access	Remove bezel retaining screws to release glass lens and gasket
Material	Cast iron body and bezel, glass lens and coated wire guard
Finish	2 Pack epoxy paint on primed surface. Standard colour – Aqua and white plastic coated guard Additional costs for non standard colours.
Weight	9.0Kgs
Features	Very heavy construction. Low projection and rounded profile Ideal for culvert and water treatment works High IP rating for arduous conditions

**Certification and Approval**

Certification Code	EEx nC II 3GD T3 (See lamp tables for T rating)
Certification number	03 ATEX TFDN/01
Certification standard	EN 60079-0, 15
Protection	IP 65

**Features Options**

Rapid lamp and control gear access  
 Even light distribution  
 Hinged lens opening

Lamp source variants  
 Power factor correction  
 Various lamp options available

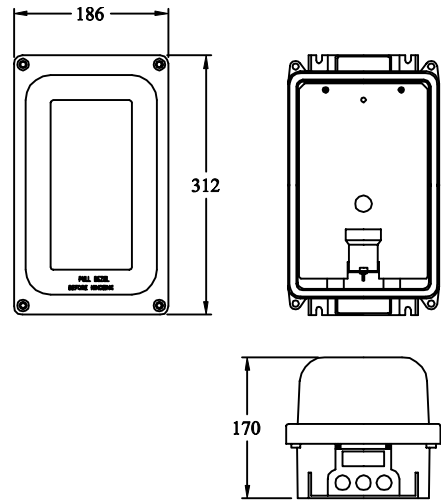

*Hinged lens opening*

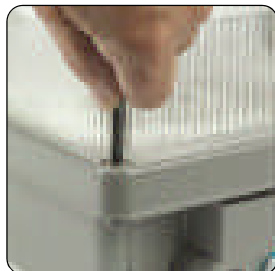

*Screwed bezel fixings*



*Integral mounting feet*

## Technical Data

Supply Voltage	230v 50Hz standard.
Operating Temperature	-20°C to +30°C standard supply subject to ambient temperature requirements.
Control Gear	Integral within the luminaire and optional power factor correction
Lamp Options	Elliptical: 70w SON 80w HPMV 200w GLS Twin 26w PL
Cable Entries	2 x M20 Threaded entries at one end (1 plugged).
Terminals	2 wire and earth. Cable size 4mm <sup>2</sup> max
Mounting Facility	4 cast in fixing lugs to take M8 screws.
Access	Unscrew retaining screws to open hinged lens.
Material	Die cast aluminium body and bezel and borosilicate glass lens
Finish	Grey Powder coating or 2 Pack epoxy paint on primed surface. Additional costs for non standard colours.
Weight	70w and 80w    6.0Kgs                      200w    4.0Kgs
Features	Rapid lamp and control gear access Even light distribution Various lamp options available

**Certification and Approval**

Certification Code	EEx nR II 3GD T3
Certification number	05 ATEX TFZT/01
Certification standard	EN 60079-0, 15
Protection	IP 66

**Features** **Options**

Symmetrical reflector fitted to all versions  
Easy lamp access  
Robust construction  
Directionally adjustable with stirrup mounting bracket

Lamp source variants  
Power factor correction  
Non standard colour

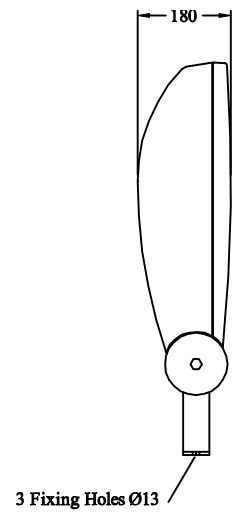
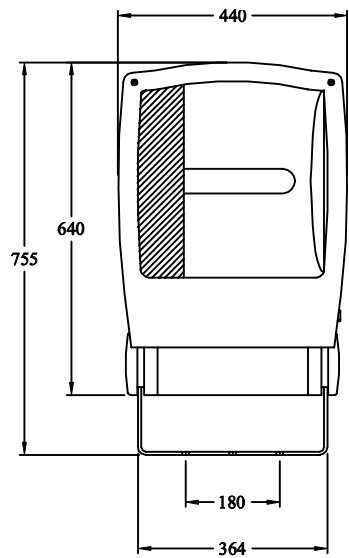

*Hinged lens opening*

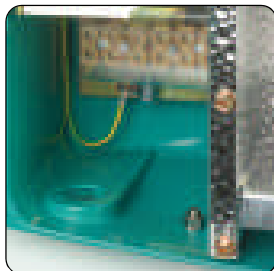

*Cable entry and termination block*

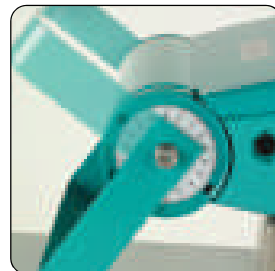

*Adjustable angle mounting stirrup*

# Technical Data

Supply Voltage	230v 50Hz standard..
Operating Temperature	-20°C to +30°C standard supply subject to ambient temperature requirements.
Control Gear	Integral within the luminaire and optional power factor correction when fitted.
Lamp Options	Tubular: SON, MBI, Tungsten. 70w to 500w Asymmetrical reflector fitted to all versions. (Lamps not provided)
Cable Entries Terminals	1 x M20 clearance hole in side of body. 2 wire and earth. Cable size 4mm <sup>2</sup> max
Mounting Facility	“U” shaped stirrup bracket with angle adjustment mechanism.
Access	Unscrew 2 stainless steel screws in hinged glass retaining frame.
Material	Corrosion resistant die cast aluminium and toughened glass lens.
Finish	2 Pack epoxy paint on primed surface. Standard colour – Aqua .Additional costs for non standard colours.
Weight	19.5Kgs to 21Kgs Lamp dependant.
Features	Symmetrical reflector fitted to all versions Robust construction Directionally adjustable with stirrup mounting bracket



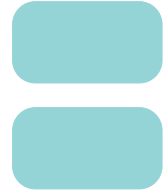

**Certification and Approval**

**Industrial Luminaire**

Bulk head fitting suitable for non hazardous industrial and commercial applications Available in a range of lamp formats including energy efficient PL's Emergency version with integral battery available with PL lamps (not supplied) Ingress Protection IP 65

**Features Options**

Hinged lens opening  
 Rapid lamp and control gear access  
 Even light distribution

Lamp source variants  
 Power factor correction  
 Various lamp options available

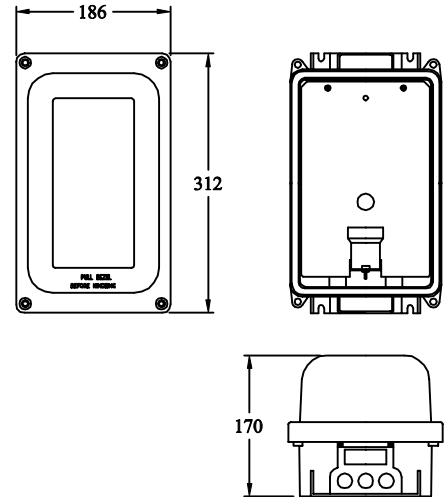

*Hinged lens opening*



*Screwed bezel fixings*



*Integral mounting feet*

## Technical Data

Supply Voltage	230v 50Hz standard..
Operating Temperature	-20°C to +25°C standard supply subject to ambient temperature requirements.
Control Gear	Integral within the luminaire and optional power factor correction. Emergency version available for PL lamps
Lamp Options	Elliptical: 70w SON 80w HPMV 200w GLS PL 28w
Cable Entries	2 x M20 Threaded entries at one end (1 plugged).
Terminals	2 wire and earth. Cable size 4mm <sup>2</sup> max
Mounting Facility	4 cast in fixing lugs to take M8 screws.
Access	Unscrew retaining screws to open hinged lens.
Material	Die cast aluminium body and bezel and borosilicate glass lens
Finish	Grey powder coated or 2 Pack epoxy paint on primed surface. Additional costs for non standard colours.
Weight	70w and 80w      8.0Kgs 200w              6.5Kgs PL                  7.0 Kgs PL emergency    8.0 Kgs
Features	Rapid lamp and control gear access Even light distribution Various lamp options available



CABLE JOINTS, CABLE TERMINATIONS, CABLE GLANDS, CABLE CLEATS  
FEEDER PILLARS, FUSE LINKS, ARC FLASH, CABLE ROLLERS, CUT-OUTS

11KV 33KV CABLE JOINTS & CABLE TERMINATIONS  
FURSE EARTHING  
www.cablejoints.co.uk  
**Thorne and Derrick UK**

Tel 0044 191 490 1547 Fax 0044 191 477 5371  
Tel 0044 117 977 4647 Fax 0044 117 9775582