



WWW.CABLEJOINTS.CO.UK
THORNE & DERRICK UK
 TEL 0044 191 490 1547 FAX 0044 477 5371
 TEL 0044 117 977 4647 FAX 0044 977 5582
 WWW.THORNEANDDERRICK.CO.UK

WOLF TANK LIGHTING KIT



- ATEX Approved for Zone 1 explosive Gas and Dust atmospheres
- Safe Extra Low Voltage
- Robust durable construction
- Choice of Stainless Steel or GRP Transformer
- Powers up to 4 Lamps
- Twin or Quad lamp configuration
- Supplied with 20m SY Cable
- Fitted with ATX Plugs and Sockets
- Maximum Cable Length per lamp 35m
- 110V or 230V Input Voltage available



Applications Include:

- Tank Cleaning
- Vessel Entry
- Aircraft maintenance
- Utility Markets
- Tunnel maintenance
- Sewers & Drains
- Petrochem Plants
- Confined Space
- Offshore Oil & Gas

LL-500
 2x 36W CFL (approx 180°)
 4x 36W CFL (approx 360°)
 Peak luminous intensity at 2.5m **138 lux**
 Peak luminous intensity at 5m **36 lux**

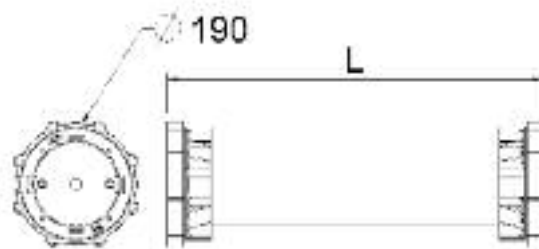
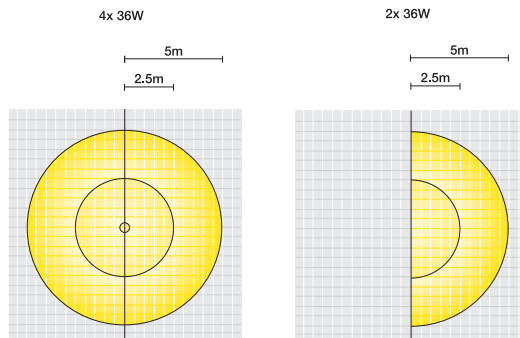

ATEX



1180

The Wolf Tank Lighting Kit provides a low voltage portable temporary lighting solution for Zone 1 Hazardous Areas where potentially explosive gases, vapours and dusts may be present.

The Kit comprises a Zone 1 Ex transformer, 230V or 110V to 24V, supplying extra low voltage for use in tanks and vessels, with up to four LL-500 fluorescent leadlamps in various configurations, the most popular being four 2x36W lamps giving 180° of light output. Alternatively, a kit including three 2x36W lamps and one 4x36W lamp

providing 360° of high quality ambient light. Each lamp is supplied with 20m SY cable and fitted with ATX 2-Pole + Earth plugs for connection in the explosive area.

Easy maintenance is a key feature of this product range, with standard replacement compact fluorescent lamps readily available from electrical wholesalers and fitted in minutes.

A full range of accessories is available, including protective film for painting and shot blasting applications, magnetic fixings, tripods, and stands to mount the

lamp vertically and elevate it away from tank residue, using the integrated Unistrut-compatible mounting points. Wolf Safety also carries a full range of spares to minimise downtime for the user.

Typical applications include:- vessel entry, tank cleaning and routine inspection work, programmed preventative maintenance shutdowns in potentially dangerous confined spaces, all frequently encountered in the aircraft industry, oil & gas, petrochemical and utility markets.

| Tank Lighting Kit Configuration Matrix | | | | | | | | |
|--|---|--------|-----------------|--------|-------------------------------|--------|-----------------|--------|
| Wolf Tank Lighting Kit Code | LL-115 | LL-215 | LL-125 | LL-225 | LL-116 | LL-216 | LL-126 | LL-226 |
| Certification Code | II 2 GD Ex emb II T3/T4 Ex tD A21 IP66/67/68 T100°C | | | | | | | |
| Lamp Models * | 4 x LL-524/20 | | | | 3 x LL-524/20 & 1 x LL-544/20 | | | |
| Lamp Output | 4 x 72W (288W) | | | | 3 x 72W & 1 x 144W (360W) | | | |
| Transformer | LL-114 | LL-214 | LL-124 | LL-224 | LL-114 | LL-214 | LL-124 | LL-224 |
| Transformer Type | GRP | | Stainless Steel | | GRP | | Stainless Steel | |
| Transformer Voltage | 110V | 230V | 110V | 230V | 110V | 230V | 110V | 230V |
| * Please refer to the Fluorescent Leadlamp sales leaflet for individual lamp specification | | | | | | | | |

| Wolf ATEX Leadlamp Transformers | | | | |
|---------------------------------|--|--------------------------|---|--------------------------------------|
| Technical Specification | | | | |
| Product Reference | LL-114 | LL-214 | LL-124 | LL-224 |
| Description | GRP 110 volt transformer | GRP 230 volt transformer | Stainless Steel 110 volt transformer | Stainless Steel 230 volt transformer |
| Code | II 2 GD EEx ed IIC T3 DIP A21 IP66 T _A =85°C | | II 2 GD Ex ed IIC T4 Ex tD A21 IP66 T135°C | |
| Apparatus Standard | EN50014, EN50018, EN50019, EN50281-1-1 | | EN60079-0, EN60079-1, EN60079-7, EN61241-0, EN61241-1 | |
| Type of protection | "e" increased safety "d" flameproof | | | |
| Area of classification (Gas) | Zones 1 and 2, Gas groups IIA, IIB and IIC | | | |
| Temp classification (Gas) | T3 | | T4 | |
| Area of classification (Dust) | Zones 21 and 22 | | Zones 21 and 22 | |
| Max. surface temperature (Dust) | T85°C | | T135°C | |
| Ambient temperature | -40°C to +55°C | | -20°C to +40°C to 350VA -20°C to +30°C to 400VA | |
| Certificate | LCIE02ATEX6248X | | SIRA08ATEX3182X | |
| Enclosure | GRP (glass reinforced polyester) enclosure, stainless steel skid | | Stainless steel enclosure, stainless steel skid | |
| Power | 400VA | | | |
| Volts in | 110V ac | 230V ac | 110V ac | 230V ac |
| Input cable | 15m SY cable with ATX 110V/230V 2P+E Plug fitted as standard | | | |
| Volts out | 24V | | | |
| Socket arrangement | 4 output sockets, ATX 24V 2P + E as standard | | | |
| Size - dimensions | 460x450x280 | | 580x370x270 | |
| Ingress protection | IP66 | | | |
| Weight | 21kg | | 23kg | |

All products supplied with 4mm² SY Cable and ATX plugs/sockets as standard.
All products supplied with fluorescent lamps fitted as standard.
Changes to the above specifications available on request.



WWW.CABLEJOINTS.CO.UK
THORNE & DERRICK UK
 TEL 0044 191 490 1547 FAX 0044 477 5371
 TEL 0044 117 977 4647 FAX 0044 977 5582
 WWW.THORNEANDDERRICK.CO.UK

