



Local Control Station - Glass Reinforced Polyester Enclosure

LCP160 - Ex e Ammeter

HAZARDOUS AREA SPECIFICATION

Marking to 94/9/EC	Ex II 2 GD		
Type of Protection	Ex e IIC T* Gb Ex tb IIIC T**C Db		
Ambient Temp.°C	Gas Temperature Class (T*°C)		Dust Temperature Class (T**)(°C)
Min	Max		
-20*	+50	T6	85
* -40°C when used with a plug and gland rated to -40°C			
Ingress Protection	IP66 to EN60529:1992		
Area Classification	Zones 1,2,21,22		
Certification No.	SIRA03ATEX3293, GOST-R POCC GB.Mn14.B00074		

ENCLOSURE SPECIFICATION

Material Box	Carbon loaded anti-static glass reinforced polyester UL94/V0
Finish	Moulded black
Weight Empty	0.7Kg
Cover Fixing	M6 Stainless Steel hexagon head screws
Gasket	1.2 mm one piece solid nitrile rubber
Earthing	Internal Ex e brass clamps on base
Entries	1x20mm threaded hole in face A, fitted with a nylon Ex e stopping plug. 1x20mm threaded hole in face B, fitted with a nylon Ex e cable gland. 25mm entries are available as an option.
Mounting	Through 7mm holes moulded into base

ELECTRICAL SPECIFICATION

1A & 5A movements are available for direct operation, scale to be specified at time of ordering. For higher currents a current transformer may be used. Movements are calibrated to show 6x overload readings.

ORDERING INFORMATION

Description	Scale	Product Code
Ammeter	To be specified at time of ordering	LCP160

Notes - For 25mm entries add/25 to Product Code e.g. LCP160/25

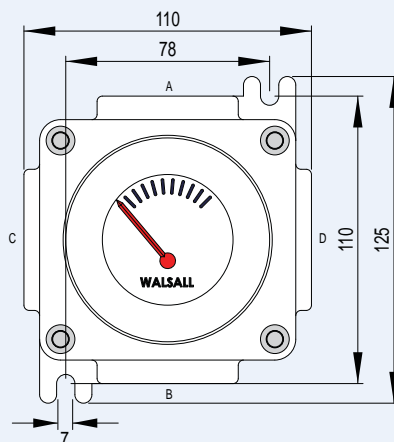

All Dimensions in mm.