

# Resin Joints

## MPJ Series Low Voltage Cable Jointing Kits

### Application

- > For cables with copper conductors

### Characteristics

- > Prysmian's cast resin straight joints are the ideal method for jointing polymeric industrial cables where crimped connectors are required.
- > The low voltage cable jointing kits are manufactured with two types of shell design. A clear injection moulded version for smaller cable sizes, and a high impact styrene design to cover the larger ranges.
- > A lightweight two-part easy flow polyurethane resin is provided as standard, suitably packed in a foil laminated sachet offering a completely enclosed resin mixing system.

### Joint Features & Benefits

- > MPJ 1, 2, 3 and 4 use injection moulded shells
- > MPJ 5, 6, 7 and 8 use high impact styrene shells (HIPS)
- > Armour bonds included
- > Tested and approved to BS EN 50393 & ENA ER C81

### Resin Features & Benefits

- > "Twin Pack" totally enclosed mixing
- > Enhanced adhesion to XLPE and PVC
- > Improved flow characteristics
- > 40% reduction in weight
- > Easier mixing



Ref: MPJ/02/09



CABLE JOINTS, CABLE TERMINATIONS, CABLE GLANDS, CABLE CLEATS  
FEEDER PILLARS, FUSE LINKS, ARC FLASH, CABLE ROLLERS, CUT-OUTS

11KV 33KV CABLE JOINTS & CABLE TERMINATIONS  
FURSE EARTHING  
www.cablejoints.co.uk  
Thorne and Derrick UK

Tel 0044 191 490 1547 Fax 0044 191 477 5371  
Tel 0044 117 977 4647 Fax 0044 117 9775582



# Low Voltage Cable Jointing Kits

## Selection Information

> Selection information for low voltage straight on 600/1000V polymeric insulated copper conductors, SWA cables to BS6346, BS5467 & IEC502

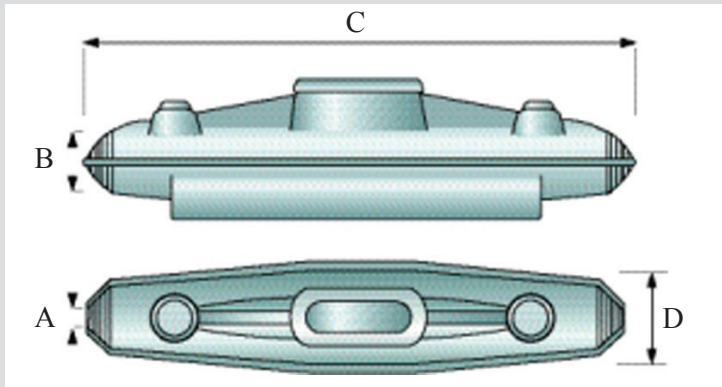

### SELECTING

"MPJ" Straight Joints XLPE or PVC/SWA Copper Conductors

### Shell Dimensions

| Joint Ref. | Min. box entry Ø 'A' | Max. box entry Ø 'B' | Box length 'C' | Internal Ø 'D' |
|------------|----------------------|----------------------|----------------|----------------|
| MPJ1       | 12mm                 | 26mm                 | 185mm          | 35mm           |
| MPJ2       | 14mm                 | 32mm                 | 245mm          | 48mm           |
| MPJ3       | 23mm                 | 39mm                 | 325mm          | 52mm           |
| MPJ4       | 28mm                 | 50mm                 | 375mm          | 68mm           |
| MPJ5       | 32mm                 | 58mm                 | 520mm          | 102mm          |
| MPJ6       | 45mm                 | 75mm                 | 705mm          | 124mm          |
| MPJ7       | 40mm                 | 89mm                 | 862mm          | 140mm          |
| MPJ8       | 57mm                 | 95mm                 | 900mm          | 150mm          |

### Notes:

- > Connectors are sold separately
- > Armour bonds are included

\*Joint does not accommodate crossed core (phase to phase) jointing.

### LV Straight joints - Suitable for Copper Cables & Compression Connectors

| Conductor Size     | Two Core Ref. | Three Core Ref. | Four Core Ref. | Connector Ref. |
|--------------------|---------------|-----------------|----------------|----------------|
| 1.5mm <sup>2</sup> | MPJ1          | MPJ1            | MPJ1           | BERS           |
| 2.5mm <sup>2</sup> | MPJ1          | MPJ1            | MPJ1           | BEBS           |
| 4mm <sup>2</sup>   | MPJ1          | MPJ1            | MPJ1           | BEYS/BT6CS     |
| 6mm <sup>2</sup>   | MPJ1          | MPJ2            | MPJ2           | BT6CS          |
| 10mm <sup>2</sup>  | MPJ2          | MPJ2            | MPJ2           | BT10CS         |
| 16mm <sup>2</sup>  | MPJ2          | MPJ3            | MPJ3           | BT16CS         |
| 25mm <sup>2</sup>  | MPJ3          | MPJ3            | MPJ3           | BT25CS         |
| 35mm <sup>2</sup>  | MPJ3          | MPJ4            | MPJ4           | BT35CS         |
| 50mm <sup>2</sup>  | MPJ4          | MPJ4            | MPJ4           | BT50CS         |
| 70mm <sup>2</sup>  | MPJ4          | MPJ4            | MPJ5           | BT70CS         |
| 95mm <sup>2</sup>  | MPJ4          | MPJ5            | MPJ5           | BT95CS         |
| 120mm <sup>2</sup> | MPJ5          | MPJ6            | MPJ6           | BT120CS        |
| 150mm <sup>2</sup> | MPJ5          | MPJ6            | MPJ6           | BT150CS        |
| 185mm <sup>2</sup> | MPJ5          | MPJ6            | MPJ6           | BT185CS        |
| 240mm <sup>2</sup> | MPJ6          | MPJ7            | MPJ7           | BT240CS        |
| 300mm <sup>2</sup> | MPJ6          | MPJ7            | MPJ7           | BT300CS        |
| 400mm <sup>2</sup> | MPJ8*         | MPJ8*           | MPJ8*          | BT400CS        |

### Compression Connector



CABLE JOINTS, CABLE TERMINATIONS, CABLE GLANDS, CABLE CLEATS  
FEEDER PILLARS, FUSE LINKS, ARC FLASH, CABLE ROLLERS, CUT-OUTS

11KV 33KV CABLE JOINTS & CABLE TERMINATIONS  
FURSE EARTHING  
www.cablejoints.co.uk  
Thorne and Derrick UK

Tel 0044 191 490 1547 Fax 0044 191 477 5371  
Tel 0044 117 977 4647 Fax 0044 117 9775582

