



INSTALLATION INFORMATION →

Ridgiduct Twin-Walled High Density Polyethylene Ducting must be installed in accordance with the general requirements and any additional site requirements.

The general requirements are to be in accordance with MCHW, Volume 3, as shown below.

Ducting laid in depths of cover other than those specified below must be laid in accordance with the procedures described in the contract with the Highways Agency (HA).

Ridgiduct must be adequately protected against damage from site construction traffic and from agricultural or similar operations.

When used as ducts for fibre optic cabling the recommendations in BS 7718 : 1996 should be followed.

PROCEDURE (UNSEALED) →

Joints are made by a simple push-fit of one duct length into the coupler attached to the adjacent length, ensuring that the connection is fully made.

Inspection points can be made in the conventional manner depending upon the type of services to be installed.

TYPICAL UNSEALED STANDARD DUCT INSTALLATIONS

TYPE A SHALLOW DUCTS (750 TO 1200 COVER) →

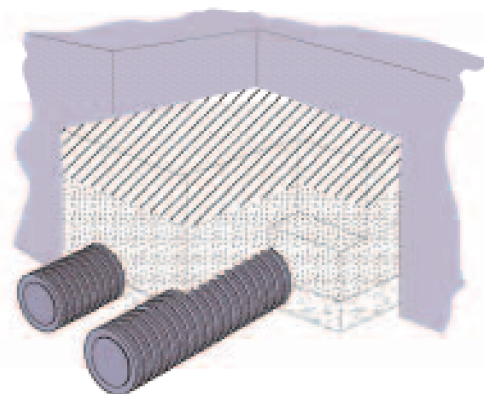
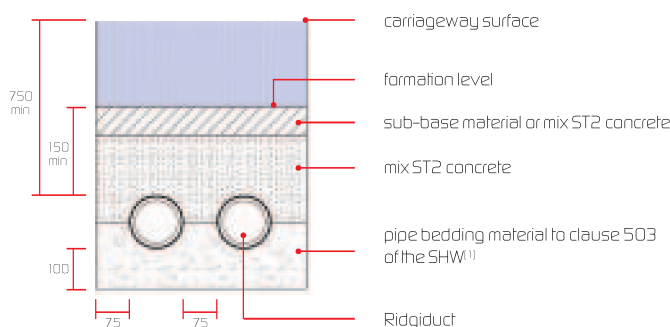

TYPE B DEEP DUCTS (OVER 1200 COVER) →

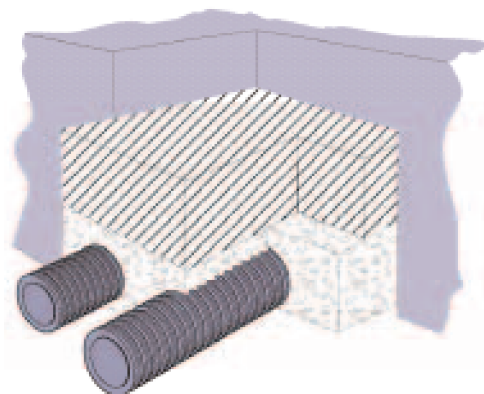
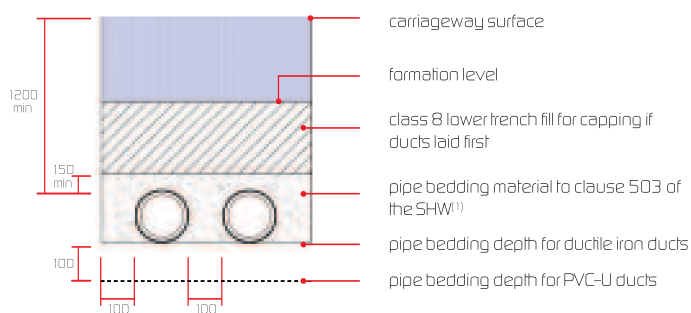

MINIMUM CLEARANCE BETWEEN DUCT AND DRAIN →

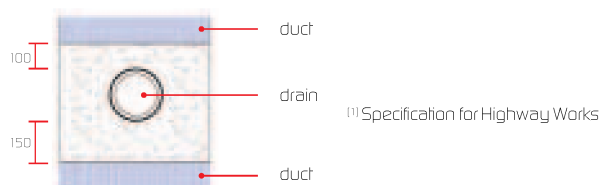

MOTORWAY COMMS INSTALLATIONS SHOULD BE IN ACCORDANCE WITH MCHW SERIES 1500, FOR INSTALLATION DETAILS REGARDING MULTIPLE DUCT CONFIGURATIONS AND SEALED SYSTEMS, PLEASE REFER TO OUR TECHNICAL OFFICE FOR SPECIFIC ADVICE.



TYPICAL INSTALLATION OF A 450 X 450mm ACCESS BOX SUBJECT TO VEHICLE TRAFFIC

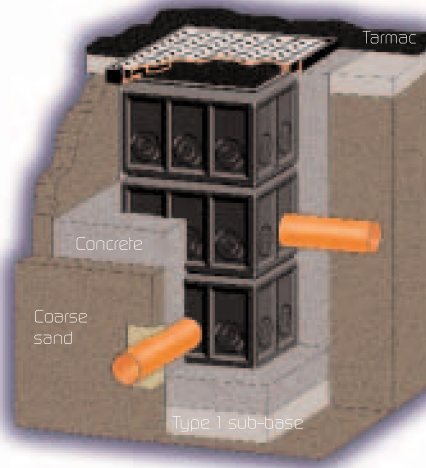

TYPICAL INSTALLATION OF A POLYPIPE 450 X 450mm POLE BOX

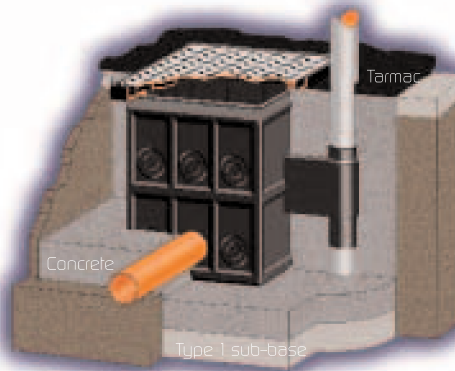

COVERS AND FRAMES

Access box covers and frames should meet the requirements of BS EN 124 Class B 125. In carriageways or other locations where vehicles may run over access boxes, heavier grades of cover may be required.

GENERAL

In footways ducting for signal post cables and linking cables must have minimum cover depths of 450mm and 250mm respectively. The minimum depth of cover in carriageways is 600mm.

Subject to local duct specification, ducts should be bedded on 100mm of compacted bedding material. Duct lengths must be continuous and fully jointed, with the printing placed uppermost when laying. Suitable surround material should also be used to fill any voids between multiple ducts and should extend to 100mm above the ducts.

Polypropylene draw cords should be provided in each duct with no knots or joints and should extend a minimum of 1 metre into each access box.

**FOR FURTHER DETAILED INFORMATION AND NBS SPECIFICATION CLAUSES PLEASE CONTACT OUR TECHNICAL OFFICE OR VISIT OUR WEBSITE
WWW.POLYPIPECIVILS.CO.UK**

ACCESS AND POLE BOXES

Ducts are easily connected to the selected entry point. The pre-trepanned section for the size of duct to be used can be cut out with a knife or hole saw. The duct should be inserted through the opening and cut to length.

Boxes that may be subject to traffic loading are typically installed as illustrated