

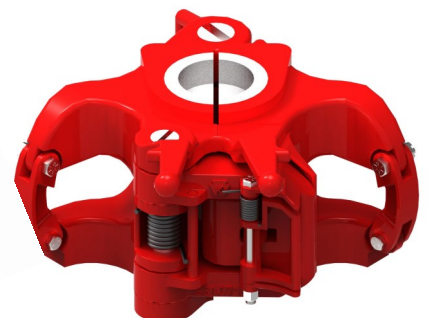

bridge the gap.

PRODUCT CATALOG

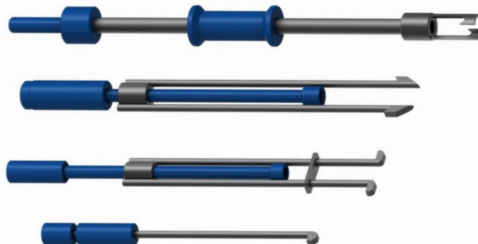
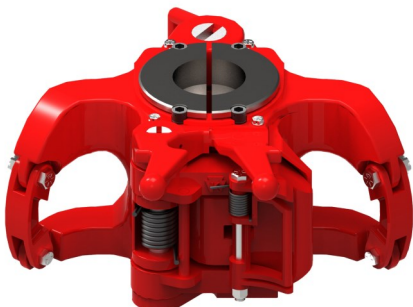
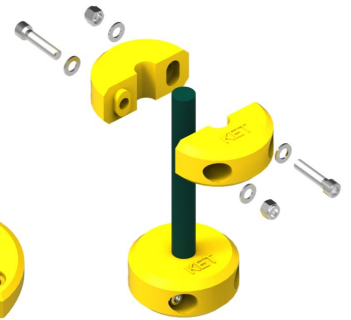
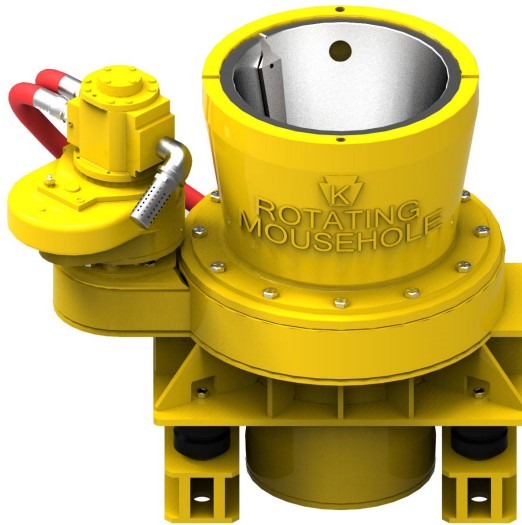
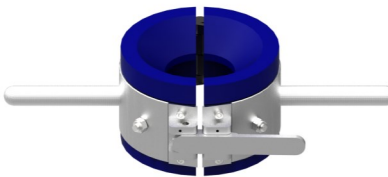
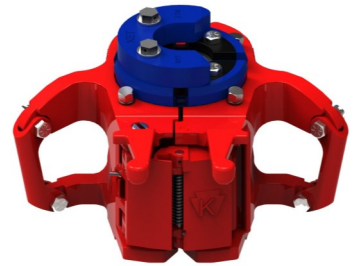
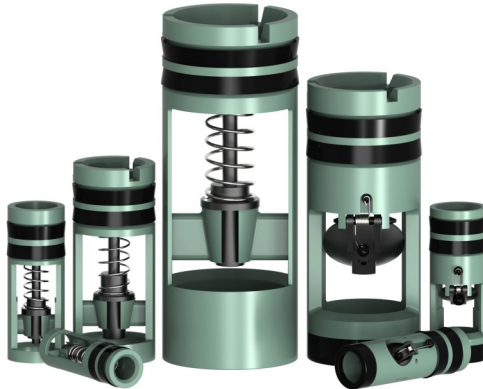
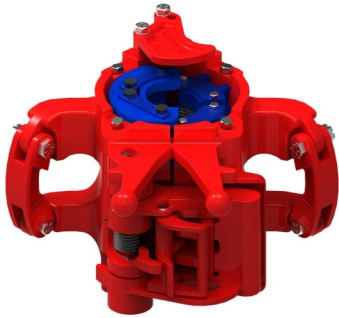

INTENTIONALLY LEFT BLANK

Certificate of Authority to use the Official API Monogram

License Number: 8C-0195

ORIGINAL

The American Petroleum Institute hereby grants to

KEYSTONE ENERGY TOOLS

8404 Hwy 90 West

New Iberia, Louisiana

the right to use the Official API Monogram® on manufactured products under the conditions in the official publications of the American Petroleum Institute entitled API Spec Q1® and API Spec 8C and in accordance with the provisions of the License Agreement.

In all cases where the Official API Monogram is applied, the API Monogram should be used in conjunction with this certificate number: **8C-0195**

The American Petroleum Institute reserves the right to revoke this authorization to use the Official API Monogram for any reason satisfactory to the Board of Directors of the American Petroleum Institute.

The scope of this license includes the following product: Casing, Tubing, Drill Pipe and Drill Collar Elevators at PSL 1 and 2

QMS Exclusions: No Exclusions Identified as Applicable

Effective Date: **AUGUST 23, 2012**

Expiration Date: **AUGUST 23, 2015**

To verify the authenticity of this license, go to www.api.org/compositelist.

American Petroleum Institute

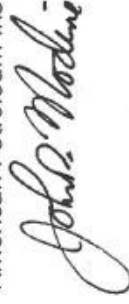

Director of Global Industry Services



®

**American
Petroleum
Institute**



2011-191

INTENTIONALLY LEFT BLANK

TABLE OF CONTENTS

Page Number	
5	About Us
6	Terms and Conditions
7	Float Valve Overview
8	Plunger Type Valves
9	Flapper Type Valves
10	Dimensional Data
11	Tool Joint Specification
12	Bit Sub Information
13	Float Valve Repair Kits
14	Valve Pullers
15-19	Float Valve Ordering Information
20	Baffle Plates
21	Rotating Mousehole
22	Elevator Overview
23	Single Joint Elevator
24-25	MYT Slip Type Elevator
26-27	YT Slip Type Elevator
27-A	MRA Center Latch Elevator
27-B	MG Bottleneck Elevator
27-C	RG Bottleneck Elevator
28	MGG Bottleneck Elevator
29	GG Bottleneck Elevator
30	Bushing Type Elevators
31	Safety Flex Handles
31	Tong Safety Handles
32-35	Safety Clamps
36	Slip Lifting Device
37	Stabbing Guides
38	Tong Blocks
39	Tong Die Drivers
40	Contact Information

INTENTIONALLY LEFT BLANK

ABOUT US



Keystone Energy Tools was established to provide the industry with support and stability from a manufacturer with over fifty years of combined experience in designing, manufacturing, and delivering high-quality oilfield tools. In addition to providing complete in-house **remanufacturing** along with **re-certification**.

With our years of experience of bridging the gap between quality and service, customers and distributors, and performance and economy, Keystone understands the critical requirements of the oil and gas industry, from on-time delivery to competitive pricing and product availability.

By using the latest in 3D modeling for product design and by staying current with the rapid advances in manufacturing technology and quality-assurance standards, Keystone is able to manufacture and produce the most reliable products on the market today.

Our experienced sales team is dedicated, always here to support our customers and distributors and ready to answer any questions that you have regarding our products. We pride ourselves on same-day quotes and expedited shipping.

OUR NAME SAYS IT ALL:

keystone (kē'stōn')

1. the topmost stone of an arch
2. a central cohesive source of stability
3. something on which associated things depend for support

HISTORY:

Keystone was created in 2009 by Joe Ramey, founder of Access Oil Tools, and in 2011 was joined by Ross Darbonne, who contributed over thirty years experience from M&W and Access Oil Tools. Our focus is to build long-term relationships with our customers and distributors and to provide them with quality products and service with one phone call or e-mail.

The float valve product line was established in 2009, and in 2011 our product line was expanded to include **rotating mouse holes, elevators, safety flex handles for slips, safety handles for tongs, ST-80'-s and mud buckets, stabbing guides, tong blocks, and automated slip-lifting devices.**

bridge the gap.

TERMS AND CONDITIONS

QUOTATIONS

All quotations are in US dollars and are F.O.B. Company's point of manufacturing origin, unless otherwise expressly stipulated. Quotations are valid for 30 days unless otherwise stated. Lighterage, wharfage or landing charges, dues, duties, or any other charges at destination are not included in quotations or indicated by list prices unless specifically stipulated. List price and discounts on all products are subject to change without notice. Prices in effect at time of shipment or delivery whether higher or lower will prevail.

TERMS OF PAYMENT

Unless otherwise specifically stated on the invoice, terms of payment are NET THIRTY DAYS following the date of the invoice and are subject to approved credit. Payments are accepted in US dollars only. Boxing, cartage, freight, insurance, and handling are always net. Interest at the maximum rate allowable by applicable law may be charged on past due accounts. Keystone Energy Tools, LLC (K.E.T.) reserves the right to revoke credit and suspend delivery if customer fails to make payment of an invoice when due.

DELIVERY

Our responsibility ceases upon delivery to any common carrier, and we do not, unless previously instructed, insure shipments beyond the point of delivery to such carrier. We make every effort to ship all materials within the time promised by us, but we do not guarantee to do so, and all such promises are subject to delays occasioned by causes beyond reasonable control.

PENALTY CLAUSES

No penalty clause of any description in any specification of an order will be effective unless approved in writing by an officer of K.E.T., LLC.

INSURANCE

We will place insurance as nearly as possible in accordance with our customer's written instructions but do so solely on behalf of our customers and assume no liability for placing, effectiveness, or otherwise in connection with such insurance or in case of breakage, damage or loss.

SHIPPING WEIGHT

All weights listed are approximate net weight only, unless otherwise specified, and do not include boxing. For approximate gross weight add 10% to net weight.

CANCELLATIONS AND RETURNS

Orders for equipment of special design, size, or materials are not subject to cancellation, and all other orders are subject to a cancellation charge after having been accepted by the prescribed company office or authority. Equipment altered or made to customer's specifications is subject to special prices and conditions.

WARRANTY

K.E.T., LLC. warrants goods of our manufacture for 12 months after date of shipment to be free from any defects in material and workmanship under normal use and service when installed, used, and serviced in the manner provided and intended by K.E.T., LLC. K.E.T.'s obligation under this warranty is limited to repair or replacement, at its option, if any products manufactured by K.E.T., LLC. and are returned F.O.B. to our plant and which we determine to be defective

Under no circumstances shall K.E.T., LLC. be liable for any consequential, special, incidental, punitive, or other damages resulting from or caused by any defective materials, products, or supplies, no charge for labor, transportation or other expense involved, to either repair allegedly defective goods outside our plant, or any other charge be allowed.

THIS IS THE SOLE WARRANTY OF K.E.T., LLC. AND NO OTHER WARRANTY IS APPLICABLE, EITHER EXPRESSED OR IMPLIED, INCLUDING ANY WARRANTY AS TO THE MERCHANTABILITY OR FITNESS FOR PARTICULAR USE OR PURPOSE.

FLOAT VALVE OVERVIEW

Valve Body

Keystone valve bodies are manufactured for today's increasingly harsh drilling environment. All valve bodies are cast out of alloy steel and are heat treated to a hardness equal to or less than 22 Rockwell C (≤ 22 Rockwell C 2 HR) to address the corrosive effects of hydrogen-sulfide gas (H_2S). Keystone's integral valve bodies are manufactured from one-piece casting and are not welded together the way some other competitors produce their bodies. This means that you receive a superior and more reliable valve body.

Integral Plunger Valves

All of Keystone's plunger valves are machined from one solid piece of material to produce a more reliable float valve and reduce the risk of down hole valve failure. Other leading manufacturers use two separate pieces of material to construct their plungers, which are invariably either shrunk fit, screwed, or welded together.

Flapper Valves

All Keystone standard-service flapper valves are made of low-alloy steel and then case hardened for wear resistance, thus giving a longer operating life.

Elastomers

Available elastomers are nitrile butadiene (NBR, Buna-N) and Viton® (fluoroelastomer, FKM).

Springs

Inconel® or stainless steel springs come standard on all our valves. These springs are good for sour gas (H_2S) applications and are significantly more resistant to corrosion when compared with the standard-service springs provided by most other manufacturers.

Interchangeability

All Keystone drill-pipe float valves and replacement parts are manufactured to standard industry dimensions and are interchangeable with other major manufacturers' parts.

Sour-Gas (H_2S) Service

Available in both F and G models.

The information contained in this catalog is not intended to be used as an operational guide. It is intended to provide a product and usage overview.

bridge the gap.

PLUNGER-TYPE VALVES

337-365-4411

sales@k-e-t.com

MODEL

F

PLUNGER TYPE-STANDARD

The Model F is a plunger-type float valve that provides a positive instantaneous shut off, providing constant fluid control while drilling. The Model F is a reliable and economical selection under standard drilling operations

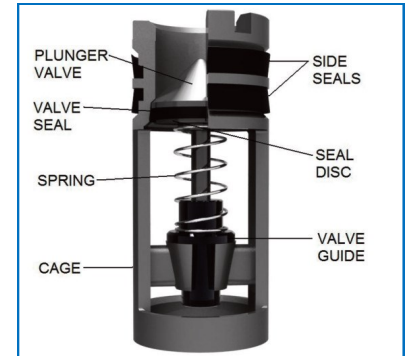

MODEL

FC

PLUNGER TYPE-AUTOMATIC FILL

The Model FC Automatic-Fill plunger-type float valve incorporates a unique key assembly and slotted valve stem to hold the plunger open during run in of the drill pipe and allows the pipe to fill from the bottom, saving time, reducing mess, and avoiding hazards. The plunger is automatically

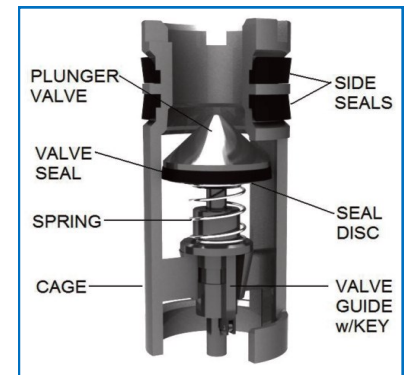

MODEL

FA

PLUNGER TYPE-PRESSURE MONITORING

The Model FA Pressure-Monitoring plunger-type float valve has a special port running through the plunger of the float valve. This valve is used when monitoring the bit head for gas pressure and allowing differential pressure measuring when required. The port also permits partial automatic fill during run in.

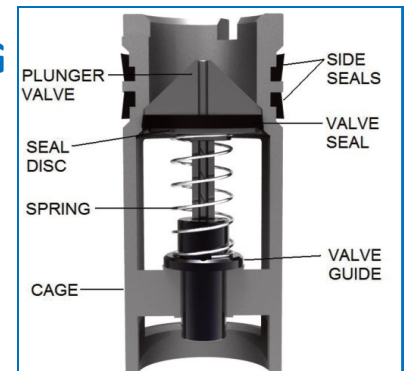

FLOAT VALVE INSTALLATION: Simply lubricate the side seals and slide the float valve into the cavity of the float sub or the bored-out drill collar. Caution: fill drill pipe regularly when going in the hole. Failure to do this can cause damage to the drill pipe and float valve.

FLAPPER-TYPE VALVES

337-365-4411

sales@k-e-t.com

MODEL

G

FLAPPER TYPE-STANDARD

The Model G is a flapper-type float valve that, when opened, offers an unobstructed bore through the float valve. The uniquely designed flapper closes rapidly to prevent shavings from entering the drill string when circulation stops and also assists primary BOP equipment in maintaining internal pressure control. The valve will fully open when the first joint is raised from the hole, preventing pulling wet joints.

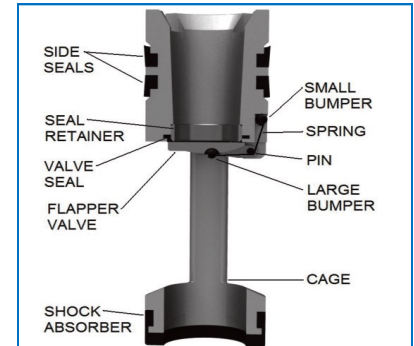

MODEL

GA

FLAPPER TYPE-PRESSURE MONITORING

The Model GA Pressure-Monitoring flapper-type float valve is indistinguishable from the Model G with the exception of a tungsten-carbide insert in the flapper valve. The insert has a quarter-inch orifice through the center that allows for differential pressure monitoring. The orifice also allows for partial automatic filling of the drill pipe during run in.

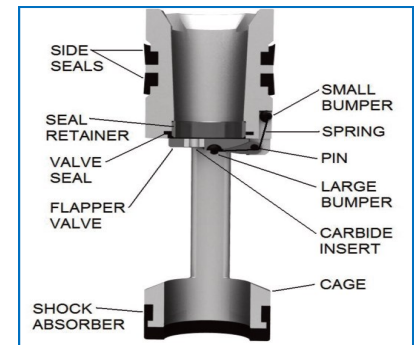

MODEL

GC

FLAPPER TYPE-AUTOMATIC FILL

The Model GC Automatic-Fill flapper-type float valve incorporates a unique self-releasing key assembly that holds the flapper partially open during run in, allowing the pipe to fill from the bottom. This eliminates the need for filling the drill pipe from the top, saving time and money. The valve will fully open when the first joint is raised from the hole, preventing pulling wet joints while avoiding the environmental and safety risks related to having mud on the rig floor. The valve can be run with the automatic-fill option or in the standard, closed position.

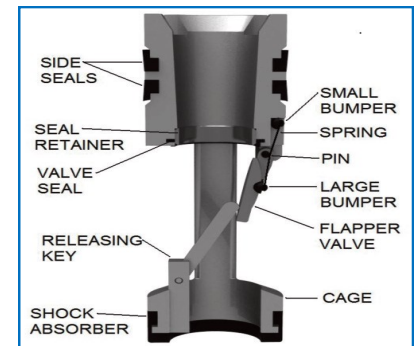

MODEL

GCA

FLAPPER TYPE-AUTO FILL PRESSURE MONITORING

The Model GCA Automatic-Fill/Pressure-Monitoring flapper-type float valve includes all the advantages of the Models G, GC, and GA. An unobstructed bore through the float valve, when open, permits automatic partial filling of the drill pipe from the bottom and measuring differential pressures when necessary.

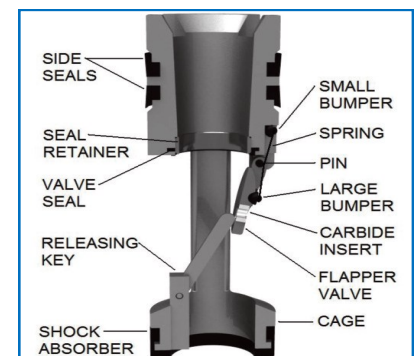

bridge the gap.

DIMENSIONAL DATA

337-365-4411

sales@k-e-t.com

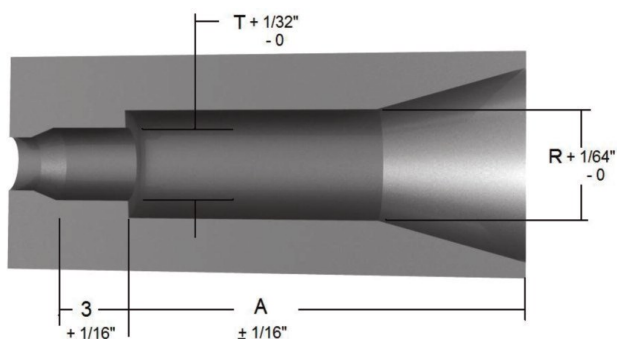
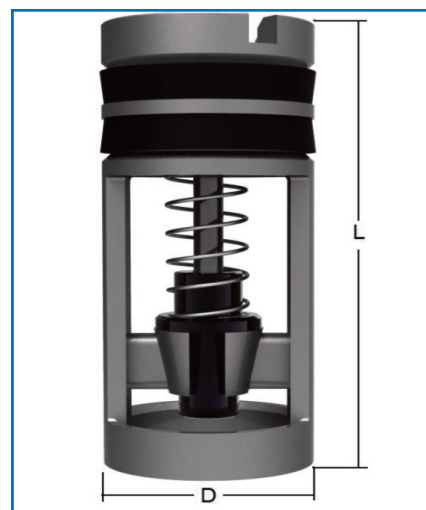
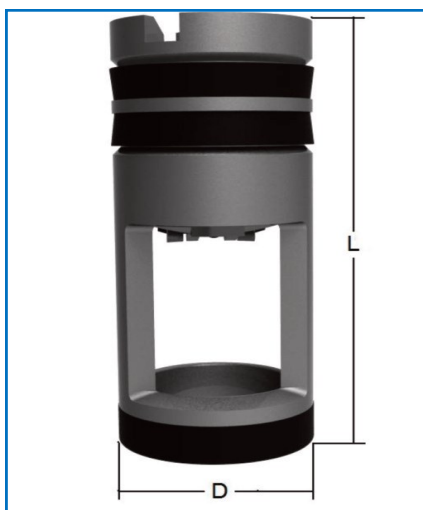

$A = L$ (Length of Float Valve) + Length of Tool Joint Pin + 1/4" Clearance

Valve Size	D Diameter of Valve	R ($D + 1/32"$) Diameter Recess F/ Valve	L Valve Length	T* Baffle Plate Recess Diameter	Valve I.D. Model F	Valve I.D. Model G
1R	1-21/32"	1-11/16"	5-7/8"	1-5/16"	1"	N/A
1R-2R	1-29/32"	1-15/16"	6-1/4"	1-1/2"	1-1/4"	1"
2F-3R	2-13/32"	2-7/16"	6-1/2"	1-29/32"	1-9/16"	1-1/4"
3F	2-13/16"	2-27/32"	10"	2-7/16"	1-7/8"	1-5/8"
3.5IF	3-1/8"	3-5/32"	10"	2-11/16"	1-7/8"	1-5/8"
4R	3-15/32"	3-1/2"	8-5/16"	2-15/16"	2-5/16"	1-31/32"
4F	3-21/32"	3-11/16"	12"	3-1/4"	2-1/2"	2-3/16"
5R	3-7/8"	2-29/32"	9-3/4"	3-3/8"	2-3/4"	2-1/4"
5F-6R	4-25/32"	4-13/16"	11-3/4"	4-9/32"	3-1/4"	2-7/8"
6F	5-11/16"	5-23/32"	14-5/8"	5-3/16"	4-1/8"	N/A

* Disregard if this diameter is the same or smaller than the standard tool joint I.D.

bridge the gap.

TOOL JOINT SPECIFICATION

337-365-4411

sales@k-e-t.com

TOOL JOINT TYPES	MODEL SIZES									
	1R	1F-2R	2F-3R	3F	3.5IF	4R	4F	5R	5F-6R	6F
API REGULAR	2-3/8"	2-7/8"	3-1/2"			4-1/2"		5-1/2" 5-9/16"*	6-5/8" 7-5/8"†	8-5/8"
HUGHES OR REED ACME	2-3/8"	2-7/8"	3-1/2"			4-1/2"		5-1/2" 5-9/16"	6-5/8"	
UNION TOOL	2-3/8"	2-7/8" 3-1/2"					4-1/2"	5-1/2" 5-9/16"*	6-5/8"†	
HUGHES OR REED DOUBLE STREAM-LINE		2-7/8" 2-3/8"	3-1/2"	4" 4-1/2"			5"	5-1/2" 5-9/16"*		
API FULL HOLE		2-3/8"	2-7/8"	3-1/2"	4"	4-1/2"	4-1/2"*			6-5/8"*
REED ACME FULL HOLE				3-1/2"*			4-1/2"*		5-1/2" 5-9/16"*	
HUGHES ACME STREAMLINE		2-3/8"	2-7/8"	3-1/2" *			4-1/2"*		5-1/2" 5-9/16"*	
HUGHES XTRA HOLE			2-7/8"	3-1/2"			4-1/2"	5"	5-1/2" 5-9/16"*	
REED SEMI-INTERNAL FLUSH			2-7/8"	3-1/2"			4-1/2"	5"		
API INTERNAL FLUSH		2-3/8"	2-7/8"		3-1/2"		4"	4-1/2"*		
HYDRIL TYPE IF(INT .FLUSH EXT. UP-SET)		2-3/8"*	2-7/8"*	3-1/2"*				4-1/2"	5"	
HYDRIL EIU (EXT. INT. UPSET)				3-1/2"		4"	4-1/2"		5-1/2" 5-9/16"*	6-5/8"
HYDRIL TYPE F (EXT. FLUSH)	2-7/8" 3-1/2"*			4-1/2" 5"		5-1/2" 5-9/16"		6-5/8"		
HUGHES EXT. FLUSH ACME		3-1/2"	4-1/2"			5-1/2" 5-9/16"		6-5/8"		
HUGHES EXT. FLUSH FULL HOLE				4-1/2"						

* Indicates that the float subs id these sizes have a smaller ID. † Indicates interchangeability. Models G and GA, are available in sizes

1F-2R thru 5F-6R. Models GC and GCA are available in sizes 2F-3R thru 5F-6R. Models F and FA are available in all sizes. Model FC is available in sizes 2F-3R thru 6F.

BIT & SHANK SIZES

Bit Size (in.)	3-1/4	3-3/8	4-1/2	4-3/4	5-1/2	6	6-1/8	6-1/4	6-1/2	6-3/4	7-1/8	8-1/4	8-1/2	8-3/4	9-1/2	9-3/4	10-1/2	11	12-1/4	13-1/2	20	24	25
Std. API Pin Shank Size (in.)	2-3/8	2-3/8	2-3/8	2-7/8	3-1/2	3-1/2	3-1/2	3-1/2	3-1/2	3-1/2	4-1/2	4-1/2	4-1/2	4-1/2	6-5/8	6-5/8	6-5/8	6-5/8	6-5/8	6-5/8	7-5/8	7-5/8	7-5/8

bridge the gap.

BIT SUB INFORMATION

337-365-4411

sales@k-e-t.com

VALVE SIZE	THREAD SIZE	TOOL JOINT TYPE	STANDARD OD	FACE TO SHOULDER OR FACE TO FACE
1R	2-3/8"	API REGULAR	3-1/8"	18"
1F-2R	2-7/8"		3-3/4"	20"
2F-3R	3-1/2"		4-1/4"	20"
4R	4-1/2"		5-1/2"	24"
5R	5-1/2"		6-3/4"	28"
5F-6R	6-5/8"		7-3/4"	30"
5F-6R	7-5/8"		8-7/8"	30"
6F	8-5/8"		10"	30"
3F	3-1/2"	API FULL HOLE	4-5/8"	24"
3.5 IF	4"		5-1/4"	24"
4F	4-1/2"		5-3/4"	28"
5F-6R	5-1/2"		7"	30"
6F	6-5/8"		8"	30"
1F-2R	2-3/8"	API IF	3-3/8"	18"
2F-3R	2-7/8"	API IF BOX X PIN	4-1/8"	20"
3.5 IF	3-1/2"	API IF	4-3/4"	24"
4F	4"		5-3/4"	28"
5R	4-1/2"		6-3/8"	28"
5F-6R	5-1/2"		7-3/8"	30"
6F	6-5/8"		8-3/4"	30"

The information guide above is for reference purposes only. Please use appropriate API specifications when manufacturing these subs.

bridge the gap.

FLOAT VALVE REPAIR KITS

337-365-4411

sales@k-e-t.com

MODEL

F

MODEL

FC

RUBBER REPAIR KIT F

MODEL

FA



MODEL

F

MODEL

FC

METAL REPAIR KIT F

MODEL

FA

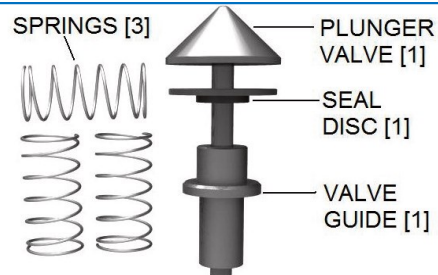

MODEL

G

MODEL

GA

RUBBER REPAIR KIT G

MODEL

GC

MODEL

GCA

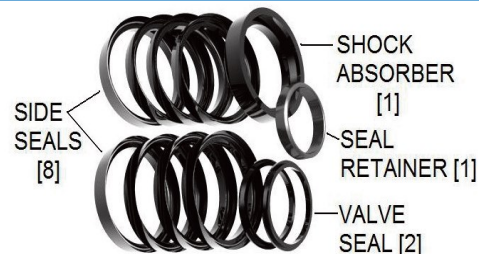

MODEL

G

MODEL

GA

METAL REPAIR KIT G

MODEL

GC

MODEL

GCA



bridge the gap.

VALVE PULLERS

337-365-4411

sales@k-e-t.com

MODEL

F

MODEL

FC

MODEL

FA

MODEL F (TOP) PULLER

The model F valve (top) puller is designed to remove float valves from the top of the sub. Simply squeeze the forks together and press against the head of the valve plunger. Once the forks are engaged with the cage the valve can be pulled. Disengage by sliding the separator away from the valve and squeezing the forks together and the puller can be removed.



MODEL

F

MODEL

FC

MODEL

FA

MODEL F (BOTTOM) PULLER

The Model F Valve Puller makes easy work of removing stuck or tight float valves from the sub or drill collar. Simply engage the special catch into the bottom of the float valve, rotate 90°, and then simply slide the bumper into the stop and the float valve is removed.

Note: when using the puller to remove a Model FC valve, special care must be taken when engaging the catch so that it does not make contact with the releasing key.



MODEL

G

MODEL

GA

MODEL

GC

MODEL

GCA

MODEL G PULLER

The Model G Valve Puller is dual-purpose tool. In addition to removing tight or stuck float valves from subs or drill collars, it assists in removing and installing the seal-retaining ring when changing out the valve seal.



bridge the gap.

STANDARD SERVICE VALVES

337-365-4411

sales@k-e-t.com

MODEL **F** PLUNGER TYPE

SIZE	ASSEMBLY	WEIGHT (lbs)	METAL REPAIR KIT	WEIGHT (lbs)	RUBBER REPAIR KIT	WEIGHT (lbs)	TOP PULLER ASSEMBLY	WEIGHT (lbs)	BOTTOM PULLER ASSEMBLY	WEIGHT (lbs)
1R	480131200	1.5	15929800	1.0	16012200	0.5	N/A	N/A	911200	6.0
1F-2R	480131422	1.5	16011300	2.0	16012300	0.7	N/A	N/A	911200	6.0
2F-3R	480132432	2.5	16011400	2.0	16012400	0.8	933600	8.0	912432	8.0
3F	480133400	5.0	16011500	2.0	16012500	1.0	933600	10.0	913400	10.0
3.5 IF	480133600	5.0	16011500	2.0	16012600	1.0	933600	10.0	913400	10.0
4R	480134200	7.0	16011700	2.0	16012700	1.0	934200	12.0	914200	12.0
4F	480134400	9.5	16011800	3.0	16012800	1.0	934210	13.0	914400	13.0
5R	480135200	9.5	16011900	4.0	16012900	1.0	934225	15.0	914400	15.0
5F-6R	480135462	16.0	16012000	5.0	16013000	1.1	934250	19.0	914400	19.0
6F	480136400	28.0	16012100	5.0	16013100	2.0	934265	21.0	916400	21.0

MODEL **FC** PLUNGER TYPE-AUTOMATIC FILL

SIZE	ASSEMBLY	WEIGHT (lbs)	METAL REPAIR KIT	WEIGHT (lbs)	RUBBER REPAIR KIT	WEIGHT (lbs)	TOP PULLER ASSEMBLY	WEIGHT (lbs)	BOTTOM PULLER ASSEMBLY	WEIGHT (lbs)
2F-3R	480182432	2.5	70017100	2.0	16012400	0.8	933600	8.0	912432	8.0
3F	480183400	5.0	70017300	2.0	16012500	1.0	933600	10.0	913400	10.0
3.5 IF	480183600	5.0	70017300	2.0	16012600	1.0	933600	10.0	913400	10.0
4R	480184200	7.0	70017400	2.0	16012700	1.0	934200	12.0	914200	12.0
4F	480184400	9.5	70017500	3.0	16012800	1.0	934210	13.0	914400	13.0
5R	480185200	9.5	70017600	4.0	16012900	1.0	934225	15.0	914400	15.0
5F-6R	480185462	16.0	70017700	5.0	16013000	1.1	934250	19.0	914400	19.0
6F	480186400	28.0	70017800	5.0	16013100	2.0	934265	21.0	916400	21.0

MODEL **FA** PLUNGER TYPE-PRESSURE MONITORING

SIZE	ASSEMBLY	WEIGHT (lbs)	METAL REPAIR KIT	WEIGHT (lbs)	RUBBER REPAIR KIT	WEIGHT (lbs)	TOP PULLER ASSEMBLY	WEIGHT (lbs)	BOTTOM PULLER ASSEMBLY	WEIGHT (lbs)
1R	480121200	1.5	15929805	1.0	16012200	0.1	N/A	N/A	911200	6.0
1F-2R	480121422	1.5	16011305	1.0	16012300	0.1	N/A	N/A	911200	6.0
2F-3R	480122432	2.5	16011405	2.0	16012400	0.8	933600	8.0	912432	8.0
3F	480123400	5.0	16011505	2.0	16012500	1.0	933600	10.0	913400	10.0
3.5 IF	480123600	5.0	16011505	2.0	16012600	1.0	933600	10.0	913400	10.0
4R	480124200	7.0	16011705	2.0	16012700	1.0	934200	12.0	914200	12.0
4F	480124400	9.5	16011805	2.0	16012800	1.0	934210	13.0	914400	13.0
5R	480125200	9.5	16011905	3.5	16012900	1.0	934225	15.0	914400	15.0
5F-6R	480125462	16.0	16012005	5.0	16013000	1.1	934250	19.0	914400	19.0
6F	480126400	28.0	16012105	5.0	16013100	1.2	934265	21.0	916400	21.0

bridge the gap.

STANDARD SERVICE VALVES

337-365-4411

sales@k-e-t.com

MODEL **G** FLAPPER TYPE

SIZE	ASSEMBLY	WEIGHT (lbs)	METAL REPAIR KIT	WEIGHT (lbs)	RUBBER REPAIR KIT	WEIGHT (lbs)	PULLER ASSEMBLY	WEIGHT (lbs)
1F-2R	480151422	2.0	51988400	0.7	51988300	0.5	901422	N/A
2F-3R	480152432	3.5	16013200	0.8	16013800	0.6	902432	8.0
3F	480153400	5.0	16013300	1.0	16013900	1.0	903400	10.0
3.5 IF	480153600	5.5	16013300	1.0	51982000	1.0	903400	10.0
4R	480154200	7.0	16013400	1.1	16014000	1.5	904200	12.0
4F	480154400	8.0	16013500	1.4	16014100	1.6	904400	13.0
5R	480155200	9.0	16013600	1.6	16014200	1.6	905200	15.0
5F-6R	480155462	18.0	16013700	1.8	16014300	2.0	905462	19.0

MODEL **GA** FLAPPER TYPE-PRESSURE MONITORING

SIZE	ASSEMBLY	WEIGHT (lbs)	METAL REPAIR KIT	WEIGHT (lbs)	RUBBER REPAIR KIT	WEIGHT (lbs)	PULLER ASSEMBLY	WEIGHT (lbs)
1F-2R	480161422	2.0	52070800	0.7	51988300	0.5	901422	7.0
2F-3R	480162432	3.5	17135000	0.8	16013800	0.6	902432	8.0
3F	480163400	5.0	17136700	1.0	16013900	1.0	903400	10.0
3.5 IF	480163600	5.5	17136700	1.0	51982000	1.0	903400	10.0
4R	480164200	7.0	17116000	1.1	16014000	1.5	904200	12.0
4F	480164400	8.0	17136800	1.4	16014100	1.6	904400	13.0
5R	480165200	9.0	17136900	1.6	16014200	1.6	905200	15.0
5F-6R	480165462	18.0	17134200	1.8	16014300	2.0	905462	19.0

MODEL **GC** FLAPPER TYPE-AUTOMATIC FILL

SIZE	ASSEMBLY	WEIGHT (lbs)	METAL REPAIR KIT	WEIGHT (lbs)	RUBBER REPAIR KIT	WEIGHT (lbs)	PULLER ASSEMBLY	WEIGHT (lbs)
2F-3R	480192432	3.5	16013200	0.8	16013800	0.6	902432	8.0
3F	480193400	5.0	16013300	1.0	16013900	1.0	903400	10.0
3.5 IF	480193600	5.5	16013300	1.0	51982000	1.0	903400	10.0
4R	480194200	7.0	16013400	1.1	16014000	1.5	904200	12.0
4F	480194400	8.0	16013500	1.4	16014100	1.6	904400	13.0
5R	480195200	9.0	16013600	1.6	16014200	1.6	905200	15.0
5F-6R	480195462	18.0	16013700	1.8	16014300	2.0	905462	19.0

bridge the gap.

STANDARD SERVICE VALVES

337-365-4411

sales@k-e-t.com

MODEL **GCA**

FLAPPER TYPE-AUTO FILL-PRESSURE MONITORING

SIZE	ASSEMBLY	WEIGHT (lbs)	METAL REPAIR KIT	WEIGHT (lbs)	RUBBER REPAIR KIT	WEIGHT (lbs)	PULLER ASSEMBLY	WEIGHT (lbs)
2F-3R	480192433	3.5	17135000	0.8	16013800	0.6	902432	8.0
3F	480193401	5.0	17136700	1.0	16013900	1.0	903400	10.0
3.5 IF	480193601	5.5	17136700	1.0	51982000	1.0	903400	10.0
4R	480194201	7.0	17116000	1.1	16014000	1.5	904200	12.0
4F	480194401	8.0	17136800	1.4	16014100	1.6	904400	13.0
5R	480195201	9.0	17136900	1.6	16014200	1.6	905200	15.0
5F-6R	480195463	18.0	17134200	1.8	16014300	2.0	905462	19.0

H₂S/HIGH TEMP SERVICE VALVES

337-365-4411

sales@k-e-t.com

MODEL **F**

PLUNGER TYPE

SIZE	ASSEMBLY	WEIGHT (lbs)	METAL REPAIR KIT	WEIGHT (lbs)	RUBBER REPAIR KIT	WEIGHT (lbs)	TOP PULLER ASSEMBLY	WEIGHT (lbs)	BOTTOM PULLER ASSEMBLY	WEIGHT (lbs)
1R	480301200	1.5	15929800	1.0	71081701	0.5	N/A	N/A	911200	6.0
1F-2R	480301422	1.5	16011300	2.0	71081801	0.7	N/A	N/A	911200	6.0
2F-3R	480302432	2.5	16011400	2.0	71081901	0.8	933600	8.0	912432	8.0
3F	480303400	5.0	16011500	2.0	71082001	1.0	933600	10.0	913400	10.0
3.5 IF	480303600	5.0	16011500	2.0	71082101	1.0	933600	10.0	913400	10.0
4R	480304200	7.0	16011700	2.0	71082201	1.0	934200	12.0	914200	12.0
4F	480304400	9.5	16011800	3.0	71082301	1.0	934210	13.0	914400	13.0
5R	480305200	9.5	16011900	4.0	71082401	1.0	934225	15.0	914400	15.0
5F-6R	480305462	16.0	16012000	5.0	71082501	1.1	934250	19.0	914400	19.0
6F	480306400	28.0	16012100	5.0	71082601	2.0	934265	21.0	916400	21.0

MODEL **FA**

PLUNGER TYPE-PRESSURE MONITORING

SIZE	ASSEMBLY	WEIGHT (lbs)	METAL REPAIR KIT	WEIGHT (lbs)	RUBBER REPAIR KIT	WEIGHT (lbs)	TOP PULLER ASSEMBLY	WEIGHT (lbs)	BOTTOM PULLER ASSEMBLY	WEIGHT (lbs)
2F-3R	480352432	2.5	16011405	2.0	71081901	0.8	933600	8.0	912432	8.0
3F	480353400	5.0	16011505	2.0	71082001	1.0	933600	10.0	913400	10.0
3.5 IF	480353600	5.0	16011505	2.0	71082101	1.0	933600	10.0	913400	10.0
4R	480354200	7.0	16011705	2.0	71082201	1.0	934200	12.0	914200	12.0
5F-6R	480355462	16.0	16012005	5.0	71082501	1.1	934250	19.0	914400	19.0

bridge the gap.

H₂S/HIGH TEMP SERVICE VALVES

337-365-4411

sales@k-e-t.com

MODEL **G**

FLAPPER TYPE

SIZE	ASSEMBLY	WEIGHT (lbs)	METAL REPAIR KIT	WEIGHT (lbs)	RUBBER REPAIR KIT	WEIGHT (lbs)	PULLER ASSEMBLY	WEIGHT (lbs)
1F-2R	480311422	2.0	51997300	0.7	51997200	0.5	901422	N/A
2F-3R	480312432	3.5	71085901	0.8	71082701	0.6	902432	8.0
3F	480313400	5.0	71086001	1.0	71082801	1.0	903400	10.0
3.5 IF	480313600	5.5	71086001	1.0	52125001	1.0	903400	10.0
4R	480314200	7.0	71086101	1.1	71082901	1.5	904200	12.0
4F	480314400	8.0	71086201	1.4	71083001	1.6	904400	13.0
5R	480315200	9.0	71086301	1.6	71083101	1.6	905200	15.0
5F-6R	480315462	18.0	71086401	1.8	71083201	2.0	905462	19.0

MODEL **GA**

FLAPPER TYPE-PRESSURE MONITORING

SIZE	ASSEMBLY	WEIGHT (lbs)	METAL REPAIR KIT	WEIGHT (lbs)	RUBBER REPAIR KIT	WEIGHT (lbs)	PULLER ASSEMBLY	WEIGHT (lbs)
1F-2R	480261422	2.0	52070801	0.7	51997200	0.5	901422	7.0
2F-3R	480262432	3.5	17135001	0.8	71082701	0.6	902432	8.0
3F	480263400	5.0	17136701	1.0	71082801	1.0	903400	10.0
3.5 IF	480263600	5.0	17136701	1.0	52125001	1.0	903400	10.0
4R	480264200	7.0	17116001	1.1	71082901	1.5	904200	12.0
4F	480264400	8.0	17136801	1.4	71083001	1.6	904400	13.0
5R	480265200	9.0	17136901	1.6	71083101	1.6	905200	15.0
5F-6R	480265462	12.0	17134201	1.8	71083201	2.0	905462	19.0

MODEL **GC**

FLAPPER TYPE-AUTOMATIC FILL

SIZE	ASSEMBLY	WEIGHT (lbs)	METAL REPAIR KIT	WEIGHT (lbs)	RUBBER REPAIR KIT	WEIGHT (lbs)	PULLER ASSEM- BLY	WEIGHT (lbs)
1F-2R	480332432	2.0	51997300	0.8	51997200	0.5	901422	7
2F-3R	480152432	3.5	71085901	0.8	71082701	0.6	902432	8.0
3F	480153400	5.0	71086001	1.0	71082801	1.0	903400	10.0
3.5 IF	480153600	5.0	71086001	1.0	52125001	1.0	903400	10.0
4R	480154200	7.0	71086101	1.1	71082901	1.5	904200	12.0
4F	480154400	8.0	71086201	1.4	71083001	1.6	904400	13.0
5R	480155200	9.0	71086301	1.6	71083101	1.6	905200	15.0
5F-6R	480155462	12.0	71086401	1.8	71083201	2.0	905462	19.0

bridge the gap.

BAFFLE PLATES

337-365-4411

sales@k-e-t.com

BAFFLE PLATES

Baffle plates can be placed on top of the drill-pipe float valve or the drill bit too help prevent damage from recorders or other wire-line tools that are dropped down the string.

BAFFLE PLATES

RING AND SPIDER TYPE



RING TYPE



SPIDER TYPE

PART NUMBER	CONNECTION TYPE/SIZE	DPFV SIZE	TYPE	WEIGHT (lbs)	BAFFLE PLATE OD
K-91701 **	2-7/8"API REG	1F-2R	SPIDER	0.5	1.94
K-91702 **	3-1/2"API REG	2F-3R	RING	0.4	2.28
K-91703 **	4-1/2"API REG	4R	RING	0.8	3.22
K-91704 **	5-9/16"API REG	5R	RING	1.3	3.87
K-91705 **	6-5/8"API REG	5F-6R	RING	1.5	4.63
K-91706 **	7-5/8"API REG	5F-6R	RING	1.7	5.33
K-91707 **	8-5/8"API REG	6F	RING	2.2	6.18
K-91711 ***	REPLACED BY K-91721	3F	SPIDER	0.6	2.75
K-91712 ***	4-1/2"API FH	4F	RING	0.9	3.36
K-91713 ***	5-9/16"API FH	5F-6R	RING	1.5	4.63
K-91714 **	6-5/8"API FH	6F	RING	2.2	5.45
K-91721 *	3-1/2"API FH	3F	SPIDER	0.6	2.63
K-91722*	4-1/2" API FH 4-1/2" API REG 5-9/16" API REG	4F 4R 5R	SPIDER	0.7	3.44
K-91723*	5-9/16" FH 6-5/8" FH	5F-6R 5F-6R	SPIDER	1.0	4.68
K-91724 *	6-5/8"API FH	6F	SPIDER	1.0	6.56
K-91725 *	3-1/2"API IF	3.5IF	SPIDER	0.6	3.06
K-91726 *	REPLACED BY K-91722	5R	SPIDER	0.8	3.76
K-91741 ***	3-1/2"API IF	3.5IF	RING	0.7	3.06
K-91742 ***	4-1/2"API IF	5R	RING	1.6	4.22
K-91743 ***	2-7/8"API IF	2F-3R	SPIDER	0.7	2.44
K-91744 ***	4"API IF / 4-1/2"XH	4F	RING	1.0	3.88

* For use on float. **For use on bit. ***For use in joint.

bridge the gap.

KET ROTATING MOUSEHOLE

337-365-4411

sales@k-e-t.com

ROTATING MOUSEHOLE

The Rotating Mousehole allows the drilling crew to quickly and efficiently build stands simultaneously while drilling ahead with the top drive. By utilizing pre-assembled stands connection time is reduced by as much as 66%.

- ▶ Available in pneumatic or hydraulic
- ▶ Installs flush with the rig floor
- ▶ Rotates tubulars below the rig floor

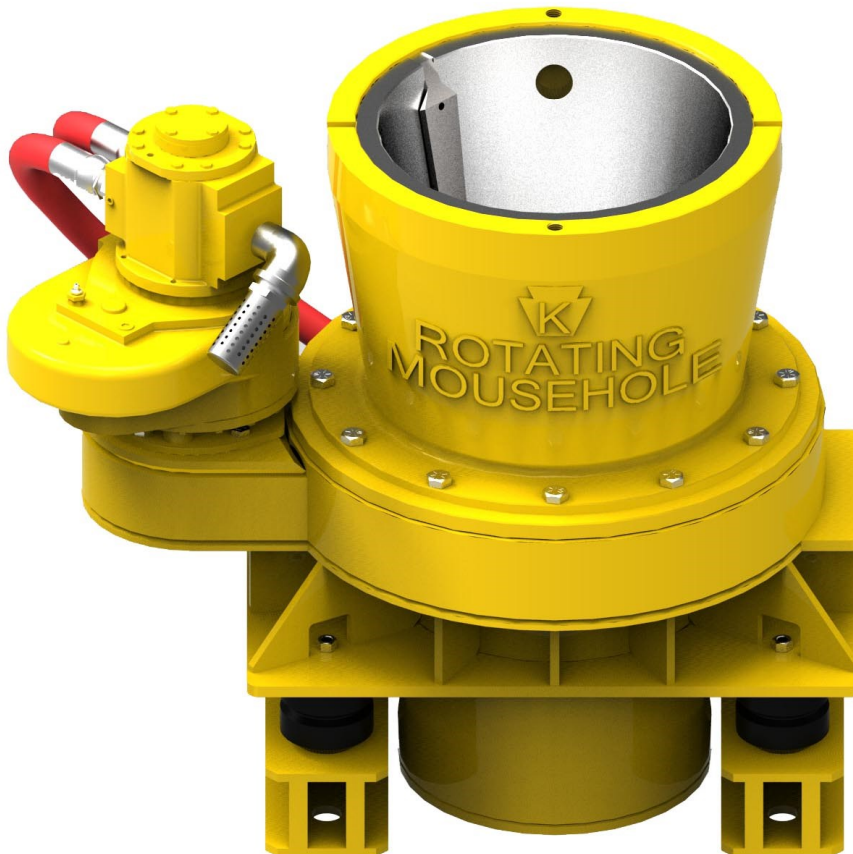

ELEVATOR OVERVIEW

CASTINGS

Keystone elevators are made in the USA and are built to meet or exceed API specification 8C requirements. All elevators are made using high-alloy heat treated steel.

DOCUMENTATION

Every elevator comes with complete certification including an operations manual outlining safety instructions, operation, maintenance, critical area drawings and repair. A documentation package containing inspection of material specs, hardness, proof of load test, magnetic particle examination and dimensional inspection is also included.

SAFETY FEATURES

All Keystone elevators incorporate a safety latch lock mechanism to prevent accidental opening of the elevator. Keystone Safety Latches are readily available and can be replaced in the field without the inconvenience of having to send the whole elevator in to the repair center.

bridge the gap.

KET SINGLE JOINT ELEVATOR

337-365-4411

sales@k-e-t.com

PART NUMBER	RANGE	WEIGHT
E20030	3-1/2"-5-7/8"	67.00

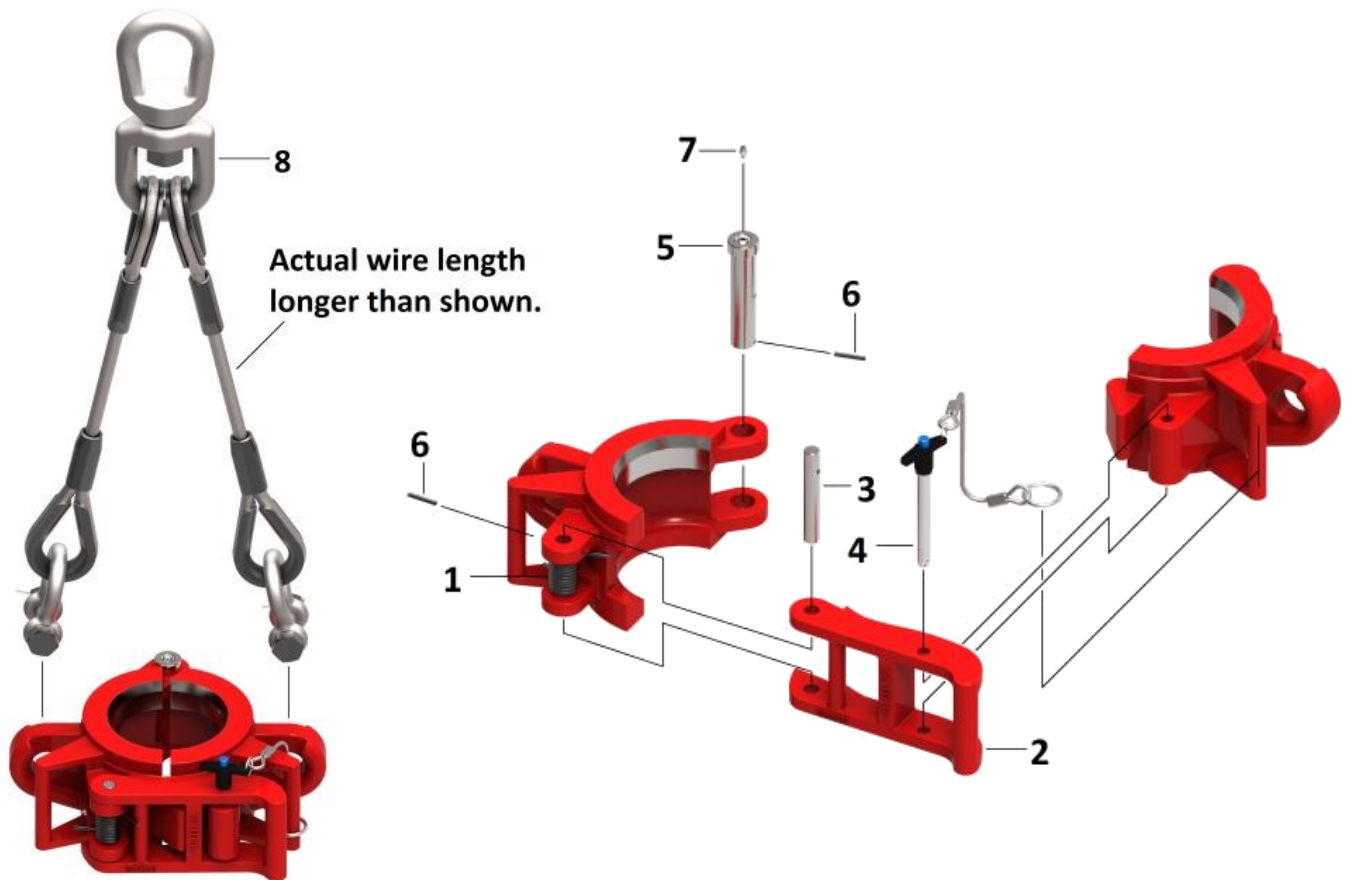

REPLACEMENT PARTS FOR SINGLE JOINT ELEVATORS

ITEM	QTY	PART No.	DESCRIPTION	SPARES	WIEGHT (lbs.)
1	1	E39-034	LATCH SPRING	2	0.20
2	1	E20026-C	LATCH		6.00
3	1	E39-050	LATCH PIN	1	0.37
4	1	E39-051-8	LATCH LOCK PIN ASSEMBLY	1	0.35
5	1	E39-052	SINGLE JOINT HINGE PN	1	1.10
6	2	P316RP	1-1/4" X 3/16" ROLL PIN		0.10
7	1	N/A	GREASE ZERT		0.10
8	1	E34568	SJ SWIVEL SUSPENSION ASSEMBLY	1	29.00

KET MYT (40 TON) SLIP TYPE ELEVATOR

337-365-4411

sales@k-e-t.com

PART NUMBER	RANGE	SIZE OF LINKS	WEIGHT
E29328	3/4" - 2-7/8"	1-1/4" - 2-3/4"	148.00

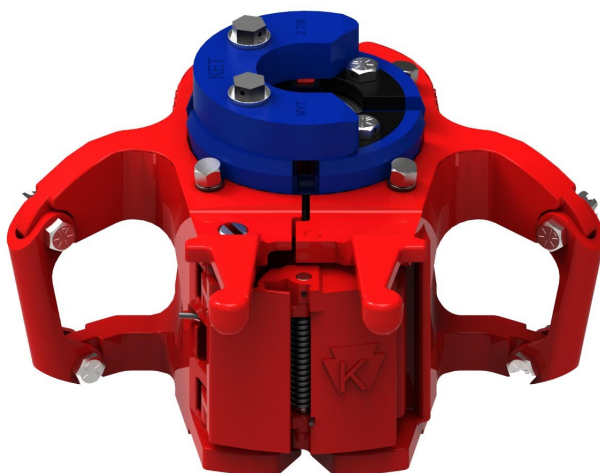

MYT SLIP ASSEMBLIES

PART NO.	DESCRIPTION	WEIGHT (lbs.)
E29343-1	2-7/8" X 2-7/8" MYT SLIP ASSEMBLY	44.00
E29343-2	2-7/8" X 2-3/8" MYT SLIP ASSEMBLY	46.00
E29343-3	2-7/8" X 2-1/16" MYT SLIP ASSEMBLY	47.25
E29343-4	2-7/8" X 2" MYT SLIP ASSEMBLY	47.50
E29343-5	2-7/8" X 1-1/2" (1.900") MYT SLIP ASSEMBLY	48.75
E29343-6	2-7/8" X 1-1/4" (1.660") MYT SLIP ASSEMBLY	49.75
E29343-7	2-7/8" X 1" (1.315") MYT SLIP ASSEMBLY	49.75
E29343-8	2-7/8" X 3/4" (1.050") MYT SLIP ASSEMBLY	51.00
E29343--S	2-7/8" MYT SLIP SEGMENTS ONLY(MATCHED SET OF 4)	31.00

MYT SETTING RINGS

ITEM	PART NO.	DESCRIPTION	WEIGHT (lbs.)
28	E29348	2-7/8" MYT SETTING RING	6.50
28	E29345	2-3/8" MYT SETTING RING	6.63
28	E29350	2-1/16" MYT SETTING RING	7.00
28	E29351	2" MYT SETTING RING	7.10
28	E29352	1-1/2" (1.900) MYT SETTING RING	7.35
28	E29353	1-1/4" (1.660) MYT SETTING RING	7.50
28	E29354	1" (1.315) MYT SETTING RING	7.90
28	E29354-1	3/4" (1.050) MYT SETTING RING	8.05

Recommended spares include 2 sets of inserts and 2 setting rings for each pipe size to be run.

KET MYT (40 TON) SLIP TYPE ELEVATOR

337-365-4411

sales@k-e-t.com

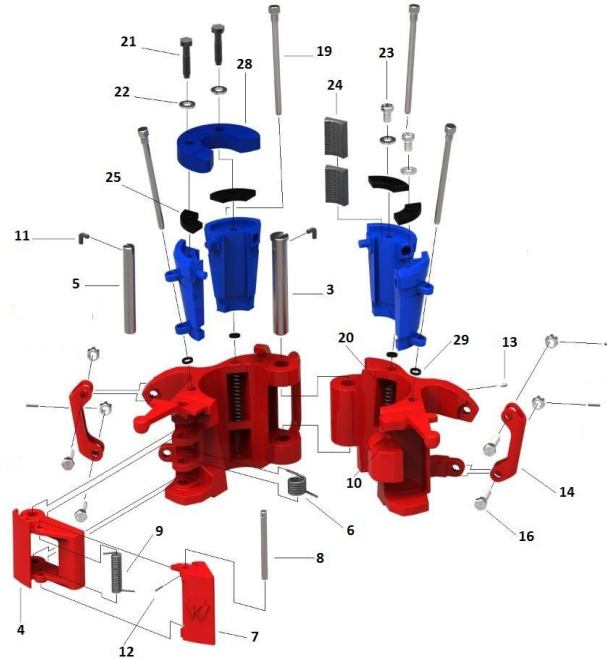

MYT REPLACEMENT PARTS

ITEM	QTY	PART NO.	DESCRIPTION	SPARES	WEIGHT (lbs.)
3	1	E29333	HINGE PIN		4
4	1	E30652	LATCH		10
5	1	E29334	LATCH PIN		4
6	1	E29338	LATCH SPRING	2	0.5
7	1	E30653	LATCH LOCK		2
8	1	E29335	LATCH LOCK PIN	2	0.5
9	1	E29349	LATCH LOCK SPRING	2	0.25
10	1	E30841	LATCH LOCK DOOR PIN		0.5
11	1	E947128-120	LATCH PIN RETAINER	2	1.5
12	1	E947128-172	LATCH LOCK PIN RETAINER	2	0.5
N/P	1	E30708	LATCH AND LATCH LOCK ASSEMBLY		12.88
14	2	E29337	LINK BLOCK		1
16	4	E939099-65-2	UPPER AND LOWER LINK BLOCK BOLT, NUT, AND COTTER	4	0.45
19	4	E29336	SLIP BOLT	4	0.75
20	4	E29340	SLIP SPRING	8	0.25
21	2	E29347	SETTING RING SCREW	4	0.25
22	2	E939370-13	SETTING PLATE WASHER	4	0.06
23	2	E939098-15	INSERT RETAINER SCREW	4	0.13
25	4	E29344	INSERT RETAINER PLATE	4	0.5

MYT INSERTS

ITEM	QTY	PART NO.	DESCRIPTION	WEIGHT (lbs.)
24	8	E24773	2-7/8" X 2-7/8" INSERT	0.75
24	8	E29255	2-7/8" X 2-3/8" INSERT	1.00
24	8	E29256	2-7/8" X 2-1/16" & 2" INSERT	1.13
24	8	E29257	2-7/8" X 1-1/2" (1.900") INSERT	1.25
24	8	E29258	2-7/8" X 1-1/4" (1.660") INSERT	1.38
24	8	E29259	2-7/8" X 1" (1.315") INSERT	1.44
24	8	E29259-1	2-7/8" X 3/4" (1.050") INSERT	1.50

Recommended spares include 1 set of inserts for each size of pipe to be run.

KET YT (75 TON) SLIP TYPE ELEVATOR

337-365-4411

sales@k-e-t.com

PART NUMBER	RANGE	SIZE OF LINKS	WEIGHT
E23105	1.315" - 3-1/2"	2-1/4" - 2-3/4"	355.00

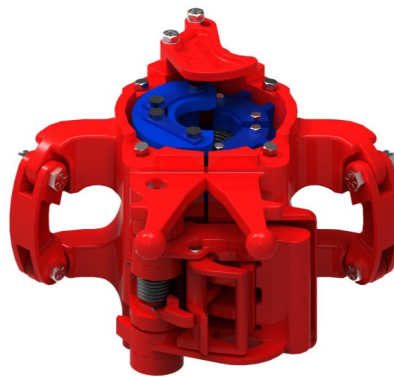

YT SLIP ASSEMBLIES

PART NO.	DESCRIPTION	WEIGHT(lbs.)
E23108-5	3-1/2" X 3-1/2" YT SLIP ASSEMBLY	64.00
E23108-3	3-1/2" X 2-7/8" YT SLIP ASSEMBLY	76.00
E23108-4	2-7/8" X 2-7/8" YT SLIP ASSEMBLY	76.00
E23108-6	2-7/8" X 2-3/8" YT SLIP ASSEMBLY	79.00
E23108-7	2-7/8" X 2-1/16" YT SLIP ASSEMBLY	81.00
E23108-8	2-7/8" X 2" YT SLIP ASSEMBLY	82.00
E23108-9	2-7/8" X 1-1/2" (1.900) YT SLIP ASSEMBLY	83.50
E23108-10	2-7/8" X 1-1/4" (1.660) YT SLIP ASSEMBLY	85.50
E23108-11	2-7/8" X 1" (1.315) YT SLIP ASSEMBLY	86.50
E23108	3-1/2" YT SLIP SEGMENTS ONLY (MATCHED SET OF 4)	51.00
E23108-2	2-7/8" YT SLIP SEGMENTS ONLY (MATCHED SET OF 4)	51.00

YT SETTING RINGS

ITEM	PART NO.	DESCRIPTION	WEIGHT (lbs.)
33	E27813	3-1/2" YT SETTING RING	3.13
33	E27695	2-7/8" YT SETTING RING	3.56
33	E27694	2-3/8" YT SETTING RING	4.00
33	E27812	2-1/16" YT SETTING RING	4.25
33	E28821	2" YT SETTING RING	4.25
33	E27811	1-1/2" (1.900) YT SETTING RING	4.31
33	E27810	1-1/4" (1.660) YT SETTING RING	4.38
33	E29001	1" (1.315) YT SETTING RING	4.75

YT SLIP INSERTS

ITEM	QTY	PART NO.	DESCRIPTION	WEIGHT (lbs.)
30	24	E24774	3-1/2" X 3-1/2" INSERT	0.50
30	24	E30358	3-1/2" X 2-7/8" INSERT	0.75
30	12	E24773	2-7/8" X 2-7/8" INSERT	0.75
30	12	E29255	2-7/8" X 2-3/8" INSERT	0.75
30	12	E29256	2-7/8" X 2-1/16" & 2" INSERT	1.00
30	12	E29257	2-7/8" X 1-1/2" (1.900") INSERT	1.20
30	12	E29258	2-7/8" X 1-1/4" (1.660") INSERT	1.38
30	12	E29259	2-7/8" X 1" (1.315") INSERT	1.45

Recommended spares include 2 sets of inserts and 2 setting rings for each size of pipe to be run.

bridge the gap.

KET YT (75 TON) SLIP TYPE ELEVATOR

337-365-4411

sales@k-e-t.com

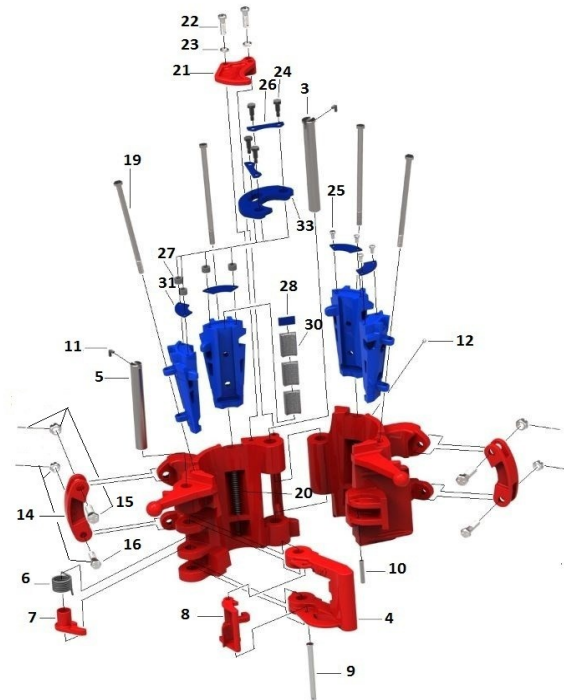

YT REPLACEMENT PARTS

ITEM	QTY	PART NO.	DESCRIPTION	SPARES	WEIGHT (lbs.)
3	1	E23116-1	HINGE PIN		4.13
4	1	E15348	LATCH		27.00
5	1	E24182	LATCH PIN		5.00
6	1	E12978	LATCH SPRING	2	0.63
7	1	E12946	LATCH CAM		1.50
8	1	E12972	LATCH LOCK	2	3.50
9	1	E13530	LATCH LOCK PIN		0.63
10	1	E12529	DOOR LUG PIN	2	0.65
11	1	E24964	LATCH PIN RETAINER		0.20
12	1	E940308-1	GREASE FITTING	2	0.05
14	2	E9519	LINK BLOCK		5.50
15	2	E8145-1	UPPER LINK BLOCK BOLT, NUT AND COTTER	2	1.00
16	2	E8145-2	LOWER LINK BLOCK BOLT, NUT AND COTTER	2	1.00
19	4	E23115-S	SLIP BOLT	4	1.25
20	4	E23113	SLIP SPRING	8	0.25
21	1	E23630	GUIDE PLATE		4.00
22	2	E939098-75	GUIDE PLATE SCREW	2	0.25
23	2	E939098-64	GUIDE PLATE LOCKWASHER	2	0.15
24	4	E27697	SETTING PLATE BOLT	8	0.25
25	4	E27532	INSERT RETAINER SCREW	8	0.06
26	2	E27546	SETTING RING RETAINER (3-1/2")	2	0.13
26	2	E27507	SETTING RING RETAINER (2-7/8")	2	0.13
27	4	E27696	YT SETTING RING BUSHING	8	0.06
28	8	E24507	INSERT SPACER (3-1/2")	8	0.13
28	4	E24508	INSERT SPACER (2-7/8")	4	0.25
31	4	E27530	INSERT RETAINER PLATE (3-1/2")	4	0.13
31	4	E27451	INSERT RETAINER PLATE (2-7/8")	4	0.25

bridge the gap.

KET MRA(150 TON) CENTER LATCH ELEVATOR

337-365-4411

sales@k-e-t.com

PART NUMBER	RANGE	SIZE OF LINKS	WEIGHT
E30158	2-7/8"-5-1/2"	1-3/4"-2-3/4"	240.00

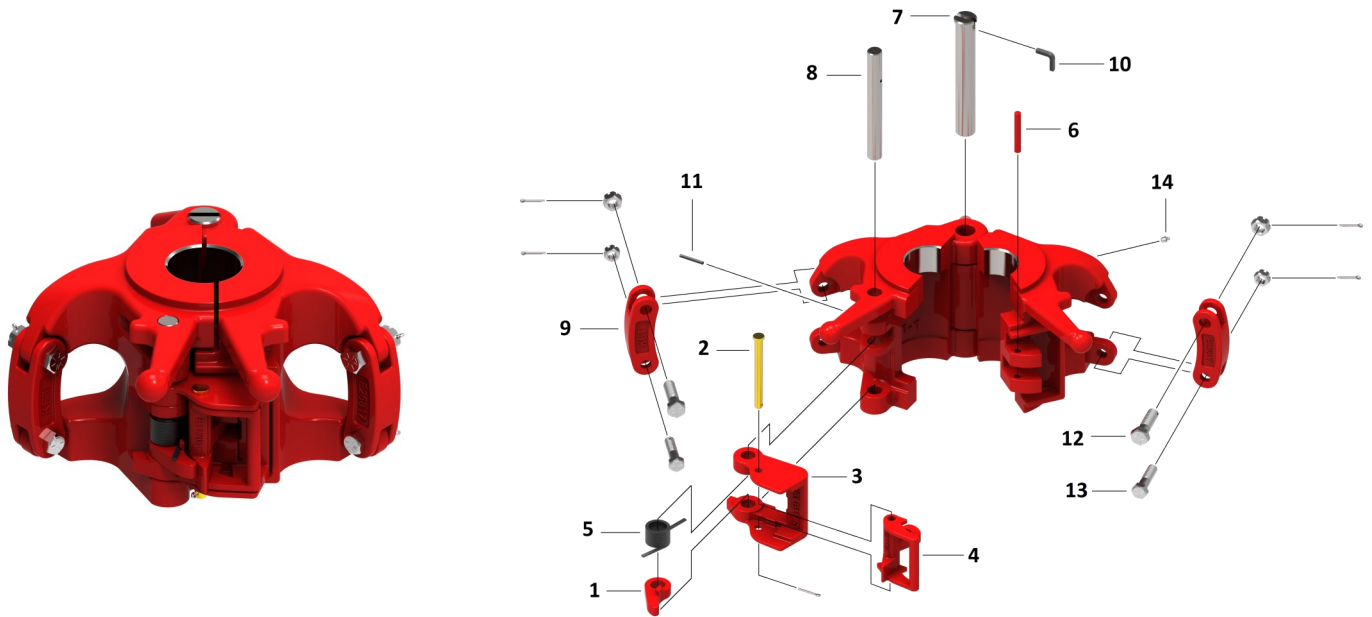

REPLACEMENT PARTS FOR MRA ELEVATORS

ITEM	QTY	PART #	DESCRIPTION	SPARES	WEIGHT
1	1	E11581	LATCH CAM	1	0.12
2	1	E11759	LATCH LOCK PIN	1	2.09
3	1	E11763	LATCH		9.04
4	1	E11764	LATCH LOCK	*	3.00
5	1	E11766	LATCH SPRING	2	0.10
6	1	E12529	LATCH LUG PIN		0.03
7	1	E26813	HINGE PIN	*	4.09
8	1	E26814	LATCH PIN	*	2.09
9	1	E26817	LINK BLOCK		3.08
10	1	E29464	HINGE PIN RETAINER	2	0.12
11	1	E8156	LATCH PIN RETAINER	2	0.12
12	2	E8145-1	UPPER LINK BLOCK BOLT, NUT, & COTTER	2	0.12
13	2	E8145-2	LOWER LINK BLOCK BOLT, NUT, & COTTER	2	0.12
14	1	E940308-1	GREASE ZERT	2	0.02

1 YEAR SPARES, FOR 2 YEAR SPARES ADD 1 EA. OF * THESE ITEMS

bridge the gap.

KET MG (100 TON) BOTTLENECK ELEVATOR

337-365-4411

sales@k-e-t.com

PART NUMBER	RANGE	SIZE OF LINKS	WEIGHT
E30157	2-3/8" - 5"	1-3/4" - 2-3/4"	240.00

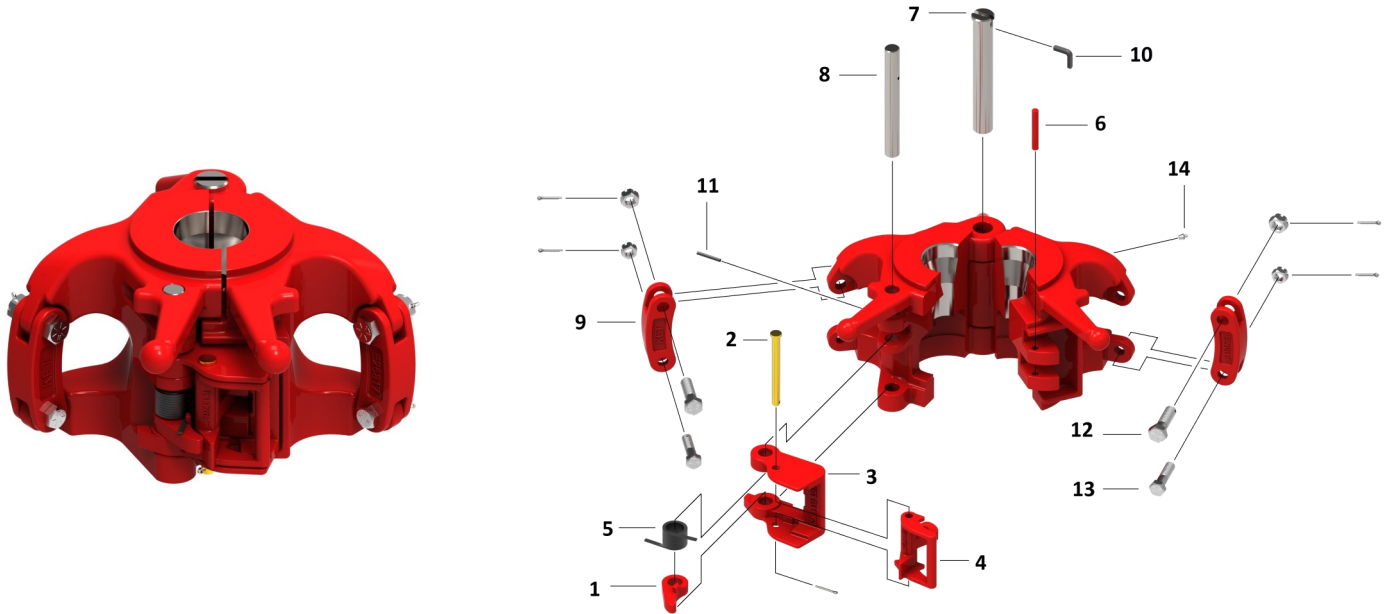

REPLACEMENT PARTS FOR MG ELEVATORS

ITEM	QTY	PART #	DESCRIPTION	SPARES	WEIGHT
1	1	E11581	LATCH CAM	1	0.12
2	1	E11759	LATCH LOCK PIN	1	2.09
3	1	E11763	LATCH		9.04
4	1	E11764	LATCH LOCK	*	3.00
5	1	E11766	LATCH SPRING	2	0.05
6	1	E12529	LATCH LUG PIN		0.03
7	1	E26813	HINGE PIN	*	4.09
8	1	E26814	LATCH PIN	*	2.09
9	1	E26817	LINK BLOCK		3.08
10	1	E29464	HINGE PIN RETAINER	2	0.12
11	1	E8156	LATCH PIN RETAINER	2	0.12
12	2	E8145-1	UPPER LINK BLOCK BOLT, NUT, & COTTER	2	0.12
13	2	E8145-2	LOWER LINK BLOCK BOLT, NUT, & COTTER	2	0.12
14	1	E940308-1	GREASE ZERT	2	0.02

1 YEAR SPARES, FOR 2 YEAR SPARES ADD 1 EA. OF * THESE ITEMS

bridge the gap.

KET RG (150 TON) BOTTLENECK ELEVATOR

337-365-4411

sales@k-e-t.com

PART NUMBER	RANGE	SIZE OF LINKS	WEIGHT
E30156	2-3/8"-4-1/2"	1-3/4"-2-3/4"	320.00

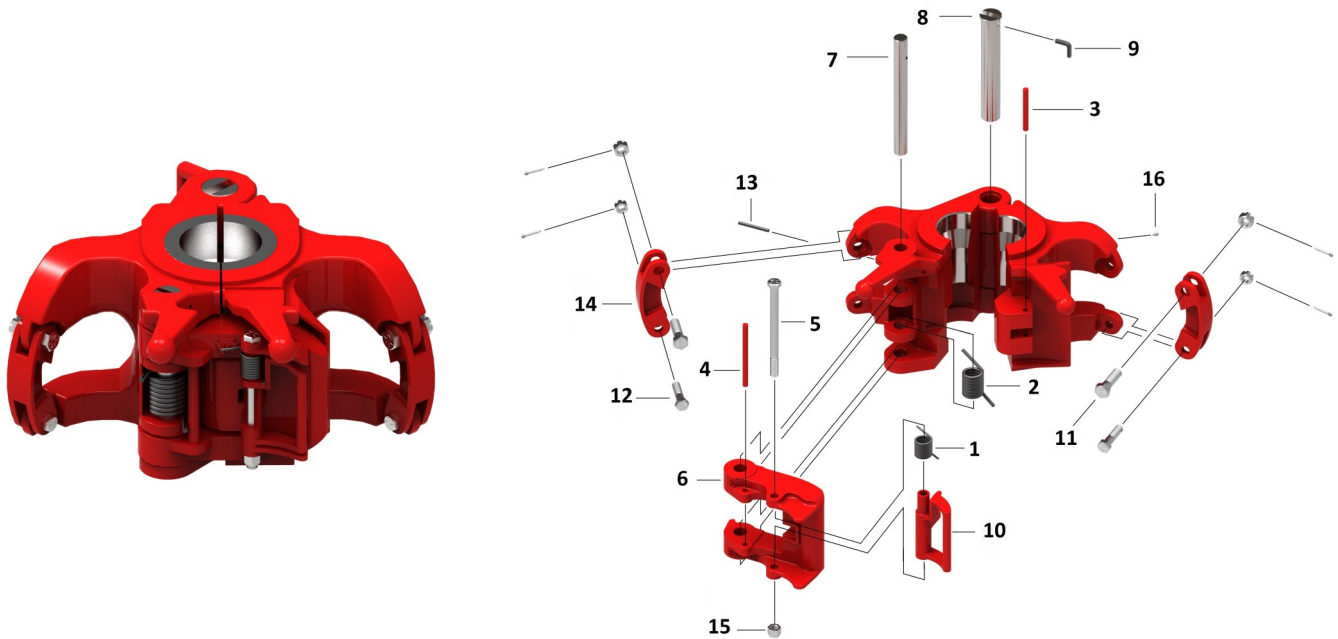

REPLACEMENT PARTS FOR RG ELEVATORS

ITEM	QTY	PART #	DESCRIPTION	SPARES	WEIGHT
1	1	E13188	LATCH LOCK SPRING	2	0.30
2	1	E23546	LATCH SPRING	2	1.00
3	1	E23547	LATCH LUG PIN		0.32
4	1	E23548	SPRING STOP PIN	1	0.94
5	1	E23553	LATCH LOCK BOLT & NUT	2	1.30
6	1	E30142	LATCH		44.00
7	1	E30148	LATCH PIN	*	4.00
8	1	E30149	HINGE PIN	*	7.00
9	1	E30149-RT	HINGE PIN RETAINER	2	0.13
10	1	E30150	LATCH LOCK	*	4.00
11	2	E8145-1	UPPER LINK BLOCK BOLT, NUT, & COTTER		0.50
12	2	E8145-2	LOWER LINK BLOCK BOLT, NUT, & COTTER		0.75
13	1	E8156	ROLL PIN	2	0.10
14	2	E9519-1	LINK BLOCK		5.50
15	1	E939484-8	LATCH LOCK NUT		0.20
16	1	E940308-1	GREASE ZERT	2	0.10

1 YEAR SPARES, FOR 2 YEAR SPARES ADD 1 EA. OF * THESE ITEMS

bridge the gap.

KET MGG (250 TON) BOTTLENECK ELEVATOR

337-365-4411

sales@k-e-t.com

PART NUMBER	RANGE	SIZE OF LINKS	WEIGHT
E35005	3-1/2"-5-1/2"	2-1/4"-3-1/2"	600.00

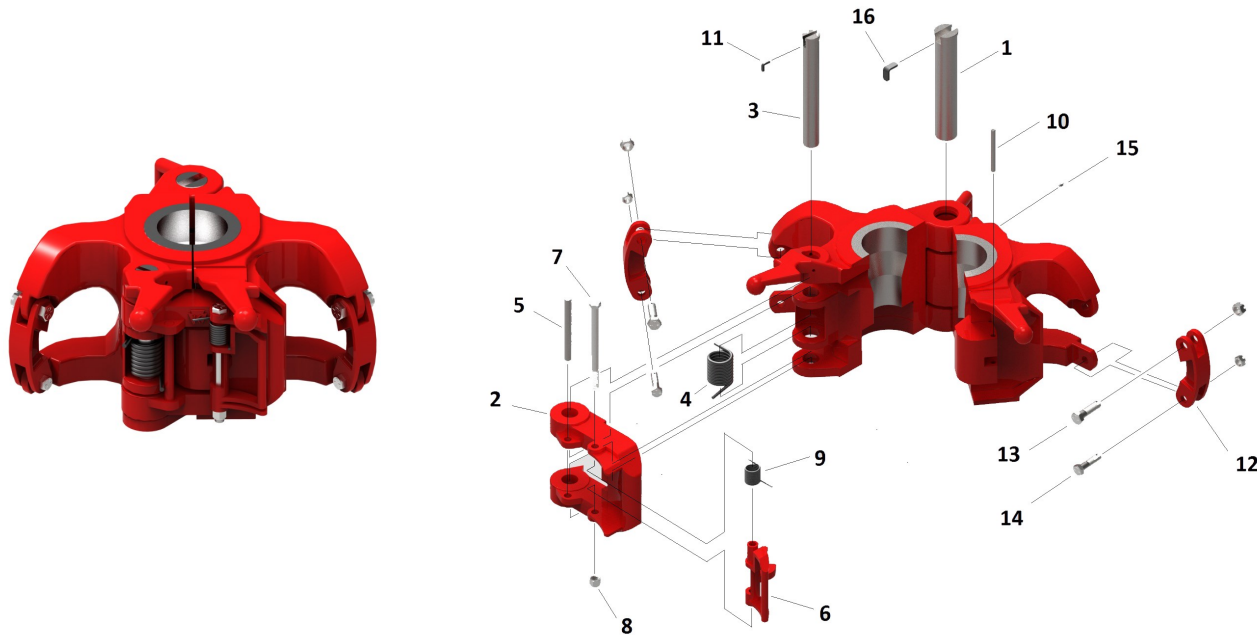

REPLACEMENT PARTS FOR MGG ELEVATORS

ITEM	QTY	PART #	DESCRIPTION	SPARES	WEIGHT
1	1	E34908	HINGE PIN	*	15.50
2	1	E34906	LATCH		57.00
3	1	E34907	LATCH PIN	*	7.31
4	1	E34909	LATCH SPRING	2	2.50
5	1	E13185	SPRING STOP PIN	1	0.94
6	1	E13152	LATCH LOCK	*	4.00
7	1	E15101	LATCH LOCK BOLT	2	1.30
8	1	E939484-8	LATCH LOCK BOLT NUT	2	0.20
9	1	E13188	LATCH LOCK SPRING	2	0.30
10	1	E13190	DOOR LUG PIN		0.32
11	1	E34911	LATCH PIN RETAINER	2	0.13
12	2	E9519	LINK BLOCK		5.50
13	2	E8145-1	UPPER LINK BLOCK BOLT, NUT, & COTTER		0.50
14	2	E8145-2	LOWER LINK BLOCK BOLT, NUT, & COTTER		0.75
15	1	E940308-1	GREASE FITTING		0.10
16	1	E34910	HINGE PIN RETAINER		0.19

1 YEAR SPARES, FOR 2 YEAR SPARES ADD 1 EA. OF * THESE ITEMS

bridge the gap.

KET GG (350 TON) BOTTLENECK ELEVATOR

337-365-4411

sales@k-e-t.com

PART NUMBER	RANGE	SIZE OF LINKS	WEIGHT
E31068	3-1/2"-5-1/2"	2-1/4"-3-1/2"	700.00

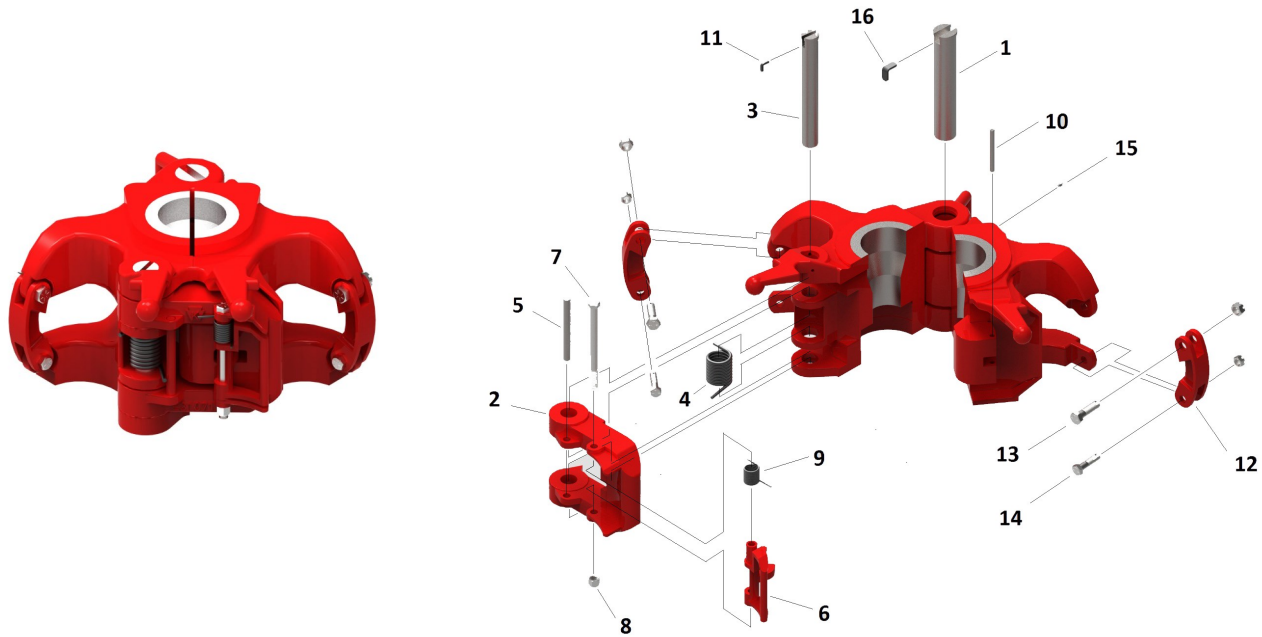

REPLACEMENT PARTS FOR GG ELEVATORS

ITEM	QTY	PART #	DESCRIPTION	SPARES	WEIGHT
1	1	E33998	HINGE PIN	*	15.50
2	1	E31071	LATCH		57.00
3	1	E33999	LATCH PIN	*	7.31
4	1	E18416	LATCH SPRING	2	2.50
5	1	E13185	SPRING STOP PIN	1	0.94
6	1	E13152	LATCH LOCK	*	4.00
7	1	E15101	LATCH LOCK BOLT	2	1.30
8	1	E939484-8	LATCH LOCK BOLT NUT	2	0.20
9	1	E13188	LATCH LOCK SPRING	2	0.30
10	1	E13190	DOOR LUG PIN		0.32
11	1	E32892	LATCH PIN RETAINER	2	0.13
12	2	E9519	LINK BLOCK		5.50
13	2	E8145-1	UPPER LINK BLOCK BOLT, NUT, & COTTER		0.50
14	2	E8145-2	LOWER LINK BLOCK BOLT, NUT, & COTTER		0.75
15	1	E940308-1	GREASE FITTING		0.10
16	1	E31074	HINGE PIN RETAINER		0.19

1 YEAR SPARES, FOR 2 YEAR SPARES ADD 1 EA. OF * THESE ITEMS

bridge the gap.

KET BUSHING TYPE ELEVATOR (MGG-GG)

337-365-4411

sales@k-e-t.com

PART NUMBER	RANGE	SIZE OF LINKS	WEIGHT (LBS.)
E35005-IB (MGG)	2-7/8"-5"	2-1/4"-3-1/2"	600.00
E31068-IB (GG)	2-7/8"-5"	2-1/4"-3-1/2"	750.00

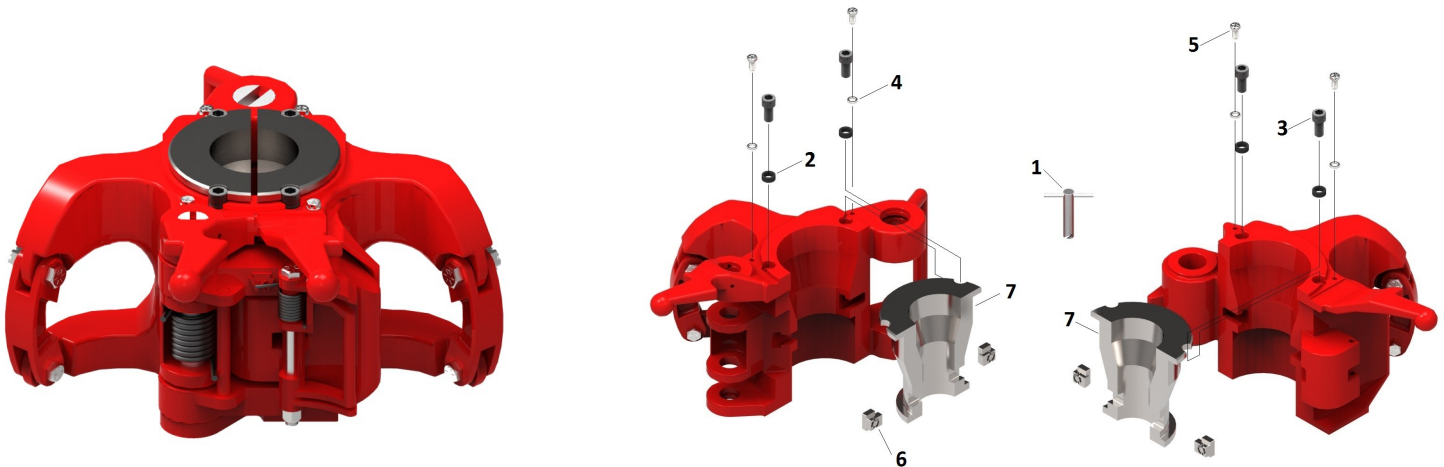

REPLACEMENT PARTS FOR BUSHING TYPE ELEVATORS

ITEM	QTY	PART NO.	DESCRIPTION	SPARES	WEIGHT (LBS.)
1	1	E35002-T	LOCK-BLOCK TOOL	1	0.755
2	4	E35001-S	RETAINER BUSHING	4	0.065
3	4	E35001	RETAINER BOLT	4	0.300
4	4	E35007	LOCK WASHER	4	0.015
5	4	E35006	SAFETY WIRE SCREW	4	0.075
6	4	E35002-ASSY	LOCK-BLOCK-ASSY.	4	0.335
7	1	E35000-	MGG BUSHING SET (SEE CHARTS BELOW FOR SPECIFIC SIZES)	1	SEE BELOW
7	1	E31000-	GG BUSHING SET (SEE CHARTS BELOW FOR SPECIFIC SIZES)	1	SEE BELOW
	1	E35000-118	2-7/8"-BUSHING F/MGG	1	68.00
	1	E35000-120	3-1/2"-BUSHING F/MGG	1	66.00
	1	E35000-121	4" FH BUSHING F/MGG	1	64.00
	1	E35000-220	4" SH BUSHING F/MGG	1	65.00
	1	E35000-122	4-1/2" BUSHING F/MGG	1	62.00
	1	E35000-123	5" BUSHING F/MGG	1	59.00
	1	E31000-120	3-1/2" BUSHING F/GG	1	70.00
	1	E31000-121	4" FH BUSHING F/GG	1	68.00
	1	E31000-220	4" SH BUSHING F/GG	1	69.00
	1	E31000-122	4-1/2" BUSHING F/GG	1	66.00
	1	E31000-123	5" BUSHING F/GG	1	64.00

1 YEAR SPARES. FOR 2 YEARS SPARES ADD 1 EA. OF * THESE ITEMS.

bridge the gap.

KET SAFETY PRODUCTS

337-365-4411

sales@k-e-t.com

SLIP SAFETY FLEX HANDLES

Keystone Slip Safety Flex Handles incorporate investment cast slip connectors and handles with thumb guards. They are joined together with high strength chain which is then covered with nitrile rubber to prevent corrosion.

- ▶ Eliminates cuts from frayed cables
- ▶ Reduces back injuries
- ▶ Improves ergonomics



PART NUMBER	DESCRIPTION	WEIGHT (LBS.)
100050	WOOLLEY B SAFETY FLEX HANDLE W/THUMB GUARD	5
100100	SD, DC,& CMSXL SAFETY FLEX HANDLE W/ THUMB GUARD	4
100200-F	DU FRONT SAFETY FLEX HANDLE W/ THUMB GUARD	4
100200-R	DU REAR SAFETY FLEX HANDLE W/ THUMB GUARD	4
100300	C-1 /WOOLLEY A SAFETY FLEX HANDLE W/THUMB GUARD	4
100350	UC SAFETY FLEX HANDLE W/THUMB GUARD	4

TONG SAFETY HANDLES

Keystone Tong Safety Handles incorporate a universal design allowing them to improve hand protection and be used with most tong models without welding.

PART NUMBER	DESCRIPTION	WEIGHT (LBS.)
20000-DB	DUMBBELL STYLE TONG SAFETY HANDLE	1.00
20000-SH-1	2 PC TONG SAFETY HANDLE KIT MODIFIED W/ 3/8" HOLE	2.00
20000-SH-2	2 PC TONG SAFETY HANDLE KIT	2.00
20000-SH-3	2 PC TONG SAFETY HANDLE FOR TYPE "C" LONG JAW	2.00
20000-SH-7-4	1/2" SAFETY BUMPER	2.00
20000-SH-7-6	3/4" SAFETY BUMPER	2.00
20000-SH-7-7	7/8" SAFETY BUMPER	2.00
20000-SH-7-8	1" SAFETY BUMPER	2.00
6181010629	2 PC TONG SAFETY HANDLE KIT FOR WOOLLEY TONG	2.00
9BV70751	B&V-65 SAFETY HANDLE	1.00
250369	SAFETY CAP ASSEMBLY FOR VARCO TONG	2.00

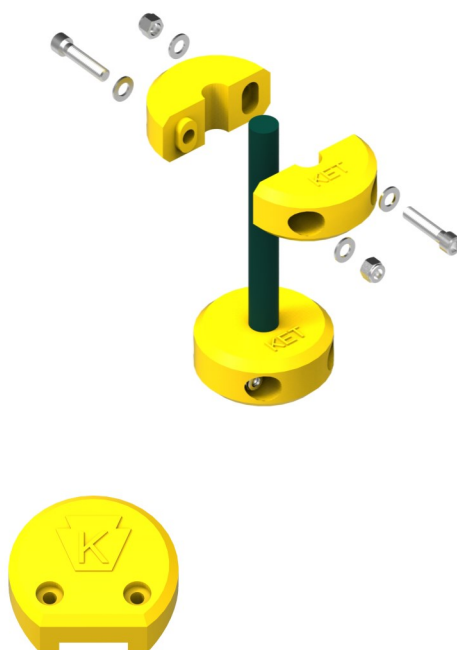

KET TYPE "C" SAFETY CLAMP

337-365-4411

sales@k-e-t.com

The KET Type "C" Safety Clamp is one of the most valuable tools on the Rig Floor. It helps guard against dropping flush-joint pipe, streamlined drill collars, etc. into the hole while making-up or breaking-out the string. Literally, it has dozens of money and time-saving applications in oilfield work, in addition to giving increased protection against fishing jobs.

The Safety Clamp consists of individual links, flexibly hinged together. Each link has a separate tapered slip which acts as a gripping member, much like a tapered rotary slip, and each slip is held in a retracted position on the taper by spring tension. When the clamp is tightened, each small slip takes a firm initial grip on the surface of the pipe. Should the pipe start to fall, or should load increase occur against the slips, the taper mounting causes each slip to wedge tighter against the surface of the pipe to increase the grip or lock the pipe against further movement.

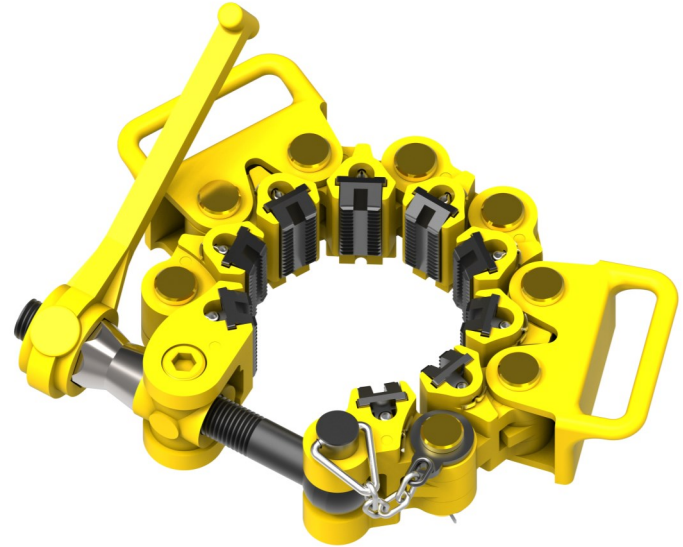

CLAMPS WITH HANDLES & WRENCH TYPE "CR" (SINGLE SCREW)

KET#	RANGE O.D. SIZE	REFERENCE	LINKS REQUIRED	WT.
A12-127	3 3/4" - 4 5/8"	7624-5007	7	46.00
A12-128	4 1/2" - 5 5/8"	7624-5008	8	55.00
A12-129	5 1/2" - 6 5/8"	7624-5009	9	60.00
A12-130	6 1/2" - 7 5/8"	7624-5010	10	64.00
A12-131	7 1/2" - 8 5/8"	7624-5011	11	69.00
A12-132	8 1/2" - 9 5/8"	7624-5012	12	73.00
A12-133	9 1/2" - 10 5/8"	7624-5013	13	78.00
TYPE "CL" (SINGLE SCREW)				
A12-134	10 1/2" - 11 5/8"	7624-5014	14	82.00
A12-135	11 1/2" - 12 5/8"	7624-5015	15	87.00
A12-136	12 1/2" - 13 5/8"	7624-5016	16	91.00
A12-137	13 1/2" - 14 5/8"	7624-5017	17	115.00
A12-138	14 1/2" - 15 5/8"	7624-5018	18	119.00
TYPE "C X L" (DOUBLE SCREW)				
A12-145	15 1/2" - 17"	7624-5029	18	121.00
A12-146	16 1/2" - 18"	7624-5030	19	125.00
A12-147	17 1/2" - 19"	7624-5031	20	129.00
A12-148	18 1/2" - 20"	7624-5032	21	134.00

bridge the gap.

KET TYPE "C" REPLACEMENT PARTS

337-365-4411

sales@k-e-t.com

CLAMPS WITH LIFTING CLEVIS- TYPE "C X L" (DOUBLE SCREW)

KET#	RANGE O.D. SIZE	REFERENCE	LINKS REQUIRED	WT.
A12-155	15 1/2" - 17"	7624-5095	18	36.00
A12-156	16 1/2" - 18"	7624-5096	19	40.00
A12-157	17 1/2" - 19"	7624-5097	20	44.00
A12-158	18 1/2" - 20"	7624-5098	21	44.00
A12-159	19 1/2" - 21"	7624-5099	22	44.00
A12-160	21 1/8" - 23"	N/A	24	36.00
A12-161	24 1/8" - 26"	N/A	27	40.00
A12-162	29 1/2" - 31"	7624-5100	32	44.00
A12-163	35 1/2" - 37"	7624-5101	38	44.00
A12-164	41 1/2" - 47"	7624-5102	44	44.00

ADD -"B" TO END OF PART # TO INCLUDE BOX

REPLACEMENT PARTS FOR TYPE "C" SAFETY CLAMP



KET#	ITEM	DESCRIPTION	REFERENCE#	SPARES	WT.
A12-101	1	LINK ASSY. COMPLETE	7624-A-7		5.00
A12-102	2	LINK INTERMEDIATE	7624-A-1	6	3.75
A12-103	3	INSERT w/COTTER	7624-A-4	1 SET	1.12
A12-104		COTTER f/INSERT	900620-65		0.06
A12-105	5	SPRING f/INSERT	7624-E-5	1 SET	0.06
A11-106	6	LINK PIN w/COTTER	7624-C-5	6	0.75
A11-107	7	COTTER f/LINK PIN	900620-36		0.06
A12-108	8	END LINK (SCREW)	7624-A-3		4.50
A12-109	9	END LINK (PIVOT BLOCK)	7624-A-24		3.50
A11-110	10	END LINK PIN w/CHAIN	7624-F-5	1	1.25
A11-111	11	SCREW	7624-A-5		4.00
A11-112	12	NUT	7624-B-5		1.50
A11-113	13	PIVOT BLOCK	7624-A-5000		1.50
A11-114	14	PIVOT BLOCK PIN	7624-D-5		0.25
A11-115	15	NUT WRENCH	7624-A-25		4.00
A12-116	16	HANDLE (CAST STEEL)	7624-A-6		3.00
A11-117	17	HANDLE LINK PIN w/COTTER	7624-G-5		0.75
A12-118	N/P	HANDLE KIT	7624-A-5135		4.00
A11-119	19	PIVOT BLOCK PIN WRENCH	900533-12		0.25
A11-120	N/P	SAFETY CLAMP BOX	7624-A-9		45.00
A12-119	21/22	SUPPORT EYE COMPLETE	7624-29		15.00
A12-120	21	SUPPORT EYE ONLY	7624-A-29		9.00
A12-121	22	SUPPORT EYE PIN & NUT	7624-A-30		2.50

** RECOMMENDED SPARE PARTS FOR 1 YEARS SERVICE

bridge the gap.

KET TYPE “T” SAFETY CLAMP

337-365-4411

sales@k-et.com

The KET Type “T” Safety Clamp is designed for small diameter pipe 1 1/8” - 4 1/2” O.D. Each link changes the effective working range approximately 1” in diameter. For sizes larger than 4 1/2” O.D., the Type “C” Safety Clamp should be used.

The same positive automatic gripping principle is used as in the Type “C” Safety Clamp. It is ideal to help safeguard against dropping strings of flush joint tubing, to provide a shoulder to position strings of flush line pipe for welding, and many other Applications.

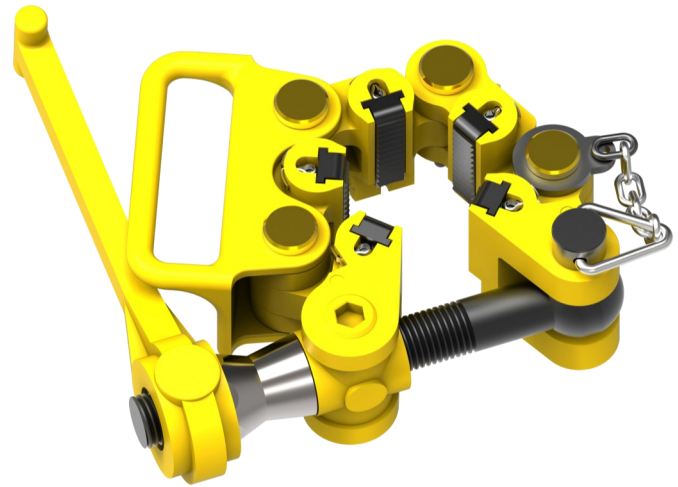

SAFETY CLAMP ASSEMBLIES COMPLETE - TYPE “T”

KET#	RANGE O.D. SIZE	REFERENCE	LINKS REQUIRED	WT.
A11-125	1 1/8” - 2”	7624-5103	4	36.00
A11-126	2 1/8” - 3 1/4”	7624-5104	5	40.00
A11-127	3 1/2” - 4 1/2”	7624-5105	6	44.00

ADD –“B” TO END OF PART NUMBER TO INCLUDE BOX

bridge the gap.

KET TYPE "T" REPLACEMENT PARTS

337-365-4411

sales@k-e-t.com

REPLACEMENT PARTS FOR TYPE "T" SAFETY CLAMP



KET#	ITEM	DESCRIPTION	REFERENCE#	**SPARES	WT.
A11-101	1	LINK ASSY. COMPLETE	7624-B-7		4.25
A11-102	2	LINK INTERMEDIATE	7624-A-18	3	3.25
A11-103	3	INSERT w/COTTER	7624-A-21	6	0.25
A11-104		COTTER f/INSERT	900620-52		0.06
A11-105	5	SPRING f/INSERT	7624-B-21	6	0.06
A11-106	6	LINK PIN w/COTTER	7624-C-5	3	0.75
A11-107	7	COTTER f/LINK PIN	900620-36		0.06
A11-108	8	END LINK (SCREW)	7624-A-20		4.50
A11-109	9	END LINK (PIVOT BLOCK)	7624-A-19		3.50
A11-110	10	END LINK PIN w/CHAIN	7624-F-5	1	1.25
A11-111	11	SCREW	7624-A-5		4.00
A11-112	12	NUT	7624-B-5		1.50
A11-113	13	PIVOT BLOCK	7624-A-5000		1.50
A11-114	14	PIVOT BLOCK PIN	7624-D-5		0.25
A11-115	15	NUT WRENCH	7624-A-25		4.00
A11-116	16	HANDLE (CAST STEEL)	7624-A-22		3.00
A11-117	17	HANDLE LINK PIN w/COTTER	7624-G-5		0.75
A11-118	N/P	HANDLE KIT	7624-A-5138		4.00
A11-119	19	PIVOT BLOCK PIN WRENCH	900533-12		0.12
A11-120	N/P	SAFETY CLAMP BOX	7624-A-9		45.00
A11-121	N/P	1 YEAR SPARE PARTS KIT	N/A	1	13.00

ALL PARTS ARE INTERCHANGEABLE WITH BAASH-ROSS® TYPE "T" SAFETY CLAMPS

** RECOMMENDED SPARE PARTS FOR 1 YEARS SERVICE

bridge the gap.

KET SLIP LIFTING DEVICE (“SLD”)

337-365-4411

sales@k-e-t.com

Keystone’s slip lifting device comes in pneumatic or hydraulic configurations. It is designed to be used while tripping in or out of the hole to help reduce fatigue and prevent injuries.

- ▶ Available in pneumatic or hydraulic
- ▶ Available for pin-drive or square-drive master bushings
- ▶ Can be used with conventional rotary, drill collar, or casing slips

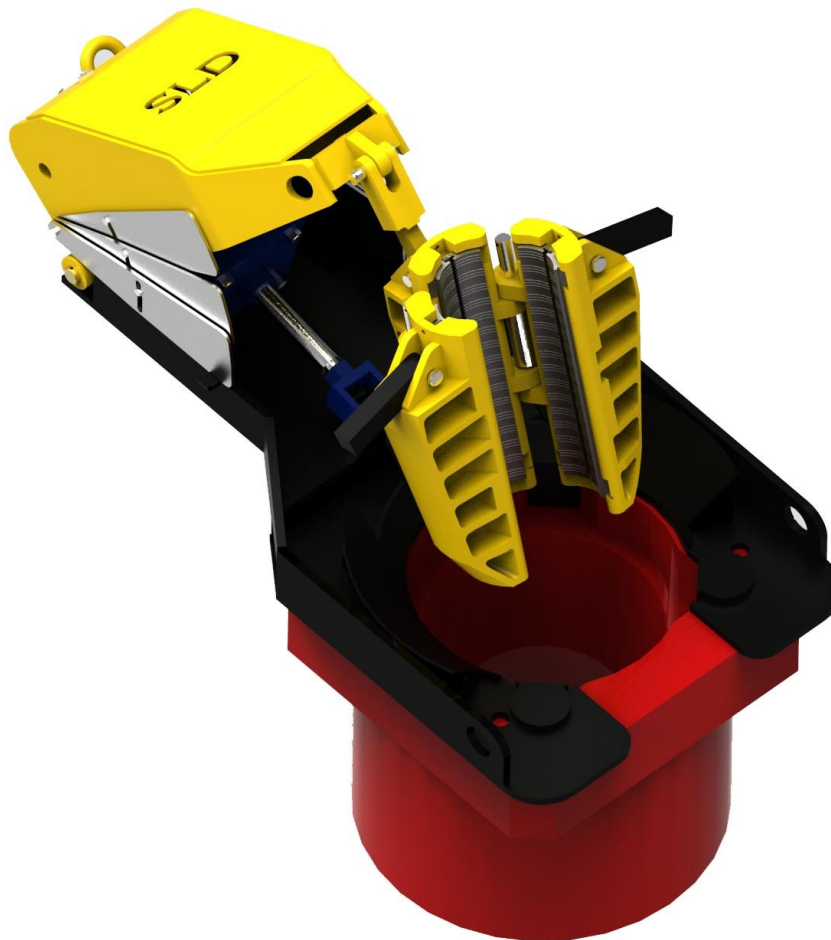

bridge the gap.

KET STABBING GUIDES

337-365-4411

sales@k-e-t.com

STABBING GUIDES

Keystone Heavy-Duty Stabbing Guides help to reduce damages to connections while making up connections.

Features include

- ▶ Polyurethane Inserts
- ▶ Light weight Aluminum construction
- ▶ Corrosion Resistant Hardware
- ▶ Adjustable Latch Cam
- ▶ Range = 2 3/8" thru 8 1/2" Tool joint OD

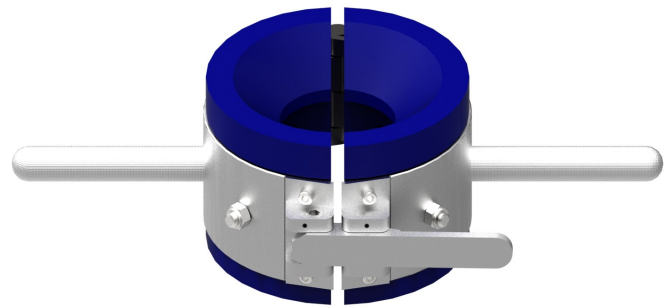

PART NUMBER	DESCRIPTION	WEIGHT (LBS.)
A02-506	2 3/8" CS 4.70#	6.00
A02-507	2 3/8" PH-6 5.95#	6.00
A02-508	2 7/8" CS	7.00
A02-509	2 7/8" PH-6 7.90#	7.00
A02-510	2 7/8" PH-6 8.70#	7.00
A02-513	2 7/8" 8RD 6.5#	7.00
A02-514	3 1/2" CS 9.3# - 10.3#	8.00
A02-515	3 1/2" PH-6 12.95#	6.00
A02-517	3 1/2" IF F/ 4 3/4" TJ	12.00
A02-517-2	3 1/2" IF f/ 4 7/8" TJ	12.00
A02-517-1	4" Full Hole	13.00
A02-5306	XT-39 f/ 4 7/8" TJ	6..00
A02-5308	XT-39 f/ 4 15/16 TJ	8.00
A02-5309	XT-43 f/ 5 3/8" TJ	18.00
A02-519	4 1/2" PH-6 15.50#	11.00
A02-5143	4 1/2" XH	18.00
A02-5310	DRILL PIPE f/ 6 1/2" TJ	17.00
A02-5311	DRILL PIPE f/ 7" TJ	18.00
A02-5312	DRILL PIPE f/ 7 1/4" TJ	18.00
A02-5313	DRILL PIPE f/ 8 1/4" TJ	12.00
A02-5314	DRILL PIPE f/ 8 1/2" TJ	12.00
A02-547	4 1/2" IF 6 5/8" TJ	17.00
A02-545	5" PH-6 20.3#	13.00
A02-546	5 1/2" PH-6 23#	13.00

bridge the gap.

KET TONG BLOCKS

337-365-4411

sales@k-e-t.com

TONG BLOCKS

The Keystone 12.5-ton Tong Block is designed to fit the line attachment of the tong and to provide a mechanical advantage of 2:1 when making or breaking out connections. The Keystone Tong Block is manufactured using high alloy heat treated steel castings and has a working capacity of 12.5 tons. It can be used with a wide variety of tongs by simply using anyone of three specially designed adapters, the SDD/DB adapter, BJ B/C adapter, and the WW adapter for AAX, and ST-60 tongs. The sheave is grooved for 1/2" through 7/8" wire line and incorporates a sleeve-type grease-able bearing for longevity.



PART NUMBER	DESCRIPTION	WEIGHT(LBS.)
TB-16490	Tong Block Assembly Less/ Adapter & Pin	19.00
TB-16500	Tong Block Assembly W/BJ B & C Adapter	20.00
TB-16600	Tong Block Assembly W/WW AAX & ST-60 Adapter	23.00
TB-16700	Tong Block Assembly W/BJ DB & SDD Adapter	25.50
TB-16018	Tong Block Adapter Only F/WW AAX & ST-60	3.00
TB-16016	Tong Block Adapter Only F/BJ B & C	3.50
TB-16014	Tong Block Adapter Only F/BJ DB & SDD	5.50
TB-16008	Tong Block Adapter Bolt F/BJ B & C	0.75
TB-16009	Tong Block Adapter Bolt F/WW & BJ DB & SDD	1.00

bridge the gap.

KET TONG DIE DRIVERS

337-365-4411

sales@k-e-t.com

TONG DIE DRIVERS

- Reduces hand injuries
- Brass striking surfaces prevent sparks and reduce airborne material
- Cleans and Re-dresses the die slot

Angled Tong Die Driver

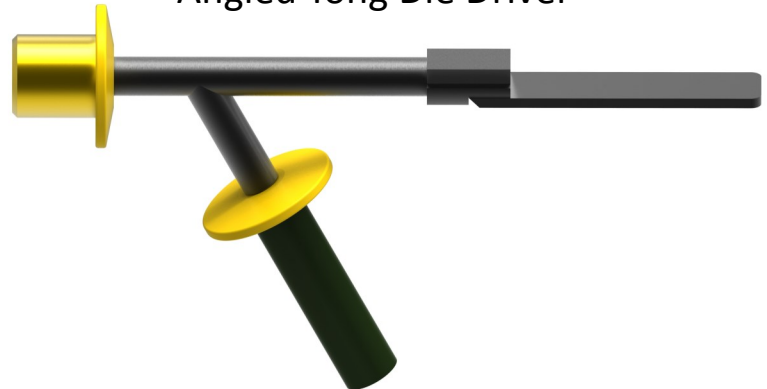

Straight Tong Die Driver





For more information, please contact us at:

Keystone Energy Tools

8404 Hwy. 90 West

New Iberia, LA 70560

www.k-e-t.com

Office: 1-337-365-4411

Fax: 1-337-365-4456