

Alpha Cable Cleats are available for trefoil and single cable applications where moderate to low levels of short circuit withstand are required. The unique design (patent applied for) allows rapid installation. Manufactured from extruded aluminium (6000 series) to BS EN 755, the product is lighter and tougher than the cast product it is designed to replace. The cleats are supplied with zinc plated closing fasteners.

Alpha Cable Cleat (Single)

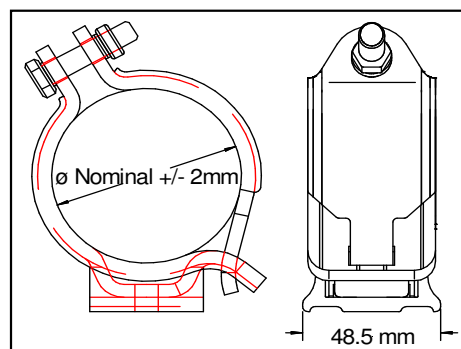

Maximum and minimum cable diameter nominal ± 2 mm

Testing Information

Alpha Cleats have been tested in line with the European Standard of 'Cable Cleats for Electrical Installations' BS EN 50368:2003. Typical results are detailed below:

Properties	BS EN 50368:2003 Classification Clause	Units / Classification	Alpha Single Cable Application Test Data
Cleat Type	6.1, 6.1.3	Composite	-
Impact Resistance	6.2, 6.2.5, 9.3	Very Heavy Classification (>6.7kg @ 300mm)	Pass
Resistance to Electromechanical Force.	6.3, 6.3.2.2, 9.4	kA @ 600mm centres Category 2	92 (Peak) 38.5 (RMS)
Temperature for Permanent Application	6.4	°C	-40 to 60
Needle Flame Test	6.5, 10.0	Application Time (seconds)	>120
Lateral Load Test	9.2	Newtons (N)	10000
Axial Movement Test	9.5	Newtons (N)	1000

Figure 1 : Short Circuit Test Rig

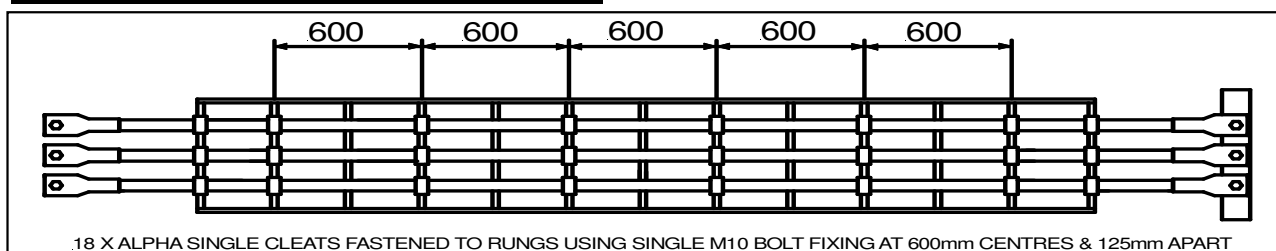

The example shown relates to BS EN 50368:2003 tests only. Other configurations / cleat spacings can be accommodated dependant on the fault level applicable. Please refer to Ellis Patents for further information.