

**Re-bar Clamps**

This versatile range of Wallis Re-bar clamps is used to connect re-bar to re-bar or re-bar to stranded cable. They provide a strong mechanical connection along with excellent resistance to corrosion.

Maximum Re-bar Ø mm	Re-bar Range Ø mm	Unit Weight kg	Pack Quantity	Part Number
10	6 - 10	0.21	20	<b>RBC 010</b>
20	12 - 20	0.34	20	<b>RBC 020</b>
25	20 - 25	0.21	10	<b>RBC 025</b>
32	25 - 32	0.34	10	<b>RBC 032</b>
40	32 - 40	0.54	10	<b>RBC 040</b>

**Material:** Gunmetal plates with Copper 'U' Bolt.

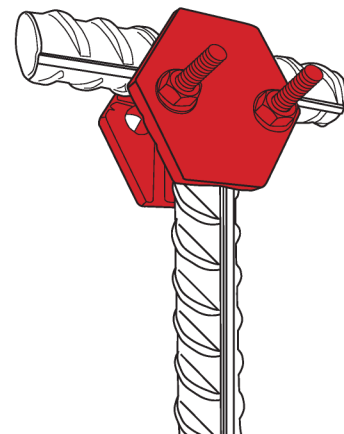
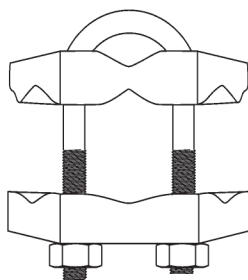
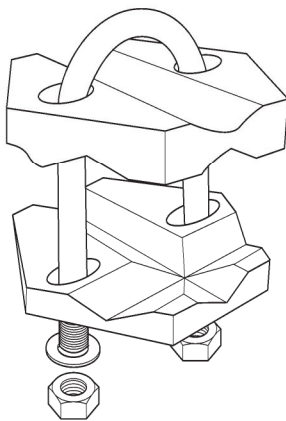

CABLE JOINTS, CABLE TERMINATIONS, CABLE GLANDS, CABLE CLEATS  
FEEDER PILLARS, FUSE LINKS, ARC FLASH, CABLE ROLLERS, CUT-OUTS

