

○ EN360 : 2002



90016668

CRESTO[®]



WWW.CABLEJOINTS.CO.UK
THORNE & DERRICK UK
 TEL 0044 191 490 1547 FAX 0044 477 5371
 TEL 0044 117 977 4647 FAX 0044 977 5582
 WWW.THORNEANDDERRICK.CO.UK

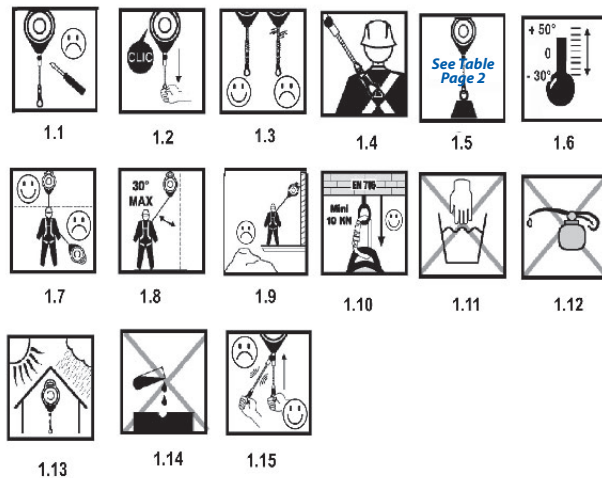

		Webbing retractables	Stopmax 10/15/20m cable
up to 110 kg	Factor 0	X	X
	Factor 1	X	X
	Factor 2		X with steel sling
up to 140 kg	Factor 0	X	X
	Factor 1		X
	Factor 2		

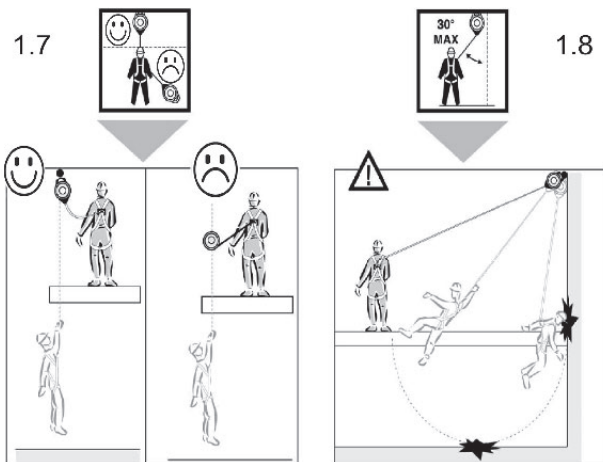

Fig. 1

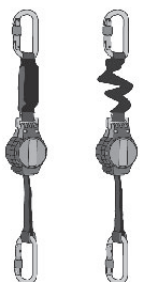
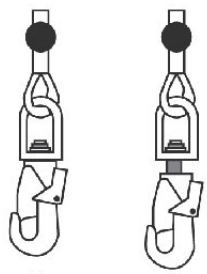
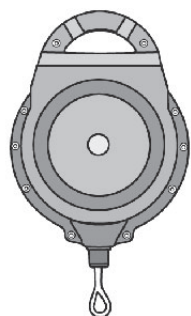
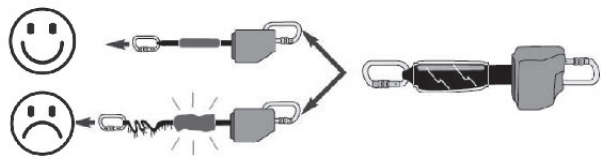

Fig. 2

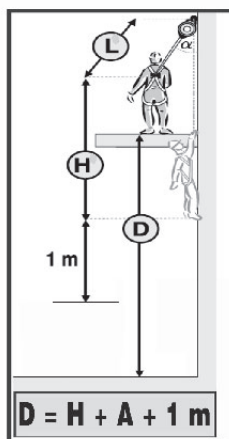
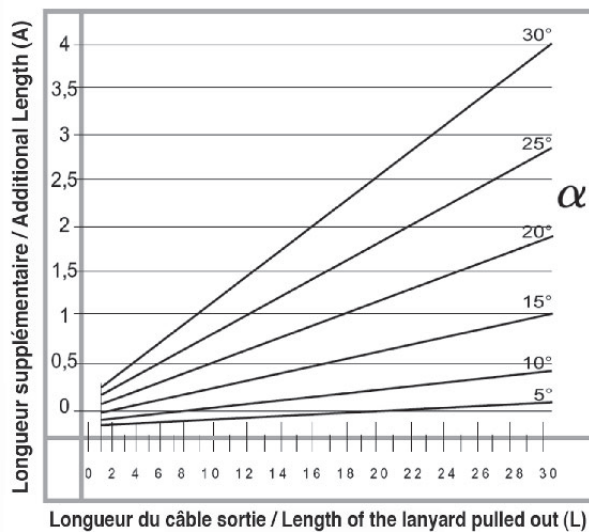

Fig. 3

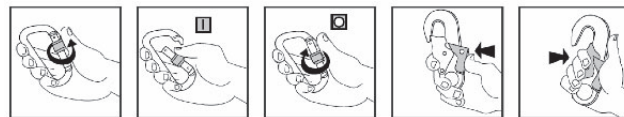

Fig. 4



INSTRUCTIONS FOR USE

Personal Protective Equipment

RETRACTABLE LIFELINE

Conforms to the CE Standard EN 360 : 2002

IMPORTANT- PLEASE NOTE:

You have just acquired Personal Protective Equipment (PPE) and we thank you for your confidence. Please follow the instructions given here

BEFORE EVERY USE OF THE

EQUIPMENT, in order to gain maximum benefit.

Failure to follow the instructions given in this manual may have grave consequences. We recommend that you re-read these instructions from time to time. In addition, the manufacturer or its representative declines all responsibility in case of any use, storage method or maintenance carried out in any other manner than that described in this manual.

IF THE BUYER IS NOT THE END USER, IT IS IMPORTANT THAT THESE INSTRUCTIONS ARE GIVEN TO THE END USER

In the interests of the user's safety, if the product is re-sold outside of the original destination country, the seller must provide the following information in the language habitually used in the country of use:

- ✓ maintenance instructions for periodical examination;
- ✓ instructions concerning repairs;
- ✓ additional information required that is specific to the equipment.

A fall arrest harness is the only body harness that is legal for use in a fall arrest system.

It is necessary to be completely sure before use that the recommendations specific to each element associated with this product are respected, as defined in their instructions, that they comply with the applicable European standards or otherwise any other appropriate standard and that their safety functions do not interfere with one another.

Whenever possible, it is strongly recommended that this equipment be

personally assigned to a single user.

Check that the product you have just acquired is compatible with the recommendations of the other system components.

While in use, protect your PPE against all risks connected with the work environment : thermal, electrical or mechanical shocks, acid splashes, sharp edges, etc. ...

WARNING

Activities carried out at a height are dangerous and can result in serious accidents and injuries. Please bear in mind that you are personally responsible in case of an accident, injury or fatality to either yourself or a third party during or following the use of one of our products. It is recommended that training in the use of our products is carried out under the supervision and instruction of a competent and experienced person. Ensure that you have been adequately trained in the use of this PPE and make sure that you have fully understood how it works. If you are in any doubt, do not take any risks but seek advice.

Good physical condition is necessary in order to carry out work at a height. Certain medical conditions can endanger the safety of the user during normal use of the harness and in case of emergency (taking medication, cardiovascular problem ...). If you have any doubts, ask your doctor.

HOW DOES IT WORK?

The retractable type fall arrester must be attached to a reliable anchorage by its karabiner. The automatic karabiner situated at the end of the cable or of the strap must be attached to the attaching point of the fall arrest harness (cf EN 361:2002). During the ascent and/or the descent of the user, the cable will be kept in tension by the retracting spring integrated into the equipment. In event of a fall, the clamping internal system will stop the cable uncoiling thanks to the activation of a calibrated lock which will stop the fall in optimal conditions.

The equipment is adjusted in factory so, to keep its results, under no circumstances its adjustment must be changed.

THE CHANGE OF AN ADJUSTMENT WOULD MAKE THE EQUIPMENT DANGEROUS

CHECKING BEFORE USE

Before each use, carry out a thorough visual examination to ensure that the PPE, as well as any other equipment with which it could be associated (connector, lanyard...) is complete. Make all necessary arrangements for the implementation of any rescue in total safety. In the event of your product being damaged, consult the manufacturer or his agent. If you have any doubts regarding the safe condition of the product, or if the product has been used to arrest a fall, it is essential to your personal safety that the PPE be withdrawn from service and sent back to the manufacturer or a qualified repair centre for checking, or destruction. Following examination, the centre will either deliver or refuse written authorisation to re-use the PPE.

It is strictly forbidden to modify or repair a PPE yourself. Only the manufacturer or a repair centre is qualified to carry out these repairs (fig. 1.1).

When the system is delivered with an integrated equipment, it is forbidden to replace one of the components of this system.

Carefully check the following points :

- ✓ All the cable or the webbing winds out and in freely.
- ✓ The braking function operates by giving a quick tug on the cable. The cable should brake immediately. (Picture 1.2)
- ✓ The device is in good condition and the screws and the closing rivets are present and suitably fixed.
- ✓ The extremity of the cable or the webbing is suitably swaged or sewed.
- ✓ The carabiners provided with the device function and lock correctly.
- ✓ There is no trace of corrosion on the metallic parts.
- ✓ The cable or webbing does not show any sign of wear (tear, fraying, breaking, corrosion, etc...) (Picture 1.3)

NOTE

Self-retractable fall arresters are designed essentially to operate in a vertical position. However, Some models are also capable of operating in the horizontal position (for confirmation, contact the maker of his agent). But, before installing, it is highly advisable to check there is no risk of pendulum movement and to protect the cable from any cutting edges or abrasive surfaces .

For retractable fall arrester fitted with a fall indicator, check before use that the fall indicator has not been activated. Its activation demonstrates that the device has been subjected to a fall or a significant traction force. In this case, the device must be returned to the manufacturer or to a certified repair centre for checks (Picture 2)

USE

Connexion :

- ✓ The retractable type fall arrester harness can be connected to a reliable anchorage point by its handle or by a connector, a lanyard, a fibre-type sling compliant with standards EN 362, EN 354, EN 795.
- ✓ The connector situated at the end of the cable or of the strap of the equipment must be connected to the fall arrest anchorage point of the harness.

ATTENTION DO NOT ATTACH THE CABLE OF THE FALL ARRESTER TO OTHER POINTS THAN THOSE INTENDED FOR THIS SYSTEM. DO NOT ATTACH IT DIRECTLY TO THE WEBBING, ON THE ADJUSTMENT ELEMENTS OR ON THE ACCESSORY HOLDER. THE "D" BACK ANCHORAGE POINT OF THE HARNESS IS THAT WHICH WILL ALLOW, IN THE CASE OF A FALL, THE BEST POSITIONING (Picture 1.4)

Limits of use :

- ✓ Maximum human load : 100 kg (Picture 1.5)
- ✓ Temperature of use : from - 30°C to + 50°C (Picture 1.6)
- ✓ Must always be placed above the user (Picture 1.7)
- ✓ Limit of pendular movement inferior to 30° (Picture 1.8)
- ✓ Can not stop a sinking (pulverulents or muddy products) (Picture 1.9)

Precautions of use :

- ✓ Check that the height of the anchorage point above the work space is compatible with the capacity of the fall arrester and that sufficient clearance exists, which is compatible with the characteristics of the device in the case of a fall.
- ✓ Check that during use, the cable or the webbing does not get wound around an arm or a leg.
- ✓ Never try to modify or to repair PPE; Only the manufacturer or a certified maintenance centre is authorised to repair it.
- ✓ Never connect more than one person to the fall arrester.
- ✓ Never block the winding out of the cable.
- ✓ The cable or the strap must always be tensed. In case of "slack", the equipment must be checked by the manufacturer.
- ✓ Lateral movements mustn't exceed one third of the distance ground / working surface.
- ✓ Make your movements on a normal walking speed. Accelerations, climbs and others engage the clamping system of the equipment.

This equipment is designed for a vertical use. If your cable drum has been designed for a special use (horizontal or inclined) you must follow the recommendations of the additional specific instruction.

AIR CLEARANCE

Before using a cable drum, check for a minimum space clearance below the user's feet as necessary, to prevent any collision with the structure or the ground.

With a weight of 100 kg in a normal use (cable drum above the head), the air clearance D is the stopping distance H + an additional distance A + 1M. A is function of the length of cable out L and the angle α formed by the cable (or D, H, A and L in m and α in °) (Picture 3).

ANCHORAGE POINT :

Choose, if possible, an anchorage point that conforms to the standard EN 795: that is to say elements fixed to last, to a structure (wall, post...).

Check that the anchorage point :

- ✓ has a resistance superior to 10 KN (Picture 1.10)
- ✓ is situated above the operator (Picture 1.7)
- ✓ vertical to the work surface : (angle maxi $\pm 30^\circ$).
- ✓ Suits at best the anchoring system
- ✓ Does not present sharp edge.

CARABINER

Connector is compliant with standard EN 362

- ✓ When the carabiner is used for attachment to an anchorage point, check for compliance with the recommendations of the "ANCHORAGE POINT" paragraph ;

AT THE MOMENT OF CONNECTION TO THE CARABINER, CHECK THAT THE LOCKING SYSTEM IS CORRECTLY IN PLACE

ATTENTION

The carabiner is an essential element for your safety. We therefore recommend that you:

- ✓ attribute the connector to one person in particular, where possible;
- ✓ check the carabiner before each use in order to safeguard against any distortion, any sign of use and to verify the good functioning of the locking system. (Picture 4)
- ✓ do not attach and remove it several times during the same working day, if it has a manual lock

IN THE SAME WAY, IF THE CARABINER HAS BEEN USED TO STOP A FALL, IT IS ESSENTIAL FOR SAFETY REASONS TO RETURN IT FOR CHECKS.

PERIODIC EXAMINATION

These instructions must be kept with the product. Fill in the identification sheet and enter the markings information. This periodic examination, which verifies the effectiveness and strength of the equipment is indispensable in guaranteeing the user's

safety. A qualified person (manufacturer or a person or organization authorized by the manufacturer) must examine this equipment at least once each year, in strict compliance with the instructions of the manufacturer and the examination must be recorded on the attached sheet. The frequency of the examination must be increased in accordance with regulations in case of heavy usage or in difficult environmental conditions. The legibility of the product markings must be checked.

MAINTENANCE AND STORAGE

Good maintenance and storage of your PPE will prolong the working-life of your product, while also ensuring your safety. The retractable fall arresters do not require any particular maintenance. However, it is advised to: o regularly clean the cable or the webbing and to checkkits state (cf § cleaning above) (Picture 1.11). To know the lanyard composition, see the additional specific instruction.

- ✓ Keep the lanyard in a place ventilated and far from direct fire or any other source of heat.
- ✓ do not oil the device (Picture. 1.12)
- ✓ check the functioning and the braking of the device.
- ✓ make sure that no foreign body is in the casing.
- ✓ store the fall arrester, hanging up, in a ventilated place away from humidity and from ultraviolet lights (Picture 1.13)
- ✓ Avoid any corrosive, overheated or refrigerated atmosphere.

CLEANING

For textile components,

- ✓ Clean them with water and soft soap. Never use acid solvents or bases (Picture 1.14).

For metallic cables,

- ✓ Brush them. Do not use solvents, water or detergent.
- ✓ Grease them regularly with universal grease.

LIFESPAN

The estimated lifespan of the product is 5 years. However, the following factors may reduce the performance of the product and its lifespan : in correct storage, improper use, fall arrest, deformation, contact with chemical products (alkali and acid), exposure to sources of heat > 60°C .

In order to improve the working-life of your device, it is advised not to:

- ✓ let go of the cable when it is completely unwound but follow it when it winds back into the fall arrester. (Picture 1.15)
- ✓ leave the cable or the webbing out when not in use.
- ✓ expose the device to violent manipulations or to shocks.
- ✓ expose the fall arrester to bad weather.



TRANSPORT

During transport, check that your PPE is stored well away from any source of heat, damp, corrosive atmosphere, ultraviolet rays, etc. ...

PACKAGING

This PPE is sold in rot proof and waterproof plastic packaging, with its instructions for use.

MARKINGS

- ✓ The name, trademark or any other means of identifying the manufacturer or the supplier,
- ✓ The product description and/or its reference, size,
- ✓ The material(s) of the main synthetic fibres used in constructing the equipment,
- ✓ The year of manufacture,
- ✓ The batch or serial number.
- ✓ EN xxx : xxxx xxxx : European standard numbers complied with, and their year
- ✓  0333 CE logo followed by the no. of the notified body responsible for the testing phase of the production,
- ✓  : The standardized pictogram informing the user to read the instructions.
- ✓ A capital "A" indicating the fall arrest harness attachment parts.
- ✓ A half-capital "A" indicating the attaching parts to be connected to the fall arrest harness.

