

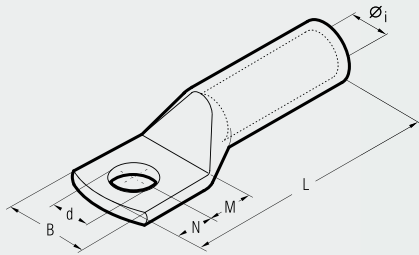

HEAVY DUTY COPPER TUBE TERMINALS

2A-M



Conductor Size sqmm	Ø Stud mm	Ref.	Dimensions mm						Quantity Box/Bag	Mechanical Tools		Hydraulic Tools					
			Øi	B	M	N	L	d		HN 5	TN 70 SE	HT 45-E	HT 51	RH 50	B 51	B 55	RHU 81
16	8	2 A 3-M 8	5,8	15,0	9	8	43,5	8,4	600/100	HN 5	TN 70 SE	HT 45-E	HT 51	RH 50	B 51	B 55	RHU 81
	10	2 A 3-M 10	5,8	18,0	11	10	47,5	10,5	500/100								
25	8	2 A 5-M 8	7,0	15,0	9	8	51,0	8,4	400/100	TN 70 SE	HT 45-E	HT 51	RH 50	B 51	B 55	RHU 81	
	10	2 A 5-M 10	7,0	18,0	11	10	55,0	10,5	300/50								
25	12	2 A 5-M 12	7,0	21,0	14	12	60,0	13,2	300/50	TN 70 SE	HT 45-E	HT 51	RH 50	B 51	B 55	RHU 81	
	8	2 A 7-M 8	8,9	17,0	9	8	53,0	8,4	250/50								
35	10	2 A 7-M 10	8,9	19,0	11	10	57,0	10,5	250/50	TN 70 SE	HT 45-E	HT 51	RH 50	B 51	B 55	RHU 81	
	12	2 A 7-M 12	8,9	21,0	14	12	62,0	13,2	250/50								
50	10	2 A 10-M 10	10,0	20,0	11	10	63,0	10,5	200/50	TN 120 SE	HT 45-E	HT 51	RH 50	B 51	B 55	RHU 81	
	12	2 A 10-M 12	10,0	21,0	14	12	68,0	13,2	150/50								
50	14	2 A 10-M 14	10,0	25,0	16	14	72,0	15,0	150/50	TN 120 SE	HT 45-E	HT 51	RH 50	B 51	B 55	RHU 81	
	16	2 A 10-M 16	10,0	26,0	18	16	76,0	17,0	150/50								
63	10	2 A 14-M 10	11,3	21,0	11	10	70,0	10,5	100/50	TN 120 SE	HT 45-E	HT 51	RH 50	B 51	B 55	RHU 81	
	12	2 A 14-M 12	11,3	22,0	14	12	75,0	13,2	100/50								
70	14	2 A 14-M 14	11,3	25,0	16	14	79,0	15,0	100/50	TN 120 SE	HT 45-E	HT 51	RH 50	B 51	B 55	RHU 81	
	16	2 A 14-M 16	11,3	26,0	18	16	83,0	17,0	100/50								
95	10	2 A 19-M 10	13,5	25,0	11	10	76,5	10,5	75/25	TN 120 SE	HT 45-E	HT 51	RH 50	B 51	B 55	RHU 81	
	12	2 A 19-M 12	13,5	25,0	14	12	81,5	13,2	75/25								
95	14	2 A 19-M 14	13,5	25,0	16	14	85,5	15,0	75/25	TN 120 SE	HT 45-E	HT 51	RH 50	B 51	B 55	RHU 81	
	16	2 A 19-M 16	13,5	27,0	18	16	90,5	17,0	75/25								
120	20	2 A 19-M 20	13,5	29,5	22	20	97,5	21,0	75/25	TN 120 SE	HT 45-E	HT 51	RH 50	B 51	B 55	RHU 81	
	10	2 A 24-M 10	15,2	28,5	11	10	82,0	10,5	50/25								
125	12	2 A 24-M 12	15,2	28,5	14	12	87,0	13,2	50/25	TN 120 SE	HT 45-E	HT 51	RH 50	B 51	B 55	RHU 81	
	14	2 A 24-M 14	15,2	28,5	16	14	91,0	15,0	50/25								
150	16	2 A 24-M 16	15,2	28,5	18	16	95,0	17,0	50/25	TN 120 SE	HT 45-E	HT 51	RH 50	B 51	B 55	RHU 81	
	20	2 A 24-M 20	15,2	30,0	22	20	103,0	21,0	50/25								
150	10	2 A 30-M 10	16,7	31,5	13	11	92,0	10,5	50/25	TN 120 SE	HT 45-E	HT 51	RH 50	B 51	B 55	RHU 81	
	12	2 A 30-M 12	16,7	31,5	16	14	98,0	13,2	30/15								
185	14	2 A 30-M 14	16,7	31,5	18	16	102,0	15,0	30/15	TN 120 SE	HT 45-E	HT 51	RH 50	B 51	B 55	RHU 81	
	16	2 A 30-M 16	16,7	31,5	19	17	104,0	17,0	30/15								
185	20	2 A 30-M 20	16,7	31,5	22	20	110,0	21,0	30/15	TN 120 SE	HT 45-E	HT 51	RH 50	B 51	B 55	RHU 81	
	12	2 A 37-M 12	19,2	35,5	16	14	108,0	13,2	30/15								
240	14	2 A 37-M 14	19,2	35,5	18	16	112,0	15,0	30/15	TN 120 SE	HT 45-E	HT 51	RH 50	B 51	B 55	RHU 81	
	16	2 A 37-M 16	19,2	35,5	19	17	114,0	17,0	30/15								
240	20	2 A 37-M 20	19,2	35,5	22	20	120,0	21,0	30/15	TN 120 SE	HT 45-E	HT 51	RH 50	B 51	B 55	RHU 81	
	12	2 A 48-M 12	21,1	39,0	16	14	109,0	13,2	20/5								
300	14	2 A 48-M 14	21,1	39,0	18	16	113,0	15,0	20/5	TN 120 SE	HT 45-E	HT 51	RH 50	B 51	B 55	RHU 81	
	16	2 A 48-M 16	21,1	39,0	19	17	115,0	17,0	20/5								
300	20	2 A 48-M 20	21,1	39,0	22	20	121,0	21,0	25/5	TN 120 SE	HT 45-E	HT 51	RH 50	B 51	B 55	RHU 81	
	12	2 A 60-M 12	23,7	44,0	20	14	129,5	13,2	20/5								
400	14	2 A 60-M 14	23,7	44,0	22	16	133,5	15,0	20/5	TN 120 SE	HT 45-E	HT 51	RH 50	B 51	B 55	RHU 81	
	16	2 A 60-M 16	23,7	44,0	22	19	136,5	17,0	20/5								
400	20	2 A 60-M 20	23,7	44,0	24	23	142,5	21,0	20/5	TN 120 SE	HT 45-E	HT 51	RH 50	B 51	B 55	RHU 81	
	12	2 A 80-M 12	27,0	51,0	22	19	140,0	13,2	15/5								
500	14	2 A 80-M 14	27,0	51,0	22	19	140,0	15,0	10/5	TN 120 SE	HT 45-E	HT 51	RH 50	B 51	B 55	RHU 81	
	16	2 A 80-M 16	27,0	51,0	22	19	140,0	17,0	10/5								
500	20	2 A 80-M 20	27,0	51,0	24	23	146,0	21,0	15/5	TN 120 SE	HT 45-E	HT 51	RH 50	B 51	B 55	RHU 81	
	16	2 A 100-M 16	30,3	56,5	22	19	147,0	17,0	10/5								
600-630	20	2 A 100-M 20	30,3	56,5	24	23	153,0	21,0	10/5	TN 120 SE	HT 45-E	HT 51	RH 50	B 51	B 55	RHU 81	
	16	2 A 120-M 16	33,4	61,5	22	19	159,0	17,0	20/5								
800	20	2 A 120-M 20	33,4	61,5	24	23	165,0	21,0	20/5	TN 120 SE	HT 45-E	HT 51	RH 50	B 51	B 55	RHU 81	
	20	2 A 160-M 20	38,0	72,0	24	23	187,0	21,0	12/3								
1000	20	2 A 200-M 20	44,0	80,0	24	23	202,0	21,0	6/2	TN 120 SE	HT 45-E	HT 51	RH 50	B 51	B 55	RHU 81	

2A-M series are made from high purity copper tube, and are annealed. They feature a double length barrel for enhanced electrical and mechanical performance in heavy duty applications.

The absence of an inspection hole prevents the entry of water or moisture into the crimped joint making these terminals suitable for outdoor applications.

The terminals are electrolytically tin plated to prevent atmospheric corrosion. 2A-2M series terminals with double stud hole palm are available against specific requirements.

