

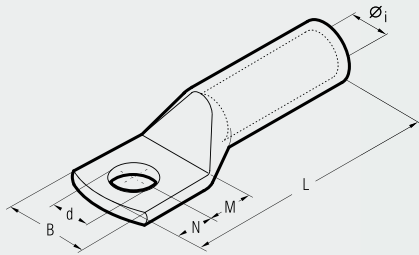

HEAVY DUTY COPPER TUBE TERMINALS

2A-M



Conductor Size sqmm	Ø Stud mm	Ref.	Dimensions mm						Quantity Box/Bag	Mechanical Tools		Hydraulic Tools				
			Øi	B	M	N	L	d		HN 5	TN 70 SE	HT 45-E	HT 51	RH 50	B 51	B 55
16	8	2 A 3-M 8	5,8	15,0	9	8	43,5	8,4	600/100	HN 5	TN 70 SE	HT 45-E	HT 51	RH 50	B 51	B 55
	10	2 A 3-M 10	5,8	18,0	11	10	47,5	10,5	500/100							
25	8	2 A 5-M 8	7,0	15,0	9	8	51,0	8,4	400/100	TN 70 SE	HT 45-E	HT 51	RH 50	B 51	B 55	
	10	2 A 5-M 10	7,0	18,0	11	10	55,0	10,5	300/50							
25	12	2 A 5-M 12	7,0	21,0	14	12	60,0	13,2	300/50	TN 70 SE	HT 45-E	HT 51	RH 50	B 51	B 55	
	8	2 A 7-M 8	8,9	17,0	9	8	53,0	8,4	250/50							
35	10	2 A 7-M 10	8,9	19,0	11	10	57,0	10,5	250/50	TN 70 SE	HT 45-E	HT 51	RH 50	B 51	B 55	
	12	2 A 7-M 12	8,9	21,0	14	12	62,0	13,2	250/50							
50	10	2 A 10-M 10	10,0	20,0	11	10	63,0	10,5	200/50	TN 120 SE	HT 45-E	HT 51	RH 50	B 51	B 55	
	12	2 A 10-M 12	10,0	21,0	14	12	68,0	13,2	150/50							
50	14	2 A 10-M 14	10,0	25,0	16	14	72,0	15,0	150/50	TN 120 SE	HT 45-E	HT 51	RH 50	B 51	B 55	
	16	2 A 10-M 16	10,0	26,0	18	16	76,0	17,0	150/50							
63	10	2 A 14-M 10	11,3	21,0	11	10	70,0	10,5	100/50	TN 120 SE	HT 45-E	HT 51	RH 50	B 51	B 55	
	12	2 A 14-M 12	11,3	22,0	14	12	75,0	13,2	100/50							
70	14	2 A 14-M 14	11,3	25,0	16	14	79,0	15,0	100/50	TN 120 SE	HT 45-E	HT 51	RH 50	B 51	B 55	
	16	2 A 14-M 16	11,3	26,0	18	16	83,0	17,0	100/50							
95	10	2 A 19-M 10	13,5	25,0	11	10	76,5	10,5	75/25	TN 120 SE	HT 45-E	HT 51	RH 50	B 51	B 55	
	12	2 A 19-M 12	13,5	25,0	14	12	81,5	13,2	75/25							
95	14	2 A 19-M 14	13,5	25,0	16	14	85,5	15,0	75/25	TN 120 SE	HT 45-E	HT 51	RH 50	B 51	B 55	
	16	2 A 19-M 16	13,5	27,0	18	16	90,5	17,0	75/25							
120	20	2 A 19-M 20	13,5	29,5	22	20	97,5	21,0	75/25	TN 120 SE	HT 45-E	HT 51	RH 50	B 51	B 55	
	10	2 A 24-M 10	15,2	28,5	11	10	82,0	10,5	50/25							
125	12	2 A 24-M 12	15,2	28,5	14	12	87,0	13,2	50/25	TN 120 SE	HT 45-E	HT 51	RH 50	B 51	B 55	
	14	2 A 24-M 14	15,2	28,5	16	14	91,0	15,0	50/25							
125	16	2 A 24-M 16	15,2	28,5	18	16	95,0	17,0	50/25	TN 120 SE	HT 45-E	HT 51	RH 50	B 51	B 55	
	20	2 A 24-M 20	15,2	30,0	22	20	103,0	21,0	50/25							
150	10	2 A 30-M 10	16,7	31,5	13	11	92,0	10,5	50/25	TN 120 SE	HT 45-E	HT 51	RH 50	B 51	B 55	
	12	2 A 30-M 12	16,7	31,5	16	14	98,0	13,2	30/15							
150	14	2 A 30-M 14	16,7	31,5	18	16	102,0	15,0	30/15	TN 120 SE	HT 45-E	HT 51	RH 50	B 51	B 55	
	16	2 A 30-M 16	16,7	31,5	19	17	104,0	17,0	30/15							
150	20	2 A 30-M 20	16,7	31,5	22	20	110,0	21,0	30/15	TN 120 SE	HT 45-E	HT 51	RH 50	B 51	B 55	
	12	2 A 37-M 12	19,2	35,5	16	14	108,0	13,2	30/15							
185	14	2 A 37-M 14	19,2	35,5	18	16	112,0	15,0	30/15	TN 120 SE	HT 45-E	HT 51	RH 50	B 51	B 55	
	16	2 A 37-M 16	19,2	35,5	19	17	114,0	17,0	30/15							
185	20	2 A 37-M 20	19,2	35,5	22	20	120,0	21,0	30/15	TN 120 SE	HT 45-E	HT 51	RH 50	B 51	B 55	
	12	2 A 48-M 12	21,1	39,0	16	14	109,0	13,2	20/5							
240	14	2 A 48-M 14	21,1	39,0	18	16	113,0	15,0	20/5	TN 120 SE	HT 45-E	HT 51	RH 50	B 51	B 55	
	16	2 A 48-M 16	21,1	39,0	19	17	115,0	17,0	20/5							
240	20	2 A 48-M 20	21,1	39,0	22	20	121,0	21,0	25/5	TN 120 SE	HT 45-E	HT 51	RH 50	B 51	B 55	
	12	2 A 60-M 12	23,7	44,0	20	14	129,5	13,2	20/5							
300	14	2 A 60-M 14	23,7	44,0	22	16	133,5	15,0	20/5	TN 120 SE	HT 45-E	HT 51	RH 50	B 51	B 55	
	16	2 A 60-M 16	23,7	44,0	22	19	136,5	17,0	20/5							
300	20	2 A 60-M 20	23,7	44,0	24	23	142,5	21,0	20/5	TN 120 SE	HT 45-E	HT 51	RH 50	B 51	B 55	
	12	2 A 80-M 12	27,0	51,0	22	19	140,0	13,2	15/5							
400	14	2 A 80-M 14	27,0	51,0	22	19	140,0	15,0	10/5	TN 120 SE	HT 45-E	HT 51	RH 50	B 51	B 55	
	16	2 A 80-M 16	27,0	51,0	22	19	140,0	17,0	10/5							
400	20	2 A 80-M 20	27,0	51,0	24	23	146,0	21,0	15/5	TN 120 SE	HT 45-E	HT 51	RH 50	B 51	B 55	
	16	2 A 100-M 16	30,3	56,5	22	19	147,0	17,0	10/5							
500	20	2 A 100-M 20	30,3	56,5	24	23	153,0	21,0	10/5	TN 120 SE	HT 45-E	HT 51	RH 50	B 51	B 55	
	16	2 A 120-M 16	33,4	61,5	22	19	159,0	17,0	20/5							
600-630	20	2 A 120-M 20	33,4	61,5	24	23	165,0	21,0	20/5	TN 120 SE	HT 45-E	HT 51	RH 50	B 51	B 55	
	800	20	2 A 160-M 20	38,0	72,0	24	23	187,0	21,0							12/3
1000	20	2 A 200-M 20	44,0	80,0	24	23	202,0	21,0	6/2	TN 120 SE	HT 45-E	HT 51	RH 50	B 51	B 55	

2A-M series are made from high purity copper tube, and are annealed. They feature a double length barrel for enhanced electrical and mechanical performance in heavy duty applications.

The absence of an inspection hole prevents the entry of water or moisture into the crimped joint making these terminals suitable for outdoor applications.

The terminals are electrolytically tin plated to prevent atmospheric corrosion. 2A-2M series terminals with double stud hole palm are available against specific requirements.

