

EZiCAT 200 Quick Start Guide

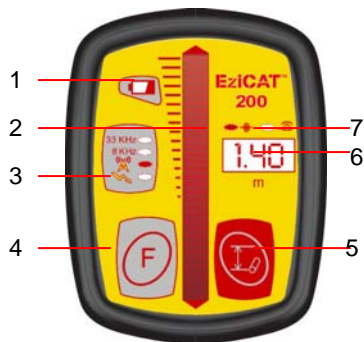

Please ensure you read the EZiSYSTEM user manual before using this product. This Quick Start Guide is NOT a substitute for the User Manual.

- | | |
|------------------------------|------------------------|
| 1 Battery Level Indicator | 6 Depth Display |
| 2 LED Bar Display | 7 Sonde/Line Mode |
| 3 LED Mode Indicator | 8 Display Panel |
| 4 Function / Mode Select Key | 9 On / Off Trigger |
| 5 Depth key | 10 Battery Compartment |



Controls:

- Switch on the EZiCAT™ by lifting and holding the On/Off trigger
- Switching on activates a start-up test which checks the display LEDs, speakers and batteries.
- The battery light starts to flash when approximately 20% battery life remains. Change all batteries at the same time using quality alkaline replacements.
- The EZiCAT™ **always** starts in POWER mode and at maximum sensitivity for the safety of the operator.
- Pressing the Function key changes the EZiCAT™ mode between Power, Radio, 8kHz and 33kHz Generator modes. The selected mode is indicated by the illuminated LED.
- The central LED bar indicates signal strength and the display will rise as a service is detected, giving a peak reading when directly over the service.



Sweep Search

POWER Mode RADIO Mode

Sweep Search:

- Mark out the site to be scanned.
- In POWER mode cross the site from left to right, keeping the EZiCAT™ upright. **DO NOT SWING.**
- Mark any responses with marker paint, flags or similar. CAUTION: Never drive pegs into the ground over the service
- Turn through 90° and repeat across the site.
- Change to RADIO mode and repeat the process in both directions.

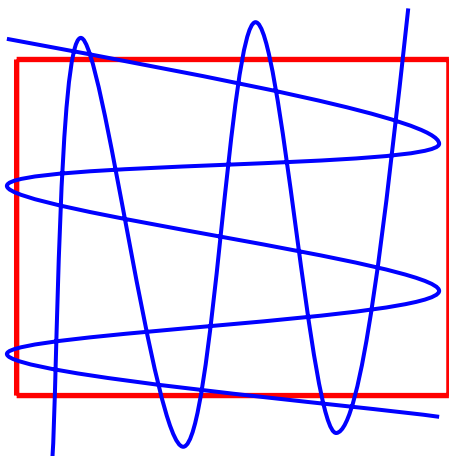

Automatic Pinpointing:

The EZiCAT™ has automatic pinpointing which accurately pinpoints the position of the service without manual adjustment. Always walk right across the service, from 'no detection' through the detection area, then to 'no detection' again. As you retrace your steps the EZiCAT™ audio signal automatically adjusts, reducing the service footprint at each pass until the service has been accurately pinpointed. Peak reading on the visual display occurs when directly over the service.

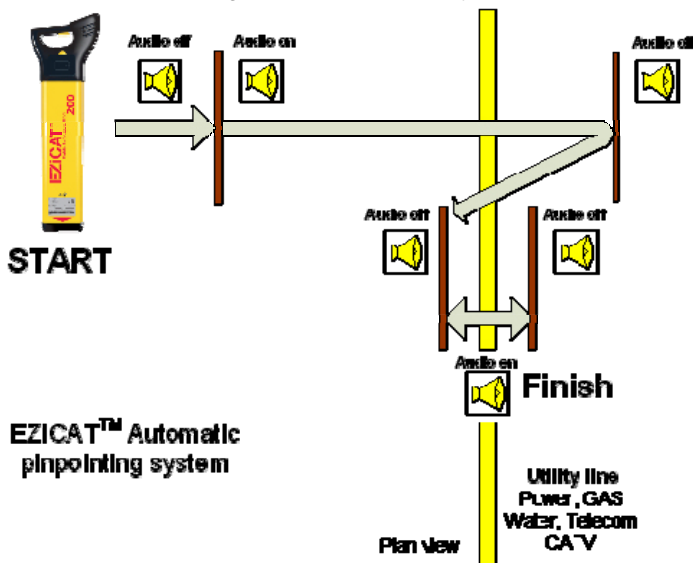

Service Direction:

Once the service has been pinpointed, rotate the EZiCAT™ until the signal display reduces to a minimum - this will indicate service direction.

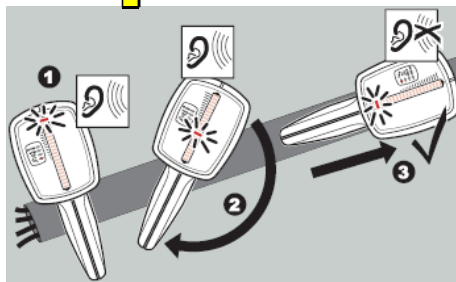

Depth :

The EZiCAT™ 200 will indicate the depth of the Service when used in conjunction with the EZiTRACE Signal Generator.

- Ensure that the EZiCAT™ and EZiTRACE™ are both set to 33kHz.
- Pinpoint the service and position the EZiCAT™ at 90° to its direction.
- Press the depth key to display the depth reading.

Please note the depth is to the **CENTRE** of the buried service

