

Phoenix Cable Clamp Datasheet

The Cableclamps have been successfully tested for fire resistance in accordance with BS 8491:2008 and also BS 5839-1: 2002, section 26.2d.

Short Circuit testing in accordance with IEC 61914:2009 has also been completed successfully. (60.1kA, Report PDL-09.203.1 Carried out at Damstra Laboratories NL)

The Phoenix Fire Rated Cableclamps are manufactured from 316L Stainless Steel.

Community Design Reg. No: 000355854-0002

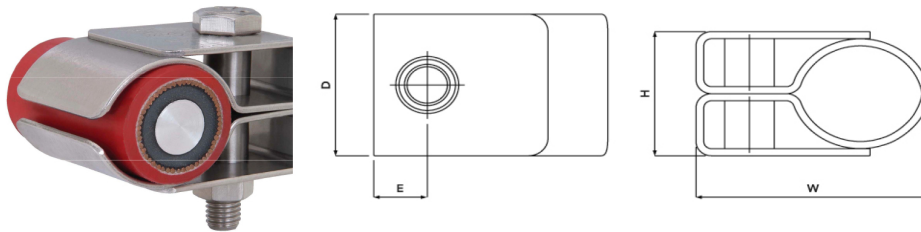

| Part Number | Cable Diameter (mm) | | Dimensions (mm) | | | | Fixing Holes | Approx. Weight (g) |
|-------------|---------------------|-----|-----------------|----|----|------|--------------|--------------------|
| | Min | Max | H | W | D | E | | |
| 1FP-10SS | 10 | 13 | 21 | 40 | 40 | 13.7 | 1 x M10 | 91 |
| 1FP-11SS | 13 | 16 | 24 | 44 | 40 | 13.7 | 1 x M10 | 106 |
| 1FP-12SS | 16 | 19 | 27 | 47 | 40 | 13.7 | 1 x M10 | 114 |
| 1FP-13SS | 19 | 23 | 31 | 51 | 40 | 13.7 | 1 x M10 | 126 |
| 1FP-14SS | 23 | 27 | 35 | 55 | 40 | 13.7 | 1 x M10 | 140 |
| 1FP-15SS | 27 | 32 | 40 | 60 | 40 | 13.7 | 1 x M10 | 155 |
| 1FP-16SS | 32 | 38 | 46 | 66 | 40 | 13.7 | 1 x M10 | 176 |
| 1FP-17SS | 38 | 46 | 54 | 74 | 40 | 13.7 | 1 x M10 | 202 |
| 1FP-18SS | 46 | 51 | 59 | 80 | 40 | 13.7 | 1 x M10 | 225 |
| 1FP-19SS | 51 | 57 | 64 | 85 | 40 | 13.7 | 1 x M10 | 245 |
| 1FP-20SS | 57 | 65 | 73 | 93 | 40 | 13.7 | 1 x M10 | 265 |

Phoenix Cable Clamps are compliant with the requirement of London Underground Standard 1-085. Product Register No. 1661



London Underground