

## Cleats & Cable Fixings

## Afumex Two Bolt Cleat

**BICON**

### Description

- > Suitable for use with cables from 50 to 94mm in diameter
- > Available in 7 sizes
- > Low Smoke and Zero Halogen
- > Suitable for use with Afumex, LSOH and LSF cables
- > LUL Approved
- > Sunlight (UV) and weather resistant
- > Two-piece, two fixing design
- > Operating temperature -20°C to +90°C
- > Can be double stacked on common fixings



**WWW.CABLEJOINTS.CO.UK**  
**THORNE & DERRICK UK**  
TEL 0044 191 490 1547 FAX 0044 477 5371  
TEL 0044 117 977 4647 FAX 0044 977 5582  
**WWW.THORNEANDDERRICK.CO.UK**

# Afumex Two Bolt Cleat

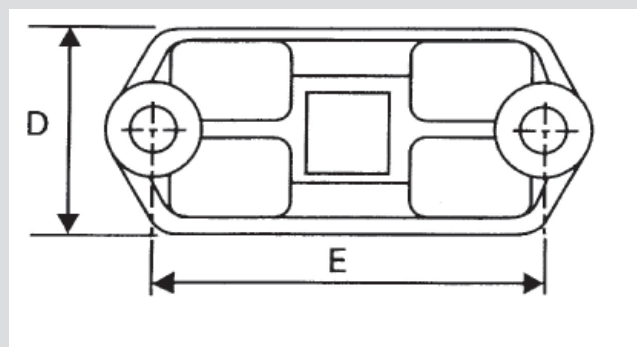
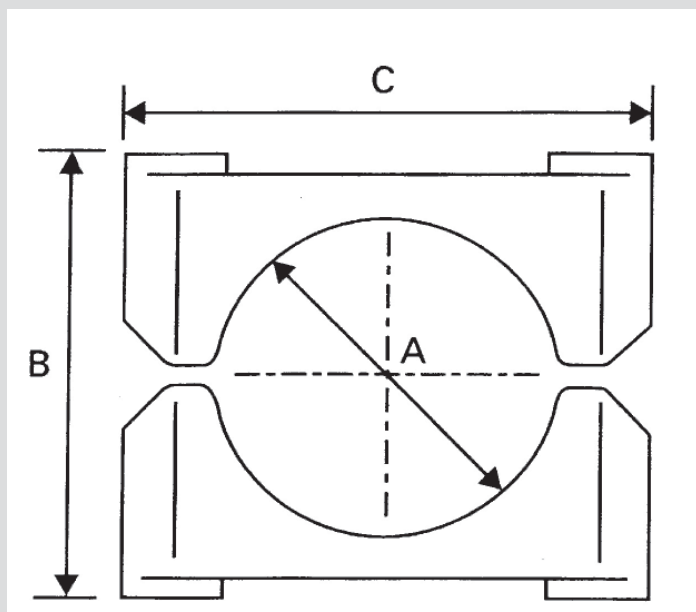

## Cable and Cleat Details

Cable & Cleat Selection Design Number	Cable Diameter A (mm)		Cleat Details				SWL FOS2 (kgf)	Approx. weight per cleat (2 halves) (g)
			Dimensions (mm)					
			B Max	C	D	E		
374LSF01	50	58	89	102	45	80	290	174
374LSF02	56	64	93	102	45	80	340	158
374LSF03	62	70	98	114	45	92	360	174
374LSF04	68	76	104	114	50	92	400	210
374LSF05	74	82	110	126	50	104	375	254
374LSF06	80	88	118	126	50	104	445	264
374LSF07	86	94	121	136	60	114	475	326

### METHOD OF FIXING

In all applications the cleat should be mounted on suitable M10 fixings.

There is no need for any channel adaptor when mounting directly on to 'C' section channel.

SWL = Safe Working Load

FOS 2 = Values include a Factor Of Safety of 2.



[WWW.CABLEJOINTS.CO.UK](http://WWW.CABLEJOINTS.CO.UK)  
**THORNE & DERRICK UK**  
 TEL 0044 191 490 1547 FAX 0044 477 5371  
 TEL 0044 117 977 4647 FAX 0044 977 5582  
[WWW.THORNEANDDERRICK.CO.UK](http://WWW.THORNEANDDERRICK.CO.UK)