

Service / Mains,  
Neutral / Earth  
Connectors

## MECHANICAL CONNECTORS

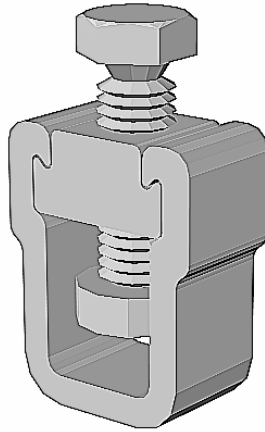

### NE20, NE21 Connectors (COPPER ALLOY)



#### Principle Application

Stranded aluminium and copper neutral/earth (CNE) conductors

#### Range

Product Reference	Conductor CSA (mm <sup>2</sup> )		Approx Unit Wt gms
	Min	Max	
NE20	10	150	100
NE21	10	95	86

The **Hepworth NE** connectors have been designed to connect the stranded copper and stranded aluminium neutral earth conductors of CNE (Waveform) service and mains distribution cables.

All joint configurations can be accommodated dependant on the total cross sectional area of neutral/earth conductor to be jointed.

Each connector is supplied complete with brass gauze as standard.

See overleaf for fitting instructions.

**NE20, NE21 Connectors (COPPER ALLOY)**

**Physical Dimensions**

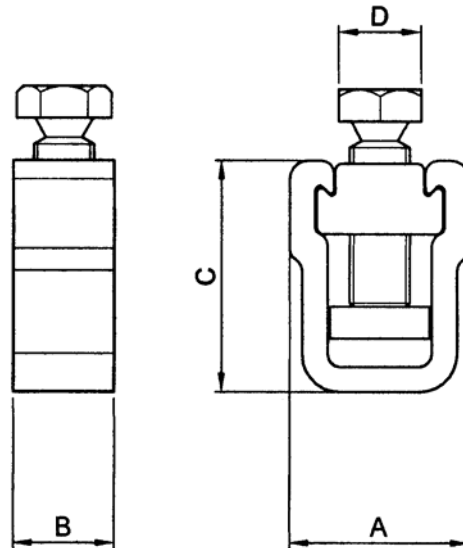

Product Reference	Dimensions (mm)			
	A	B	C	D (A/F)
NE20	28.5	16.0	36.4	13.0
NE21	28.5	16.0	30.4	13.0

**Material**

Copper Alloy

**Fitting Instructions**

1. Arrange the CNE conductors into the required number of bunches for the particular joint and, where necessary, cut the conductors to length.
2. Thoroughly abrade all conductors around the assembly area.
3. Fit the yoke around the conductors, insert the bridge piece and tighten the screw until positive location is achieved.
4. Due to the conductor employing a shear head system, check for even distribution of the conductors before finally tightening the screw until the head shears.

Note: When jointing CNE aluminium to copper conductors, ensure the supplied brass gauze is fitted around the copper conductors only.