



WWW.CABLEJOINTS.CO.UK
THORNE & DERRICK UK
TEL 0044 191 490 1547 FAX 0044 477 5371
TEL 0044 117 977 4647 FAX 0044 977 5582
WWW.THORNEANDDERRICK.CO.UK

Perfect shielding

Rittal EMC range



Perfect shielding

The ultimate in shielding for all frequencies

Today's technical measurement and control, communication and data technology systems are extremely powerful, as they contain large numbers of complex electronic components which can be highly sensitive to electromagnetic influences. Good, professional planning of electromagnetic compatibility (EMC) from the outset is therefore crucial to the lasting functional reliability of equipment and systems.

Put your trust in the expert advice and wide range of practically tested solutions from Rittal, one of the world's leading suppliers of enclosure and case technology. We have decades of expertise in the handling of various materials and are therefore able to translate the latest findings quickly and reliably into practical solutions.

Your perfect partner – from analysis to problem-solving

It's a familiar dilemma: Your product needs EMC, but you're not an EMC expert. We offer the ideal solution: Our specialists will provide you with expert assistance and advice. From obtaining initial information, to theoretical training, through to practical implementation.

An analysis of the EMC risks of your application allows us to discuss the proposed solutions and the range of products available for selection. Rittal gives you the peace of mind needed to confirm compliance with specified EMC protection targets. It's reassuring to know that you are also ideally equipped to meet the requirements of the future.





The Rittal EMC concept

Page 4 – 5

EMC wall-mounted enclosures

Terminal boxes KL

Page 6 – 7

E-Box EB

Page 6 – 7

Compact enclosures AE

Page 6 – 7

Electronic Kombi system EL, 3-part

Page 12 – 13

EMC subracks

Ripac Vario

Page 8 – 9

EMC instrument cases

Rittal Vario Case *iS*

Page 12 – 13

EMC enclosures

Baying systems TS 8

Page 10 – 11

flexRack

Page 12 – 13

EMC accessories

Page 14 – 19

Basic EMC information

Page 20 – 25

Notes/contact

Page 26 – 27

The Rittal EMC concept

■ Interference can be fatal

Rittal offers excellent pre-requisites for EMC enclosure configurations with its standard sheet steel enclosures, EMC-shielded enclosures, and a practical range of EMC accessories. Even the standard enclosures offer a good shielding effect against electrical fields which is sufficient for many applications. Depending on the individual application, anything is possible, be it closely intermeshed potential equalisation in a standard enclosure to prevent conducted interference, or extra shielding to protect against high-frequency electromagnetic fields. For large enclosures in the ES 5000 series, standard version, we can even offer fast, simple upgrades of the screening attenuation up to a maximum of 20 dB.

Rittal EMC enclosures with a high level of shielding are based on the following concept: Conductive sealing edges offer maximum protection against corrosion, thanks to aluminium zinc coating of sheet steel enclosures or chromate conversion of aluminium enclosures. In conjunction with low-resistance EMC seals, this produces a largely slot-free, electrically conductive surface, which in turn leads to excellent attenuation levels and good value for money.

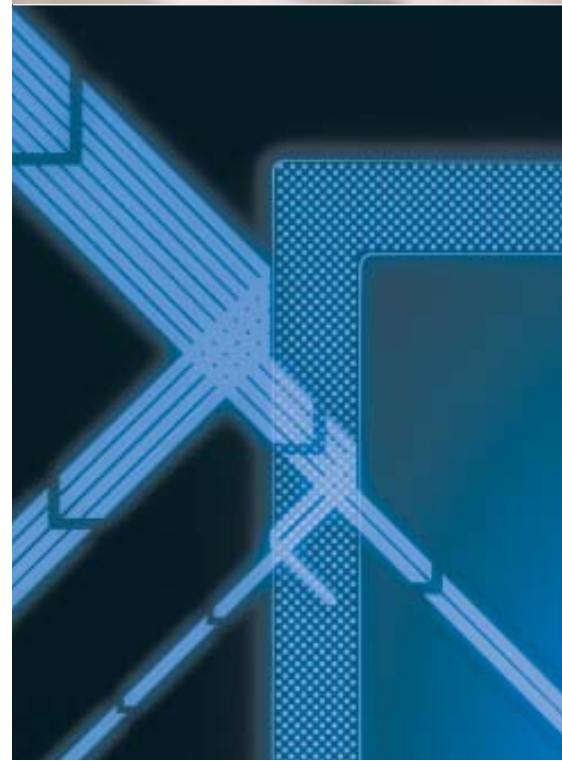

Partial shielding

It is not always necessary to provide a high level of shielding for the entire enclosure. When it comes to shielding a single source of interference in the system or protecting a particularly sensitive assembly, an “enclosure-within-an-enclosure” structure can often provide a viable alternative. The efficient use of EMC enclosures is not only a question of materials, but also a design issue. With this in mind, Rittal offers a wide selection of small enclosures and subracks which can be used for partial shielding in standard enclosures. There is an almost unlimited choice of combination variants with large enclosures and wall-mounted enclosures.

The influence of holes and slots

Openings in the structure may severely impair the local shielding effect of the highly shielded enclosure. The interference depends on the type of field, and the size and geometry of the openings. EMC viewing windows, EMC cable entry glands, EMC fan-and-filter units, wire screens and standard commercial perforated plates for the shielding of cutouts for heat dissipation and other components mean that the effects of such unavoidable leaks may be significantly reduced. The attenuation levels given were ascertained by accredited test centres to VG 95373, part 15 and the former MIL STD 285, and should be seen as orientation guidelines for sealed empty enclosures with no cutouts or other modifications. Deviations are possible, particularly with customised designs.

EMC – Standard protection

Standard enclosures of sheet steel offer adequate EMC protection in many cases, thanks to their electrically conductive material. A zinc-coated mounting plate offers the option of large-scale potential equalisation. For large enclosures in the TS 8 series, the standard protection will match or exceed the average protection levels of the predecessor model PS 4000.



EMC – Medium protection (EMC retrofitting)

In standard enclosures, medium levels of EMC protection are achieved via additional electrical connections between the enclosure and the doors/walls. Depending on the EMC requirements, contact clips may be retro-fitted to the profiles of ES enclosures to improve the EMC shielding effect. In this way, attenuation can be increased by up to 20 dB. EMC earthing straps ensure optimum potential equalisation. In TS/ES enclosures, EMC gland plates may be used for the entry of shielded cables. Shield buses for contacting the cable shields or EMC cable glands may additionally be used in all enclosures.

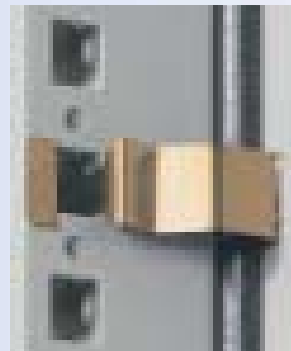

EMC – High protection

A high level of shielding is afforded by an enclosure body or enclosure frame of sheet steel with an aluminium zinc surface finish, spray-finished on the outside. The roof, base, door and sides likewise have an uncoated aluminium zinc interior finish, and therefore offer excellent slot-free contact via self-adhesive, low-resistance EMC seals to the enclosure or enclosure frame.



EMC terminal boxes KL

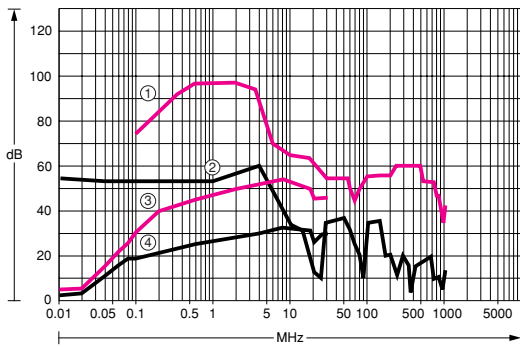

MHz = Frequency
dB = RF attenuation
① = E field, high RF attenuation
② = E field, standard
③ = H field, high RF attenuation
④ = H field, standard

| Width mm | Height mm | Depth mm | Model No. KL |
|----------|-----------|----------|--------------|
| 300 | 300 | 120 | 1507.710 |

Other sizes available on request.

Material/surface finish:

Sheet steel with aluminium zinc coating, powder coated in RAL 7032 on the outside, interior surfaces conductive.

Supply includes:

Enclosure, cover with special seal and cover screws.

Protection category:

IP 55 to EN 60 529/10.91.

The EMC version ("high RF attenuation") has been certified by the VDE.



EMC E box EB

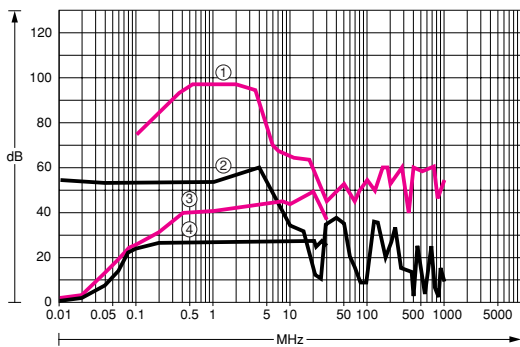

MHz = Frequency
dB = RF attenuation
① = E field, high RF attenuation
② = E field, standard
③ = H field, high RF attenuation
④ = H field, standard

All sizes available on request.

Material/surface finish:

Sheet steel with aluminium zinc coating, powder coated in RAL 7032 on the outside, interior surfaces conductive.

Supply includes:

Enclosure with mounting plate, door with special seal including 180° hinge and cam lock with double-bit insert.

Protection category:

IP 55 to EN 60 529/10.91.

The EMC version ("high RF attenuation") has been certified by the VDE.



EMC compact enclosures AE

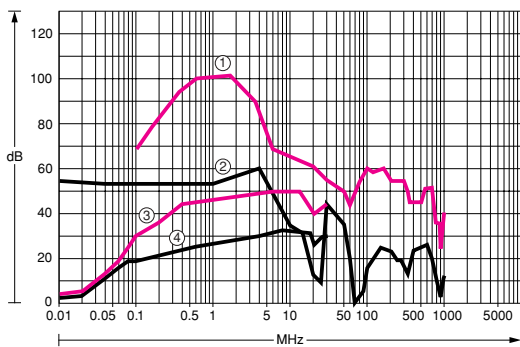

MHz = Frequency
dB = RF attenuation
① = E field, high RF attenuation
② = E field, standard
③ = H field, high RF attenuation
④ = H field, standard

| Width mm | Height mm | Depth mm | Model No. AE |
|----------|-----------|----------|--------------|
| 380 | 380 | 210 | 1380.700 |
| 600 | 380 | 210 | 1039.700 |
| 600 | 600 | 210 | 1060.700 |
| 800 | 1000 | 300 | 1180.700 |

Other sizes available on request.

Material/surface finish:

Sheet steel with aluminium zinc coating, powder coated in RAL 7032 on the outside, interior surfaces conductive.

Supply includes:

Enclosure with mounting plate, door with special seal (130° hinge) including cam lock with double-bit insert.

Protection category:

IP 55 to EN 60 529/10.91.

The EMC version ("high RF attenuation") has been certified by the VDE.





We have opted to eliminate gland plates from EMC enclosures, in order to achieve maximum shielding effectiveness.

EMC wall-mounted enclosures KL, EB, AE have the following approvals:

- UL
- CSA
- TÜV
- Norske Veritas
- Lloyds Register of Shipping
- VDE



- 1 EB:**
Opening angle 180°.
- 2 KL/EB/AE:**
The combined, self-adhesive EMC/IP seal provides reliable, long-lasting EMC/IP protection with low-resistance conductance values.
- 3 EB/AE:**
The double-bit insert is easily exchanged for standard lock inserts.
- 4 KL:**
Profile strips with mounting holes on both sides.
- 5 KL:**
Removable cover, paint-free on the inside, with cover screws. Cover screws may be exchanged for quick-release fasteners or hinges.
- 6 KL/EB/AE:**
The holes drilled in the rear panel are sealed by blind rivet nuts, thereby preserving the EMC protection when wall mounting.
- 7 KL/EB/AE:**
In all wall-mounted enclosures, the enclosure edges are kept paint-free in order to ensure contact with the door or cover via the EMC seal.



Accessories:

EMC accessories, see page 14 – 19.
EMC fan-and-filter units, see Climate Control brochure, page 142/143.
Ripac Vario EMC, see page 8 – 9.

- 8 AE:**
Opening angle 130°.
- 9 AE:**
Perforated mounting strips are spot-welded to both inner sides of the door.
- 10 EB/AE:**
The zinc-coated mounting plate installed in all EMC enclosures permits large-scale earthing of components, thereby making a direct contribution towards reducing EMC interference.

■ Ripac Vario EMC

The Ripac Vario EMC subrack system was developed with a view to EMC aspects. The subracks are equipped with a conductive surface and may be supplemented with additional EMC components such as gaskets and extrusions. This allows individual EMC requirements to be met, depending on the specific application in question.

Technical specifications:

Overall depth: 245, 285, 305, 345, 405, 465, 525, 585 mm
 Installation width: 84 HP
 Height: 3 U, 4 U, 6 U, 7 U, 9 U

Material:

Side panels: 2.5 mm aluminium plates
 Flanges and horizontal rails: Extruded aluminium section
 Cover plates: Aluminium

Surface finish:

Clear chromated

Testing:

Vibration and shock-tested to:
 IEC 600-68-2-6 test Fc
 IEC 600-68-2-27 test Ea

Standards:

Ripac Vario subracks are based on the system dimensions to DIN 41 494, part 5 and IEC 60 297-3.

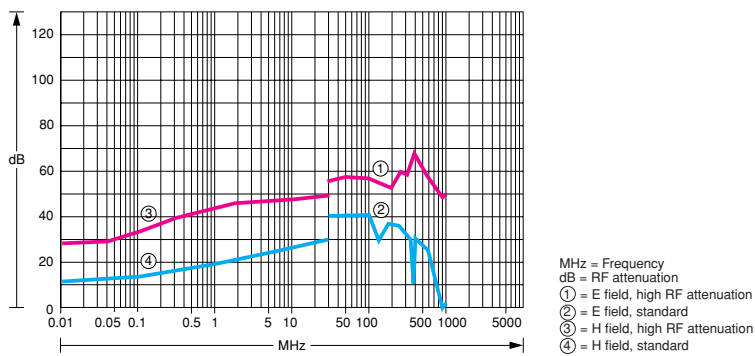

■ EMC gaskets, vertical



To ensure EMC protection between the subrack side panel and the front/rear panels. Both segmented and one-piece versions are optionally available.

■ EMC gaskets, horizontal



For horizontal EMC protection. For snap-fastening onto the front horizontal rails.

■ EMC contact strip

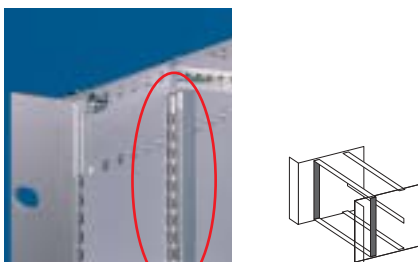

To ensure EMC protection with recessed horizontal rails. Integral channel to accommodate vertical EMC gaskets. 2 extrusions are required for each subrack.

■ Mounting blocks

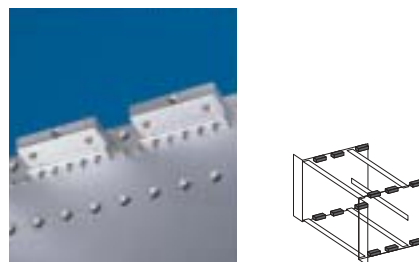

For mounting the cover plates on the subrack side panel. For EMC applications, mounting blocks must be fitted across the entire subrack depth.

■ EMC gaskets for cover plates



For EMC shielding between the horizontal rails and cover plates.



The EMC subracks in the Rittal range provide shielding for assemblies which may emit, or be sensitive to external influence.

+ Accessories:

Other accessories for EMC configuration may be found in the Rittal Electronics Catalogue.

- 1 Horizontal EMC gaskets for horizontal rails (optional).
- 2 EMC gaskets, vertical (optional).
- 3 Keyable plastic guide rails.
- 4 U-shaped EMC front panels with ejector/retainer handles.
- 5 Mounting blocks for covers.
- 6 Covers, punched or solid, with EMC gaskets.
- 7 Trim for rear 84 HP termination.



ESD clip in the PCB guide for reliable discharge of static charges.

■ EMC baying systems TS 8

The enclosure frame is of sheet steel with an aluminium zinc surface finish. All externally mounted parts likewise have a conductive aluminium zinc surface finish. The TS 8 Top Enclosure is painted on the outside, including rear panel, roof and door. There are self-adhesive EMC/IP combination seals on the zinc-plated interior surfaces, which ensure slot-free all-round contact. The base is sealed by standard gland plates with a zinc-plated surface finish, which contact the same EMC/IP seal.

Material:
Sheet steel with an aluminium zinc surface finish
Door: 2.0 mm
Rear panel: 1.5 mm
Mounting plate: 3.0 mm

Surface finish:
Framework, door, rear panel and roof plate of sheet steel with an aluminium zinc surface finish, painted in RAL 7032 on the outside and unpainted on the inside.

Protection category:
IP 55 to EN 60 529/10.91.

Supply includes:
Enclosure frame with removable door, rear panel and roof plate, r/h door hinge, can be changed to opposite side, 4 eyebolts, fitted, mounting plate, three-part gland plates.

The EMC version ("high RF attenuation") has been certified by the VDE.

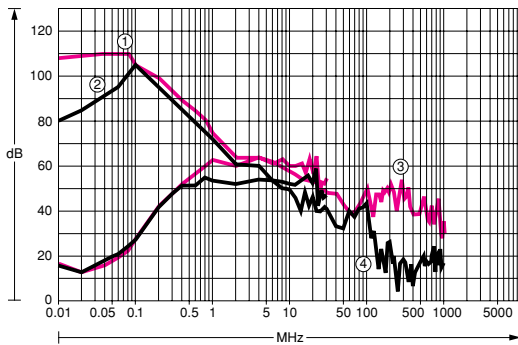

MHz = Frequency
dB = RF attenuation
① = E field, high RF attenuation
② = E field, standard
③ = H field, high RF attenuation
④ = H field, standard

Approvals:



All sizes and side panels available on request.

! Also required:

EMC baying seal TS 8800.690, see page 16, for bayed enclosures.

■ EMC free-standing enclosure ES 5000

The enclosure body is of sheet steel with an aluminium zinc surface finish. The door and rear panel likewise have a conductive aluminium zinc surface finish. The ES 5000 free-standing enclosure is painted on the outside, including the rear panel and the door. There are self-adhesive EMC/IP combination seals on the zinc-plated interior surfaces, which ensure slot-free all-round contact. The base is sealed by standard gland plates with a zinc-plated surface finish, which contact the same EMC/IP seal.

Material:
Sheet steel with an aluminium zinc surface finish
Enclosure body: 10-fold profiled
Door: 2.0 mm
Rear panel: 1.5 mm
Mounting plate: 3.0 mm

Surface finish:
Enclosure body, door and rear panel of sheet steel with an aluminium zinc surface finish, painted in RAL 7032 on the outside and unpainted on the inside.

Protection category:
IP 55 to EN 60 529/10.91.

Supply includes:
Enclosure, closed top and sides, removable rear wall, r/h door hinge, can be changed to opposite side, 2 eyebolts, not fitted, mounting plate, three-part gland plates.

The EMC version ("high RF attenuation") has been certified by the VDE.

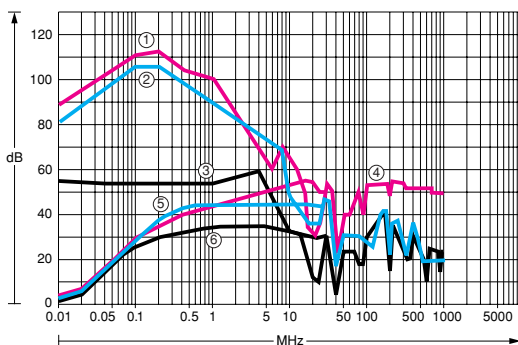

MHz = Frequency
dB = RF attenuation
① = E field, high RF attenuation
② = E field, medium RF attenuation
③ = E field, standard
④ = H field, high RF attenuation
⑤ = H field, medium RF attenuation
⑥ = H field, standard

Approvals:



All sizes available on request.

! Also required:

EMC contact clips are required in order to achieve the medium attenuation level shown in the diagram with standard enclosure, see page 17.

Baying systems TS 8, free-standing enclosure ES 5000



Accessories:

EMC accessories,
see page 14 – 19.
EMC fan-and-filter units,
see Climate Control brochure,
page 142/143.
Ripac Vario EMC,
see page 8 – 9.

**German utility model
no. 295 21 087
European patent
no. 0 857 406 with validity for
CH, ES, FR, GB, IT, NL, SE
US patent no. 6,384,323
Jap. patent no. 3 193 059**

The cost-cutting alternative to large EMC enclosures is the high shielding of potential sources of interference or sensitive components using EMC subracks or EMC small boxes.



EMC E box EB on the mounting plate.



EMC cable entry – for fast, inexpensive, reliable contact. Model No. see page 14.

EMC flexRack

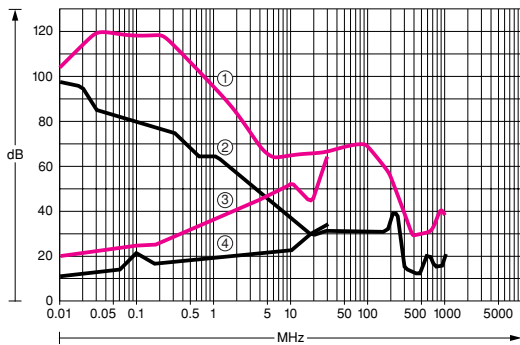

MHz = Frequency
dB = RF attenuation
① = E field, high RF attenuation
② = E field, standard
③ = H field, high RF attenuation
④ = H field, standard

Material:
Base frame: Aluminium
Cover sections:
1.5 mm sheet steel

Surface finish:
Base frame: Zinc plated, passivated
Cover sections: Yellow passivated on the inside, painted in RAL 7035 on the outside.

The EMC version ("high RF attenuation") has been certified by the VDE.



| U | Width mm | Height mm | Depth mm | Model No. FR |
|----|----------|-----------|----------|------------------|
| 33 | 600 | 1600 | 600 | 2100.260 |
| 42 | 600 | 2000 | 600 | 2100.360 |
| 33 | 600 | 1600 | 800 | 2100.460* |
| 42 | 600 | 2000 | 800 | 2100.560* |

* Delivery times available on request

Supply includes:
1 base frame,
1 rear door, solid,
1 front door, solid,
(door with Ergoform-S handle and security insert),
2 side panels,
1 gland plate, one-piece,
1 roof plate, solid,
4 levelling feet,
EMC seals.

EMC electronic Kombi system EL, 3-part

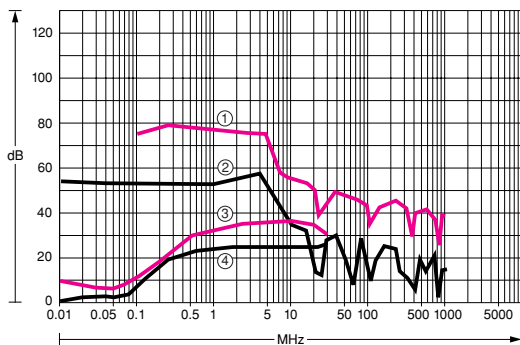

MHz = Frequency
dB = RF attenuation
① = E field, high RF attenuation
② = E field, standard
③ = H field, high RF attenuation
④ = H field, standard

Material:
Wall unit and centre part:
1.5 mm sheet steel, yellow passivated on the inside
Mounting plate:
2.75 mm sheet steel
Front door:
Extruded aluminium section, die-cast aluminium corner connectors,
4 mm safety glass, with EMC mesh.

Surface finish:
Textured stove enamel, enclosure RAL 7032, interior surfaces zinc plated and yellow passivated, door frame RAL 7033.

Protection category:
IP 55 to EN 60 529/10.91

| U | Width mm | Height mm | Depth mm | Model No. EL |
|----|----------|-----------|----------|------------------|
| 3 | 600 | 212 | 415 | 2243.700* |
| 6 | 600 | 345 | 415 | 2246.700* |
| 9 | 600 | 478 | 415 | 2249.700* |
| 6 | 600 | 345 | 515 | 2256.700* |
| 9 | 600 | 478 | 515 | 2259.700* |
| 15 | 600 | 746 | 515 | 2265.700* |
| 21 | 600 | 1012 | 515 | 2271.700* |

* Delivery times available on request

Supply includes:
1 wall unit, solid,
2 gland plates, solid,
1 centre part, hinged,
2 x 482.6 mm (19") mounting angles, fitted,
1 mounting plate, zinc-coated, passivated,
1 front door with EMC safety glass.

EMC Vario-Case iS

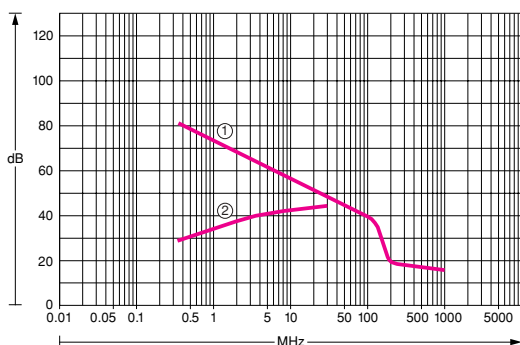

MHz = Frequency
dB = RF attenuation
① = E field, high RF attenuation
② = H field, high RF attenuation

Instrument case for 482.6 mm (19") modules and modular assemblies to DIN 41 494, part 5
Width: 534 mm

Material:
Side panels:
Extruded aluminium section, chromated on the inside, painted on the outside
Cover trays:
Plastic to UL 94-V0 (self-extinguishing), with conductive coating on the inside

Rear panel:
2 mm aluminium, chromated
Front panel:
2 mm aluminium, chromated

Surface finish:
Chromated/painted, RAL 7030/7035.

| HP | U | Height mm | Depth mm | Model No. VC |
|----|---|-----------|----------|------------------|
| 84 | 4 | 208.10 | 300 | 3743.700* |
| 84 | 7 | 341.40 | 400 | 3774.700* |
| 84 | 3 | 163.65 | 300 | 3733.700* |
| 84 | 3 | 163.65 | 400 | 3734.700* |
| 84 | 6 | 297.00 | 400 | 3764.700* |
| 84 | 6 | 297.00 | 500 | 3765.700* |
| 84 | 9 | 430.50 | 500 | 3795.700* |

* Delivery times available on request

Supply includes:
2 plastic cover trays,
8 enclosure feet (12 with 400 mm depth),
2 side panels,
1 rear panel,
1 front panel,
4 x 482.6 mm (19") mounting angles,
4 threaded inserts,
4 plain inserts,
assembly parts.

flexRack, electronic Kombi system EL, Vario-Case iS



EMC flexRack has the following approvals:

- UL
- CSA



EMC electronic Kombi system EL, has the following approvals:

- TÜV
- Norske Veritas
- Russian Maritime Register of Shipping
- Lloyds Register of Shipping
- VDE
- UL – Underwriters Laboratories Inc. For USA and Canada



- 1 Front door with EMC safety glass.
- 2 Aluminium door frame.
- 3 Lock system, may be exchanged for Ergoform-Mini handle.
- 4 482.6 mm (19") mounting angles, depth-adjustable.
- 5 Continuous knife edge.
- 6 Centre part of 1.5 mm sheet steel, multi-folded, yellow passivated on the inside.
- 7 Wall unit locked from the front.
- 8 Removable cable gland plate top and bottom.
- 9 Bonded EMC seal for protection category IP 55.
- 10 Extruded aluminium section side panels, interior surface chromated.
- 11 Plastic base and cover tray, coated in aluminium. Conductive connection to the side panels via RF spring seal system.
- 12 Removable side panel, yellow passivated on the inside.
- 13 One-part solid roof panel, removable.

+ Accessories:

EMC accessories, see page 14 – 19.
EMC fan-and-filter units, see Climate Control brochure, page 142/143.
Ripac Vario EMC, see page 8 – 9.

- 14 Depth-adjustable 482.6 mm (19") or metric mounting angles (accessories).
- 15 Torsionally rigid aluminium section.
- 16 Removable, one-part gland plate.
- 17 Solid, removable front/rear door with EMC seal and Ergoform-S handle.

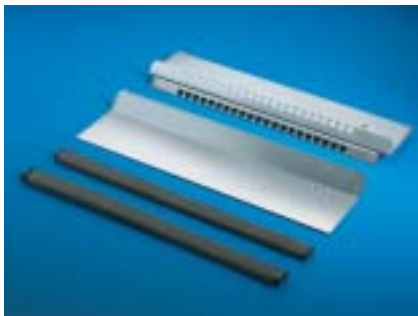

EMC gland plates

For shielded cables with a maximum diameter of 20 mm. EMC cable shield contact over a conductive rubber cable clamp strip. Combined EMC/IP seal provides low-resistance contact between cable shield and gland plate. For all enclosures with a depth of 400, 500, 600 and 800 mm.

German patent no. 196 04 219

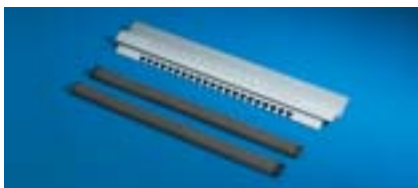

Single-row version (upper illustration):

For one cable entry level in conjunction with standard gland plate.

Supply includes:

- 1 gland plate with twin hammer-head punching,
- 1 sliding gland plate,
- 2 IP/EMC gaskets.

| Width mm | Model No. TS | | Model No. PS |
|----------|------------------------|------------------------|--------------------------|
| | single-row | twin-row | single-row ²⁾ |
| 600 | 8800.660 | 8800.760 | 4314.060 |
| 800 | 8800.680 | 8800.780 | 4314.080 |
| 1000 | 8800.600 ¹⁾ | 8800.700 ¹⁾ | 4314.100 |
| 1200 | 8800.620 ¹⁾ | 8800.720 ¹⁾ | 4314.120 ¹⁾ |

Packs of 1 kit

¹⁾ For one enclosure half only

²⁾ For installation in ES, PC enclosures based on ES and PS, universal console with contact clip PS 4313.000, see page 17.

Twin-row version (bottom illustration):

May only be used in conjunction with single-row EMC gland plates. Provides a further cable entry level.

Supply includes:

- 1 gland plate with twin hammer-head punching and integral sliding gland plate,
- 2 IP/EMC gaskets.



Metal cable ties

For 360° contact of shielded cables on the EMC gland plate. The cable ties are not toothed, thereby eliminating the risk of damage to insulation and braided screens.

| Length mm | Width mm | Packs of | Model No. SZ |
|-----------|----------|----------|--------------|
| 125 | 4.6 | 50 | 2598.125 |
| 200 | 4.6 | 50 | 2598.200 |

Material:

AISI 316 (similar to V4A), anti-magnetic and rust-proof.



Tightening tool

For simple tightening of metal cable ties SZ 2598.125 and SZ 2598.200.

Material:

- Handle: Polypropylene
- Blades: Chrome vanadium steel, tempered, nickel-plated.

| | Packs of | Model No. SM |
|-----------------|----------|--------------|
| Tightening tool | 1 | 2585.000 |



EMC cable entry gland

The EMC cable entry gland permits super-fast, EMC-compatible cable entry into the zinc-plated gland plates. Simply lock into position and voilà!

Other benefits include:

- 360° contact.
- Fastens without lock nuts.
- May be used with PG or metric holes.
- Adapts flexibly to existing cable diameters.

- Contact directly at the point of cable entry on the enclosure.
- The spring action means permanent contact pressure.
- The cable insulation is only stripped off at the shielded point of contact.

Material: Stainless steel

Supply includes:

Cable entry glands including seals and cable ties.

German patent no. 197 01 959



| Cable shield diameter in mm | | Hole diameter in mm | | Packs of | Model No. SZ |
|-----------------------------|----|---------------------|----|----------|--------------|
| from | to | from | to | | |
| 13 | 16 | 25 | 29 | 5 | 2491.150 |
| 18 | 22 | 30 | 34 | 5 | 2491.200 |
| 23 | 27 | 35 | 39 | 5 | 2491.250 |
| 28 | 32 | 40 | 44 | 5 | 2491.300 |

Installation diagram:

Before snap-fastened

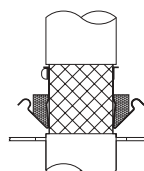

Spring-loaded piece snap-fastened, seal compressed

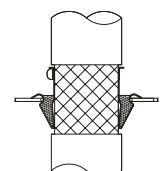



EMC cable glands

The cable sheathing may optionally be interrupted at the contact point or removed completely inside the enclosure. The cable shield in the enclosure is retained.

The supplied lock nut cuts automatically into the paint when screwed down, thus creating a conductive connection.

Protection category:
IP 68 to EN 60 529/10.91

Cable glands, PG

| PG size | Cable diameter mm | Minimum* shield diameter mm | Packs of | Model No. SZ |
|---------|-------------------|-----------------------------|----------|-----------------|
| 9 | 4 – 8 | 3 | 5 | 2411.090 |
| 11 | 5 – 10 | 4 | 5 | 2411.110 |
| 13.5 | 6 – 12 | 5 | 5 | 2411.140 |
| 16 | 10 – 14 | 8 | 5 | 2411.160 |
| 21 | 13 – 18 | 10 | 1 | 2411.210 |
| 29 | 18 – 25 | 15 | 1 | 2411.290 |
| 36 | 22 – 32 | 19 | 1 | 2411.360 |
| 42 | 30 – 38 | 27 | 1 | 2411.420 |

* Minimum shield diameter = cable diameter less cable sheathing

Cable glands, metric

| Size | Cable diameter mm | Minimum* shield diameter mm | Packs of | Model No. SZ |
|------|-------------------|-----------------------------|----------|-----------------|
| M16 | 4 – 8 | 3 | 5 | 2843.160 |
| M20 | 6 – 12 | 5 | 5 | 2843.200 |
| M25 | 10 – 14 | 8 | 5 | 2843.250 |
| M32 | 13 – 18 | 10 | 1 | 2843.320 |
| M40 | 18 – 25 | 15 | 1 | 2843.400 |
| M50 | 22 – 32 | 19 | 1 | 2843.500 |
| M63 | 34 – 44 | 30 | 1 | 2843.630 |

Other sizes available on request.

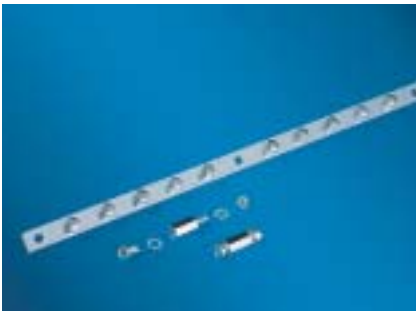

EMC shield bus

EMC shield bus of yellow passivated steel strip, 75 mm² cross section, for cable shield contact. 10 (16) connections for cable shield contact.

Supply includes:

- 1 shield bus,
 - 2 (3) slotted screws M6 x 12 mm,
 - 2 (3) M6 nuts,
 - 4 (6) serrated lock washers,
 - 2 (3) spacer bolts.
- Figures in brackets for SZ 2413.550

| Rail length mm | Packs of | Model No. SZ |
|----------------|----------|-----------------|
| 375 | 1 | 2413.375 |
| 550 | 1 | 2413.550 |



EMC earth clamps

The clamps may be used directly on the consumer or operating equipment on the mounting plate for cable shield contact.

Material:

Sheet steel, zinc plated, passivated.

| Size mm | Packs of | Model No. SZ |
|---------|----------|------------------|
| 4 | 50 | 2367.040 |
| 6 | 50 | 2367.060 |
| 8 | 50 | 2367.080 |
| 12 | 50 | 2367.120 |
| 16 | 50 | 2367.160 |
| 20 | 25 | 2367.200* |
| 25 | 25 | 2367.250* |

* 2 assembly brackets



Central earthing point

For connecting

- Earth straps
 - Earthing braids
- to the vertical and horizontal enclosure profile. The connection bracket is connected to the enclosure frame with 2 screws and is securely contacted. Earth connection is carried out via the threaded bolt M8 x 20 mm.

Material:

Sheet steel, zinc plated, passivated.

| Packs of | Model No. DK |
|----------|-----------------|
| 1 | 7829.200 |

Supply includes:

- 1 connection bracket,
- 2 screws BZ 5.5 x 13 mm,
- 2 serrated washers,
- 1 nut M8,
- 1 contact washer M8,
- 1 washer.



Assembly parts

For the attachment of earth straps and earthing straps to:

- Horizontal TS 8 enclosure sections
- PS/ES/universal console AP rail systems using captive nuts, see below.

| Size | Packs of | Model No. SZ |
|------|----------|--------------|
| M6 | 10 set | 2570.000 |
| M8 | 10 set | 2559.000 |

Captive nuts/ threaded blocks

For rectangular system punchings (10.5 x 12.5 mm) in:

- Horizontal TS 8 enclosure sections
- PS/ES/universal console AP rail systems



Captive nuts

The compression spring, designed as an insertion aid, ensures reliable mechanical and electrical connection in the system punchings.

| Thread | Packs of | Model No. PS |
|--------|----------|--------------|
| M6 | 50 | 4164.000 |
| M8 | 50 | 4165.000 |



Threaded block

With snap-off insertion aid, die-cast zinc.

| Thread | Packs of | Model No. PS |
|--------|----------|--------------|
| M6 | 50 | 4162.000 |
| M8 | 50 | 4163.000 |



Captive nuts

The nuts are inserted from the outside, thereby enabling the use of attachment points of the same height or width around corners. The spring cage also ensures electrical connection in the system punchings.

| Thread | Packs of | Model No. TS |
|--------|----------|--------------|
| M6 | 50 | 8800.340 |
| M8 | 50 | 8800.350 |

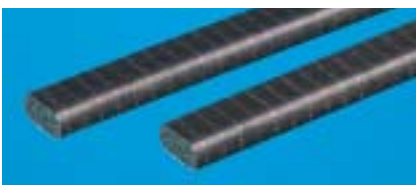

EMC baying seal

For baying enclosure systems. Seal with all-round, electrically conductive sheathing.

| For enclosures | Diameter (mm) | Model No. |
|----------------|---------------|-------------|
| TS | 6.3 x 6.3 | TS 8800.690 |
| PS | 6.4 x 3.2 | PS 4346.000 |

Packs of 1 set consisting of 3 seals, each 2 m long



EMC divider panel seal

This seal ensures optimum contact in bayed EMC enclosure systems and when using a zinc-plated divider panel.

Material:

PU foam with electrically conductive sheathing.

Supply includes:

1 roll (12.7 x 12.7 x 5300 mm)

| Packs of | Model No. PS |
|----------|--------------|
| 1 | 4348.000 |



Contact cutter

The contact cutter enables EMC-compatible preparation of the contact point e.g. for earthing straps. Plastic-bound abrasive with guide pin for round system punchings. With location point for drill, grinder etc.

| | Model No. SM |
|---------------------|--------------|
| For frame section | 2414.000 |
| For earthing bolts* | 2414.500 |

* Not necessary with TS 8

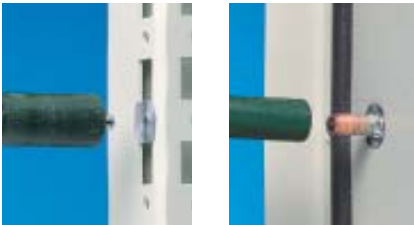

Contact paint

Contact paint prevents the corrosion of conductive, unprotected contact points.

Contents:
12 ml

| Packs of | Model No. SZ |
|----------|--------------|
| 1 | 2415.000 |

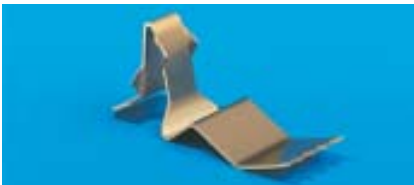

PS 4312.000

Clip for roof, side panel and rear panel
Joulean heat value $I^2 \cdot T = 0.13 \cdot 10^6 A^2 \cdot s$

Contact clips

for exclusive enclosures ES 5000

There's no faster, cheaper way of connecting a PE conductor/upgrading EMC shielding:

- Potential equalisation of the panels and the frame of the switchgear enclosure.

- PE conductor connection in accordance with EN 60 439, part 1, VDE 0660, part 500 and IEC 60 439-1 on panels to which no electrical equipment is fastened.
- Multiple-contacting increases the shielding effect by up to 20 dB, raising it to a medium shielding level.

Material:

Rust-proof spring steel



PS 4332.000

Clip for doors with square frame, with conductive surface.

| Contact clips for | Increases the shielding effect | PE conductor connection (potential equalisation) | Packs of | Model No. PS |
|----------------------------------|--------------------------------|--|----------|-----------------|
| Roof Side panel Rear panel | • | • | 50 | 4312.000 |
| Door | • | | 50 | 4332.000 |
| Mounting plate | • | • | 50 | 4334.000 |
| Gland plate | • | • | 50 | 4313.000 |
| Baying connection | • | | 50 | 4337.000 |



PS 4334.000

Clip for mounting plates with conductive surface when installed in the rearmost position. May also be retrofitted to an installed mounting plate.



PS 4313.000

Clip for gland plates
Joulean heat value $I^2 \cdot T = 0.06 \cdot 10^6 A^2 \cdot s$



PS 4337.000

Clip for baying connection



EMC viewing windows

are designed to prevent weakening of the shielding effect in enclosures with a high protection level, even with cutouts, and preserve this high standard of protection. Further information available on request.



Rail for EMC shielding bracket and strain relief

Combined rail for strain relief and EMC contacting of inserted cables.

Mounting options:

- On the horizontal/vertical TS, PC, ES enclosure section
- On a mounting plate
May also be fitted without a retaining bracket. Additional contacting on the left or right of the rail via existing holes (9 mm diameter).

Material:

Sheet steel

Surface finish:

Zinc plated, passivated

Supply includes:

- 1 rail,
- 2 retaining brackets,
- 8 screws.



| Width | Model No. SZ |
|--------|-----------------|
| 600 mm | 2388.600 |
| 800 mm | 2388.800 |



Also required:

EMC shielding bracket, see below.
Cable clamps for strain relief, see page 19.



Accessories:

Earth straps, see page 19.
Earthing strap, see page 19.

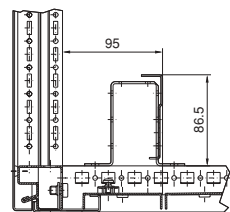
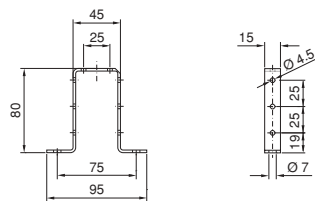
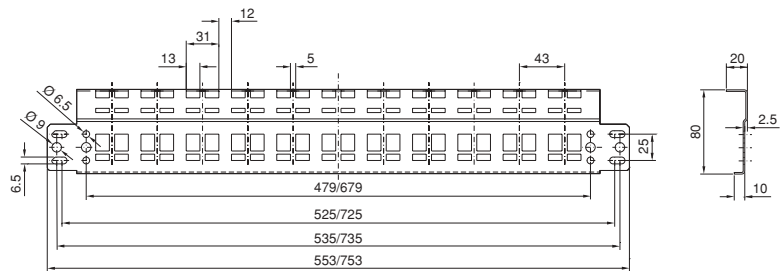

EMC shielding bracket

Diameter changes are compensated in full by the spring of the EMC shielding bracket. To attach without using tools: Press the EMC shielding bracket against the cable shield and clip into the rail.

Material:

Sheet steel

Surface finish:

Zinc plated, passivated

| For shield diameter | Packs of | Model No. SZ |
|---------------------|----------|-----------------|
| 3 – 10 mm | 10 | 2388.100 |
| 4 – 15 mm | 10 | 2388.150 |
| 10 – 20 mm | 10 | 2388.200 |
| 15 – 28 mm | 10 | 2388.280 |



Cable clamps

For strain relief of cables on rail SZ 2388.XXX, with plastic insert.

Material:
Sheet steel, zinc plated, passivated.

| For cable diameter | Packs of | Model No. DK |
|--------------------|----------|-----------------|
| 6 – 14 mm | 25 | 7077.000 |
| 12 – 18 mm | 25 | 7078.000 |
| 18 – 22 mm | 25 | 7097.000 |
| 22 – 26 mm | 25 | 7097.220 |
| 26 – 30 mm | 25 | 7097.260 |
| 30 – 34 mm | 25 | 7097.300 |
| 34 – 38 mm | 25 | 7097.340 |
| 38 – 42 mm | 25 | 7098.000 |
| 56 – 64 mm | 25 | 7099.000 |



Earth straps

Choose from 6 ready-to-use earth straps in various lengths and cross-sections. For screws M6 and M8.

| Cross-section mm ² | Packs of | Model No. SZ | |
|-------------------------------|----------|-----------------|-----------------|
| | | Length 170 mm | Length 300 mm |
| 4 | 5 | 2564.000 | 2567.000 |
| 16 | 5 | 2565.000 | 2568.000 |
| 25 | 5 | 2566.000 | 2569.000 |



Earth straps

10 mm²

For configuring a reliable earthing connection with perfect contact.

- With ring terminals in M6 and M8 to match the earthing screw
- Length-optimised and ready to install.

| For | Door/lid | Enclosures |
|---------------------------------------|----------|------------|
| KL, EB, AE 1032.XXX, AE 1035.XXX | M6 | M6 |
| AE, AP | M6 | M8 |
| TS, ES, PC, AP universal console, KEL | M8 | M8 |

| Connection | Length | Packs of | Model No. SZ |
|------------|--------|----------|-----------------|
| M6 – M6 | 200 mm | 5 | 2565.100 |
| M6 – M8 | 300 mm | 5 | 2565.110 |
| M8 – M8 | 300 mm | 5 | 2565.120 |

↔ Possible alternative:

Earth straps, see above, or earthing straps, see below.



Earthing strap

Tin-plated copper, in various lengths and cross-sections with press-fitted contact rings. Earthing straps counteract the current displacement effect at high frequencies, whilst at the same time offering highly flexible connection opportunities.

| For | Cross-section mm ² | Length mm | Packs of | Model No. SZ |
|-----|-------------------------------|-----------|----------|-----------------|
| M6 | 10 | 200 | 10 | 2412.210 |
| M8 | 16 | 200 | 10 | 2412.216 |
| M8 | 25 | 200 | 10 | 2412.225 |
| M6 | 10 | 300 | 10 | 2412.310 |
| M8 | 16 | 300 | 10 | 2412.316 |
| M8 | 25 | 300 | 10 | 2412.325 |

+ Accessories:

Central earthing point, see page 15.

Basic EMC information



■ What is meant by EMC?

Electromagnetic compatibility (EMC) is the ability of an electrical appliance to operate satisfactorily in its electromagnetic environment without adversely affecting this environment, which may also contain other equipment. High packaging densities in electronic assemblies and ever-increasing signal processing speeds often cause faults in complex electronic equipment, measurement and control systems, data processing and transmission systems, and communications technology, which are attributable to electromagnetic influences. There are fundamental requirements for:

- Defined immunity to interference
- Prevention/reduction of interference emissions.



■ Legal foundations, standardisation

EMC legislation, as national implementation of European Directive 89/336/EEC, regulates the marketing, siting and operation of equipment which may cause electromagnetic interference or whose operation may be impaired by such interference. Since 1 January 1996, the compliance of a device or system with the protection requirements of EMC legislation must be documented by the CE symbol. The contribution of enclosures to the EMC of a device or system lies primarily in the shielding effect from field-bound interference, which in the case of Rittal enclosures is measured at external laboratories to VG 95 373, part 15 and documented in the corresponding attenuation diagrams. These diagrams facilitate qualitative statements in themselves. Testing of the finished enclosure, including installed equipment, whilst in operation is indispensable for compliance with and documentation of certain limits under international regulations (e.g. radio interference suppression in accordance with EN 55 011).



Technical foundations

Basic terminology

Electromagnetic influence is the effect of electromagnetic factors on circuits, appliances, systems or living creatures.

- **Interference source** refers to the origin of interference.
- **Potentially susceptible equipment** refers to electrical equipment whose function may be affected by interference factors.
- **Coupling** refers to the interaction between circuits, where energy can be transmitted from one circuit to another.
- **Interference** is the electromagnetic factor which may induce an undesirable influence in an electrical installation (interference voltage, current or field strength).

Definition of immunity to interference

An item of electrical equipment is said to be immune to interference if interference factors (up to a certain limit) do not lead to malfunctions:

- **Functional impairment:** A permissible impairment to proper functioning.
- **Malfunction:** An impermissible impairment to proper functioning. The malfunction ends when the interference factor subsides.
- **Functional failure:** An impermissible impairment to proper functioning and which can only be eliminated e.g. by means of repair.

Emitted interference, interference model

Electrical devices which operate in an electromagnetic environment with other devices may be both transmitters (sources of interference) and receivers (potentially susceptible equipment) of interference energy. The transmission of electrical energy from one circuit to another is known as coupling.

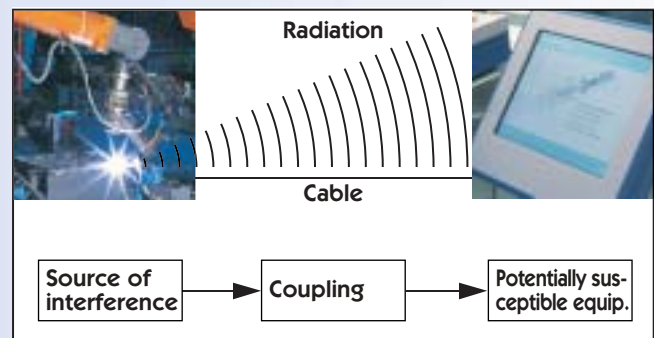

Interference sources and interference

Interference sources may be divided into:

- **Internal sources of interference:**
 - Artificial, i.e. technically induced
- **Internal sources of interference:**
 - Natural, e.g. lightning, electrostatic discharges
 - Artificial, i.e. technically induced.

In the case of technically induced interference sources, a distinction must be made between the effects of electromagnetic factors created and used for business purposes (such as radio transmitters, radar etc.), and electromagnetic factors which occur within the context of business or in the event of a failure which are not generated deliberately for the purpose of use (e.g. spark discharges on switch contacts, magnetic fields around heavy currents etc.).

Interference may be either continuous, periodic or randomly occurring and pulse-shaped.

- The most interference-intensive temporary events are caused in low-voltage networks by the switching of inductive loads, e.g. power tools, household electrical appliances, fluorescent lamps.
- The most dangerous overvoltages (in terms of level, duration and power content) are caused by deactivating fuses in the event of a short-circuit (duration in the millisecond range).

Technical foundations

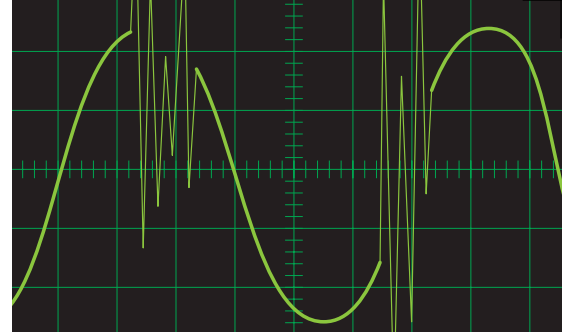

Electrostatic discharges

When solid materials rub against one another, electrostatic charges may arise which are rapidly discharged on conductive surfaces but which may persist for a long time on less conductive surfaces. Upon contact with conductive parts, the electrostatic voltages associated with such charges in non-conductors may cause interference or even destruction in electronic components as discharge current (conducted interference). Also, during discharge, an electromagnetic pulse is irradiated, representing field-bound interference. Electrostatic discharges from humans onto control components and enclosures are particularly significant. The voltages occurring in such cases may be up to 15000 V, with discharge currents of up to 5 A, and current rise rates of up to 5 kA/ μ s. The risk of malfunctions or damage is increased by poorly conductive floor coverings and low air humidity.

Influence mechanisms and counter-measures

A distinction may be made between the following coupling influences:

- Conducted interference
- Field-bound interference
 - Low-frequency field interference
 - Radiation interference (high frequency)

Conducted interference

refers to interference voltages and currents. The principal causes lie in the mechanical switching of electrical equipment (particularly inductive loads such as motors, transformers, throttling via electronic systems). Coupling of interference source and potentially susceptible equipment can occur via various "routes": conductive, inductive, capacitive or wave interference are the relevant terms.

Field-bound interference (low frequency)

Very low-frequency currents cause a low-frequency magnetic field which may induce interference voltage or initiate interference via direct magnetic effects (magnetic memory in computers, monitors, sensitive electromagnetic test equipment such as EEG). Low-frequency electric fields of high intensity may be generated by low-frequency high voltages (high-voltage overhead cables), resulting in interference voltage (capacitive interference). Of practical significance are magnetic fields, the effects of which can be reduced via

- Shielded cables
- Shielding enclosures (the decisive material property is that of permeability, which is too low in the case of sheet steel; nickel iron, for example, is much better).
- Distance from the field source

Radiation interference (high frequency)

Interference can be reduced via:

- Shielded cables
- Shielding enclosures (Faraday cage!).



Electromagnetic interference (EMI)

Enclosure/RF shielding

High-frequency electrical currents and voltages in electronic circuits may initiate electromagnetic waves (e.g. mobile radio transmission stations, radar, as well as industrial high-frequency installations such as microwave drying, bonding and welding). These, in turn, may generate interference voltage in cables or directly in electronic assemblies via enclosure openings. Every metal enclosure already offers good basic shielding within a broad frequency range,

i.e. attenuation of electromagnetic fields. High shielding attenuation levels in the frequency range above approx. 5 MHz can be achieved via special seals which conductively connect the conductive inner surfaces of doors and removable panels, roof and gland plates to the conductive sealing edges of the enclosure body or frame, largely in a slot-free manner. The higher the frequencies occurring, the more critical openings in the enclosure become.

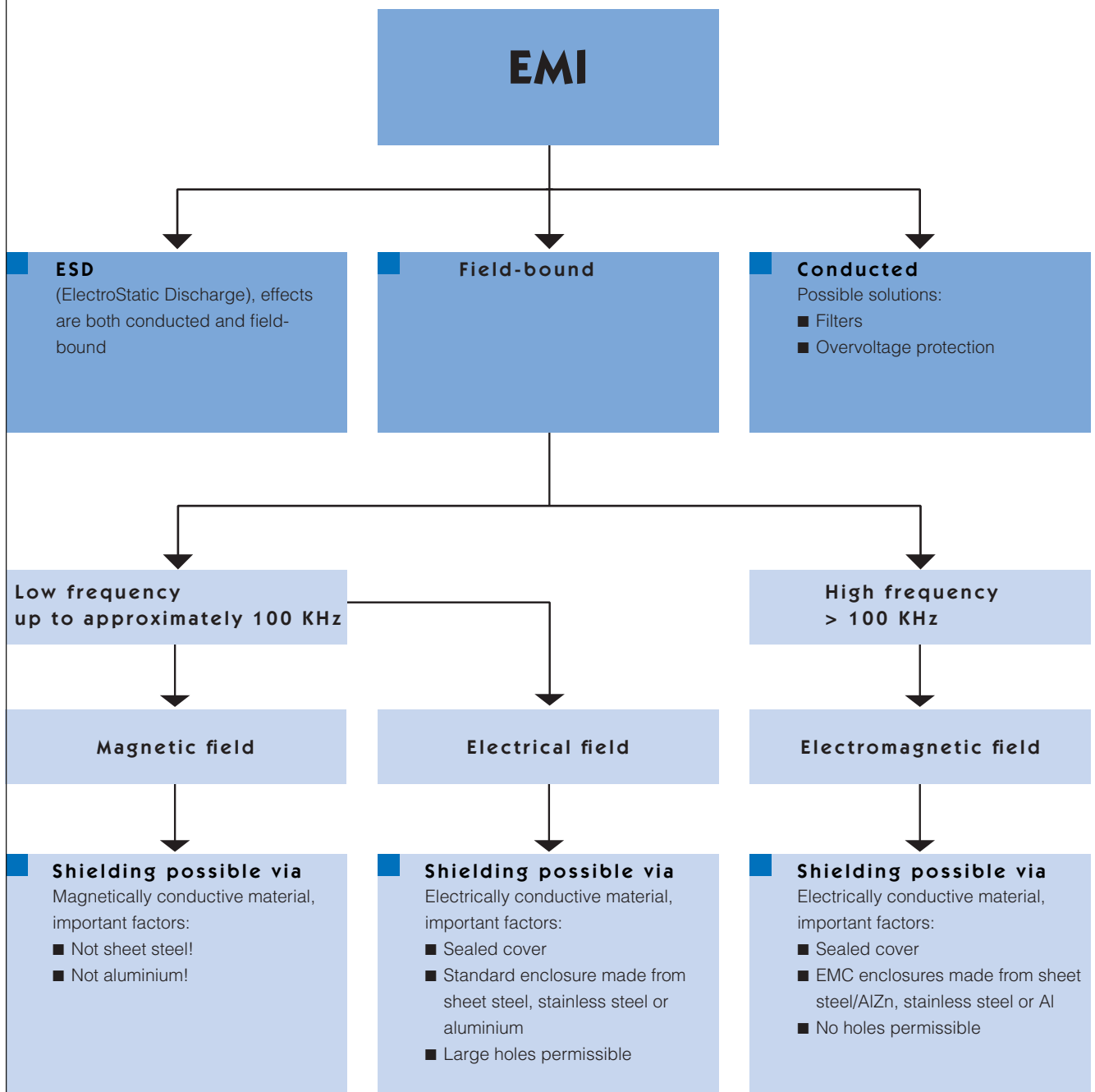

Basic EMC information

Practical EMC tips when handling components that emit interference

- With the inverters available on the market today, it is impossible to maintain a level of radio interference suppression without a radio interference suppression filter at the mains input. Line filters also boost a system's resistance to interference.
- Cables between the inverter and motor must be shielded: Shield contact on both sides.
- Metallic components in the enclosure must have a large surface area and should be connected to one another with a high level of RF conductivity. Avoid surface finishes such as eloxal which have very high resistance levels.
- Relays, contactors and magnetic valves installed in the same circuit must be connected via arc extinguishing combinations or overvoltage-limiting components.
- Analog control leads should be shielded on one side and contacted inside the enclosure where possible. Ensure low-resistance connections across a large area!
- Digital signal cables should be shielded on both sides across a large area with low-resistance contact. In case of differences in potential, an additional equalising conductor should be laid parallel. Separable connections must always be equipped with metal-cased connectors!
- Avoid spare loops on all connection cables! These could result in RF short-circuiting of the above measures. Unassigned strands in the cable should be connected to potential equalisation at both ends.
- Unshielded cables in a circuit, i.e. outward and return conductors, should be twisted against symmetrical interference sources.
- Physically separate "hot" and "cold" cables at the planning stage. Pay special attention to the motor cable. The area around the shared terminal strip for the mains input and motor output is particularly at risk.
- The cable routing in an enclosure should be as close as possible to the reference potential; "free-floating cables" act as both active and passive antennae!
- When operating more than one inverter on a shared network, EMC problems are to be expected. System planners should integrate interference emission of high frequency as well as interference sensitivity amongst the frequency inverters into their concept from the outset, and take appropriate counteractive action.





How do I interpret a shielding attenuation diagram?

In all diagrams, the attenuation value of an enclosure is obtained from the anticipated interference frequency and the nature of the interference field (electrical field E, magnetic field H or electromagnetic field). For example, in the diagram below, the following attenuation values are obtained with a frequency of 200 MHz.

Point 1: Electrical field, high:

$a_1 = 50$ dB

Point 2: Electrical field, standard:

$a_2 = 25$ dB

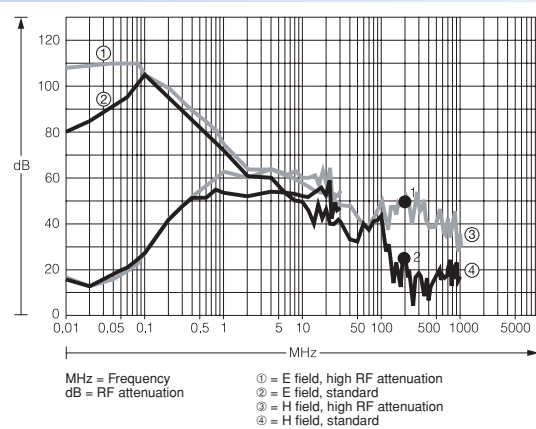

In all diagrams, the level of attenuation "a" is shown on the Y axis (vertical) in the unit "dB". This unit indicates the logarithmic ratio between the field in the environment and the field in the enclosure interior. The frequency band is entered on the X axis (horizontal) on a logarithmic scale. Attenuation "a" is obtained using the following equation:

$$a = 20 \log \frac{E_0}{E_1} \text{ and } \left. \begin{array}{l} \text{where:} \\ \text{index 0 is for} \\ \text{unshielded values} \end{array} \right\}$$

$$a = 20 \log \frac{H_0}{H_1} \left. \begin{array}{l} \text{index 1 is for} \\ \text{shielded values} \end{array} \right\}$$

Material labelling

Enclosures with aluminium zinc coatings are manufactured from hot-dip galvanized metal to DIN EN 10215.

Material specifications of steel: DX51D + AZ 100-B-C

Material parameters of surface coating:

Alloy coating 100 g/m²

Improved surface finish (B)

Surface chemically passivated (C)

Sendzimir zinc-coated mounting plates are manufactured from continuously hot-galvanized metal to DIN EN 10 142.

Material specifications of steel: DX51D + Z 140-B-C

Material parameters of surface coating:

Zinc coating 140 g/m²

Improved surface finish (B)

Coating implemented with a small flower of zinc (M)

Surface chemically passivated (C)

Notes

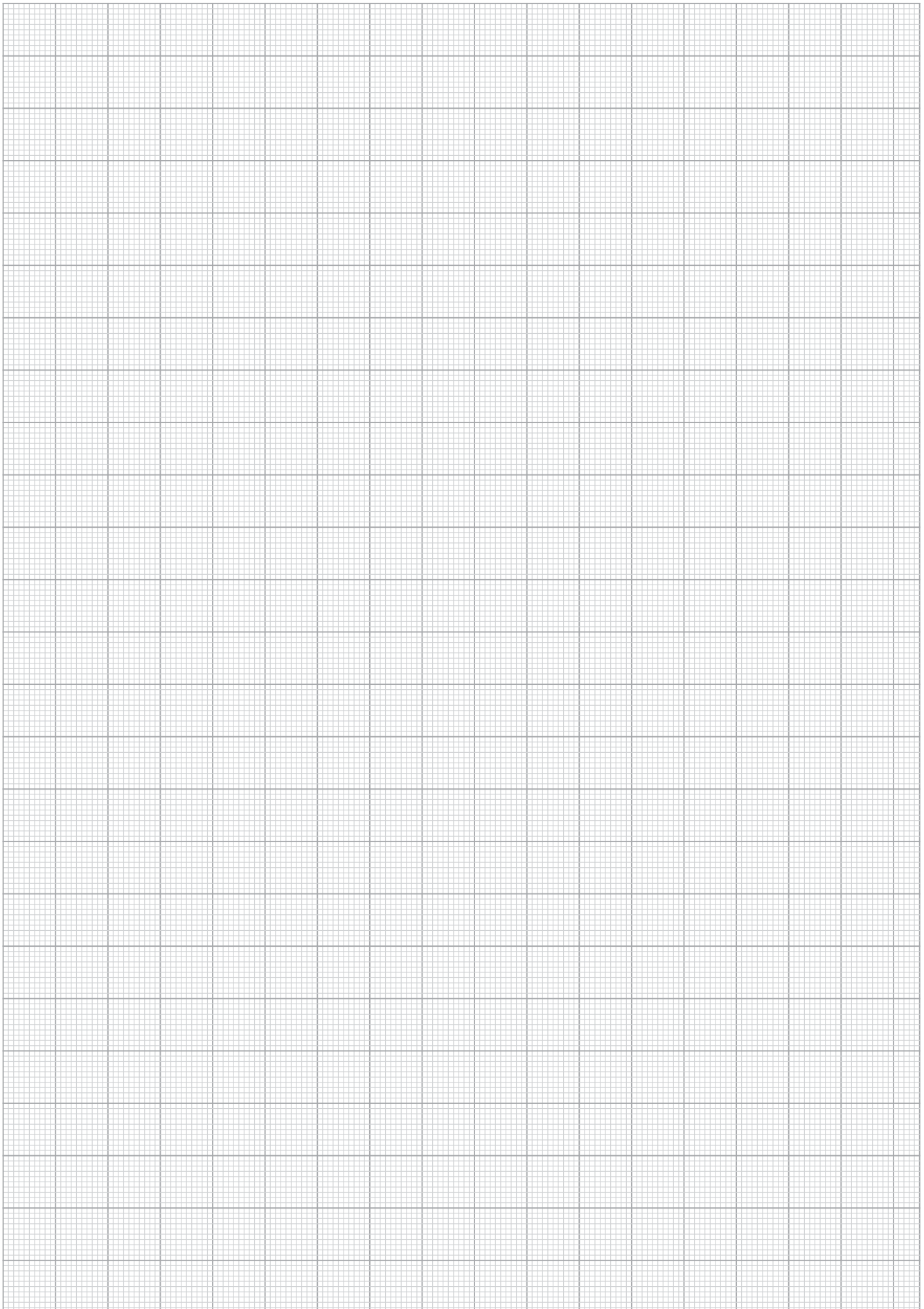

Rittal international

Agencies worldwide

Germany

Rittal GmbH & Co. KG
Postfach 1662
D-35726 Herbord
Tel.: +49 (27 72) 5 05-0
Fax: +49 (27 72) 5 05-23 19
email: info@rittal.de
www.rittal.com

Argentina

Racklatina S.A.
Av. Pedro B.
Palacios 81 - 85
1704, Ramos Mejía
Buenos Aires
Tel.: +54(11) 46 56-32 31
Fax: +54(11) 46 56-23 23
email: rack@sion.com

Australia

Rittal Pty. Ltd.
130 - 140 Parraweena Rd.
Taren Point, 2229 N. S. W
Tel.: +61(2) 95 25 27 66
Fax: +61(2) 95 25 53 02
Free Call 1800 350 665
email: info@rittal.com.au

Austria

Rittal-Schaltstränke
Ges.m.b.H.
Laxenburger Straße 246a
A-1239 Wien
Tel.: +43(1) 6 10 09-0
Fax: +43(1) 6 10 09-21
email: info@rittal.at

Bahrain

Please contact
Rittal Middle East FZE
Dubai/U.A.E.

Belarus

Netexpert
Volocha Str. 1 of 310
220036 Minsk
Tel.: +375 (172) 86 20 03
Fax: +375 (172) 56 65 15

Belgium

Rittal nv/sa
Rustrieterrein E17/3
Stokelaar 8
B-9160 Lokeren
Tel.: +32(9) 353 91 11
Fax: +32(9) 355 68 62
email: info@rittal.be
Bosnia-Herzegovina
SYS Company d.o.o.
Sibenska b.b.
BiH-71000 Sarajevo
Tel.: +387/33/27 70 90
Fax: +387/33/23 05 57
email: sys@sys.ba

Brazil

Rittal Sist. Eletrom. Ltda.
Av. Cândido Portinari,
nr. 1.174
Vl Jaguara
05114-001 São Paulo-SP
Tel.: +55(11) 36 22 23 77
Fax: +55(11) 36 22 23 99
email: info@rittal.com.br

Bulgaria

RITTBUL Ltd.
56 Gorski patnik Str. Office 5
BG-1421 Sofia
Tel.: +359(2) 65 10 66
Fax: +359(2) 96 32 51 6
email: bojkov@rittbul.bg

Canada

Rittal Systems Ltd.
7320 Pacific Circle
Mississauga, Ontario
L5T 1V1
Tel.: +1(905) 795 07 77
Fax: +1(905) 795 95 48
email: rittal.systems@rittal.ca

Chile

AMMY S.A.
Camino El Cerro 5090
Casilla 241-V C21
Huechuraba
Santiago
Tel.: +56(2) 7 40 01 02
Fax: +56(2) 7 40 10 65
email: ammysa@entelchile.net

China

Rittal Electrical Equipment
(Shanghai) Co. Ltd.
No. 353, Ri Ying North Road
P. R. China
Shanghai, 200131
Tel.: +86(21) 50 46 16 71
Fax: +86(21) 50 46 19 90
email: marketing@rittal.com.cn

Colombia

COLSEIN Ltda.
Medición y Automatización
Calle 82 No. 5 - 48
Apartado Aereo 55479
Santafé de Bogotá,
D.C. Columbia
Tel.: +57(1) 6 10 26 74
Fax: +57(1) 6 10 78 68
email: info@colsein.com.co

Costa Rica

Elvatron
400 metros norte
de la agencia del
Banco de Costa Rica
San José
Tel.: +5 06 (2 96) 10 60
Fax: +5 06 (2 32) 60 71

Croatia

Technoshell D.O.O.
Av. V. Holjevca 20/III
10020 Zagreb
Tel./Fax:
+3 85/1 65 53-5 47
email: technoshell@zg.tel.hr

Cyprus

Christos Charalambous
& Sons Ltd.
9 - 11 Zanettos Street
P.O. Box 1268
Nicosia
Tel.: +357/2 77 20 55
Fax: +357/2 45 81 97
email:
chchara@spidernet.com.cy

Czech Republic

Rittal Czech, s.r.o.
Ke Zdišsku 182
250 66 Zdiuby u Prahy
Tel.: +420 234 099 000
Fax: +420 234 099 099
email: info@rittal.cz

Denmark

Duelco a/s
Holtvej 10
Hoeruphav
6400 Soenderborg
Tel.: +45-74 41 52 84
Fax: +45-74 41 52 09
email:
soenderborg@duelco.dk

Dubai/U.A.E.

Rittal Middle East FZE
Warehouse GC2
P.O. Box 17 599
Jebel Ali Free Zone - Dubai
U.A.E.
Tel.: +971(4) 8 83 41 31
Fax: +971(4) 8 83 42 44
email:
info@rittal-middle-east.com

Egypt

Rittal Egypt S.A.E.
45, Gamiat Al Dewal
Al Arabia St.
Mohandesine, Giza
Tel.: +2(012) 74 28 012
Fax: +2(012) 74 82 276

Finland

Rittal Oy
Vailimite 35
PL 134
01510 Vantaa
Tel.: +358 9 4 13 44 00
Fax: +358 9 4 13 44 410
email: info.keskus@rittal.fi

France

Rittal France SAS
880, rue Marcel Paul
Z.A. des Grands Godets
94507 Champigny
sur Marne Cedex
Tel.: +33(1) 49 83 60 00
Fax: +33(1) 49 83 82 06
email: info@rittal.fr

France-East

Sermes S.A.
14, rue des Frères Eberts
Boîte Postale 177
67025 Strasbourg-Cedex
Tel.: +33(3) 88 40 72 00
Fax: +33(3) 88 40 72 49
email:
appareillage@sermes.fr

Great Britain

Rittal Limited
Braithwell Way
Hellaby Industrial Estate
Hellaby
Rotherham
S.Yorks
S66 8QY
Tel.: +44(17 09) 70 40 00
Fax: +44(17 09) 70 12 17
email:
information@rittal.co.uk

Greece

RITTAL EPE
Thessaloniki 98
14342 Nea Philadelpia,
Athen
Tel.: +30/210/27 17 975
976
Fax: +30/210/27 12 398
www.rittal.gr

Guatemala

INTEK
Ingeniería y Tecnología
Via 5 y Ruta 3,
Zona 4 Esquina
01004 Guatemala, C.A.
Tel.: +50(2) 332 1489
332 4336
Fax: +50(2) 334 4338

Hong Kong

Ranger
Enterprise Co. Ltd.
Units A-B, 8/F, Block 1
Tai Ping Industrial Center
57 Ting Kok Road
Tai Po, N. T.
Hong Kong
Tel.: +852 24 20 89 28
Fax: +852 24 94 92 28
email:
sales@ranger.com.hk

Hungary

Rittal Kereskedelmi Kft.
Ipari Park u. 1.
1044-Budapest
Tel.: +36(1) 399 8000
Fax: +36(1) 399 8009
email: rittal@rittal.hu

Iceland

Smith & Norland h/f
Nóatúni 4
P.O. Box 519
121 Reykjavik
Tel.: +354 520 3000
Fax: +354 520 3011
email: smnor@smnor.is

India

Rittal India Pvt. Ltd.
Nos. 23 & 24 Kiadb
Industrial Area
Veerapura
Doddaballapur
Bangalore 561 203
Tel.: +91(80) 76 22 335
76 23 075
Fax: +91(80) 76 23 343
email: info@rittal-india.com

Indonesia

PT Zuellig Services
Wisma Budi, 2/F
202 Jl. H.R. Rasuna Said,
Kav. C-6
Jakarta 12940
Tel.: +62(21) 5296 1448 /58 /68
Fax:
+62(21) 5296 1450 /60 /70
email: electrical@zi-id.com

Ireland

Rittal Ltd.
Sleaty Road
Graiguecullen
Carlow
Ireland
Tel.: +353(599) 182 100
Fax: +353(599) 132 090
email: sales@rittal.ie

Israel

Rittal Enclosure Systems Ltd.
15, Hatarshish St. Zone 29
P.O. Box 3597
Industrial Park
Caesarea 38900
Tel.: +9 72(4) 6 27 55 05
Fax: +9 72(4) 6 27 55 35

Italy

Rittal S.p.A.
S.P. n. 14 Rivoltana-Km 9,5
20060 Vignate (MI)
Tel.: +39(02) 95 93 01
Fax: +39(02) 95 36 02 09
email: info@rittal.it

Japan

Rittal K.K.
1438-1 Shimonohara
Nishi-izumida
Sakai-machi, Sashima-gun
Ibaraki 306-0431
Tel.: +81(280) 87 51 20
Fax: +81(280) 87 51 08
email: hotline@rittal.co.jp

Jordan

Please contact
Rittal Middle East FZE
Dubai/U.A.E.

Kuwait

Please contact
Rittal Middle East FZE
Dubai/U.A.E.

Lebanon

Please contact
Rittal Middle East FZE
Dubai/U.A.E.

Lithuania

Rittal UAB
Meistru 8
2038 Vilnius
Tel.: +370/5 2 306 669
Fax: +370/5 2 306 665
email: info@rittal.lt

Luxembourg

D.M.E. s.a.r.l.
Distribution de matériel
électrique
Z.A.R.E. Ouest
4384 Ehlerange
Tel.: +3 52-57 43 44
Fax: +3 52-57 43 57
email: dme@dme.lu

Macedonia

Siskon System Engineering
Taskenska 4A
MK-91000 Skopje
Tel.: +389/91/36 24 23
Fax: +389/91/36 12 50
email:
siskon@lotus.mpt.com.mk

Malaysia

Rittal Systems Sdn. Bhd.
No. 5 Jalan 4/118C
Desa Tun Razak
56000 Cheras
Kuala Lumpur
Tel.: +60(3)-9173 64 88
Fax: +60(3)-9173 64 99
email: sales@rittal.com.my

Mexico

Rittal, S.A. de C.V.
Prof. 5 de Mayo No. 29
Parque Industrial
Naucalpan
Naucalpan de Juarez
Estado de México
53489 México
Tel.: +52(55) 53 00-25 70
Fax: +52(55) 53 00-04 95
email: info@rittal.com.mx

Morocco

S.M.R.I.
Société marocaine de
réalisations industrielles
109, Rue Abou Ishak
El Marouni
20110 Casablanca
Tel.: +212-2 25 94 90
Fax: +212-2 23 77 08
email: smri@elan.net.ma

Netherlands

Rittal bv
Hengelder 56
Postbus 246
6900 AE Zevenaar
Tel.: +31(3 16) 59 19 11
Fax: +31(3 16) 52 51 45

New Zealand

Rittal Ltd.
5 Pretoria Street
P.O. Box 30-453
Lower Hutt
Wellington
Tel.: +64(4) 5 66 76 30
Fax: +64(4) 5 66 92 19

Norway

Rittal AS
Postboks 79 Stovner
Luhrtoppen 2
0913 Oslo
Tel.: +47-67 91 23 00
Fax: +47-67 91 23 23
email: rittal@rittal.no

Oman

Please contact
Rittal Middle East FZE
Dubai/U.A.E.

Peru

CE-YE-SA
Ingeniería Eléctrica
Av. Enrique Meiggs
255 - 257
Parque Internacional de
Industria y Comercio
Callao
Tel.: +51(1) 4 51 79 36
Fax: +51(1) 4 51 72 72

Philippines

Enclosure Systems
Specialist Incorporated
G/F, GE Phils Building
2291 Pasong Tamo
Extension
Makati City 1231
Philippines
Tel.: +63(2) 8 13 85 80
Fax: +63(2) 8 13 85 96
email: gardex@ibm.net

Poland

Rittal Sp. z o.o.
Ul. Królewska 6
05-825 Grodzisk Maz.
k/Warszawy
Tel.: +48(22) 724 27 84
Fax: +48(22) 724 08 52
email: rittal@rittal.com.pl

Portugal

RITTALSIS-Sistemas
Eléctricos e Electrónicos
Unipersonal Lda.
Z.I. Rio Meao/Apdo. 434
4520-907 Rio Meao,
Stª Mª da Feira
Tel.: +351 256 780 210
Fax: +351 256 780 219
email: info@rittal.pt

Qatar

Please contact
Rittal Middle East FZE
Dubai/U.A.E.

Republic of Slovakia

Rittal s.r.o.
Plynárenská 1
SK-82109 Bratislava
Tel.: +421(2) 5363 0651
Fax: +421(2) 5363 0951
email: rittal@rittalsro.sk

Romania

Cubrit s.r.l.
Sos. Chitilei, no. 114
Sector 1 - Bucharest
Romania
Tel./Fax: +40/21/3 12 94 97
email: office@cubrit.ro

Russia

Rittal OOO
Letchika Babushkina 1a
129344 Moscow
Tel.: +7(095) 775 02 30
Fax: +7(095) 775 02 39
email: info@rittal.ru

Saudi Arabia

A. Abunayyan Electric
Corp.
King Abdulaziz Street
P.O. Box 321
Riyadh 11411
Kingdom of Saudi Arabia
Tel.: +966(1) 477 91 11
Fax: +966(1) 479 33 12
email:
aec-salesmarketing@
abunayyangrp.com

Singapore

Rittal Pte. Ltd.
7 Loyang Street
Loyang Industrial Estate
Singapore 508842
Tel.: +65-65 42 68 18
Fax: +65-65 42 68 33
email: sales@rittal.com.sg

Slovenia

Rittal d.o.o.
Smartinska 152
SLO-1533 Ljubljana
Tel.: +386(1) 5466370
Fax: +386(1) 5411710
email: info@rittal.si

South Africa

Controp Rittal (Pty) Ltd.
123, Terrace Road
Sebenza
P.O. Box 462
Edenvale, 1610
Tel.: +27(11) 6 09-82 94
Fax: +27(11) 4 52-58 16
email: enclosures@
5072
controprittal.co.za

South Korea

Rittal Co. Ltd.
1 NA 509 Sihwa-Gongdan
1254-8 Jeungwang-Dong
Sihung-Shi, Gyeonggi-Do
Korea 429-450
Tel.: +82(031) 499-59 61 ~3
Fax: +82(031) 499-59 64
email: rittal@rittal.co.kr

Spain

Rittal Disprel, S.A.
Mas Baiona, 40
Polígono Industrial
Can Roqueta
08202 Sabadell
(Barcelona)
Tel.: +34(93) 700 13 00
Fax: +34(93) 700 13 01
email: info@rittal.es

S. R. Vietnam

ESACO Ltd.
15 - 17 Tran Quoc
Tah Street
District 3
Hochiminh City
Socialist Republic
of Vietnam
Tel.: +84(8) 9 30 35 80
Fax: +84(8) 9 30 31 93
email: esaco@hcm.vnn.vn

Sweden

Rittal Scandinavia ab
26273 Angelholm
Tel.: +46(4 31) 44 26 00
Fax: +46(4 31) 44 26 37
email: info@rittal.se

Switzerland

Rittal AG
Ringstrasse 1
5432 Neuenhof
Tel.: +41 056 416 06 00
Fax: +41 056 416 06 66
email: rittal@rittal.ch

Syria

Please contact
Rittal Middle East FZE
Dubai/U.A.E.

Taiwan

Rittal Systems Taiwan Ltd.
13 - 1 Fl., No. 87,
Wen Hua 3rd Rd.
Kuei Shan
Taoyuan Hsien
Taiwan
Tel.: +8 86 (3) 397-1745
(3) 327-8871
Fax: +8 86 (3) 397-2019
email:
sales.inform@rittal.com.tw

Thailand

Rittal Ltd.
101 Soi 7, Saeree 7
Rama 9 Road
Kwaeng Suanluang
Khet Suanluang
Bangkok 10250
Tel.: +66 (2) 7183 296
(2) 7183 297
Fax: +66 (2) 7183 298
email: info@rittal.co.th

Turkey

STOKS Ltd.
Zümürtevir Mah. Visne
Sok. No: 5
81530 Maltepe
Istanbul/Turkey
Tel.: +90(2 16) 4517009
4515739
Fax: +90(2 16) 4519290
email:
gsavas@stoks.com.tr

Ukraine

Advanced Network
Technology
Scherbakova Str. 37
04111 Kiev
Tel.: +38(44) 495 11 36
Fax: +38(44) 443 95 22

USA

Rittal Corporation
One Rittal Place
Springfield, OH 45504
Tel.: +1(9 37) 3 99-05 00
Fax: +1(9 37) 3 90-55 99
email: rittal@rittal-corp.com

Uzbekistan

Naytov Ltd.
Ul. Matbutsochilar 32
700047 Taschkent
Tel.: +9 98/71-132 08 56
Fax: +9 98/71-132 08 59

Venezuela

Equipos y sistemas C.A.
Edificio Centro Cyanamid,
P.B. Calle 1 - 2
La Urbina - 1073 Caracas
Tel.: +58(212) 243 6401
5072
Fax: +58(212) 243 6401

Yemen

Please contact
Rittal Middle East FZE
Dubai/U.A.E.

Yugoslavia

Vesimpex d.o.o.
Petra Konjovica 12 v
11090 Beograd
Tel./Fax:
+381/11/35 10 683
email:
info@vesimpex.co.yu

Global Rittal. Worldwide service.



Industrial enclosures



Electronic packaging



System climate control



Power distribution



IT solutions



Communication systems

Rittal has one of the largest ranges of enclosures available for immediate delivery. However, Rittal also supplies integral solutions at a high level – up to Level 4. Fully assembled and functional, according to your specific requirements. Wherever your location.

The global alliance between production, distribution and service guarantees customer proximity. World-wide! Wherever in the world you develop and implement solutions for yourself and your customers, we are close at hand.



WWW.CABLEJOINTS.CO.UK
THORNE & DERRICK UK
TEL 0044 191 490 1547 FAX 0044 477 5371
TEL 0044 117 977 4647 FAX 0044 977 5582
WWW.THORNEANDDERRICK.CO.UK

12/03 · E932



Switch to perfection **RITTAL**