



CABLE JOINTS, CABLE TERMINATIONS, CABLE GLANDS, CABLE CLEATS  
FEEDER PILLARS, FUSE LINKS, ARC FLASH, CABLE ROLLERS, CUT-OUTS

11KV 33KV CABLE JOINTS & CABLE TERMINATIONS  
FURSE EARTHING  
www.cablejoints.co.uk  
Thorne and Derrick UK  
Tel 0044 191 490 1547 Fax 0044 191 477 5371  
Tel 0044 117 377 4647 Fax 0044 117 377582



## Electrical connection system

■ <b>Copper tubular cable lugs and connectors</b>	<b>18</b>
Tubular cable lugs	20
Angle tubular cable lugs	24
Connector	28
Insulated tubular cable lugs and connectors	32
Tubular cable lugs and compression joints for fine stranded conductors	35
Tubular cable lugs and connectors for solid conductors	40
Tubular cable lugs for switchgear connections	43
Tool application chart	44
■ <b>Tubular cable lugs and connectors - nickel, stainless steel</b>	<b>50</b>
Tubular cable lugs and connectors - stainless steel	52
Tubular cable lugs and connectors - nickel	54
Tool application chart	57
■ <b>Compression cable lugs and connectors to DIN - Cu</b>	<b>58</b>
Compression cable lugs DIN 46235	60
Angle compression cable lugs	62
Compression cable lugs, special type	65
Compression joints DIN 46267, part 1 and similar versions	68
Tool application chart	74
■ <b>Solderless terminals, connectors and pin terminals to DIN - Cu</b>	<b>76</b>
Solderless terminals DIN 46234	78
Insulated solderless terminals	80
Solderless terminals, fork and pin type	82
Insulated solderless terminals for meter connections	84
Solderless connectors DIN 46341, part 1	85
Tool application chart	87
■ <b>Sleeves for compacted conductors and sector shaped conductors - Cu</b>	<b>90</b>
■ <b>Compression cable lugs and connectors to DIN - Al</b>	<b>98</b>
Compression cable lugs to DIN 46329 and similar versions - Al	100
Compression joints DIN 46267, part 2 and similar versions - Al	102
Reduction compression joints - Al	105
Compression joints, full tension - Al	107
Compression cable lugs and connectors for Al/St cables DIN EN 50182 - Al	108
Tool application chart	111
■ <b>Compression cable lugs and connectors, Al/Cu</b>	<b>114</b>
Compression cable lugs - Al/Cu	116
Compression joints - Al/Cu	118
■ <b>Clamps and screw connectors</b>	<b>122</b>
Punched cable lugs - Cu	124
Screw connectors with soldering hole - CuZn	125
Parallel groove clamps for tap off connections - Cu	127
C and H-shaped clamps	129
Screw connectors for street lighting - CuZn	132
Screw connectors, high resistant aluminium alloy	133
Compact tap connectors, high resistant aluminium alloy	150
Tool application chart	154

■ <b>Cable end-sleeves</b>	<b>156</b>
Cable end-sleeves to DIN 46228, part 1 and part 2	158
Insulated cable end-sleeves to DIN 46228, part 4 and similar versions	161
Insulated cable end-sleeves for short circuit resistant conductors	166
Insulated twin cable end-sleeves	166
Insulated cable end-sleeves, strips and tapes	167
Tool application chart	171
■ <b>Cable connections, insulated and non insulated</b>	<b>176</b>
Insulated terminals	178
Non-insulated receptacles	189
Flexible connectors	192
Tool application chart	198
■ <b>Assortments</b>	<b>202</b>
Assortment boxes with tubular und compression cable lugs	204
Pocket boxes with cable end-sleeves	205
Pocket boxes with insulated cable end-sleeves	207
Assortment boxes with cable end-sleeves	215
Assortment boxes with insulated cable end-sleeves	216
Assortment boxes with insulated terminals	219

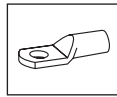

■ **Tubular cable lugs, copper 0.75 - 6 mm<sup>2</sup>**  
Ring type

■ for fine stranded conductors



**Characteristics**

- With inspection hole
- Annealed material optimises material and crimping characteristics

**Material**

- Copper to EN 13600

**Surface**

- Tin plated

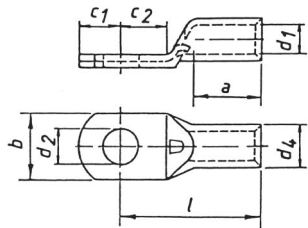

Cross-section mm <sup>2</sup>	Size of bolt Ø	Part No.	Dimensions mm								Weight/ 100 pcs.	
			d1	a	b	d2	d4	c1	c2	l	~ kg	pcs.
0.75	M3	<b>91R3</b>	1.3	6	6.0	3.2	2.8	3.25	4.0	12	0.060	100
	M4	<b>91R4</b>	1.3	6	6.5	4.3	2.8	4.00	5.0	13	0.060	100
	M5	<b>91R5</b>	1.3	6	7.5	5.3	2.8	4.75	5.5	14	0.060	100
1.5	M3	<b>92R3</b>	1.8	6	6.5	3.2	3.3	3.25	4.0	12	0.080	100
	M4	<b>92R4</b>	1.8	6	6.5	4.3	3.3	4.00	5.0	13	0.080	100
	M5	<b>92R5</b>	1.8	6	7.5	5.3	3.3	4.75	5.5	14	0.080	100
	M6	<b>92R6</b>	1.8	6	9.0	6.5	3.3	6.50	6.5	16	0.090	100
2.5	M3	<b>93R3</b>	2.3	6	7.5	3.2	4.2	3.25	4.0	12	0.120	100
	M4	<b>93R4</b>	2.3	6	7.5	4.3	4.2	4.00	5.0	13	0.120	100
	M5	<b>93R5</b>	2.3	6	8.5	5.3	4.2	4.75	5.5	14	0.130	100
	M6	<b>93R6</b>	2.3	6	9.5	6.5	4.2	6.50	6.5	16	0.150	100
	M8	<b>93R8</b>	2.3	6	13.0	8.5	4.2	7.75	9.5	20	0.180	100
4	M4	<b>94R4</b>	3.0	8	8.5	4.3	5.0	4.75	5.5	18	0.210	100
	M5	<b>94R5</b>	3.0	8	9.0	5.3	5.0	4.75	6.0	18	0.213	100
	M6	<b>94R6</b>	3.0	8	10.0	6.5	5.0	6.50	6.5	19	0.220	100
	M8	<b>94R8</b>	3.0	8	13.0	8.5	5.0	8.50	9.5	22	0.280	100
6	M4	<b>95R4</b>	4.0	9	9.5	4.3	6.0	5.00	5.5	18	0.290	100
	M5	<b>95R5</b>	4.0	9	9.5	5.3	6.0	6.00	6.0	19	0.300	100
	M6	<b>95R6</b>	4.0	9	10.0	6.5	6.0	7.00	6.5	19	0.300	100
	M8	<b>95R8</b>	4.0	9	14.0	8.5	6.0	8.50	9.5	22	0.320	100

► Tool: see chart page 44

■ **Tubular cable lugs, copper 0.75 - 16 mm<sup>2</sup>**

Fork type

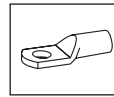

- For direct screw-mounting
- for fine stranded conductors

**Characteristics**

- With inspection hole
- Annealed material optimises material and crimping characteristics

**Material**

- Copper to EN 13600

**Surface**

- Tin plated

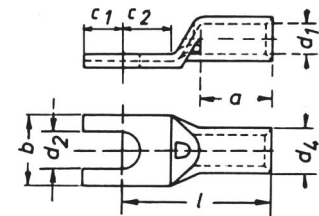

Cross-section mm <sup>2</sup>	Size of bolt Ø	Part No.	Dimensions mm								Weight/ 100 pcs.	
			d1	a	b	d2	d4	c1	c2	l	~ kg	pcs.
0.75	M3	<b>91C3</b>	1.3	6	6.0	3.2	2.8	3.25	4.0	12	0.06	100
	M4	<b>91C4</b>	1.3	6	6.5	4.3	2.8	4.00	5.0	13	0.05	100
	M5	<b>91C5</b>	1.3	6	7.5	5.3	2.8	4.75	5.5	14	0.06	100
1.5	M3	<b>92C3</b>	1.8	6	6.5	3.2	3.3	3.25	4.0	12	0.07	100
	M4	<b>92C4</b>	1.8	6	6.5	4.3	3.3	4.00	5.0	13	0.07	100
	M5	<b>92C5</b>	1.8	6	7.5	5.3	3.3	4.75	5.5	14	0.07	100
	M6	<b>92C6</b>	1.8	6	9.0	6.5	3.3	6.50	6.5	16	0.08	100
2.5	M3	<b>93C3</b>	2.3	6	7.5	3.2	4.2	3.25	4.0	12	0.12	100
	M4	<b>93C4</b>	2.3	6	7.5	4.3	4.2	4.00	5.0	13	0.11	100
	M5	<b>93C5</b>	2.3	6	8.5	5.3	4.2	4.75	5.5	14	0.12	100
	M6	<b>93C6</b>	2.3	6	9.5	6.5	4.2	6.50	6.5	16	0.10	100
4	M4	<b>94C4</b>	3.0	8	8.5	4.3	5.0	4.75	5.5	17	0.19	100
	M5	<b>94C5</b>	3.0	8	9.0	5.3	5.0	4.75	6.0	17	0.19	100
	M6	<b>94C6</b>	3.0	8	10.0	6.5	5.0	6.50	6.5	19	0.21	100
	M8	<b>94C8</b>	3.0	8	13.0	8.5	5.0	8.50	9.5	22	0.24	100
6	M4	<b>95C4</b>	4.0	9	9.5	4.3	6.0	5.00	5.5	18	0.27	100
	M5	<b>95C5</b>	4.0	9	9.5	5.3	6.0	6.00	6.0	19	0.32	100
	M6	<b>95C6</b>	4.0	9	10.0	6.5	6.0	7.00	6.5	19	0.27	100
	M8	<b>95C8</b>	4.0	9	14.0	8.5	6.0	8.50	9.0	22	0.31	100
10	M5	<b>96C5</b>	4.5	10	12.0	5.5	7.0	6.50	7.5	22	0.45	100
	M6	<b>96C6</b>	4.5	10	12.0	6.5	7.0	6.50	7.5	22	0.41	100
	M8	<b>96C8</b>	4.5	10	15.0	8.5	7.0	10.00	10.0	25	0.52	100
16	M5	<b>97C5</b>	5.5	13	12.0	5.5	8.5	5.50	6.5	26	0.81	100
	M6	<b>97C6</b>	5.5	13	12.0	6.5	8.5	6.25	7.5	27	0.81	100
	M8	<b>97C8</b>	5.5	13	15.0	8.5	8.5	8.50	9.5	29	0.90	100

► Tool: see chart page 44

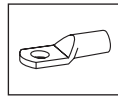
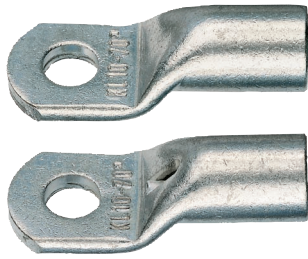

**Tubular cable lugs, copper 6 - 400 mm<sup>2</sup>**  
standard type

- For stranded round shaped conductors e.g. VDE 0295 Class 2
- For pre-rounded sector shaped conductors

**Characteristics**

- Annealed material optimises material and crimping characteristics

**Material**

- Copper to EN 13600

**Surface**

- Tin plated

**Order info**

- Also available with inspection hole, part number with „ms“

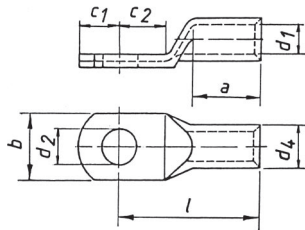

Cross-section mm <sup>2</sup>	Size of bolt Ø	Part No.	Dimensions mm								Weight/ 100 pcs.	
			d1	a	b	d2	d4	c1	c2	l	~ kg	pcs.
6	M5	<b>1R5</b>	3.5	9	10	5.5	6.5	6.50	7.5	21	0.50	100
	M6	<b>1R6</b>	3.5	9	12	6.5	6.5	6.50	7.5	21	0.47	100
	M8	<b>1R8</b>	3.5	9	15	8.5	6.5	10.00	10.0	23	0.54	100
	M10	<b>1R10</b>	3.5	9	17	10.5	6.5	12.00	12.0	25	0.59	100
	M12	<b>1R12</b>	3.5	9	19	13.0	6.5	13.00	13.0	28	0.63	100
10	M5	<b>2R5</b>	4.5	10	12	5.5	7.0	6.50	7.5	22	0.50	100
	M6	<b>2R6</b>	4.5	10	12	6.5	7.0	6.50	7.5	22	0.49	100
	M8	<b>2R8</b>	4.5	10	15	8.5	7.0	10.00	10.0	25	0.58	100
	M10	<b>2R10</b>	4.5	10	17	10.5	7.0	12.00	12.0	27	0.62	100
	M12	<b>2R12</b>	4.5	10	19	13.0	7.0	13.00	13.0	29	0.64	100
16	M5	<b>3R5</b>	5.5	13	12	5.5	8.5	5.50	6.5	26	0.84	100
	M6	<b>3R6</b>	5.5	13	12	6.5	8.5	6.25	7.5	27	0.86	100
	M8	<b>3R8</b>	5.5	13	15	8.5	8.5	8.50	9.5	29	0.93	100
	M10	<b>3R10</b>	5.5	13	17	10.5	8.5	10.50	11.5	31	0.99	100
	M12	<b>3R12</b>	5.5	13	19	13.0	8.5	12.00	13.0	33	1.02	100
25	M5	<b>4R5</b>	7.0	15	14	5.5	10.0	7.50	7.5	30	1.22	25
	M6	<b>4R6</b>	7.0	15	14	6.5	10.0	7.50	7.5	30	1.20	100
	M8	<b>4R8</b>	7.0	15	16	8.5	10.0	10.00	10.0	32	1.31	100
	M10	<b>4R10</b>	7.0	15	18	10.5	10.0	12.00	12.0	34	1.57	100
	M12	<b>4R12</b>	7.0	15	19	13.0	10.0	13.00	13.0	35	1.39	25
	M14	<b>4R14</b>	7.0	15	21	15.0	10.0	14.50	14.5	38	1.49	25
35	M6	<b>5R6</b>	8.5	17	17	6.5	12.0	7.50	7.5	32	1.85	100
	M8	<b>5R8</b>	8.5	17	17	8.5	12.0	10.00	10.0	34	2.00	100
	M10	<b>5R10</b>	8.5	17	19	10.5	12.0	12.00	12.0	37	2.13	100
	M12	<b>5R12</b>	8.5	17	21	13.0	12.0	13.00	13.0	38	2.12	100
	M14	<b>5R14</b>	8.5	17	21	15.0	12.0	14.50	14.5	40	2.18	25
	M16	<b>5R16</b>	8.5	17	26	17.0	12.0	16.00	16.0	42	2.24	25
50	M6	<b>6R6</b>	10.0	19	20	6.5	14.0	10.00	10.0	37	3.00	25
	M8	<b>6R8</b>	10.0	19	20	8.5	14.0	10.00	10.0	37	2.93	50
	M10	<b>6R10</b>	10.0	19	20	10.5	14.0	12.00	12.0	39	3.08	50
	M12	<b>6R12</b>	10.0	19	23	13.0	14.0	13.00	13.0	43	3.23	50
	M14	<b>6R14</b>	10.0	19	23	15.0	14.0	14.50	14.5	45	3.32	25
	M16	<b>6R16</b>	10.0	19	28	17.0	14.0	16.00	16.0	46	3.38	25
	M20	<b>6R20</b>	10.0	19	30	21.0	14.0	19.00	19.0	48	3.46	25

■ **Tubular cable lugs, copper 6 - 400 mm<sup>2</sup>**

standard type

Cross-section mm <sup>2</sup>	Size of bolt Ø	Part No.	Dimensions mm								Weight/ 100 pcs. ~ kg	pcs.
			d1	a	b	d2	d4	c1	c2	l		
70	M6	<b>7R6</b>	12.0	21	23	6.5	16.5	10.00	10.0	43	4.49	25
	M8	<b>7R8</b>	12.0	21	23	8.5	16.5	10.00	10.0	43	4.38	50
	M10	<b>7R10</b>	12.0	21	23	10.5	16.5	12.00	12.0	44	4.54	50
	M12	<b>7R12</b>	12.0	21	23	13.0	16.5	13.00	13.0	46	4.63	50
	M14	<b>7R14</b>	12.0	21	23	15.0	16.5	14.50	14.5	48	4.76	25
	M16	<b>7R16</b>	12.0	21	28	17.0	16.5	16.00	16.0	50	4.24	25
	M20	<b>7R20</b>	12.0	21	30	21.0	16.5	19.00	19.0	53	5.09	25
95	M8	<b>8R8</b>	13.5	25	26	8.5	18.0	12.0	12.0	48	5.44	25
	M10	<b>8R10</b>	13.5	25	26	10.5	18.0	12.0	12.0	48	5.40	50
	M12	<b>8R12</b>	13.5	25	26	13.0	18.0	13.0	13.0	49	5.56	50
	M14	<b>8R14</b>	13.5	25	26	15.0	18.0	14.5	14.5	51	5.62	25
	M16	<b>8R16</b>	13.5	25	28	17.0	18.0	16.0	16.0	54	5.82	50
	M20	<b>8R20</b>	13.5	25	36	21.0	18.0	22.0	22.0	60	6.71	25
120	M8	<b>9R8</b>	15.0	26	28	8.5	19.5	14.0	14.0	51	6.72	25
	M10	<b>9R10</b>	15.0	26	28	10.5	19.5	14.0	14.0	51	6.57	50
	M12	<b>9R12</b>	15.0	26	28	13.0	19.5	14.0	14.0	51	6.38	50
	M14	<b>9R14</b>	15.0	26	28	15.0	19.5	15.0	15.0	52	6.45	25
	M16	<b>9R16</b>	15.0	26	30	17.0	19.5	16.0	16.0	54	6.51	50
	M20	<b>9R20</b>	15.0	26	36	21.0	19.5	22.0	22.0	63	7.74	25
150	M8	<b>10R8</b>	16.5	30	31	8.5	21.0	14.0	14.0	56	7.78	10
	M10	<b>10R10</b>	16.5	30	31	10.5	21.0	14.0	14.0	56	7.62	10
	M12	<b>10R12</b>	16.5	30	31	13.0	21.0	15.0	15.0	57	7.73	25
	M14	<b>10R14</b>	16.5	30	31	15.0	21.0	15.0	15.0	57	7.64	10
	M16	<b>10R16</b>	16.5	30	31	17.0	21.0	16.0	16.0	58	7.53	10
	M20	<b>10R20</b>	16.5	30	36	21.0	21.0	22.0	22.0	66	8.80	10
185	M10	<b>11R10</b>	19.0	30	35	10.5	24.0	18.0	18.0	65	11.75	10
	M12	<b>11R12</b>	19.0	30	35	13.0	24.0	18.0	18.0	65	11.82	10
	M14	<b>11R14</b>	19.0	30	35	15.0	24.0	18.0	18.0	65	11.39	10
	M16	<b>11R16</b>	19.0	30	35	17.0	24.0	18.0	18.0	65	11.24	25
	M20	<b>11R20</b>	19.0	30	39	21.0	24.0	22.0	22.0	69	12.00	10
240	M10	<b>12R10</b>	21.0	35	39	10.5	26.0	21.5	19.0	72	14.72	10
	M12	<b>12R12</b>	21.0	35	39	13.0	26.0	21.5	19.0	72	14.55	10
	M14	<b>12R14</b>	21.0	35	39	15.0	26.0	21.5	19.0	72	14.24	10
	M16	<b>12R16</b>	21.0	35	39	17.0	26.0	21.5	19.0	72	14.09	25
	M20	<b>12R20</b>	21.0	35	39	21.0	26.0	21.5	19.0	72	13.60	10
300	M12	<b>13R12</b>	23.5	44	43	13.0	29.5	24.0	24.0	87	23.33	5
	M14	<b>13R14</b>	23.5	44	43	15.0	29.5	24.0	24.0	87	23.14	5
	M16	<b>13R16</b>	23.5	44	43	17.0	29.5	24.0	24.0	87	22.74	5
	M20	<b>13R20</b>	23.5	44	43	21.0	29.5	24.0	24.0	87	22.19	5
400	M12	<b>14R12</b>	27.0	44	49	13.0	34.0	24.0	24.0	90	32.41	5
	M14	<b>14R14</b>	27.0	44	49	15.0	34.0	24.0	24.0	90	32.24	5
	M16	<b>14R16</b>	27.0	44	49	17.0	34.0	24.0	24.0	90	31.98	5
	M20	<b>14R20</b>	27.0	44	49	21.0	34.0	24.0	24.0	90	31.41	5

► Tool: see chart page 44

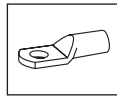

**Angle tubular cable lugs, copper, 6 - 400 mm<sup>2</sup>  
90° angle  
standard type**

- For stranded round shaped conductors e.g. VDE 0295 Class 2
- For pre-rounded sector shaped conductors

**Characteristics**

- Annealed material optimises material and crimping characteristics
- Flat contact surface by special manufacturing processes

**Material**

- Copper to EN 13600

**Surface**

- Tin plated

**Order info**

- Also available with inspection hole, part number with „ms“

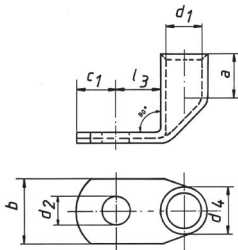

Cross-section mm <sup>2</sup>	Size of bolt Ø	Part No.	Dimensions mm							Weight/100 pcs. ~ kg	pcs.
			d1	a	b	d2	d4	c1	l3		
6	M5	<b>41R5</b>	3.5	9	10	5.5	6.5	7.5	9	0.59	50
	M6	<b>41R6</b>	3.5	9	12	6.5	6.5	7.5	10	0.58	50
	M8	<b>41R8</b>	3.5	9	14	8.5	6.5	10.0	13	0.61	50
	M10	<b>41R10</b>	3.5	9	17	10.5	6.5	12.0	15	0.65	50
	M12	<b>41R12</b>	3.5	9	19	13.0	6.5	13.0	17	0.62	50
10	M5	<b>42R5</b>	4.5	10	12	5.5	7.0	6.5	10	0.57	50
	M6	<b>42R6</b>	4.5	10	12	6.5	7.0	6.5	10	0.57	50
	M8	<b>42R8</b>	4.5	10	15	8.5	7.0	10.0	13	0.63	50
	M10	<b>42R10</b>	4.5	10	17	10.5	7.0	12.0	15	0.66	50
	M12	<b>42R12</b>	4.5	10	19	13.0	7.0	13.0	18	0.81	50
16	M5	<b>43R5</b>	5.5	13	12	5.5	8.5	7.5	10	1.01	50
	M6	<b>43R6</b>	5.5	13	12	6.5	8.5	7.5	11	1.01	50
	M8	<b>43R8</b>	5.5	13	15	8.5	8.5	10.0	13	1.08	50
	M10	<b>43R10</b>	5.5	13	17	10.5	8.5	12.0	15	1.09	50
	M12	<b>43R12</b>	5.5	13	19	13.0	8.5	13.0	18	1.15	50
25	M5	<b>44R5</b>	7.0	15	14	5.5	10.0	7.5	11	1.40	25
	M6	<b>44R6</b>	7.0	15	14	6.5	10.0	7.5	11	1.32	25
	M8	<b>44R8</b>	7.0	15	16	8.5	10.0	10.0	13	1.44	25
	M10	<b>44R10</b>	7.0	15	18	10.5	10.0	12.0	15	1.49	25
	M12	<b>44R12</b>	7.0	15	19	13.0	10.0	13.0	18	1.44	25
	M14	<b>44R14</b>	7.0	15	21	15.0	10.0	14.5	20	1.55	25
35	M6	<b>45R6</b>	8.5	17	17	6.5	12.0	7.5	11	2.05	25
	M8	<b>45R8</b>	8.5	17	17	8.5	12.0	10.0	13	2.20	25
	M10	<b>45R10</b>	8.5	17	19	10.5	12.0	12.0	15	2.28	25
	M12	<b>45R12</b>	8.5	17	21	13.0	12.0	13.0	18	2.38	25
	M14	<b>45R14</b>	8.5	17	21	15.0	12.0	14.5	20	2.41	25
	M16	<b>45R16</b>	8.5	17	26	17.0	12.0	16.0	22	2.40	25
50	M6	<b>46R6</b>	10.0	19	20	6.5	14.0	10.0	13	3.34	25
	M8	<b>46R8</b>	10.0	19	20	8.5	14.0	10.0	13	3.28	25
	M10	<b>46R10</b>	10.0	19	20	10.5	14.0	12.0	16	3.47	25
	M12	<b>46R12</b>	10.0	19	23	13.0	14.0	13.0	18	3.42	25
	M14	<b>46R14</b>	10.0	19	23	15.0	14.0	14.5	20	3.55	25
	M16	<b>46R16</b>	10.0	19	28	17.0	14.0	16.0	22	3.58	25
	M20	<b>46R20</b>	10.0	19	30	21.0	14.0	19.0	24	3.15	25

■ **Angle tubular cable lugs, copper, 6 - 400 mm<sup>2</sup>**  
**90° angle**  
 standard type

Cross-section mm <sup>2</sup>	Size of bolt Ø	Part No.	Dimensions mm							Weight/ 100 pcs. ~ kg	pcs.
			d1	a	b	d2	d4	c1	l3		
70	M6	<b>47R6</b>	12.0	21	23	6.5	16.5	10.0	13	4.90	25
	M8	<b>47R8</b>	12.0	21	23	8.5	16.5	10.0	14	4.80	25
	M10	<b>47R10</b>	12.0	21	23	10.5	16.5	12.0	16	4.88	25
	M12	<b>47R12</b>	12.0	21	23	13.0	16.5	13.0	18	4.99	25
	M14	<b>47R14</b>	12.0	21	23	15.0	16.5	14.5	20	5.38	25
	M16	<b>47R16</b>	12.0	21	28	17.0	16.5	16.0	22	5.35	25
	M20	<b>47R20</b>	12.0	21	30	21.0	16.5	19.0	24	5.30	25
95	M8	<b>48R8</b>	13.5	25	26	8.5	18.0	12.0	14	5.89	25
	M10	<b>48R10</b>	13.5	25	26	10.5	18.0	12.0	17	5.88	25
	M12	<b>48R12</b>	13.5	25	26	13.0	18.0	13.0	18	5.93	25
	M14	<b>48R14</b>	13.5	25	26	15.0	18.0	14.5	20	6.03	25
	M16	<b>48R16</b>	13.5	25	28	17.0	18.0	16.0	22	6.17	25
	M20	<b>48R20</b>	13.5	25	36	21.0	18.0	22.0	24	6.42	25
120	M8	<b>49R8</b>	15.0	26	28	8.5	19.5	14.0	16	7.26	10
	M10	<b>49R10</b>	15.0	26	28	10.5	19.5	14.0	17	7.30	10
	M12	<b>49R12</b>	15.0	26	28	13.0	19.5	14.0	18	7.19	10
	M14	<b>49R14</b>	15.0	26	28	15.0	19.5	15.0	20	7.30	10
	M16	<b>49R16</b>	15.0	26	30	17.0	19.5	16.0	22	7.35	10
	M20	<b>49R20</b>	15.0	26	36	21.0	19.5	22.0	24	7.60	10
150	M8	<b>50R8</b>	16.5	30	31	8.5	21.0	14.0	16	8.41	10
	M10	<b>50R10</b>	16.5	30	31	10.5	21.0	14.0	17	8.27	10
	M12	<b>50R12</b>	16.5	30	31	13.0	21.0	15.0	18	8.34	10
	M14	<b>50R14</b>	16.5	30	31	15.0	21.0	15.0	20	8.52	10
	M16	<b>50R16</b>	16.5	30	31	17.0	21.0	16.0	22	8.62	10
	M20	<b>50R20</b>	16.5	30	36	21.0	21.0	22.0	24	9.10	10
185	M10	<b>51R10</b>	19.0	30	35	10.5	24.0	18.0	22	12.17	10
	M12	<b>51R12</b>	19.0	30	35	13.0	24.0	18.0	22	11.97	10
	M14	<b>51R14</b>	19.0	30	35	15.0	24.0	18.0	22	11.77	10
	M16	<b>51R16</b>	19.0	30	35	17.0	24.0	18.0	22	11.53	10
	M20	<b>51R20</b>	19.0	30	39	21.0	24.0	22.0	24	12.00	10
240	M10	<b>52R10</b>	21.0	35	39	10.5	26.0	21.5	22	15.60	10
	M12	<b>52R12</b>	21.0	35	39	13.0	26.0	21.5	22	15.60	10
	M14	<b>52R14</b>	21.0	35	39	15.0	26.0	21.5	22	15.41	10
	M16	<b>52R16</b>	21.0	35	39	17.0	26.0	21.5	22	15.18	10
	M20	<b>52R20</b>	21.0	35	39	21.0	26.0	21.5	24	14.80	10
300	M12	<b>53R12</b>	23.5	44	43	13.0	29.5	24.0	24	23.60	5
	M14	<b>53R14</b>	23.5	44	43	15.0	29.5	24.0	24	23.40	5
	M16	<b>53R16</b>	23.5	44	43	17.0	29.5	24.0	24	20.99	5
	M20	<b>53R20</b>	23.5	44	43	21.0	29.5	24.0	24	22.70	5
400	M12	<b>54R12</b>	27.0	44	49	13.0	34.0	24.0	24	32.53	5
	M14	<b>54R14</b>	27.0	44	49	15.0	34.0	24.0	24	33.40	5
	M16	<b>54R16</b>	27.0	44	49	17.0	34.0	24.0	24	32.60	5
	M20	<b>54R20</b>	27.0	44	49	21.0	34.0	24.0	24	31.80	5

► Tool: see chart page 44



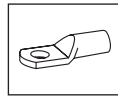

**Angle tubular cable lugs, copper, 6 - 400 mm<sup>2</sup>  
45° angle  
standard type**



- For stranded round shaped conductors e.g. VDE 0295 Class 2
- For pre-rounded sector shaped conductors

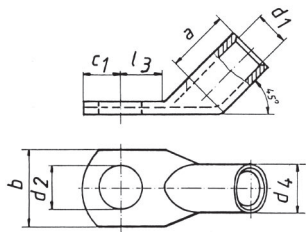

**Characteristics**

- Annealed material optimises material and crimping characteristics
- Flat contact surface by special manufacturing processes

**Material**

- Copper to EN 13600

**Surface**

- Tin plated

**Order info**

- Also available with inspection hole, part number with „ms“

Cross-section mm <sup>2</sup>	Size of bolt Ø	Part No.	Dimensions mm							Weight/100 pcs. ~ kg	pcs.
			d1	a	b	d2	d4	c1	l3		
6	M5	<b>41R545</b>	3.5	9	10	5.5	6.5	7.5	9	0.60	50
	M6	<b>41R645</b>	3.5	9	12	6.5	6.5	7.5	10	0.58	50
	M8	<b>41R845</b>	3.5	9	14	8.5	6.5	10.0	13	0.68	50
	M10	<b>41R1045</b>	3.5	9	17	10.5	6.5	12.0	15	0.70	50
	M12	<b>41R1245</b>	3.5	9	19	13.0	6.5	13.0	17	0.70	50
10	M5	<b>42R545</b>	4.5	10	12	5.5	7.0	6.5	10	0.57	50
	M6	<b>42R645</b>	4.5	10	12	6.5	7.0	6.5	10	0.57	50
	M8	<b>42R845</b>	4.5	10	15	8.5	7.0	10.0	13	0.63	50
	M10	<b>42R1045</b>	4.5	10	17	10.5	7.0	12.0	15	0.68	50
	M12	<b>42R1245</b>	4.5	10	19	13.0	7.0	13.0	18	0.68	50
16	M5	<b>43R545</b>	5.5	13	12	5.5	8.5	7.5	10	1.01	50
	M6	<b>43R645</b>	5.5	13	12	6.5	8.5	7.5	11	1.06	50
	M8	<b>43R845</b>	5.5	13	15	8.5	8.5	10.0	13	1.15	50
	M10	<b>43R1045</b>	5.5	13	17	10.5	8.5	12.0	15	1.09	50
	M12	<b>43R1245</b>	5.5	13	19	13.0	8.5	13.0	18	1.15	50
25	M5	<b>44R545</b>	7.0	15	14	5.5	10.0	7.5	11	1.40	25
	M6	<b>44R645</b>	7.0	15	14	6.5	10.0	7.5	11	1.32	25
	M8	<b>44R845</b>	7.0	15	16	8.5	10.0	10.0	13	1.44	25
	M10	<b>44R1045</b>	7.0	15	18	10.5	10.0	12.0	15	1.49	25
	M12	<b>44R1245</b>	7.0	15	19	13.0	10.0	13.0	18	1.44	25
	M14	<b>44R1445</b>	7.0	15	21	15.0	10.0	14.5	20	1.55	25
35	M6	<b>45R645</b>	8.5	17	17	6.5	12.0	7.5	11	2.05	25
	M8	<b>45R845</b>	8.5	17	17	8.5	12.0	10.0	13	2.20	25
	M10	<b>45R1045</b>	8.5	17	19	10.5	12.0	12.0	15	2.28	25
	M12	<b>45R1245</b>	8.5	17	21	13.0	12.0	13.0	18	2.38	25
	M14	<b>45R1445</b>	8.5	17	21	15.0	12.0	14.5	20	2.41	25
	M16	<b>45R1645</b>	8.5	17	26	17.0	12.0	16.0	22	2.40	25
50	M6	<b>46R645</b>	10.0	19	20	6.5	14.0	10.0	13	3.43	25
	M8	<b>46R845</b>	10.0	19	20	8.5	14.0	10.0	13	3.28	25
	M10	<b>46R1045</b>	10.0	19	20	10.5	14.0	12.0	16	3.47	25
	M12	<b>46R1245</b>	10.0	19	23	13.0	14.0	13.0	18	3.42	25
	M14	<b>46R1445</b>	10.0	19	23	15.0	14.0	14.5	20	3.65	25
	M16	<b>46R1645</b>	10.0	19	28	17.0	14.0	16.0	22	3.76	25
	M20	<b>46R2045</b>	10.0	19	30	21.0	14.0	19.0	24	3.30	25

■ **Angle tubular cable lugs, copper, 6 - 400 mm<sup>2</sup>**  
**45° angle**  
 standard type

Cross-section mm <sup>2</sup>	Size of bolt Ø	Part No.	Dimensions mm							Weight/ 100 pcs. ~ kg	pcs.
			d1	a	b	d2	d4	c1	l3		
70	M6	<b>47R645</b>	12.0	21	23	6.5	16.5	10.0	13	5.06	25
	M8	<b>47R845</b>	12.0	21	23	8.5	16.5	10.0	14	5.06	25
	M10	<b>47R1045</b>	12.0	21	23	10.5	16.5	12.0	16	5.25	25
	M12	<b>47R1245</b>	12.0	21	23	13.0	16.5	13.0	18	5.30	25
	M14	<b>47R1445</b>	12.0	21	23	15.0	16.5	14.5	20	5.60	25
	M16	<b>47R1645</b>	12.0	21	28	17.0	16.5	16.0	22	5.61	25
	M20	<b>47R2045</b>	12.0	21	30	21.0	16.5	19.0	24	5.60	25
95	M8	<b>48R845</b>	13.5	25	26	8.5	18.0	12.0	14	6.19	25
	M10	<b>48R1045</b>	13.5	25	26	10.5	18.0	12.0	17	5.70	25
	M12	<b>48R1245</b>	13.5	25	26	13.0	18.0	13.0	18	6.67	25
	M14	<b>48R1445</b>	13.5	25	26	15.0	18.0	14.5	20	6.60	25
	M16	<b>48R1645</b>	13.5	25	28	17.0	18.0	16.0	22	6.78	25
	M20	<b>48R2045</b>	13.5	25	36	21.0	18.0	22.0	24	6.80	25
120	M8	<b>49R845</b>	15.0	26	28	8.5	19.5	14.0	16	7.92	10
	M10	<b>49R1045</b>	15.0	26	28	10.5	19.5	14.0	17	7.99	10
	M12	<b>49R1245</b>	15.0	26	28	13.0	19.5	14.0	18	7.96	10
	M14	<b>49R1445</b>	15.0	26	28	15.0	19.5	15.0	20	7.94	10
	M16	<b>49R1645</b>	15.0	26	30	17.0	19.5	16.0	22	8.26	10
	M20	<b>49R2045</b>	15.0	26	36	21.0	19.5	22.0	24	8.20	10
150	M8	<b>50R845</b>	16.5	30	31	8.5	21.0	14.0	16	9.00	10
	M10	<b>50R1045</b>	16.5	30	31	10.5	21.0	14.0	17	9.15	10
	M12	<b>50R1245</b>	16.5	30	31	13.0	21.0	15.0	18	8.75	10
	M14	<b>50R1445</b>	16.5	30	31	15.0	21.0	15.0	20	9.20	10
	M16	<b>50R1645</b>	16.5	30	31	17.0	21.0	16.0	22	9.22	10
	M20	<b>50R2045</b>	16.5	30	36	21.0	21.0	22.0	24	9.26	10
185	M10	<b>51R1045</b>	19.0	30	35	10.5	24.0	18.0	22	13.30	10
	M12	<b>51R1245</b>	19.0	30	35	13.0	24.0	18.0	22	13.32	10
	M14	<b>51R1445</b>	19.0	30	35	15.0	24.0	18.0	22	13.40	10
	M16	<b>51R1645</b>	19.0	30	35	17.0	24.0	18.0	22	12.80	10
	M20	<b>51R2045</b>	19.0	30	39	21.0	24.0	22.0	24	13.10	10
240	M10	<b>52R1045</b>	21.0	35	39	10.5	26.0	21.5	22	16.28	10
	M12	<b>52R1245</b>	21.0	35	39	13.0	26.0	21.5	22	16.80	10
	M14	<b>52R1445</b>	21.0	35	39	15.0	26.0	21.5	22	16.40	10
	M16	<b>52R1645</b>	21.0	35	39	17.0	26.0	21.5	22	16.10	10
	M20	<b>52R2045</b>	21.0	35	39	21.0	26.0	21.5	24	16.10	10
300	M12	<b>53R1245</b>	23.5	44	43	13.0	29.5	24.0	24	24.08	5
	M14	<b>53R1445</b>	23.5	44	43	15.0	29.5	24.0	24	24.20	5
	M16	<b>53R1645</b>	23.5	44	43	17.0	29.5	24.0	24	23.23	5
	M20	<b>53R2045</b>	23.5	44	43	21.0	29.5	24.0	24	23.50	5
400	M12	<b>54R1245</b>	27.0	44	49	13.0	34.0	24.0	24	34.00	5
	M14	<b>54R1445</b>	27.0	44	49	15.0	34.0	24.0	24	33.40	5
	M16	<b>54R1645</b>	27.0	44	49	17.0	34.0	24.0	24	34.28	5
	M20	<b>54R2045</b>	27.0	44	49	21.0	34.0	24.0	24	31.80	5

► Tool: see chart page 44



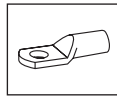

■ **Butt-connector, copper 0.75 - 400 mm<sup>2</sup>**  
standard type

- With buttmarks for precise cable insertion
- For stranded conductors e.g. VDE 0295 Class 2

**Characteristics**

- Annealed material optimises material and crimping characteristics

**Material**

- Copper to EN 13600

**Surface**

- Tin plated

**Order info**

- Also available without wirestop, part number with „om“

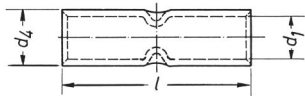

Cross-section mm <sup>2</sup>	Part No.	Dimensions mm			Weight/100 pcs. ~ kg	pcs.
		d1	d4	l		
0.75	<b>17R</b>	1.3	2.8	20	0.09	100
1.5	<b>18R</b>	1.8	3.3	25	0.12	100
2.5	<b>19R</b>	2.3	4.2	25	0.20	100
4	<b>20R</b>	3.0	5.0	25	0.26	100
6	<b>21R</b>	3.5	6.5	25	0.50	100
10	<b>22R</b>	4.5	7.0	30	0.72	100
16	<b>23R</b>	5.5	8.5	35	1.00	100
25	<b>24R</b>	7.0	10.0	40	1.41	50
35	<b>25R</b>	8.5	12.0	45	2.24	50
50	<b>26R</b>	10.0	14.0	50	3.36	50
70	<b>27R</b>	12.0	16.5	55	4.87	50
95	<b>28R</b>	13.5	18.0	60	5.91	25
120	<b>29R</b>	15.0	19.5	65	7.00	25
150	<b>30R</b>	16.5	21.0	70	8.12	10
185	<b>31R</b>	19.0	24.0	75	10.06	10
240	<b>32R</b>	21.0	26.0	85	13.82	10
300	<b>33R</b>	23.5	29.5	100	21.94	5
400	<b>34R</b>	27.0	34.0	100	29.65	5

► Tool: see chart page 44

■ **Parallel connector, copper 1.5 - 300 mm<sup>2</sup>**  
standard type

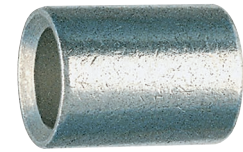
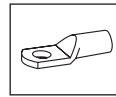

- For connecting different cable cross-sections

**Characteristics**

- Annealed material optimises material and crimping characteristics

**Material**

- Copper to EN 13600

**Surface**

- Tin plated

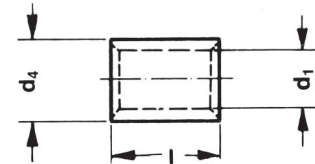

Total cross-section mm <sup>2</sup>	Part No.	Dimensions mm			Weight/100 pcs. ~ kg	pcs.
		d1	d4	l		
1.5	<b>148R</b>	1.8	3.3	5	0.03	100
2.5	<b>149R</b>	2.3	4.2	5	0.04	100
4	<b>150R</b>	3.0	5.0	7	0.08	100
6	<b>151R</b>	4.0	6.0	7	0.09	100
10	<b>152R</b>	4.5	7.0	9	0.17	100
16	<b>153R</b>	5.5	8.5	10	0.28	100
25	<b>154R</b>	7.0	10.0	13	0.44	100
35	<b>155R</b>	8.5	12.0	16	0.78	100
50	<b>156R</b>	10.0	14.0	19	1.22	100
70	<b>157R</b>	12.0	16.5	19	1.62	50
95	<b>158R</b>	13.5	18.0	20	1.90	50
120	<b>159R</b>	15.0	19.5	22	2.28	50
150	<b>160R</b>	16.5	21.0	26	3.00	50
185	<b>161R</b>	19.0	24.0	30	4.37	50
240	<b>162R</b>	21.0	26.0	32	5.30	25
300	<b>163R</b>	23.5	29.5	36	8.05	25

► Tool: see chart page 44

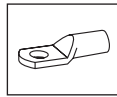
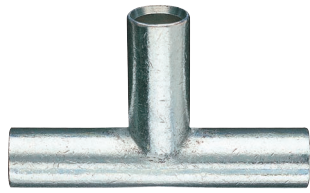

■ **T-connectors, copper 1.5 - 240 mm<sup>2</sup>**  
standard type

- For single cable tap conductors
- For stranded conductors e.g. VDE 0295 Class 2

**Characteristics**

- Annealed material optimises material and crimping characteristics

**Material**

- Copper to EN 13600

**Surface**

- Tin plated

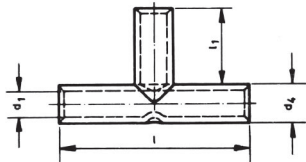

Cross-section mm <sup>2</sup>	Part No.	Dimensions mm				Weight/100 pcs. ~ kg	pcs.
		d1	d4	l	l1		
1.5	<b>TV15</b>	1.8	3.3	30	12	0.23	50
2.5	<b>TV2.5</b>	2.3	4.2	30	12	0.37	50
4	<b>TV4</b>	3.0	5.0	30	12	0.45	50
6	<b>TV6</b>	4.0	6.0	35	14	0.73	50
10	<b>TV10</b>	4.5	7.0	35	14	1.05	50
16	<b>TV16</b>	5.5	8.5	50	21	2.20	50
25	<b>TV25</b>	7.0	10.0	55	23	2.90	25
35	<b>TV35</b>	8.5	12.0	70	30	5.20	25
50	<b>TV50</b>	10.0	14.0	80	34	7.90	25
70	<b>TV70</b>	12.0	16.5	85	35	11.20	10
95	<b>TV95</b>	13.5	18.0	90	36	13.00	10
120	<b>TV120</b>	15.0	19.5	95	38	14.70	10
150	<b>TV150</b>	16.5	21.0	110	44	18.90	10
185	<b>TV185</b>	19.0	24.0	115	45	25.00	5
240	<b>TV240</b>	21.0	26.0	130	52	31.10	5

► Tool: see chart page 44

■ **Cross-connector, copper 1.5 - 240 mm<sup>2</sup>**  
standard type

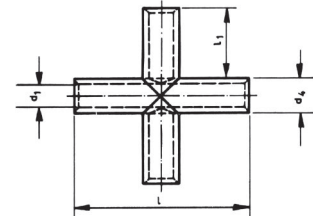
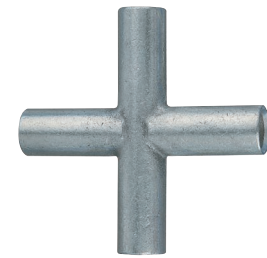
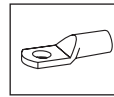

- For double cable tap conductors
- For stranded conductors e.g. VDE 0295 Class 2

**Characteristics**

- Annealed material optimises material and crimping characteristics

**Material**

- Copper to EN 13600

**Surface**

- Tin plated

Cross-section mm <sup>2</sup>	Part No.	Dimensions mm				Weight/100 pcs. ~ kg	pcs.
		d1	d4	l	l1		
1.5	<b>KV15</b>	1.8	3.3	30	12	0.320	25
2.5	<b>KV2.5</b>	2.3	4.2	30	12	0.490	25
4	<b>KV4</b>	3.0	5.0	30	12	0.650	25
6	<b>KV6</b>	4.0	6.0	35	14	0.950	25
10	<b>KV10</b>	4.5	7.0	35	14	1.350	25
16	<b>KV16</b>	5.5	8.5	50	21	2.950	25
25	<b>KV25</b>	7.0	10.0	55	23	4.000	15
35	<b>KV35</b>	8.5	12.0	70	30	6.900	15
50	<b>KV50</b>	10.0	14.0	80	34	10.400	15
70	<b>KV70</b>	12.0	16.5	85	35	14.600	15
95	<b>KV95</b>	13.5	18.0	90	36	17.100	15
120	<b>KV120</b>	15.0	19.5	95	38	19.400	5
150	<b>KV150</b>	16.5	21.0	110	44	24.100	5
185	<b>KV185</b>	19.0	24.0	115	45	32.100	5
240	<b>KV240</b>	21.0	26.0	130	52	41.100	5

► Tool: see chart page 44

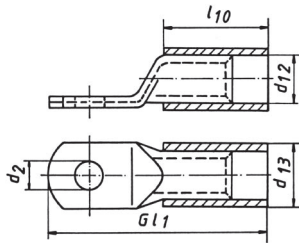
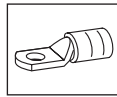
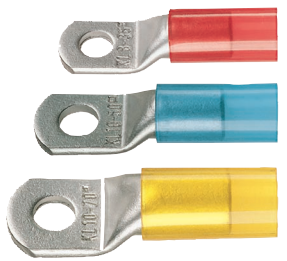

**Insulated tubular cable lugs, Cu 10 - 150 mm<sup>2</sup> standard type**

- Crimping operation direct on the insulation
- For stranded conductors e.g. VDE 0295 Class 2

**Characteristics**

- Annealed material optimises material and crimping characteristics

**Material**

- Cable lug: Copper to EN 13600
- Insulation sleeve: PA, free of halide

**Surface**

- Tin plated

**Order info**

- Also available with inspection hole, part number with „ms“
- Dimensions of tubular cable lugs can be found from page 22

Cross-section mm <sup>2</sup>	Size of bolt Ø	Part No.	Colour	Dimensions mm					Weight		pcs.
				d2	d12	d13	G l1	l10	100 pcs. ~ kg Cu	~ kg Total	
10	M5	602R5	■	5.5	7.0	9.0	35.5	17.0	0.50	0.548	25
	M6	602R6	■	6.5	7.0	9.0	35.5	17.0	0.49	0.538	25
	M8	602R8	■	8.5	7.0	9.0	42.0	17.0	0.58	0.628	25
	M10	602R10	■	10.5	7.0	9.0	46.0	17.0	0.62	0.668	25
	M12	602R12	■	13.0	7.0	9.0	49.0	17.0	0.64	0.688	25
16	M5	603R5	■	5.5	8.5	10.5	39.5	21.0	0.84	0.907	25
	M6	603R6	■	6.5	8.5	10.5	41.3	21.0	0.86	0.927	25
	M8	603R8	■	8.5	8.5	10.5	45.5	21.0	0.93	0.997	25
	M10	603R10	■	10.5	8.5	10.5	49.5	21.0	0.99	1.057	25
	M12	603R12	■	13.0	8.5	10.5	54.0	21.0	1.02	1.087	25
25	M5	604R5	■	5.5	10.0	12.0	45.0	24.0	1.22	1.312	25
	M6	604R6	■	6.5	10.0	12.0	46.5	24.0	1.20	1.292	25
	M8	604R8	■	8.5	10.0	12.0	51.0	24.0	1.31	1.402	25
	M10	604R10	■	10.5	10.0	12.0	55.0	24.0	1.57	1.662	25
	M12	604R12	■	13.0	10.0	12.0	57.0	24.0	1.39	1.482	25
	M14	604R14	■	15.0	10.0	12.0	61.5	24.0	1.49	1.582	25
35	M6	605R6	■	6.5	12.0	14.5	49.5	27.0	1.85	2.010	25
	M8	605R8	■	8.5	12.0	14.5	54.0	27.0	2.00	2.160	25
	M10	605R10	■	10.5	12.0	14.5	59.0	27.0	2.13	2.290	25
	M12	605R12	■	13.0	12.0	14.5	61.0	27.0	2.12	2.280	25
	M14	605R14	■	15.0	12.0	14.5	64.5	27.0	2.18	2.340	25
	M16	605R16	■	17.0	12.0	14.5	68.0	27.0	2.24	2.400	25
50	M6	606R6	■	6.5	14.0	16.5	59.0	32.0	3.00	3.220	25
	M8	606R8	■	8.5	14.0	16.5	59.0	32.0	2.93	3.150	25
	M10	606R10	■	10.5	14.0	16.5	63.0	32.0	3.08	3.300	25
	M12	606R12	■	13.0	14.0	16.5	68.0	32.0	3.23	3.450	25
	M14	606R14	■	15.0	14.0	16.5	71.5	32.0	3.32	3.540	25
	M16	606R16	■	17.0	14.0	16.5	77.0	32.0	3.38	3.600	25
	M20	606R20	■	21.0	14.0	16.5	83.5	32.0	3.46	3.680	25

■ **Insulated tubular cable lugs, Cu 10 - 150 mm<sup>2</sup>**

standard type

Cross-section mm <sup>2</sup>	Size of bolt Ø	Part No.	Colour	Dimensions mm					Weight		pcs.
				d2	d12	d13	G1	I10	100 pcs. ~ kg	Cu Total	
70	M6	<b>607R6</b>	■	6.5	16.4	18.9	65.5	33.5	4.49	4.760	25
	M8	<b>607R8</b>	■	8.5	16.4	18.9	65.5	33.5	4.38	4.650	25
	M10	<b>607R10</b>	■	10.5	16.4	18.9	66.5	33.5	4.54	4.810	25
	M12	<b>607R12</b>	■	13.0	16.4	18.9	70.5	33.5	4.63	4.900	25
	M14	<b>607R14</b>	■	15.0	16.4	18.9	73.5	33.5	4.76	5.030	25
	M16	<b>607R16</b>	■	17.0	16.4	18.9	78.5	33.5	4.24	4.510	25
	M20	<b>607R20</b>	■	21.0	16.4	18.9	84.5	33.5	5.09	5.360	25
95	M8	<b>608R8</b>	■	8.5	17.8	20.8	74.0	40.0	5.44	5.85	25
	M10	<b>608R10</b>	■	10.5	17.8	20.8	74.0	40.0	5.40	5.81	25
	M12	<b>608R12</b>	■	13.0	17.8	20.8	76.0	40.0	5.56	5.97	25
	M14	<b>608R14</b>	■	15.0	17.8	20.8	79.5	40.0	5.62	6.03	25
	M16	<b>608R16</b>	■	17.0	17.8	20.8	84.0	40.0	5.82	6.23	25
	M20	<b>608R20</b>	■	21.0	17.8	20.8	96.0	40.0	6.71	7.12	25
120	M8	<b>609R8</b>	■	8.5	19.3	22.3	80.5	41.5	6.72	7.18	10
	M10	<b>609R10</b>	■	10.5	19.3	22.3	80.5	41.5	6.57	7.03	10
	M12	<b>609R12</b>	■	13.0	19.3	22.3	80.5	41.5	6.38	6.84	10
	M14	<b>609R14</b>	■	15.0	19.3	22.3	82.5	41.5	6.45	6.91	10
	M16	<b>609R16</b>	■	17.0	19.3	22.3	85.5	41.5	6.51	6.97	10
	M20	<b>609R20</b>	■	21.0	19.3	22.3	100.5	41.5	7.74	8.20	10
150	M8	<b>610R8</b>	■	8.5	20.8	23.8	88.0	48.0	7.78	8.36	10
	M10	<b>610R10</b>	■	10.5	20.8	23.8	88.0	48.0	7.62	8.20	10
	M12	<b>610R12</b>	■	13.0	20.8	23.8	89.0	48.0	7.73	8.31	10
	M14	<b>610R14</b>	■	15.0	20.8	23.8	90.0	48.0	7.64	8.22	10
	M16	<b>610R16</b>	■	17.0	20.8	23.8	92.0	48.0	7.53	8.11	10
	M20	<b>610R20</b>	■	21.0	20.8	23.8	106.0	48.0	8.80	9.38	10

► Tool: see chart page 46



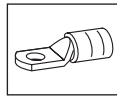
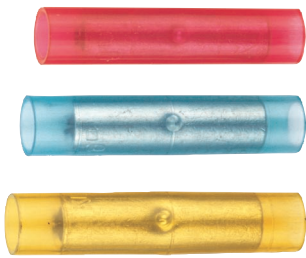

■ **Insulated butt-connector, Cu 10 - 150 mm<sup>2</sup>**  
Standard type

- Crimping operation direct on the insulation
- With buttmarks for precise cable insertion
- For stranded conductors e.g. VDE 0295 Class 2

**Characteristics**

- Annealed material optimises material and crimping characteristics

**Material**

- Connector: Copper to EN 13600
- Insulation sleeve: PA, free of halide

**Surface**

- Tin plated

**Order info**

- Dimensions of butt-connectors can be found on page 28

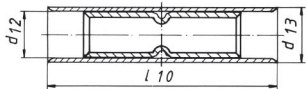

Cross-section mm <sup>2</sup>	Part No.	Colour	Dimensions mm			Weight		pcs.
			d12	d13	l10	100 pcs. ~ kg Cu	Total	
10	622R	■	7.0	9.0	42	0.72	0.84	25
16	623R	■	8.5	10.5	50	1.00	1.16	25
25	624R	■	10.0	12.0	57	1.41	1.63	25
35	625R	■	12.0	14.4	65	2.24	2.60	25
50	626R	■	14.0	16.4	72	3.36	3.81	25
70	627R	■	16.4	19.0	80	4.87	5.46	25
95	628R	■	17.8	20.8	87	5.91	6.74	25
120	629R	■	19.3	22.3	94	7.00	7.96	10
150	630R	■	20.8	23.8	103	8.12	9.32	10

► Tool: see chart page 46

■ **Tubular cable lugs, copper 10 - 300 mm<sup>2</sup>**

For fine strand conductors, DIN VDE 60228  
(e.g. VDE 0295 Class 5 and 6)

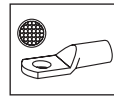

- **Flared cable entry to ease insertion**

**Characteristics**

- Annealed material optimises material and crimping characteristics
- Tube dimensions suitable for fine strand conductors

**Material**

- Copper to EN 13600

**Surface**

- Tin plated

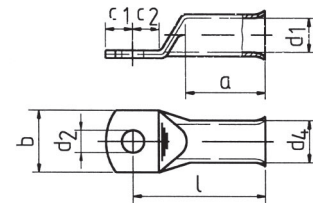

**Order info**

- Also available with inspection hole, part number with „ms“

Cross-section mm <sup>2</sup>	Size of bolt Ø	Part No.	Dimensions mm								Weight/ 100 pcs. ~ kg	pcs.
			d1	a	b	d2	d4	c1	c2	l		
10	M5	<b>702F5</b>	5.5	14	12	5.3	8.0	6.25	7.5	27	0.72	100
	M6	<b>702F6</b>	5.5	14	12	6.5	8.0	6.25	7.5	27	0.71	100
	M8	<b>702F8</b>	5.5	14	16	8.5	8.0	8.50	9.5	29	0.77	100
	M10	<b>702F10</b>	5.5	14	16	10.5	8.0	10.50	11.5	31	0.82	100
	M12	<b>702F12</b>	5.5	14	19	13.0	8.0	12.00	13.0	32	0.82	100
16	M5	<b>703F5</b>	6.6	15	13	5.3	9.5	6.25	7.5	30	1.10	100
	M6	<b>703F6</b>	6.6	15	13	6.5	9.5	6.25	7.5	30	1.07	100
	M8	<b>703F8</b>	6.6	15	16	8.5	9.5	10.00	10.0	32	1.21	100
	M10	<b>703F10</b>	6.6	15	17	10.5	9.5	12.00	12.0	34	1.28	100
	M12	<b>703F12</b>	6.6	15	19	13.0	9.5	13.00	13.0	35	1.28	100
25	M5	<b>704F5</b>	7.9	17	15	5.3	11.0	7.50	7.5	32	1.52	25
	M6	<b>704F6</b>	7.9	17	15	6.5	11.0	7.50	7.5	32	1.50	100
	M8	<b>704F8</b>	7.9	17	17	8.5	11.0	10.00	10.0	34	1.61	100
	M10	<b>704F10</b>	7.9	17	17	10.5	11.0	12.00	12.0	37	1.71	100
	M12	<b>704F12</b>	7.9	17	19	13.0	11.0	13.00	13.0	38	1.74	25
35	M6	<b>705F6</b>	9.2	19	17	6.5	12.5	7.50	7.5	35	1.91	100
	M8	<b>705F8</b>	9.2	19	18	8.5	12.5	10.00	10.0	37	2.08	100
	M10	<b>705F10</b>	9.2	19	18	10.5	12.5	12.00	12.0	40	2.24	100
	M12	<b>705F12</b>	9.2	19	19	13.0	12.5	13.00	13.0	41	2.22	25
	M14	<b>705F14</b>	9.2	19	21	15.0	12.5	14.50	14.5	43	2.41	25
50	M6	<b>706F6</b>	11.0	21	21	6.5	15.0	10.00	10.0	41	3.54	25
	M8	<b>706F8</b>	11.0	21	21	8.5	15.0	10.00	10.0	41	3.44	50
	M10	<b>706F10</b>	11.0	21	21	10.5	15.0	12.00	12.0	43	3.64	50
	M12	<b>706F12</b>	11.0	21	21	13.0	15.0	13.00	13.0	46	3.73	50
	M14	<b>706F14</b>	11.0	21	23	15.0	15.0	14.50	14.5	48	3.89	25
	M16	<b>706F16</b>	11.0	21	28	17.0	15.0	16.00	16.0	50	4.02	25
70	M8	<b>707F8</b>	13.0	25	25	8.5	17.0	10.00	10.0	46	4.46	50
	M10	<b>707F10</b>	13.0	25	25	10.5	17.0	12.00	12.0	48	4.62	50
	M12	<b>707F12</b>	13.0	25	25	13.0	17.0	13.00	13.0	50	4.71	50
	M14	<b>707F14</b>	13.0	25	25	15.0	17.0	14.50	14.5	52	4.87	25
	M16	<b>707F16</b>	13.0	25	25	17.0	17.0	16.00	16.0	54	5.85	25
95	M8	<b>708F8</b>	14.5	26	28	8.5	19.0	12.00	12.0	52	6.35	25
	M10	<b>708F10</b>	14.5	26	28	10.5	19.0	12.00	12.0	52	6.23	50
	M12	<b>708F12</b>	14.5	26	28	13.0	19.0	13.00	13.0	53	6.31	50
	M14	<b>708F14</b>	14.5	26	28	15.0	19.0	14.50	14.5	55	6.46	25
	M16	<b>708F16</b>	14.5	26	28	17.0	19.0	16.00	16.0	56	6.56	50

■ **Tubular cable lugs, copper 10 - 300 mm<sup>2</sup>**

For fine strand conductors, DIN VDE 60228  
(e.g. VDE 0295 Class 5 and 6)

Cross-section mm <sup>2</sup>	Size of bolt Ø	Part No.	Dimensions mm								Weight/ 100 pcs.	
			d1	a	b	d2	d4	c1	c2	l	~ kg	pcs.
120	M10	<b>709F10</b>	16.2	30	30	10.5	21.0	14.00	14.0	57	8.31	50
	M12	<b>709F12</b>	16.2	30	30	13.0	21.0	15.00	15.0	58	8.39	50
	M14	<b>709F14</b>	16.2	30	30	15.0	21.0	15.00	15.0	58	8.06	25
	M16	<b>709F16</b>	16.2	30	30	17.0	21.0	16.00	16.0	59	8.17	50
	M20	<b>709F20</b>	16.2	30	36	21.0	21.0	22.00	22.0	66	9.56	25
150	M10	<b>710F10</b>	18.0	32	34	10.5	23.0	15.00	16.0	64	10.91	10
	M12	<b>710F12</b>	18.0	32	34	13.0	23.0	16.00	17.0	65	10.89	25
	M14	<b>710F14</b>	18.0	32	34	15.0	23.0	18.00	19.0	67	11.42	10
	M16	<b>710F16</b>	18.0	32	34	17.0	23.0	19.00	20.0	68	11.30	10
	M20	<b>710F20</b>	18.0	32	40	21.0	23.0	21.00	22.0	70	11.36	10
185	M12	<b>711F12</b>	20.6	35	39	13	26	21.5	19	72	15.40	10
	M14	<b>711F14</b>	20.6	35	39	15	26	21.5	19	72	15.20	10
	M16	<b>711F16</b>	20.6	35	39	17	26	21.5	19	72	15.00	25
	M20	<b>711F20</b>	20.6	35	39	21	26	21.5	19	72	14.20	10
240	M12	<b>712F12</b>	23.1	44	41	13	28	16.0	17	80	16.30	10
	M14	<b>712F14</b>	23.1	44	41	15	28	19.0	20	83	16.80	10
	M16	<b>712F16</b>	23.1	44	41	17	28	19.0	20	83	16.71	25
	M20	<b>712F20</b>	23.1	44	41	21	28	21.0	22	85	17.12	10
300	M12	<b>713F12</b>	26.1	44	47	13	32	19.0	22	96	25.60	5
	M14	<b>713F14</b>	26.1	44	47	15	32	19.0	22	96	26.56	5
	M16	<b>713F16</b>	26.1	44	47	17	32	19.0	22	96	25.60	5
	M20	<b>713F20</b>	26.1	44	47	21	32	22.0	22	96	26.24	5

► Tool: see chart page 47

■ **Angle tubular cable lugs, copper, 10 - 185 mm<sup>2</sup>, 90° angle**

For fine strand conductors, DIN VDE 60228  
(e.g. VDE 0295 Class 5 and 6)

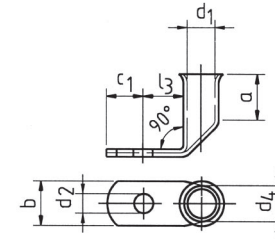
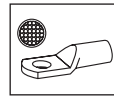

- **Flared cable entry to ease insertion**

**Characteristics**

- Annealed material optimises material and crimping characteristics
- Flat contact surface by special manufacturing processes
- Tube dimensions suitable for fine strand conductors

**Material**

- Copper to EN 13600

**Surface**

- Tin plated

**Order info**

- 45° angle version also available, part number with „45“
- Also available with inspection hole, part number with „ms“

Cross-section mm <sup>2</sup>	Size of bolt Ø	Part No.	Dimensions mm							Weight/ 100 pcs. ~ kg	pcs.
			d1	a	b	d2	d4	c1	l3 min.		
10	M5	<b>742F5</b>	5.5	14	12	5.3	8.0	6.25	7.5	0.80	50
	M6	<b>742F6</b>	5.5	14	12	6.5	8.0	6.25	7.5	0.78	50
	M8	<b>742F8</b>	5.5	14	16	8.5	8.0	9.00	9.5	0.84	50
	M10	<b>742F10</b>	5.5	14	16	10.5	8.0	10.50	12.0	0.88	50
	M12	<b>742F12</b>	5.5	14	19	13.0	8.0	12.00	13.0	0.90	50
16	M5	<b>743F5</b>	6.6	15	13	5.3	9.5	6.25	7.5	1.12	50
	M6	<b>743F6</b>	6.6	15	13	6.5	9.5	6.25	7.5	1.12	50
	M8	<b>743F8</b>	6.6	15	16	8.5	9.5	10.00	10.0	1.30	50
	M10	<b>743F10</b>	6.6	15	17	10.5	9.5	12.00	12.0	1.38	50
	M12	<b>743F12</b>	6.6	15	19	13.0	9.5	13.00	13.0	1.34	50
25	M5	<b>744F5</b>	7.9	17	15	5.3	11.0	7.50	7.5	1.52	25
	M6	<b>744F6</b>	7.9	17	15	6.5	11.0	7.50	7.5	1.54	25
	M8	<b>744F8</b>	7.9	17	17	8.5	11.0	10.00	10.0	1.80	25
	M10	<b>744F10</b>	7.9	17	17	10.5	11.0	12.00	12.0	1.79	25
	M12	<b>744F12</b>	7.9	17	19	13.0	11.0	13.00	13.0	1.76	25
35	M6	<b>745F6</b>	9.2	19	17	6.5	12.5	7.50	7.5	2.02	25
	M8	<b>745F8</b>	9.2	19	18	8.5	12.5	10.00	10.0	2.18	25
	M10	<b>745F10</b>	9.2	19	18	10.5	12.5	12.00	12.0	2.30	25
	M12	<b>745F12</b>	9.2	19	19	13.0	12.5	13.00	13.0	2.26	25
	M14	<b>745F14</b>	9.2	19	21	15.0	12.5	14.50	14.5	2.65	25
50	M6	<b>746F6</b>	11.0	21	21	6.5	15.0	10.00	10.0	3.75	25
	M8	<b>746F8</b>	11.0	21	21	8.5	15.0	10.00	10.0	3.57	25
	M10	<b>746F10</b>	11.0	21	21	10.5	15.0	12.00	12.0	3.83	25
	M12	<b>746F12</b>	11.0	21	21	13.0	15.0	13.00	13.0	3.74	25
	M14	<b>746F14</b>	11.0	21	23	15.0	15.0	14.50	14.5	4.20	25
	M16	<b>746F16</b>	11.0	21	28	17.0	15.0	16.00	16.0	4.35	25
70	M8	<b>747F8</b>	13.0	25	25	8.5	17.0	10.00	10.0	4.83	25
	M10	<b>747F10</b>	13.0	25	25	11.0	17.0	12.00	12.0	5.18	25
	M12	<b>747F12</b>	13.0	25	25	13.0	17.0	13.00	13.0	5.16	25
	M14	<b>747F14</b>	13.0	25	25	15.0	17.0	14.50	14.5	5.38	25
	M16	<b>747F16</b>	13.0	25	25	17.0	17.0	16.00	16.0	6.50	25

■ **Angle tubular cable lugs, copper,  
10 - 185 mm<sup>2</sup>, 90° angle**

For fine strand conductors, DIN VDE 60228  
(e.g. VDE 0295 Class 5 and 6)

Cross-section mm <sup>2</sup>	Size of bolt Ø	Part No.	Dimensions mm							Weight/ 100 pcs. ~ kg	pcs.
			d1	a	b	d2	d4	c1	l3 min.		
95	M8	<b>748F8</b>	14.5	26	28	8.5	19.0	12.00	12.0	6.66	25
	M10	<b>748F10</b>	14.5	26	28	11.0	19.0	12.00	12.0	6.04	25
	M12	<b>748F12</b>	14.5	26	28	13.0	19.0	13.00	13.0	6.58	25
	M14	<b>748F14</b>	14.5	26	28	15.0	19.0	14.50	14.5	7.24	25
	M16	<b>748F16</b>	14.5	26	28	17.0	19.0	16.00	16.0	7.34	25
120	M10	<b>749F10</b>	16.2	30	30	11.0	21.0	14.00	14.0	8.76	10
	M12	<b>749F12</b>	16.2	30	30	13.0	21.0	15.00	15.0	8.76	10
	M14	<b>749F14</b>	16.2	30	30	15.0	21.0	15.00	15.0	9.15	10
	M16	<b>749F16</b>	16.2	30	30	17.0	21.0	16.00	16.0	8.54	10
	M20	<b>749F20</b>	16.2	30	36	21.0	21.0	22.00	22.0	9.60	10
150	M10	<b>750F10</b>	18.0	32	34	11	23	15.0	16	11.54	10
	M12	<b>750F12</b>	18.0	32	34	13	23	16.0	18	11.58	10
	M14	<b>750F14</b>	18.0	32	34	15	23	18.0	19	11.90	10
	M16	<b>750F16</b>	18.0	32	34	17	23	19.0	20	11.80	10
	M20	<b>750F20</b>	18.0	32	40	21	23	21.0	22	12.00	10
185	M12	<b>751F12</b>	20.6	35	39	13	26	21.5	19	16.36	10
	M14	<b>751F14</b>	20.6	35	39	15	26	21.5	19	16.20	10
	M16	<b>751F16</b>	20.6	35	39	17	26	21.5	19	15.36	10
	M20	<b>751F20</b>	20.6	35	39	21	26	21.5	19	15.80	10

► Tool: see chart page 47

■ **Butt-connector, copper 10 - 150 mm<sup>2</sup>**

For fine strand conductors, DIN VDE 60228  
(e.g. VDE 0295 Class 5 and 6)

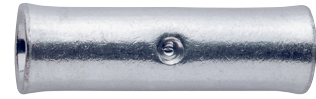
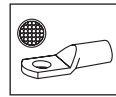

- Flared cable entry to ease insertion
- With buttmarks for precise cable insertion

**Characteristics**

- Annealed material optimises material and crimping characteristics
- Tube dimensions suitable for fine strand conductors

**Material**

- Copper to EN 13600

**Surface**

- Tin plated

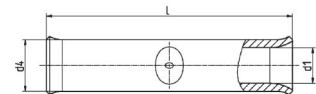

Cross-section mm <sup>2</sup>	Part No.	Dimensions mm			Weight/100 pcs. ~ kg	pcs.
		d1	d4	l		
10	<b>722F</b>	5.5	8.0	38	0.90	100
16	<b>723F</b>	6.6	9.5	38	1.25	100
25	<b>724F</b>	7.9	11.0	38	1.56	50
35	<b>725F</b>	9.2	12.5	45	2.19	50
50	<b>726F</b>	11.0	15.0	45	3.37	50
70	<b>727F</b>	13.0	17.0	54	4.65	50
95	<b>728F</b>	14.5	19.0	56	6.05	25
120	<b>729F</b>	16.2	21.0	60	7.58	25
150	<b>730F</b>	18.0	23.0	68	9.83	10

► Tool: see chart page 47

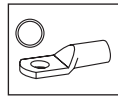

**■ Tubular cable lugs, copper 6 - 50 mm<sup>2</sup>**

Special type, for solid conductors (re) e.g. to VDE 0295 Class 1

■ Tube dimensions suitable for solid conductors

**Characteristics**

■ Annealed material optimises material and crimping characteristics

**Material**

■ Copper to EN 13600

**Surface**

■ Tin plated

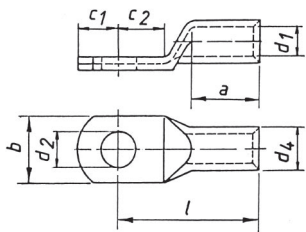

Cross-section mm <sup>2</sup>	Size of bolt Ø	Part No.	Dimensions mm								Weight/ 100 pcs. ~ kg	pcs.
			d1	a	b	d2	d4	c1	c2	l		
6	M5	SR65	3.0	8	9.0	5.3	5	4.75	6.0	17.0	0.213	25
	M6	SR66	3.0	8	10.0	6.5	5	6.50	6.5	19.0	0.220	25
10	M6	SR106	4.0	9	10.0	6.5	6	7.00	6.5	19.0	0.300	25
	M8	SR108	4.0	9	14.0	8.5	6	8.50	9.5	22.0	0.320	25
16	M6	SR166	5.0	12	12.5	6.5	8	6.50	7.0	23.5	0.800	25
	M8	SR168	5.0	12	15.0	8.5	8	9.00	9.0	26.0	0.900	25
25	M6	SR256	6.2	15	14.0	6.5	10	7.50	7.5	30.0	1.560	25
	M8	SR258	6.2	15	16.0	8.5	10	10.00	10.0	32.0	1.700	25
35	M6	SR356	7.0	15	14.0	6.5	10	7.50	7.5	30.0	1.200	25
	M8	SR358	7.0	15	16.0	8.5	10	10.00	10.0	32.0	1.310	25
	M10	SR3510	7.0	15	18.0	10.5	10	12.00	12.0	34.0	1.570	25
50	M6	SR506	8.5	17	17.0	6.5	12	7.50	7.5	32.0	1.850	25
	M8	SR508	8.5	17	17.0	8.5	12	10.00	10.0	34.0	2.000	25
	M10	SR5010	8.5	17	19.0	10.5	12	12.00	12.0	37.0	2.130	25

► Tool: see chart page 49

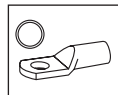

**■ Butt-connector, copper 1.5 - 50 mm<sup>2</sup>**

Special type, for solid conductors (re) e.g. to VDE 0295 Class 1

■ Tube dimensions suitable for solid conductors

**Characteristics**

■ Annealed material optimises material and crimping characteristics

**Material**

■ Copper to EN 13600

**Surface**

■ Tin plated

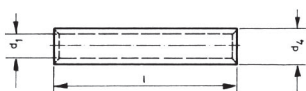

Cross-section mm <sup>2</sup>	Part No.	Wire Ø	Dimensions mm			Weight/ 100 pcs. ~ kg	pcs.
			d1	d4	l		
1.5-2.5	SV1525	1.38/1.78	1.9	3.9	25	0.210	100
4	SV4	2.25	2.4	4.4	25	0.240	100
6	SV6	2.75	3.0	5.0	25	0.275	100

■ **Butt-connector, copper 1.5 - 50 mm<sup>2</sup>**

Special type, for solid conductors (re) e.g. to VDE 0295 Class 1

Cross-section mm <sup>2</sup>	Part No.	Wire Ø	Dimensions mm			Weight/100 pcs. ~ kg	pcs.
			d1	d4	l		
10	<b>SV10</b>	3.55	4.0	6.0	25	0.350	100
16	<b>SV16</b>	4.5	5.0	8.0	35	0.960	100
25	<b>SV25</b>	5.65	6.2	10.0	40	1.700	50
35	<b>SV35</b>	6.7	7.0	10.0	40	1.420	50
50	<b>SV50</b>	8	8.5	12.0	70	3.550	50

► Tool: see chart page 49

■ **T-connectors, copper 1.5 - 50 mm<sup>2</sup>**

Special type, for solid conductors (re) e.g. to VDE 0295 Class 1

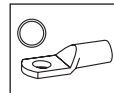

■ **For single cable tap conductors**

**Characteristics**

- Annealed material optimises material and crimping characteristics
- Tube dimensions suitable for solid conductors

**Material**

- Copper to EN 13600

**Surface**

- Tin plated

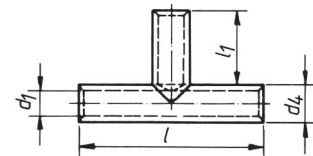
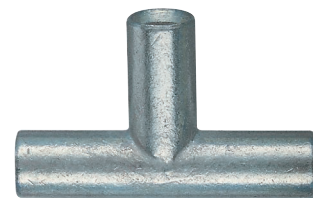

Cross-section mm <sup>2</sup>	Part No.	Wire Ø	Dimensions mm				Weight/100 pcs. ~ kg	pcs.
			d1	d4	l	l1		
1.5-2.5	<b>STV1525</b>	1.38/1.78	1.9	3.9	30	12	0.34	50
4	<b>STV4</b>	2.25	2.4	4.4	30	12	0.40	50
6	<b>STV6</b>	2.75	3.0	5.0	30	12	0.48	50
10	<b>STV10</b>	3.55	4.0	6.0	35	14	0.72	50
16	<b>STV16</b>	4.5	5.0	8.0	35	14	1.40	50
25	<b>STV25</b>	5.65	6.2	10.0	50	21	3.20	25
35	<b>STV35</b>	6.7	7.0	10.0	55	23	2.95	25
50	<b>STV50</b>	8	8.5	12.0	76	32	5.60	25

► Tool: see chart page 49

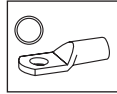
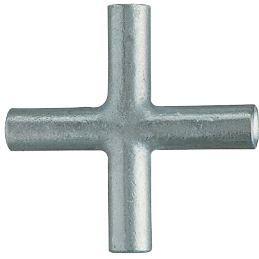

■ **Cross-connector, copper 1.5 - 50 mm<sup>2</sup>**

Special type, for solid conductors (re) e.g. to VDE 0295 Class 1

- For double cable tap conductor

**Characteristics**

- Annealed material optimises material and crimping characteristics
- Tube dimensions suitable for solid conductors

**Material**

- Copper to EN 13600

**Surface**

- Tin plated

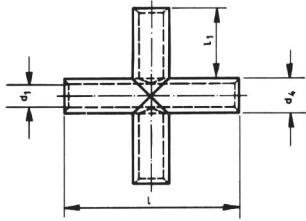

Cross-section mm <sup>2</sup>	Part No.	Wire ∅	Dimensions mm				Weight/ 100 pcs. ~ kg	pcs.
			d1	d4	l	l1		
1.5-2.5	<b>SKV1525</b>	1.38/1.78	1.9	3.9	30	12	0.47	25
4	<b>SKV4</b>	2.25	2.4	4.4	30	12	0.56	25
6	<b>SKV6</b>	2.75	3.0	5.0	30	12	0.67	25
10	<b>SKV10</b>	3.55	4.0	6.0	35	14	0.92	25
16	<b>SKV16</b>	4.5	5.0	8.0	35	14	1.86	25
25	<b>SKV25</b>	5.65	6.2	10.0	50	21	4.20	15
35	<b>SKV35</b>	6.7	7.0	10.0	55	23	3.80	15
50	<b>SKV50</b>	8	8.5	12.0	76	32	7.35	15

► Tool: see chart page 49

**■ Tubular cable lug for switch gear connections, copper 35 - 300 mm<sup>2</sup>**

Narrow palm version

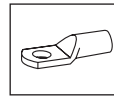

- For connections in switch cabinets with reduced connecting space
- For stranded conductors e.g. VDE 0295 Class 2

**Characteristics**

- Annealed material optimises material and crimping characteristics

**Material**

- Copper to EN 13600

**Surface**

- Tin plated

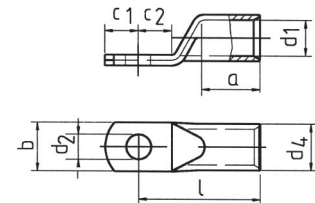

**Order info**

- Also available with inspection hole, part number with „ms“

Cross-section mm <sup>2</sup>	Size of bolt Ø	Part No.	Dimensions mm								Weight/ 100 pcs. ~ kg	pcs.
			d1	a	b	d2	d4	c1	c2	l		
35	M6	<b>5SG6</b>	8.5	17	15.0	6.5	12.0	7.5	7.5	32	1.78	25
50	M6	<b>6SG6</b>	10.0	19	15.0	6.5	14.0	10.0	10.0	37	2.95	25
	M8	<b>6SG8</b>	10.0	19	17.0	8.5	14.0	10.0	10.0	37	2.82	25
	M10	<b>6SG10</b>	10.0	19	19.0	10.5	14.0	11.5	12.0	39	3.08	25
70	M6	<b>7SG6</b>	12.0	21	17.0	6.5	16.5	10.0	10.0	43	4.22	25
	M8	<b>7SG8</b>	12.0	21	17.0	8.5	16.5	10.0	10.0	43	4.10	25
	M10	<b>7SG10</b>	12.0	21	19.0	10.5	16.5	11.5	12.0	44	4.45	25
	M12	<b>7SG12</b>	12.0	21	19.0	13.0	16.5	13.0	13.0	46	4.22	25
95	M6	<b>8SG6</b>	13.5	25	19.0	6.5	18.0	11.5	12.0	48	5.49	25
	M8	<b>8SG8</b>	13.5	25	19.0	8.5	18.0	11.5	12.0	48	5.46	25
	M10	<b>8SG10</b>	13.5	25	19.0	10.5	18.0	11.5	12.0	48	5.13	25
	M12	<b>8SG12</b>	13.5	25	19.0	13.0	18.0	13.0	13.0	49	5.15	25
120	M6	<b>9SG6</b>	15.0	26	19.0	6.5	19.5	11.5	14.0	51	6.16	10
	M8	<b>9SG8</b>	15.0	26	19.0	8.5	19.5	11.5	14.0	51	5.94	10
	M10	<b>9SG10</b>	15.0	26	19.0	10.5	19.5	11.5	14.0	51	5.81	10
	M12	<b>9SG12</b>	15.0	26	19.0	13.0	19.5	14.0	14.0	51	5.92	10
150	M6	<b>10SG6</b>	16.5	30	19.0	6.5	21.0	11.5	14.0	56	6.85	10
	M8	<b>10SG8</b>	16.5	30	19.0	8.5	21.0	11.5	14.0	56	6.80	10
	M10	<b>10SG10</b>	16.5	30	19.0	10.5	21.0	11.5	14.0	56	6.75	10
	M12	<b>10SG12</b>	16.5	30	19.0	13.0	21.0	15.0	15.0	57	7.15	10
185	M10	<b>11SG10</b>	19.0	30	24.5	10.5	24.0	11.5	18.0	65	10.59	10
	M12	<b>11SG12</b>	19.0	30	31.0	13.0	24.0	18.0	18.0	65	11.09	10
	M16	<b>11SG16</b>	19.0	30	31.0	17.0	24.0	18.0	18.0	65	9.76	10
240	M10	<b>12SG10</b>	21.0	35	31.0	10.5	26.0	11.5	19.0	72	12.70	5
	M12	<b>12SG12</b>	21.0	35	31.0	13.0	26.0	21.5	19.0	72	13.72	5
	M16	<b>12SG16</b>	21.0	35	31.0	17.0	26.0	21.5	19.0	72	13.28	5
300	M10	<b>13SG10</b>	23.5	44	31.0	10.5	30.0	11.5	24.0	87	19.70	5
	M12	<b>13SG12</b>	23.5	44	31.0	13.0	30.0	24.0	24.0	87	22.72	5
	M16	<b>13SG16</b>	23.5	44	31.0	17.0	30.0	24.0	24.0	87	22.50	5

► Tool: see chart page 44

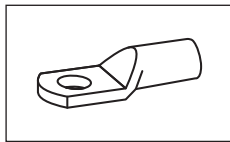

### ■ Tool application chart

**Tubular cable lugs, butt-connectors, parallel connectors and T-connectors „standard type“ and tubular cable lugs for switchgear connections made from Cu**

Crimping range corresponds to nominal cross-section mm <sup>2</sup>	Crimping tools		Tool type						Crimping profile	Page (Tool)
	Tools	Crimping head/adaptor	Mechanical crimping tools	mechanical, electrical, pneumatic, crimping tools with interchangeable dies/heads	hand hydraulic crimping tools	Battery powered crimping tools	Hydraulic crimping systems	Hydraulic crimping heads		
0.5-6	K13		•						☺	257
0.75-2.5	KP1	+KP232		•					☺	267
	KP1L	+KP232		•					☺	267
	EKP1	+KP232				•			☺	322
	TEKP1	+KP232		•					☺	419
	KPM15	+KP232		•					☺	420
0.75-10	K50			•					☺	271
	EK1550					•			☺	316
	EK1550G					•			☺	320
	EK1550ST					•			☺	318
0.75-16	K2		•					☺	257	
1-4	K511		•					☺	278	
4-10	KP1	+KP242		•					☺	267
	KP1L	+KP242		•					☺	267
	EKP1	+KP242				•			☺	322
	TEKP1	+KP242		•					☺	419
	KPM15	+KP242		•					☺	420
6-50	K5		•						☺	260
	K05		•						☺	262
6+10	K512		•					☺	278	
6-120	EK354					•			☺	324
6-185	K18			•					☺	274
	HK6018				•				☺	294
	EK18PLUS					•			☺	326
	PK18							•	☺	387
	THK18						•		☺	358
	HK60UNV	+ UA18			•				☺	309
	EK60UNV	+ UA18				•			☺	347
	PK60UNV	+ UA18						•	☺	405
6-300	K22			•					☺	276
	HK6022				•				☺	296
	EK22PLUS					•			☺	328
	PK22							•	☺	389
	THK22						•		☺	360
	HK60UNV	+ UA22			•				☺	309
	EK60UNV	+ UA22				•			☺	347
	PK60UNV	+ UA22						•	☺	405

See next page

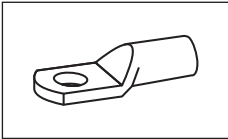

**■ Tool application chart**

**Tubular cable lugs, butt-connectors, parallel connectors and T-connectors „standard type“ and tubular cable lugs for switchgear connections made from Cu**

Crimping range corresponds to nominal cross-section mm²	Crimping tools		Tool type						Crimping profile	Page (Tool)
	Tools	Crimping head/ adapter	Mechanical crimping tools	mechanical, electrical, pneumatic, crimping tools with interchangeable dies/heads	hand hydraulic crimping tools	Battery powered crimping tools	Hydraulic crimping systems	Hydraulic crimping heads		
10-120	K06		•						⬡	264
10-240	HK60VP				•				⬢	298
	EK60VPPLUS					•			⬢	330
	PK60VP							•	⬢	391
16-95	K08		•						⬡	263
	K95		•						⬣	259
	TK95		•						⬣	259
16-300	HK60VPFT				•				⬢	299
	EK60VPFTPLUS					•			⬢	331
	PK60VPFT							•	⬢	392
16-400	HK12025				•				⬡	300
	HK12042				•				⬡	302
	HK120U				•				⬡	304
	EK12025					•			⬡	332
	EK12042					•			⬡	334
	EK120UPLUS					•			⬡	336
	HK122						•		⬡	362
	HK122EL220						•		⬡	367
	HK122EL380						•		⬡	367
	PK12038							•	⬡	393
	PK120U							•	⬡	395
	HK252						•		⬡	364
	HK252EL220						•		⬡	369
	HK252EL380						•		⬡	369
PK252							•	⬡	397	
25-150	K09		•						⬡	265
35-95	K8		•						⬣	262
50-120	K6		•						⬣	260
120-240	K7		•						⬣	261
185-400	K07		•						⬣	261



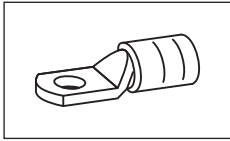

■ Tool application chart

Insulated tubular cable lugs and butt-connectors „standard type“

Crimping range corresponds to nominal cross-section mm <sup>2</sup>	Crimping tools		Tool type						Crimping profile	Page (Tool)	
	Tools	Crimping head/ adapter	Mechanical crimping tools	mechanical, electrical, pneumatic, crimping tools with interchangeable dies/heads	hand hydraulic crimping tools	Battery powered crimping tools	Hydraulic crimping systems	Hydraulic crimping heads			
10-70	EK354					•			○	324	
10-95	K18			•					○	274	
	HK6018				•				○	294	
	EK18PLUS					•			○	326	
	PK18							•	○	387	
	THK18						•		○	358	
	HK60UNV + UA18					•			○	309	
	EK60UNV + UA18						•		○	347	
	PK60UNV + UA18							•	○	405	
10-150	K22			•					○	276	
	HK6022				•				○	296	
	EK22PLUS					•			○	328	
	PK22							•	○	389	
	THK22						•		○	360	
	HK60UNV + UA22				•				○	309	
	EK60UNV + UA22					•			○	347	
	PK60UNV + UA22							•	○	405	
	HK12025				•				○	300	
	HK12042				•				○	302	
	HK120U				•				○	304	
	EK12025					•			○	332	
	EK12042					•			○	334	
	EK120UPLUS					•			○	336	
	HK122							•	○	362	
	HK122EL220							•	○	367	
	HK122EL380							•	○	367	
	PK12038								•	○	393
	PK120U								•	○	395
	HK252							•	○	364	
	HK252EL220							•	○	369	
	HK252EL380							•	○	369	
	PK252								•	○	397

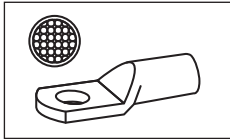

■ **Tool application chart**

**Tubular cable lugs and butt-connectors for fine stranded conductors**

Crimping range corresponds to nominal cross-section mm <sup>2</sup>	Crimping tools		Tool type						Crimping profile	Page (Tool)
	Tools	Crimping head/ adapter	Mechanical crimping tools	mechanical, electrical, pneumatic, crimping tools with interchangeable dies/heads	hand hydraulic crimping tools	Battery powered crimping tools	Hydraulic crimping systems	Hydraulic crimping heads		
10-50	EK354					•			☺	324
	K5		•						☺	260
	K18			•					☺	274
	HK6018				•				☺	294
	EK18PLUS					•			☺	326
	PK18							•	☺	387
	THK18						•		☺	358
	HK60UNV + UA18				•				☺	309
	EK60UNV + UA18						•		☺	347
	PK60UNV + UA18							•	☺	405
10-70	K22			•					☺	276
	HK6022				•				☺	296
	EK22PLUS					•			☺	328
	PK22							•	☺	389
	THK22						•		☺	360
	HK60UNV + UA22				•				☺	309
	EK60UNV + UA22						•		☺	347
	PK60UNV + UA22							•	☺	405
10-240	HK60VP				•				☹	298
	EK60VPPLUS					•			☹	330
	PK60VP							•	☹	391
16-95	K95		•						☺	259
	TK95		•						☺	259
16-150	HK60VPFT				•				☹	299
	HK12025				•				☺	300
	HK12042				•				☺	302
	HK120U				•				☺	304
	EK60VPFTPLUS					•			☹	331
	EK12025					•			☺	332
	EK12042					•			☺	334
	EK120UPLUS					•			☺	336
	HK122						•		☺	362
	HK122EL220						•		☺	367
	PK60VPFT							•	☹	392
	PK12038							•	☺	393
	PK120U							•	☺	395

See next page

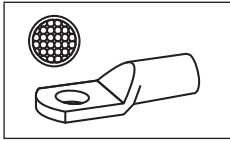

### ■ Tool application chart

#### Tubular cable lugs and butt-connectors for fine stranded conductors

Crimping range corresponds to nominal cross-section mm <sup>2</sup>	Crimping tools		Tool type						Crimping profile	Page (Tool)
	Tools	Crimping head/ adapter	Mechanical crimping tools	mechanical, electrical, pneumatic, crimping tools with interchangeable dies/heads	hand hydraulic crimping tools	Battery powered crimping tools	Hydraulic crimping systems	Hydraulic crimping heads		
16-300	HK252						•			364
	HK252EL220						•			369
	HK252EL380						•			369
	PK252							•		397
35-95	K8		•							262
50-120	K6		•							260
120-240	K7		•							261

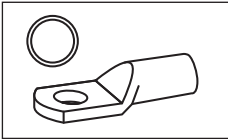

■ **Tool application chart**

**Tubular cable lugs and connectors for solid conductors**

Crimping range corresponds to nominal cross-section mm <sup>2</sup>	Crimping tools		Tool type						Crimping profile	Page (Tool)
	Tools	Crimping head/adaptor	Mechanical crimping tools	mechanical, electrical, pneumatic, crimping tools with interchangeable dies/heads	hand hydraulic crimping tools	Battery powered crimping tools	Hydraulic crimping systems	Hydraulic crimping heads		
0.75-16	K02		•						☺	258
1.5-4	K93		•						⬡	256
1.5-10	K50			•					⬡	271
	EK1550					•			⬡	316
	EK1550G					•			⬡	320
	EK1550ST					•			⬡	318
1.5-16	EK354					•			⬡	324
	K18			•					⬡	274
	HK6018				•				⬡	294
	EK18PLUS					•			⬡	326
	PK18							•	⬡	387
	THK18						•		⬡	358
	HK60UNV + UA18					•			⬡	309
	EK60UNV + UA18						•		⬡	347
	PK60UNV + UA18							•	⬡	405
	K22			•					⬡	276
	HK6022					•			⬡	296
	EK22PLUS						•		⬡	328
	PK22							•	⬡	389
	THK22						•		⬡	360
	HK60UNV + UA22					•			⬡	309
	EK60UNV + UA22						•		⬡	347
PK60UNV + UA22							•	⬡	405	
6-10	K94		•						⬡	256
25-50*	K05		•						⬡	262

\*For sizes 25 + 35 mm<sup>2</sup>, use the die size 25 mm<sup>2</sup>.  
 For size 50 mm<sup>2</sup> use die size 35 mm<sup>2</sup>.  
 We recommend 2 crimps on each side.



CABLE JOINTS, CABLE TERMINATIONS, CABLE GLANDS, CABLE CLEATS  
 FEEDER PILLARS, FUSE LINKS, ARC FLASH, CABLE ROLLERS, CUT-OUTS

11KV 33KV CABLE JOINTS & CABLE TERMINATIONS  
 FURSE EARTHING  
[www.cablejoints.co.uk](http://www.cablejoints.co.uk)  
**Thorne and Derrick UK**

Tel 0044 191 490 1547 Fax 0044 191 477 5371  
 Tel 0044 117 977 4647 Fax 0044 117 9775582