

## ACCESSORIES INTERFACE C

### Application

For use with connectors and bushings with an interface C as described by CENELEC EN 50180 and 50181.

### Technical characteristics

All these products, except the earthing plugs, are tested for AC withstand and partial discharge prior to leaving the factory.

**Up to 36 kV**

6/10 (12) kV  
6.35/11 (12) kV  
8.7/15 (17.5) kV  
12/20 (24) kV  
12.7/22 (24) kV  
18/30 (36) kV

### 400DR-B Dead-end receptacle

Fits over a bushing with a type C interface to provide 'dead-end' facility.

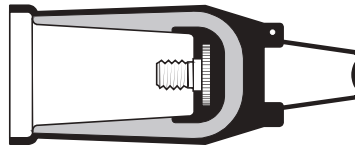

### Ordering instructions

Order  
400DR-B for 12 kV,  
K400DR-B for 24 kV or  
M400DR-B for 36 kV  
applications.  
The dead-end receptacle can  
be supplied with an earth lead.  
Order: -/G.  
E.g. K400DR-B/G.

### 400SOP-B Stand-off plug

Is designed to support and 'dead-end' connectors with a type C interface when removed from equipment.

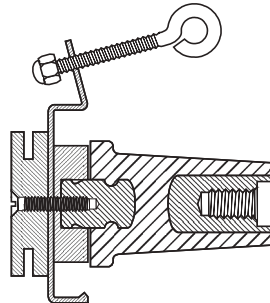

### Ordering instructions

Order  
400SOP-B for 12 kV,  
K400SOP-B for 24 kV or  
M400SOP-B for 36 kV  
applications.

### 400GP-B Earthing plug

Is designed to support and earth connectors with a type C interface when removed from equipment.

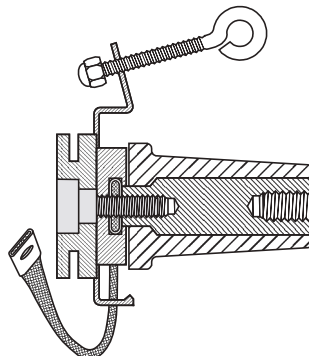

### Ordering instructions

Order  
400GP-B for 12, 24 or 36 kV  
applications.

### 300GP-B Earthing plug

Is designed to earth the 430TB-630A connectors when it is fixed-mounted to the equipment (maintenance earthing).

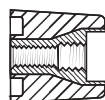

### Ordering instructions

Order  
300GP-B for 12 or 24 kV  
applications.

## 400BIPA Basic insulating plug

Acts as a tightening nut for the 400TB and 440TB tee connector kits.  
The plug contains a voltage detection point.  
The conductive rubber protection cap is included.

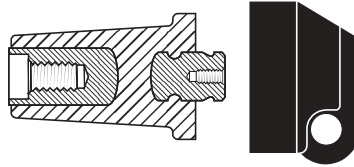

## Ordering instructions

Order  
400BIPA for 12 kV,  
K400BIPA for 24 kV or  
M400BIPA for 36 kV  
applications.

## 400CP-SC Connecting plug

For connecting two or more connectors with a type C interface together, thus creating a separable cable joint or a multiple cable connection to equipment.

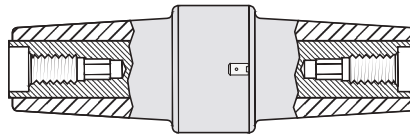

## Ordering instructions

Order  
400CP-SC for 12 kV,  
K400CP-SC for 24 kV or  
M400CP-SC for 36 kV  
applications.

## 440CP Connecting plug

For connecting two or more 440TB connectors, thus creating a separable cable joint or a multiple cable connection to equipment.  
For use up to 1250 A.  
Only for use with 440TB.

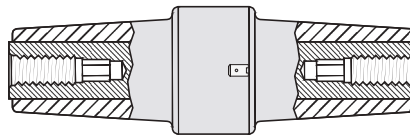

## Ordering instructions

Order  
440CP for 12 kV,  
K440CP for 24 kV or  
M440CP for 36 kV  
applications.  
Order: -/ATEX for use in  
potentially explosive  
atmospheres (for 12 kV max.).

## 400RTPA Reducing tap plug

Provides a type A interface to connectors with a type C interface.  
A 'C' spanner, 600SW, is used to tighten the reducing tap plug on to its mating part.

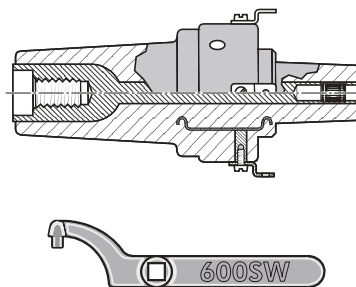

## Ordering instructions

Order  
400RTPA for 12 kV or  
K400RTPA for 24 applications.  
Order 600SW for the 'C'  
spanner.

## Kit MT Earthing kit for copper tape screened cables

Contains a tinned copper braid (25 mm<sup>2</sup> - L = 500 mm), a tinned copper wire for cleating and some water sealing mastic.

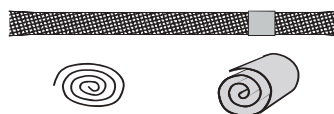

## Ordering instructions

Order  
Kit MT for 12 kV, 24 kV  
36 kV or 41.5 kV applications.