

Verbindungen mit **System**
The **Power** of Partnership



CABLE JOINTS, CABLE TERMINATIONS, CABLE GLANDS, CABLE CLEATS
FEEDER PILLARS, FUSE LINKS, ARC FLASH, CABLE ROLLERS, CUT-OUTS

11KV 33KV CABLE JOINTS & CABLE TERMINATIONS
FURSE EARTHING
www.cablejoints.co.uk

Thorne and Derrick UK
Tel 0044 191 490 1547 Fax 0044 191 477 5371
Tel 0044 117 977 4647 Fax 0044 117 9775582

Compression cable lugs and compression joints according to DIN

3

Compression cable lugs Al	3.2
Compression cable lugs AL-St / Bi-metallic washers (cupal)	3.4
Bi-metallic compression cable lugs	3.5
Compression joints Al DIN 46267, part 2 and similar versions	3.7
Reduction compression joints AL	3.9
Compression joints Al, full tension	3.11
Compression joints for Al-/St conductors DIN 48204	3.12
Compression joints Al with copper connection bolt	3.13
Bi-metallic compression joints	3.14
Tool application chart	3.16



Compression cable lugs AI

- DIN 46329; with barrier
- material: Al 99.5
- surface: bright
- optional tin plated (20 µm), to connect copper busbars (interior)

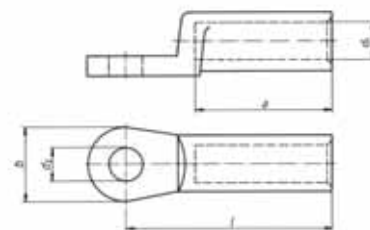

Cross section mm ²		Bolt size Ø	Part No.*	Die code	Dimensions mm					Number of crimps		Weight/ 100 pcs. ~ kg	pcs.	
rm/sm	se				d1	d2	b	l	a	mech.	hydr.			
16		25	M 8	**263R8	12	5.8	8.4	20	50	30	4	2	1.20	4
		25	M 10	**263R10	12	5.8	10.5	20	50	30	4	2	1.20	4
25		35	M 8	264R8	12	6.8	8.4	25	50	30	4	2	1.30	4
		35	M 10	264R10	12	6.8	10.5	25	50	30	4	2	1.24	4
		35	M 12	264R12	12	6.8	13.0	25	50	30	4	2	1.22	4
35		50	M 8	265R8	14	8.0	8.4	25	62	42	5	2	2.50	4
		50	M 10	265R10	14	8.0	10.5	25	62	42	5	2	1.98	4
		50	M 12	265R12	14	8.0	13.0	25	62	42	5	2	2.50	4
50		70	M 8	266R8	16	9.8	8.4	25	62	42	5	2	2.75	4
		70	M 10	266R10	16	9.8	10.5	25	62	42	5	2	2.70	4
		70	M 12	266R12	16	9.8	13.0	25	62	42	5	2	2.65	4
70		95	M 8	267R8	18	11.2	8.4	25	72	52	6	3	3.45	4
		95	M 10	267R10	18	11.2	10.5	25	72	52	6	3	3.80	4
		95	M 12	267R12	18	11.2	13.0	25	72	52	6	3	3.35	4
95		120	M 10	268R10	22	13.2	10.5	25	75	56	6	3	6.90	4
		120	M 12	268R12	22	13.2	13.0	25	75	56	6	3	4.92	4
		120	M 16	**268R16	22	13.2	17.0	25	75	56	6	3	6.00	4
120		150	M 10	269R10	22	14.7	10.5	30	80	56	6	3	5.95	4
		150	M 12	269R12	22	14.7	13.0	30	80	56	6	3	5.84	4
		150	M 16	269R16	22	14.7	17.0	30	80	56	6	3	6.60	4
150		185	M 10	270R10	25	16.3	10.5	30	90	60	6	3	8.50	4
		185	M 12	270R12	25	16.3	13.0	30	90	60	6	3	7.73	4
		185	M 16	270R16	25	16.3	17.0	30	90	60	6	3	7.60	4
		185	M 20	**270R20	25	16.3	21.0	30	90	60	6	3	8.20	4
185		240	M 10	271R10	28	18.3	10.5	30	91	60	6	3	11.00	4
		240	M 12	271R12	28	18.3	13.0	30	91	60	6	3	9.88	4
		240	M 16	271R16	28	18.3	17.0	30	91	60	6	3	10.10	4
		240	M 20	**271R20	28	18.3	21.0	30	91	60	6	3	10.00	4
240		300	M 10	**272R10	32	21.0	10.5	38	103	70	8	3	15.50	4
		300	M 12	272R12	32	21.0	13.0	38	103	70	8	3	13.80	4
		300	M 16	272R16	32	21.0	17.0	38	103	70	8	3	13.48	4
		300	M 20	272R20	32	21.0	21.0	38	103	70	8	3	15.00	4
300	--	M 12	273R12	34	23.3	13.0	38	103	70	8	3	17.60	1	
		M 16	273R16	34	23.3	17.0	38	103	70	8	3	17.28	1	
		M 20	273R20	34	23.3	21.0	38	103	70	8	3	17.40	1	
400	--	M 12	274R12	38	26.0	13.0	38	116	73	--	4	38.00	1	
		M 16	274R16	38	26.0	17.0	38	116	73	--	4	37.40	1	
		M 20	274R20	38	26.0	21.0	38	116	73	--	4	40.20	1	
500	--	M 12	275R12	44	29.0	13.0	44	122	79	--	4	43.70	1	
		M 16	275R16	44	29.0	17.0	44	122	79	--	4	43.30	1	
		M 20	275R20	44	29.0	21.0	44	122	79	--	4	43.00	1	

*Part number for tinned version with appendix "v"

** Not standardized

rm = round stranded; sm = sector stranded; se = sector solid

>> Tool: see chart page 3.16



Compression cable lugs AI

- for aluminium conductors DIN 48201 and pre-rounded sector shaped conductors
- material: Al 99.5
- surface: bright

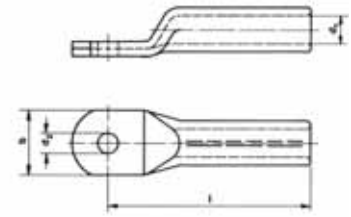

Cross section mm ²		Bolt size Ø	Part No.	Die code	Dimensions mm				Number of crimps		Weight/ 100 pcs.	
rm/sm	se				d1	d2	b	l	mech.	hydr.	~ kg	pcs.
10	--	M 6	202R6	10	5.0	6.5	16	52	4	2	0.86	25
	--	M 8	202R8	10	5.0	8.5	18	52	4	2	0.88	25
16	25	M 8	203R8	12	5.8	8.5	18	52	4	2	1.37	10
	25	M 10	203R10	12	5.8	10.5	18	52	4	2	1.39	10
25	35	M 8	204R8	12	6.8	8.5	18	60	4	2	1.41	10
	35	M 10	204R10	12	6.8	10.5	18	60	4	2	1.46	10
35	50	M 10	205R10	14	8.0	10.5	21	67	5	2	2.08	10
	50	M 12	205R12	14	8.0	13.0	21	67	5	2	2.05	10
50	70	M 10	206R10	16	9.8	10.5	25	72	5	2	2.68	10
	70	M 12	206R12	16	9.8	13.0	25	72	5	2	2.73	10
70	95	M 10	207R10	18	11.2	10.5	28	86	6	3	4.42	10
	95	M 12	207R12	18	11.2	13.0	28	86	6	3	4.27	10
95	120	M 10	208R10	22	13.2	10.5	32	90	6	3	7.40	4
	120	M 12	208R12	22	13.2	13.0	32	90	6	3	7.50	4
	120	M 16	208R16	22	13.2	17.0	34	90	6	3	7.30	4
120	150	M 12	209R12	22	14.7	13.0	32	91	6	3	6.68	4
	150	M 16	209R16	22	14.7	17.0	34	91	6	3	6.41	4
150	185	M 12	210R12	25	16.3	13.0	35	103	6	3	9.64	4
	185	M 16	210R16	25	16.3	17.0	35	103	6	3	9.24	4
	185	M 20	210R20	25	16.3	21.0	41	103	6	3	9.40	4
185	240	M 12	211R12	28	18.3	13.0	40	106	6	3	12.61	1
	240	M 16	211R16	28	18.3	17.0	40	106	6	3	11.92	1
	240	M 20	211R20	28	18.3	21.0	40	106	6	3	13.10	1
240	300	M 12	212R12	32	21.0	13.0	45	116	8	3	18.30	1
	300	M 16	212R16	32	21.0	17.0	45	116	8	3	17.60	1
	300	M 20	212R20	32	21.0	21.0	45	116	8	3	17.30	1
300	--	M 16	213R16	34	23.3	17.0	49	124	8	3	17.50	1
	--	M 20	213R20	34	23.3	21.0	49	124	8	3	17.30	1
400	--	M 16	214R16	38	26.0	17.0	58	165	--	4	32.20	1
	--	M 20	214R20	38	26.0	21.0	58	165	--	4	31.90	1

rm = round stranded; sm = sector stranded; se = sector solid

>> Tool: see chart page 3.16



Compression cable lugs

- for Al-St conductors according to DIN 48204
- material: E-Al 99.5
- surface: bright

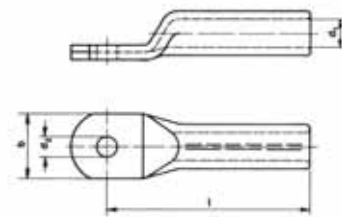

	Cross section mm ²	Bolt size Ø	Part No.	Die code	Cond. Ø mm	Dimensions mm				Weight/100 pcs. ~ kg	pcs.
						d1	d2	b	l		
25 - 4		M 8	254R8	12	6.8	7.6	8.5	19	60	1.5	5
		M 10	254R10	12	6.8	7.6	10.5	19	60	1.5	5
		M 12	254R12	12	6.8	7.6	13.0	23	60	1.6	5
35 - 6		M 10	255R10	14	8.1	9.0	10.5	21	67	2.0	5
		M 12	255R12	14	8.1	9.0	13.0	21	67	2.2	5
50 - 8		M 10	256R10	16	9.6	10.8	10.5	22	72	2.5	5
		M 12	256R12	16	9.6	10.8	13.0	24	72	2.6	5
		M 16	256R16	16	9.6	10.8	17.0	26	72	2.7	5
70 - 12		M 10	257R10	18	11.7	12.5	10.5	26	86	4.1	5
		M 12	257R12	18	11.7	12.5	13.0	26	86	4.3	5
		M 16	257R16	18	11.7	12.5	17.0	32	86	4.4	5
95 - 15		M 12	258R12	22	13.6	14.8	13.0	31	91	7.8	5
		M 16	258R16	22	13.6	14.8	17.0	33	91	6.6	5
120 - 20		M 12	259R12	25	15.5	16.5	13.0	37	103	9.8	5
		M 16	259R16	25	15.5	16.5	17.0	37	103	10.0	5
		M 20	259R20	25	15.5	16.5	21.0	41	103	10.1	5

>> Tool: see chart page 3.16



Bi-metallic washers (cupal)

- material: Al 99.5, one side copper plated

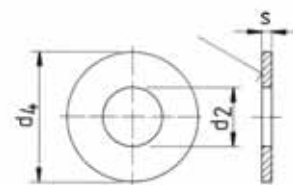

Bolt size Ø	Part No.	Dimensions mm			Weight/100 pcs. ~ kg	pcs.
		d4	d2	s		
M 8	CS818	18	8.5	1	0.09	10
M 10	CS1022	22	11.0	2	0.26	10
M 12	CS1228	28	13.0	2	0.44	10
M 14	CS1428	28	15.0	2	0.40	10
M 16	CS1635	35	17.0	2	0.66	10



Bi-metallic compression cable lugs

- for aluminium conductors DIN 48201 and pre-rounded sector shaped conductors
- with barrier, with solid copper palm
- material: Al 99.5; E-copper
- surface: bright

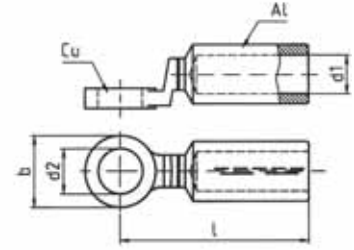

Cross section mm ²		Bolt size Ø	Part No.	Die code	Dimensions mm				Number of crimps		Weight 100 pcs. ~ kg		pcs.
rm/sm	se				d1	d2	b	l	mech.	hydr.	Cu	Total	
16	25	M 8	363R8	12	6.0	8.5	25	67.5	4	2	4.4	5.9	10
	25	M 10	363R10	12	6.0	10.5	25	67.5	4	2	4.2	5.7	10
25	35	M 8	364R8	12	6.8	8.5	25	67.5	4	2	4.4	5.8	10
	35	M 10	364R10	12	6.8	10.5	25	67.5	4	2	4.2	5.6	10
	35	M 12	364R12	12	6.8	13.0	25	67.5	4	2	3.9	5.3	10
35	50	M 8	365R8	14	8.0	8.5	25	76.5	5	2	4.4	6.3	10
	50	M 10	365R10	14	8.0	10.5	25	76.5	5	2	4.2	6.1	10
	50	M 12	365R12	14	8.0	13.0	25	76.5	5	2	3.8	5.8	10
50	70	M 8	366R8	16	9.8	8.5	25	76.5	5	2	4.4	6.4	10
	70	M 10	366R10	16	9.8	10.5	25	76.5	5	2	4.2	6.2	10
	70	M 12	366R12	16	9.8	13.0	25	76.5	5	2	3.9	5.9	10
70	95	M 10	367R10	18	11.2	10.5	25	84.5	6	3	4.2	7.4	10
	95	M 12	367R12	18	11.2	13.0	25	84.5	6	3	3.9	7.1	10
95	120	M 10	368R10	22	13.2	10.5	30	90.5	6	3	7.4	11.4	10
	120	M 12	368R12	22	13.2	13.0	30	90.5	6	3	6.8	10.8	10
	120	M 16	368R16	22	13.2	17.0	30	90.5	6	3	6.4	10.4	10
120	150	M 12	369R12	22	14.7	13.0	30	92.0	6	3	6.8	11.4	5
	150	M 16	369R16	22	14.7	17.0	30	92.0	6	3	6.4	10.8	5
	150	M 20	370R20	25	16.3	21.0	35	107.5	6	3	10.1	16.4	5
150	185	M 12	370R12	25	16.3	13.0	30	104.0	6	3	6.8	13.1	5
	185	M 16	370R16	25	16.3	17.0	30	104.0	6	3	6.4	12.7	5
	185	M 20	370R20	25	16.3	21.0	35	107.5	6	3	10.1	16.4	5
	240	M 10	371R10	28	18.3	10.5	30	105.0	6	3	10.3	18.6	5
	240	M 12	371R12	28	18.3	13.0	30	105.0	6	3	10.1	18.4	5
240	240	M 16	371R16	28	18.3	17.0	30	105.0	6	3	9.3	17.6	5
	240	M 20	371R20	28	18.3	21.0	35	107.5	6	3	10.1	18.4	5
	300	M 10	372R10	32	21.0	10.5	35	118.5	8	3	12.1	22.5	5
	300	M 12	372R12	32	21.0	13.0	35	118.5	8	3	11.8	22.2	5
	300	M 16	372R16	32	21.0	17.0	35	118.5	8	3	11.0	21.4	5
300	300	M 20	372R20	32	21.0	21.0	35	118.5	8	3	10.1	20.5	5
	--	M 12	373R12	34	23.3	13.0	40	123.5	8	3	17.7	33.7	1
	--	M 16	373R16	34	23.3	17.0	40	123.5	8	3	16.9	32.9	1
	--	M 20	373R20	34	23.3	21.0	40	123.5	8	3	16.0	32.0	1

rm = round stranded; sm = sector stranded; se = sector solid

>> Tool: see chart page 3.16



Bi-metallic compression cable lugs

- for aluminium conductors DIN 48201 and pre-rounded sector shaped conductors
- material: Al 99.5; E-copper
- surface: bright

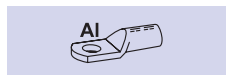
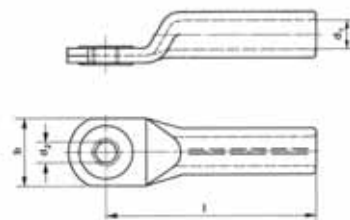

Cross section mm ²		Bolt size Ø	Part No.	Die code	Dimensions mm				Number of crimps		Weight 100 pcs. ~ kg		pcs.
rm/sm	se				d1	d2	b	l	mech.	hydr.	Cu	Total	
10	--	M 6	302R6	10	5.0	6.5	18	52	4	2	0.260	1.20	10
	--	M 8	302R8	10	5.0	8.5	22	52	4	2	0.580	1.50	10
16	25	M 8	303R8	12	5.8	8.5	22	52	4	2	0.600	1.95	10
	25	M 10	303R10	12	5.8	10.5	25	52	4	2	0.600	2.00	10
25	35	M 8	304R8	12	6.8	8.5	22	60	4	2	0.625	2.00	10
	35	M 10	304R10	12	6.8	10.5	25	60	4	2	0.900	2.10	10
35	50	M 10	305R10	14	8.0	10.5	26	67	5	2	0.800	3.00	10
	50	M 12	305R12	14	8.0	13.0	30	67	5	2	1.120	3.10	10
50	70	M 10	306R10	16	9.8	10.5	27	72	5	2	0.900	3.60	10
	70	M 12	306R12	16	9.8	13.0	30	72	5	2	1.120	3.80	10
70	95	M 10	307R10	18	11.2	10.5	29	86	6	3	1.075	5.60	10
	95	M 12	307R12	18	11.2	13.0	32	86	6	3	1.300	5.70	10
95	120	M 10	308R10	22	13.2	10.5	32	90	6	3	1.435	10.00	5
	120	M 12	308R12	22	13.2	13.0	35	90	6	3	1.735	9.50	5
	120	M 16	308R16	22	13.2	17.0	38	90	6	3	2.655	10.00	5
120	150	M 12	309R12	22	14.7	13.0	35	91	6	3	1.810	8.70	5
	150	M 16	309R16	22	14.7	17.0	38	91	6	3	2.230	8.80	5
150	185	M 12	310R12	25	16.3	13.0	35	103	6	3	2.025	12.20	5
	185	M 16	310R16	25	16.3	17.0	41	103	6	3	2.655	12.30	5
	185	M 20	310R20	25	16.3	21.0	44	103	6	3	3.620	12.80	5
185	240	M 12	311R12	28	18.3	13.0	40	106	6	3	2.320	15.00	5
	240	M 16	311R16	28	18.3	17.0	42	106	6	3	4.975	15.50	5
	240	M 20	311R20	28	18.3	21.0	46	106	6	3	4.610	15.50	5
240	300	M 12	312R12	32	21.0	13.0	45	116	8	3	2.750	20.00	5
	300	M 16	312R16	32	21.0	17.0	45	116	8	3	3.400	21.00	5
	300	M 20	312R20	32	21.0	21.0	49	116	8	3	4.600	22.00	5
300	--	M 16	313R16	34	23.3	17.0	51	124	8	3	3.980	21.60	1
	--	M 20	313R20	34	23.3	21.0	51	124	8	3	5.510	22.20	1
400	--	M 16	314R16	38	26.0	17.0	58	165	--	4	4.200	35.00	1
	--	M 20	314R20	38	26.0	21.0	58	165	--	4	5.950	35.00	1

rm = round stranded; sm = sector stranded; se = sector solid

>> Tool: see chart page 3.16



Compression joints Al

- DIN 46267, part 2; for non tension connections of aluminium conductors DIN 48201 and pre-rounded sector shaped conductors
- material: Al 99.5
- surface: bright



Cross section mm ²		Part No.	Die code	Dimensions mm		Number of crimps		Weight/ 100 pcs. ~ kg	pcs.
rm/sm	se			d1	l	mech.	hydr.		
10	--	*222R	10	5.0	55	3/3	--	0.95	10
16	25	*223R	12	5.8	55	3/3	--	1.40	10
25	35	224R	12	6.8	70	4/4	2/2	1.60	10
35	50	225R	14	8.0	85	5/5	2/2	2.60	10
50	70	226R	16	9.8	85	5/5	2/2	3.20	10
70	95	227R	18	11.2	105	6/6	3/3	5.30	10
95	120	228R	22	13.2	105	6/6	3/3	7.60	10
120	150	229R	22	14.7	105	6/6	3/3	7.80	10
150	185	230R	25	16.3	125	6/6	3/3	10.70	10
185	240	231R	28	18.3	125	6/6	3/3	14.30	5
240	300	232R	32	21.0	145	8/8	3/3	20.30	5
300	--	233R	34	23.3	145	8/8	3/3	22.20	1
400	--	234R	38	26.0	210	--	5/5	40.80	1
500	--	235R	44	29.0	210	--	5/5	56.00	1

* Not standardized
 rm = round stranded; sm = sector stranded; se = sector solid

>> Tool: see chart page 3.16



Compression joints Al

- for non tension connections of high voltage aluminium cable 10-30 kV
- material: Al 99.5
- surface: bright



Cross section mm ²		Part No.	Die code	Dimensions mm		Number of crimps		Weight/ 100 pcs. ~ kg	pcs.
rm/sm	se			d1	l	mech.	hydr.		
35	50	405R	14	8.20	90	4/4	2/2	2.7	10
50	70	406R	16	10.00	90	4/4	2/2	3.4	10
70	95	407R	18	11.50	95	4/4	2/2	4.6	10
95	120	408R	22	13.50	100	4/4	2/2	6.8	10
120	150	409R	22	15.00	105	4/4	2/2	7.4	10
150	185	410R	25	16.50	105	4/4	2/2	8.7	10
185	240	411R	28	18.50	125	5/5	2/2	13.4	5
240	300	412R	32	21.30	125	5/5	2/2	15.7	5
300	--	413R	34	23.60	125	5/5	2/2	16.3	1
400	--	414R	38	26.25	150	--	3/3	25.8	1

rm = round stranded; sm = sector stranded; se = sector solid

>> Tool: see chart page 3.16



Compression joints

- with barrier; for non tension connections of high voltage aluminium cable 10-30 kV
- material: Al 99.5
- surface: bright
- leakproof against oil

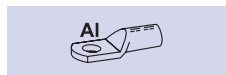
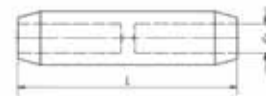

Cross section mm ²		Part No.	Die code	Dimensions mm		Number of crimps		Weight/ 100 pcs. ~ kg	pcs.
rm/sm	se			d1	l	mech.	hydr.		
35	50	415R	14	8.0	95	4/4	2/2	2.2	5
50	70	416R	16	9.8	95	4/4	2/2	5.6	5
70	95	417R	18	11.2	100	4/4	2/2	6.1	5
95	120	418R	22	13.2	105	4/4	2/2	9.2	5
120	150	419R	22	14.7	110	4/4	2/2	10.3	5
150	185	420R	25	16.3	110	4/4	2/2	12.0	5
185	240	421R	28	18.3	130	5/5	2/2	15.6	5
240	300	422R	32	21.0	130	5/5	2/2	19.1	5
300	--	423R	34	23.3	135	5/5	2/2	30.7	1
400	--	424R	38	26.0	165	--	3/3	30.0	1

rm = round stranded; sm = sector stranded; se = sector solid

>> Tool: see chart page 3.16



Reduction compression joints AL

- with barrier; for non tension connections of high voltage aluminium cable 10-30 kV
- material: Al 99.5
- surface: bright
- leakproof against oil

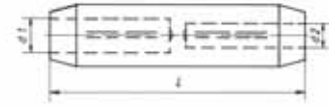

Cross section* mm ²		Part No.	Die code	Dimensions mm			Number of crimps		Weight/ 100 pcs. ~ kg	pcs.
from	to			d1	d2	l	mech.	hydr.		
35	25	425R25	14	8.0	6.8	95	4/4	2/2	2.800	5
50	25	426R25	16	9.8	6.8	95	4/4	2/2	3.630	5
50	35	426R35	16	9.8	8.0	95	4/4	2/2	3.450	5
70	25	427R25	18	11.2	6.8	100	4/4	2/2	4.975	5
70	35	427R35	18	11.2	8.0	100	4/4	2/2	4.790	5
70	50	427R50	18	11.2	9.8	100	4/4	2/2	4.420	5
95	25	428R25	22	13.2	6.8	105	4/4	2/2	8.200	5
95	35	428R35	22	13.2	8.0	105	4/4	2/2	8.000	5
95	50	428R50	22	13.2	9.8	105	4/4	2/2	7.600	5
95	70	428R70	22	13.2	11.2	105	4/4	2/2	7.350	5
120	25	429R25	22	14.7	6.8	110	4/4	2/2	8.000	5
120	35	429R35	22	14.7	8.0	110	4/4	2/2	7.800	5
120	50	429R50	22	14.7	9.8	110	4/4	2/2	7.380	5
120	70	429R70	22	14.7	11.2	110	4/4	2/2	7.100	5
120	95	429R95	22	14.7	13.2	110	4/4	2/2	6.550	5
150	25	430R25	25	16.3	6.8	110	4/4	2/2	10.700	5
150	35	430R35	25	16.3	8.0	110	4/4	2/2	10.500	5
150	50	430R50	25	16.3	9.8	110	4/4	2/2	10.100	5
150	70	430R70	25	16.3	11.2	110	4/4	2/2	9.800	5
150	95	430R95	25	16.3	13.2	110	4/4	2/2	9.500	5
150	120	430R120	25	16.3	14.7	110	4/4	2/2	8.650	5
185	25	431R25	28	18.3	6.8	130	--	2/2	16.120	5
185	35	431R35	28	18.3	8.0	130	--	2/2	15.875	5
185	50	431R50	28	18.3	9.8	130	--	2/2	15.400	5
185	70	431R70	28	18.3	11.2	130	--	2/2	15.050	5
185	95	431R95	28	18.3	13.2	130	--	2/2	14.400	5
185	120	431R120	28	18.3	14.7	130	5/5	2/2	13.700	5
185	150	431R150	28	18.3	16.3	130	5/5	2/2	13.050	5
240	25	432R25	32	21.0	6.8	130	--	2/2	21.200	5
240	35	432R35	32	21.0	8.0	130	--	2/2	20.950	5
240	50	432R50	32	21.0	9.8	130	--	2/2	20.470	5
240	70	432R70	32	21.0	11.2	130	--	2/2	20.120	5
240	95	432R95	32	21.0	13.2	130	--	2/2	19.460	5
240	120	432R120	32	21.0	14.7	130	--	2/2	18.800	5
240	150	432R150	32	21.0	16.3	130	5/5	2/2	18.125	5
240	185	432R185	32	21.0	18.3	130	5/5	2/2	17.275	5
300	150	433R150	34	23.3	16.3	135	5/5	2/2	21.100	1
300	185	433R185	34	23.3	18.3	135	5/5	2/2	20.120	1
300	240	433R240	34	23.3	21.0	135	5/5	2/2	18.730	1
400	185	434R185	38	26.0	18.3	165	--	3/3	34.700	1
400	240	434R240	38	26.0	21.0	165	--	3/3	32.900	1
400	300	434R300	38	26.0	23.3	165	--	3/3	31.200	1

*The nominal cross-sections refer to rm/sm conductors
 rm = round stranded; sm = sector stranded; se = sector solid

>> Tool: see chart page 3.16



Reduction compression joints Al

- for non tension connections of aluminium conductors DIN 48201 and pre-rounded sector shaped conductors
- material: Al 99.5
- surface: bright

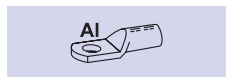

Cross section* mm ²		Part No.	Die code	Dimensions mm			Number of crimps		Weight/ 100 pcs. ~ kg	pcs.
from	to			d1	d2	l	mech.	hydr.		
25	16	284R16	12	7.0	5.8	75	4/4	2/2	1.53	10
35	25	285R25	14	8.2	6.8	90	5/5	2/2	2.50	10
50	25	286R25	16	10.0	6.8	90	5/5	2/2	3.24	10
50	35	286R35	16	10.0	8.0	90	5/5	2/2	3.09	10
70	25	287R25	18	11.5	6.8	110	6/6	3/3	5.50	10
70	35	287R35	18	11.5	8.0	110	6/6	3/3	5.35	10
70	50	287R50	18	11.5	9.8	110	6/6	3/3	4.96	10
95	25	288R25	22	13.5	6.8	110	6/6	3/3	9.10	10
95	35	288R35	22	13.5	8.0	110	6/6	3/3	8.90	10
95	50	288R50	22	13.5	9.8	110	6/6	3/3	8.51	10
95	70	288R70	22	13.5	11.2	110	6/6	3/3	8.15	10
120	25	289R25	22	15.0	6.8	110	6/6	3/3	8.62	10
120	35	289R35	22	15.0	8.0	110	6/6	3/3	8.43	10
120	50	289R50	22	15.0	9.8	110	6/6	3/3	8.04	10
120	70	289R70	22	15.0	11.2	110	6/6	3/3	7.66	10
120	95	289R95	22	15.0	13.2	110	6/6	3/3	7.14	10
150	35	290R35	25	16.5	8.0	130	6/6	3/3	12.59	10
150	50	290R50	25	16.5	9.8	130	6/6	3/3	12.12	10
150	70	290R70	25	16.5	11.2	130	6/6	3/3	11.70	10
150	95	290R95	25	16.5	13.2	130	6/6	3/3	11.05	10
150	120	290R120	25	16.5	14.7	130	6/6	3/3	10.49	10
185	120	291R120	28	18.5	14.7	130	6/6	3/3	13.80	5
185	150	291R150	28	18.5	16.3	130	6/6	3/3	13.19	5
240	95	292R95	32	21.3	13.2	150	--	3/3	22.24	5
240	120	292R120	32	21.3	14.7	150	--	3/3	21.59	5
240	150	292R150	32	21.3	16.3	150	--	3/3	20.87	5

*The nominal cross-sections refer to rm/sm conductors
 rm = round stranded; sm = sector stranded; se = sector solid

>> Tool: see chart page 3.16



Compression joints Al DIN 48085, part 2

- for full tension connections of aluminium conductors DIN 48201, sheet 5
- material: Al 99.5 up to 95 mm²; AlMgSi 1w from 120 mm²
- surface: bright

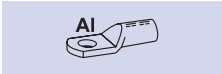

Cross section mm ²	Part No.	Die code	Cond. Ø mm	Dimensions mm			Number of crimps		Weight/100 pcs.	
				d1	d4	l	mech.	hydr.	~ kg	pcs.
16	*243R	12	5.1	5.8	12.0	140	8/8	4/4	3.4	10
25	244R	12	6.3	6.8	12.0	140	8/8	4/4	2.9	10
35	245R	14	7.5	8.0	14.0	140	8/8	4/4	3.9	10
50	246R	16	9.0	10.0	16.0	155	8/8	4/4	5.2	10
70	247R	18	10.5	11.5	18.5	165	8/8	4/4	7.4	10
95	248R	22	12.5	13.5	22.0	165	8/8	4/4	12.2	10
120	249R	25	14.0	15.5	25.5	250	12/12	6/6	21.8	10
150	250R	28	15.7	16.5	28.5	300	--	7/7	34.4	10
185	251R	28	17.5	18.5	28.5	330	--	7/7	33.0	5
240	252R	34	20.2	21.5	34.5	350	--	7/7	54.0	5
300	253R	38	22.5	23.5	38.5	400	--	8/8	79.0	1

* Not standardized

>> Tool: see chart page 3.16



Compression joints

- for full tension connections of Aldrey-conductors according to DIN 48201, sheet 6
- material: AlMgSi F20
- surface: bright

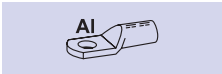

Cross section mm ²	Part No.	Die code	Cond. Ø mm	Dimensions mm			Number of crimps		Weight/100 pcs.	
				d1	d4	l	mech.	hydr.	~ kg	pcs.
25	294AD	12	6.3	6.8	140	8/8	--	3.4	5	
35	295AD	14	7.5	8.0	140	8/8	--	4.7	5	
50	296AD	16	9.0	10.0	155	8/8	--	5.9	5	
70	297AD	18	10.5	11.5	165	8/8	--	9.0	5	
95	298AD	20	12.5	13.5	165	10/10	5/5	10.2	5	

>> Tool: see chart page 3.16



Compression joints

- for non tension connections of Al/St conductors according to DIN 48204
- material: Al 99.5
- surface: bright

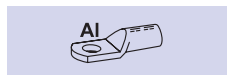
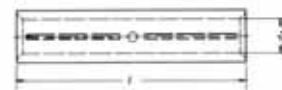

Cross section mm ²	Part No.	Die code	Cond. Ø mm	Dimensions mm		Number of crimps		Weight/ 100 pcs. ~ kg	pcs.
				d1	l	mech.	hydr.		
25 - 4	444R	12	6.8	7.6	70	4/4	2/2	1.65	5
35 - 6	445R	14	8.1	9.0	85	5/5	2/2	2.75	5
50 - 8	446R	16	9.6	10.8	85	5/5	2/2	3.70	5
70 - 12	447R	18	11.7	12.5	105	6/6	3/3	5.20	5
95 - 15	448R	22	13.6	14.8	105	6/6	3/3	8.60	5
120 - 20	449R	25	15.5	16.5	125	6/6	3/3	12.20	5

>> Tool: see chart page 3.17

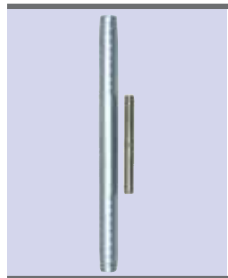

Compression joints DIN 48085, part 3

- for full tension connections of Al/St conductors according to DIN 48204
- material Al-sleeve: Al 99.5
- surface Al-sleeve: bright
- material St-sleeve: St 52
- surface St-sleeve: fire zinc coated

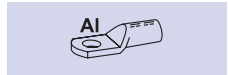
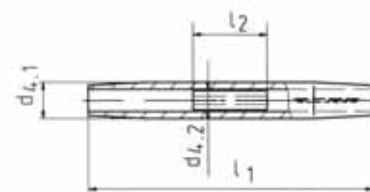

Cross section mm ²	Part No.	Cond. Ø mm	Die code	Aluminium				Steel				Weight/ 100 pcs. ~ kg	pcs.	
				Dimensions mm		Number of crimps		Die code	Dimensions mm		Number of crimps			
				d4.1	l1	mech.	hydr.		d4.2	l2	mech.	hydr.		
25 - 4	454R	6.8	12	12.0	200	7/7	--	6	6.3	65	4/4	--	5	5
35 - 6	455R	8.1	14	14.0	235	8/8	--	6	6.3	75	5/5	--	7	5
50 - 8	456R	9.6	16	16.0	270	9/9	--	7	7.5	95	6/6	--	11	5
70 - 12	457R	11.7	18	18.5	270	9/9	--	9	9.5	95	6/6	--	15	5
95 - 15	458R	13.6	22	22.5	310	11/11	--	9	9.6	95	6/6	--	23	5
120 - 20	459R	15.5	25	25.0	380	13/13	6/6	13	13.0	110	7/7	4/4	36	5

>> Tool: see chart page 3.17



Compression joints Al with copper connecting bolt

- material: Al 99.5; E-Copper
- surface: bright

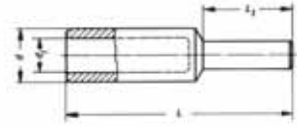

Cross section mm ²		Part No.	Die code	Bolt Ø mm	Cond. Ø mm	Dimensions mm				Weight 100 pcs. ~ kg		pcs.
rm/sm	se					dØ	d1Ø	l1	l	Cu	Total	
25	35	344R	12	6	6.3	12.0	6.8	20	58	0.462	1.6	10
35	50	345R	14	7	7.5	14.0	8.0	22	71	0.695	2.5	10
50	70	346R	16	8	9.0	16.0	10.0	25	74	1.037	3.3	10
70	95	347R	18	10	10.5	18.5	11.5	30	87	1.958	5.4	10
95	120	348R	22	12	12.5	23.0	13.2	33	91	3.112	8.7	10
120	150	349R	22	12	14.0	23.0	15.0	38	97	3.598	9.0	10
150	185	350R	25	12	15.8	25.5	16.5	38	108	3.598	10.9	10
185	240	351R	28	14	17.5	28.5	18.5	44	116	3.692	15.7	5
240	300	352R	32	16	20.3	32.5	21.5	44	128	7.435	21.8	5
300	--	353R	34	18	22.5	34.5	23.5	46	131	9.410	26.7	1

rm = round stranded; sm = sector stranded; se = sector solid

>> Tool: see chart page 3.16



Bi-metallic compression joints

- for non tension connections
- material: Al 99,5; E-Copper
- surface: bright

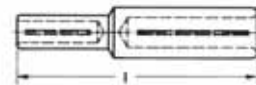

Al	Cross section mm ²		Cu	Part No.	Die code		Dimensions mm			Weight 100 pcs. ~ kg		pcs.
	Al	se			Al	Cu	Al	Cu	l	Cu	Total	
10	16	10	322R10	10	6	5.0	4.5	55.0	0.212	1.100	4	
10	16	16	322R16	10	8	5.0	5.4	61.0	0.714	1.550	4	
16	25	10	323R10	12	6	6.0	4.5	55.0	0.212	1.500	4	
16	25	16	323R16	12	8	6.0	5.4	61.0	0.714	1.750	4	
25	35	10	324R10	12	6	6.8	4.5	55.0	0.212	1.400	4	
25	35	16	324R16	12	8	6.8	5.5	61.0	0.714	1.650	4	
25	35	25	324R25	12	10	6.8	7.0	61.0	0.892	1.900	4	
25	35	35	324R35	12	12	6.8	8.2	61.0	1.624	2.000	4	
25	35	50	324R50	12	14	6.8	10.0	72.0	2.362	3.500	4	
25/4	35 re	16	324R416	12	8	7.6	5.5	61.0	0.714	1.600	4	
25/4	35 re	25	324R425	12	10	7.6	7.0	61.0	0.892	1.850	4	
35	50	16	325R16	14	8	8.0	5.5	71.0	0.714	2.500	4	
35	50	25	325R25	14	10	8.0	7.0	71.0	0.892	2.650	4	
35	50	35	325R35	14	12	8.0	8.2	71.0	1.519	3.300	4	
35	50	50	325R50	14	14	8.0	10.0	77.0	2.362	3.530	4	
35/6	50 re	16	325R616	14	8	9.0	5.5	71.0	0.714	2.450	4	
35/6	50 re	25	325R625	14	10	9.0	7.0	71.0	0.892	2.600	4	
35/6	50 re	35	325R635	14	12	9.0	8.2	71.0	1.624	3.250	4	
50	70	16	326R16	16	8	9.8	5.5	71.5	0.714	2.850	4	
50	70	25	326R25	16	10	9.8	7.0	71.5	0.892	3.200	4	
50	70	35	326R35	16	12	9.8	8.2	71.5	1.624	3.800	4	
50	70	50	326R50	16	14	9.8	10.0	77.5	2.362	4.550	4	
70	95	16	327R16	18	8	11.2	5.5	79.0	0.714	4.100	4	
70	95	25	327R25	18	10	11.2	7.0	79.0	0.892	3.950	4	
70	95	35	327R35	18	12	11.2	8.2	79.0	1.624	4.900	4	
70	95	50	327R50	18	14	11.2	10.0	85.0	2.362	5.700	4	
70	95	70	327R70	18	16	11.2	11.5	86.0	2.921	7.250	4	
70	95	95	327R95	18	18	11.2	13.5	95.0	4.957	9.360	4	
70	95	120	327R120	18	20	11.2	15.5	99.0	5.640	10.540	4	
95	120	16	328R16	22	8	13.2	5.5	79.0	0.714	6.150	4	
95	120	25	328R25	22	10	13.2	7.0	79.0	0.892	6.300	4	
95	120	35	328R35	22	12	13.2	8.2	79.0	1.519	6.800	4	
95	120	50	328R50	22	14	13.2	10.0	85.0	2.362	8.050	4	
95	120	70	328R70	22	16	13.2	11.5	87.0	3.105	8.200	4	
95	120	95	328R95	22	18	13.2	13.5	95.0	4.957	10.350	4	
95	120	120	328R120	22	20	13.2	15.5	95.0	5.640	11.550	4	
120	150	35	329R35	22	12	14.7	8.2	81.0	1.519	7.600	4	
120	150	50	329R50	22	14	14.7	10.0	87.0	2.362	7.900	4	
120	150	70	329R70	22	16	14.7	11.5	89.0	3.105	8.500	4	
120	150	95	329R95	22	18	14.7	13.5	97.0	4.857	11.000	4	
120	150	120	329R120	22	20	14.7	15.5	97.0	5.640	10.280	4	



Bi-metallic compression joints

- for non tension connections
- material: Al 99.5; E-Copper
- surface: bright

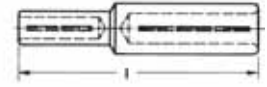

Cross section mm ²			Part No.	Die code		Dimensions mm sleeve inside-Ø			Weight 100 pcs. ~ kg		pcs.
Al	Cu	Part No.		Al	Cu	Al	Cu	l	Cu	Total	
150	185	16	330R16	25	8	16.3	5.4	91.5	0.714	7.800	4
150	185	25	330R25	25	10	16.3	6.8	91.5	0.892	8.000	4
150	185	35	330R35	25	12	16.3	8.2	91.5	1.624	8.400	4
150	185	50	330R50	25	14	16.3	10.0	98.5	2.362	10.200	4
150	185	70	330R70	25	16	16.3	11.5	99.5	3.105	10.350	4
150	185	95	330R95	25	18	16.3	13.5	107.5	4.957	12.650	4
150	185	120	330R120	25	20	16.3	15.5	107.5	5.640	13.900	4
150	185	150	330R150	25	22	16.3	17.0	124.0	8.231	16.700	4
185	240	50	331R50	28	14	18.3	10.0	99.0	2.362	12.100	1
185	240	70	331R70	28	16	18.3	11.5	100.0	3.105	13.000	1
185	240	95	331R95	28	18	18.3	13.5	108.0	4.957	14.450	1
185	240	120	331R120	28	20	18.3	15.5	108.0	5.640	13.720	1
185	240	150	331R150	28	22	18.3	17.0	113.0	8.231	19.550	1
185	240	185	331R185	28	25	18.3	19.0	116.0	9.621	21.000	1
240	300	50	332R50	32	14	21.0	10.0	110.0	2.362	16.500	1
240	300	70	332R70	32	16	21.0	11.5	111.0	3.105	18.000	1
240	300	95	332R95	32	18	21.0	13.5	119.0	4.957	19.000	1
240	300	120	332R120	32	20	21.0	15.5	119.0	5.640	20.500	1
240	300	150	332R150	32	22	21.0	17.0	124.0	8.231	23.300	1
240	300	185	332R185	32	25	21.0	19.0	127.0	9.621	25.500	1
240	300	240	332R240	32	28	21.0	21.5	128.0	12.705	30.100	1
300	--	120	333R120	34	20	23.5	15.5	119.0	5.640	27.800	1
300	--	150	333R150	34	22	23.5	17.0	124.0	8.234	31.100	1
300	--	185	333R185	34	25	23.5	19.0	127.0	9.621	32.700	1
300	--	240	333R240	34	28	23.5	21.5	128.0	12.705	37.500	1
300	--	300	333R300	34	32	23.5	24.5	134.0	16.099	41.700	1

rm = round stranded; sm = sector stranded; se = sector solid

>> Tool: see chart page 3.16

Compression cable lugs and compression joints made of E-Al/Al-Cu,
 • Catalogue pages 3.2 - 3.10, 3.13 - 3.15
 Compression joints for full tension connections of Al-
 conductors according to DIN 48201 sheet 5, 16-95 mm²
 • Catalogue page 3.11



Range: mm ²	Tools	M	M+	H	H+	Crimping profile	Catalogue page
10-70	EK354				•	⬡	10.15
10-185	K18		•			⬡	9.21
	HK6018			•		⬡	10.2
	EK18PLUS				•	⬡	10.16
	PK18			•		⬡	10.30
	THK18			•		⬡	10.43
	HK60UNV + UA18			•		⬡	10.11
	EK60UNV + UA18				•	⬡	10.29
	PK60UNV + UA18				•	⬡	10.41
10-240	K22		•			⬡	9.22
	HK6022			•		⬡	10.3
	EK22PLUS				•	⬡	10.17
	PK22			•		⬡	10.31
	THK22			•		⬡	10.44
	HK60UNV + UA22			•		⬡	10.11
	EK60UNV + UA22				•	⬡	10.29
	PK60UNV + UA22				•	⬡	10.41
	HK12025			•		⬡	10.6
	HK12042			•		⬡	10.7
	HK120U			•		⬡	10.8
	EK12025				•	⬡	10.20
	EK12042				•	⬡	10.21
	EK120UPLUS				•	⬡	10.22
	HK122			•		⬡	10.45
	HK122EL			•		⬡	10.50
	PK12038			•		⬡	10.34
	PK120U			•		⬡	10.35
10-500	HK252			•		⬡	10.46
	HK252EL			•		⬡	10.50
	PK252			•		⬡	10.36
150-500	HK45			•		⬡	10.47
	PK45			•		⬡	10.37

Compression joints for full tension connections of Aldrey-conductors
 according to DIN 48201, part 6 and Al-conductors DIN 48201,
 part 5, 120-300 mm²
 • Catalogue page 3.11



Range: mm ²	Tools	M	M+	H	H+	Crimping profile	Catalogue page
25-50	EK354				•	⬡	10.15
25-95	K18		•			⬡	9.21
	HK6018			•		⬡	10.2
	EK18PLUS				•	⬡	10.16
	PK18			•		⬡	10.30
	THK18			•		⬡	10.43
	HK60UNV + UA18			•		⬡	10.11
	EK60UNV + UA18				•	⬡	10.29
	PK60UNV + UA18				•	⬡	10.41
25-185	K22		•			⬡	9.22
	HK6022			•		⬡	10.3
	EK22PLUS				•	⬡	10.17
	PK22			•		⬡	10.31
	THK22			•		⬡	10.44
	HK60UNV + UA22			•		⬡	10.11
	EK60UNV + UA22				•	⬡	10.29
	PK60UNV + UA22				•	⬡	10.41
	HK12025			•		⬡	10.6
	HK12042			•		⬡	10.7
	HK120U			•		⬡	10.8
	EK12025				•	⬡	10.20
	EK12042				•	⬡	10.21
	EK120UPLUS				•	⬡	10.22
	HK122			•		⬡	10.45
	HK122EL			•		⬡	10.50
	PK12038			•		⬡	10.34
	PK120U			•		⬡	10.35
25-300	HK252			•		⬡	10.46
	HK252EL			•		⬡	10.50
	PK252			•		⬡	10.36
150-300	HK45			•		⬡	10.47
	PK45			•		⬡	10.37

Compression joints for non tension connections of Al/St conductors acc. to DIN 48204
 Compression joints for full tension connections acc. to DIN 48085, part 3 for Al/St conductors acc. to DIN 48204
 • Catalogue page 3.12



Range: mm²	Tools	M	M+	H	H+	Crimping profile	Catalogue page
25/4-120/20	K22		•			⬡	9.22
	HK6022			•		⬡	10.3
	EK22PLUS				•	⬡	10.17
	PK22			•		⬡	10.31
	THK22			•		⬡	10.44
	HK60UNV + UA22			•		⬡	10.11
	EK60UNV + UA22				•	⬡	10.29
	PK60UNV + UA22			•		⬡	10.41
	HK12025			•		⬡	10.6
	HK12042			•		⬡	10.7
	HK120U			•		⬡	10.8
	EK12025				•	⬡	10.20
	EK12042				•	⬡	10.21
	EK120UPLUS				•	⬡	10.22
	HK122			•		⬡	10.45
	HK122EL			•		⬡	10.50
	PK12038			•		⬡	10.34
	PK120U			•		⬡	10.35
	HK252			•		⬡	10.46
	HK252EL			•		⬡	10.50
	PK252			•		⬡	10.36

M mechanical tools, without interchangeable dies

H hydraulic tools, hand-operated

M+ mechanical tools, with interchangeable dies

H+ battery powered and mains operated tools



CABLE JOINTS, CABLE TERMINATIONS, CABLE GLANDS, CABLE CLEATS
 FEEDER PILLARS, FUSE LINKS, ARC FLASH, CABLE ROLLERS, CUT-OUTS

11KV 33KV CABLE JOINTS & CABLE TERMINATIONS
 FURSE EARTHING
www.cablejoints.co.uk

Thorne and Derrick UK
 Tel 0044 191 490 1547 Fax 0044 191 477 5371
 Tel 0044 117 977 4647 Fax 0044 117 9775582