

Operating Instructions



TL3800 3/8" Tie-Lok Hand Tool

This tool is designed for use with Band-It 3/8" wide Stainless Steel Tie-Lok Ties

A) Form a clamp by threading the end of the tie through the buckle, with the tie gap in the buckle facing up. Tighten the band by hand to maintain a minimum clamp tail of 3 inches to ensure the tip of the clamp tail can be inserted into the winding mandrel.

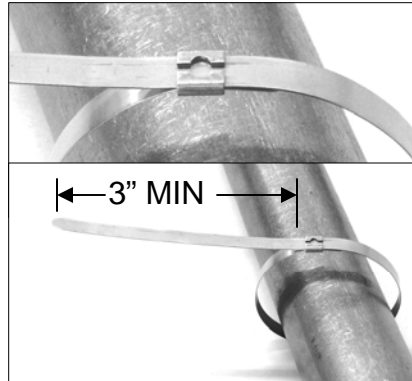

B) Holding the cut-off handle against the bottom of the main handle, insert the tail of the clamp into the head of tool and slide into slot of winding mandrel. Position the ratchet pawl so that it engages fully with the ratchet gear.

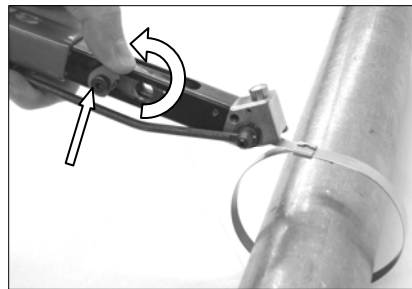

C) Tension the clamp with forward strokes of ratchet handle. When the desired tension is reached or the ratchet gear makes contact with the stop pin, release the ratchet handle. Tension will be maintained by the ratchet pawl.

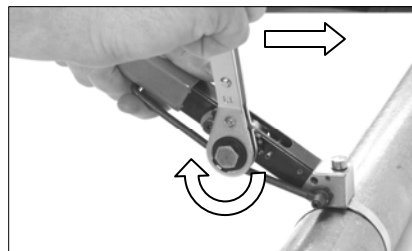

D) Lock the band clamp by holding the tool body in one hand while hitting the punch with a mallet to form a dimple in the center of the buckle. The head of the punch will bottom against the top of the tool head.

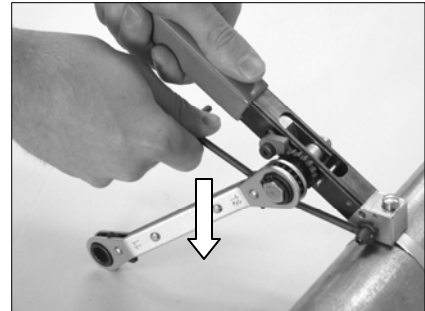

E) After the lock is secured, cut off the excess band tail by firmly pushing the cut-off handle downward.

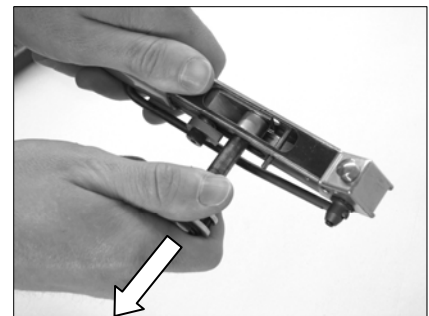

F) Carefully remove the excess band tail by removing the winding mandrel and ratchet from the tool body.



G) Example of finished clamp.



Tool Diagram



TL3800 3/8" Tie-Lok Hand Tool

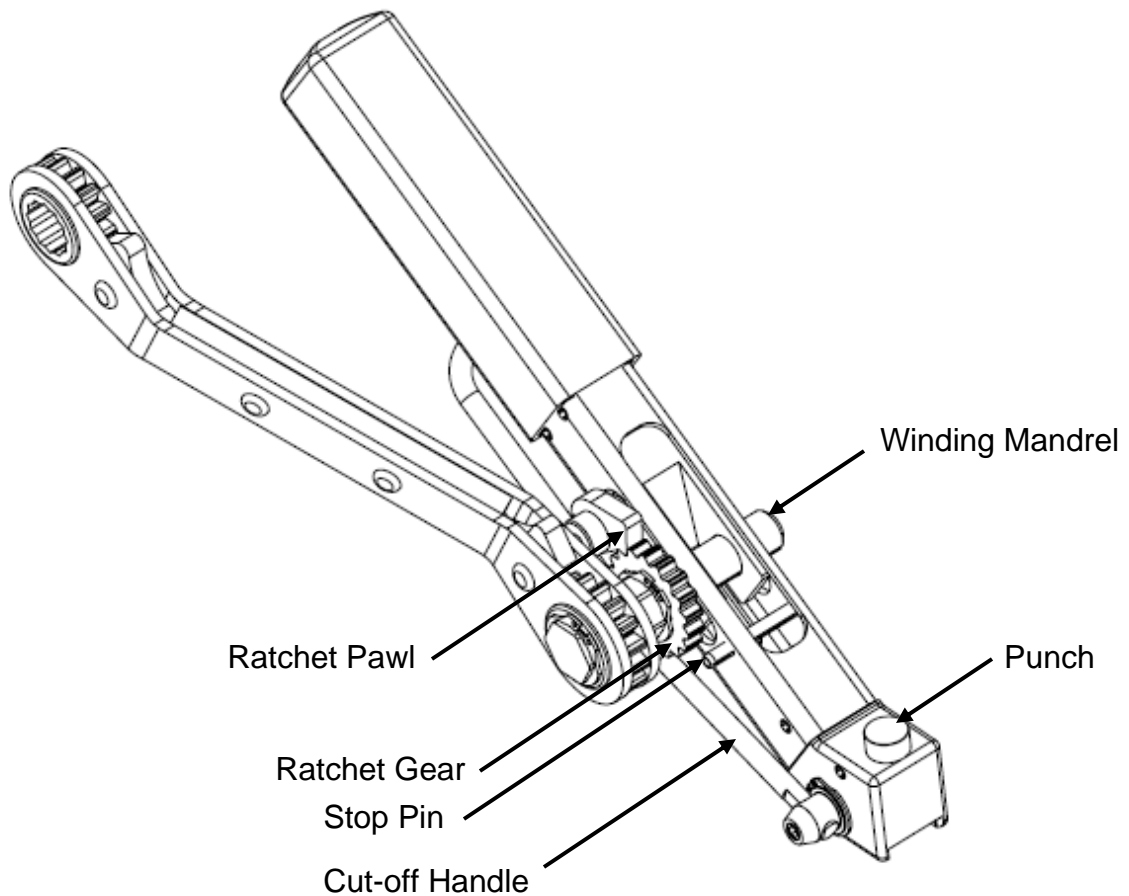

Refer to website for warranty information: <http://www.band-it-idex.com/warranty.html>

BAND-IT-IDEX, Inc.
A Unit of IDEX Corporation
4799 Dahlia Street
Denver, CO 80216-3070 USA
P: 1-800-525-0758 F: 1-800-624-3925



WWW.CABLEJOINTS.CO.UK
THORNE & DERRICK UK
TEL 0044 191 490 1547 FAX 0044 477 5371
TEL 0044 117 977 4647 FAX 0044 977 5582
WWW.THORNEANDDERRICK.CO.UK

Page 2 of 2

Document #P38050 Rev --

© Copyright

BAND-IT-IDEX, Inc. 2008

All rights reserved