

Instructions:

Wrap object with appropriate band and buckle. Place band through tool as shown. Ensure that lever block under the cut-off handle is in locked position. Hold the cut-off handle steady while leveraging the tension handle to desired tension. With tool still in tension, bend band back over the buckle. Place lever block in open position and pull cut-off handle up until band is cut.

Press the band down between the buckle ears and secure band with a hammer or mallet by pounding down buckle ears over remaining band tab to complete the clamp.

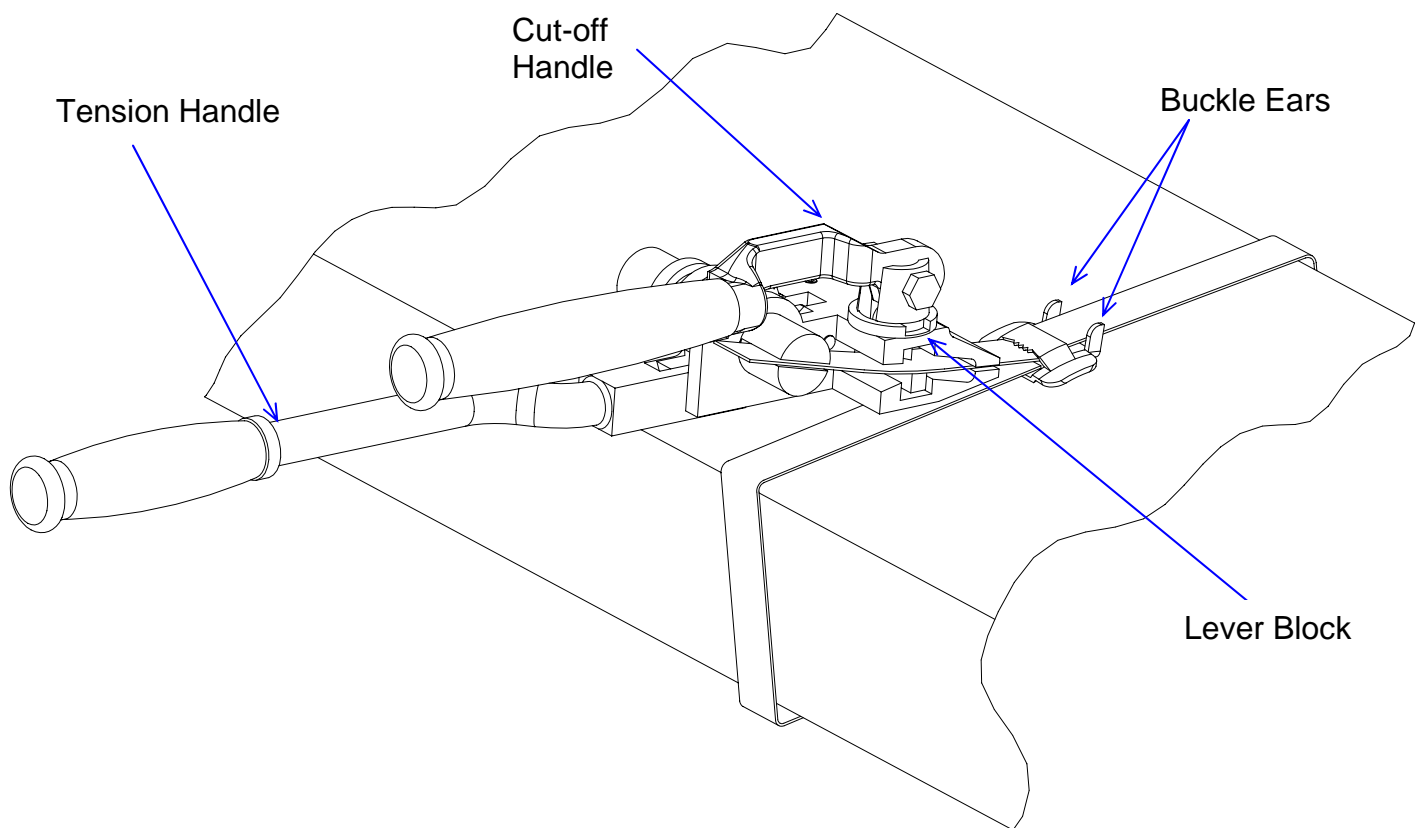

CABLE JOINTS, CABLE TERMINATIONS, CABLE GLANDS, CABLE CLEATS
FEEDER PILLARS, FUSE LINKS, ARC FLASH, CABLE ROLLERS, CUT-OUTS

11KV 33KV CABLE JOINTS & CABLE TERMINATIONS
FURSE EARTHING
www.cablejoints.co.uk
Thorne and Derrick UK

Tel 0044 191 490 1547 Fax 0044 191 477 5371
Tel 0044 117 977 4647 Fax 0044 117 9775582

Assembly and Repair Parts List



C40099 - Ratchet Banding Tool

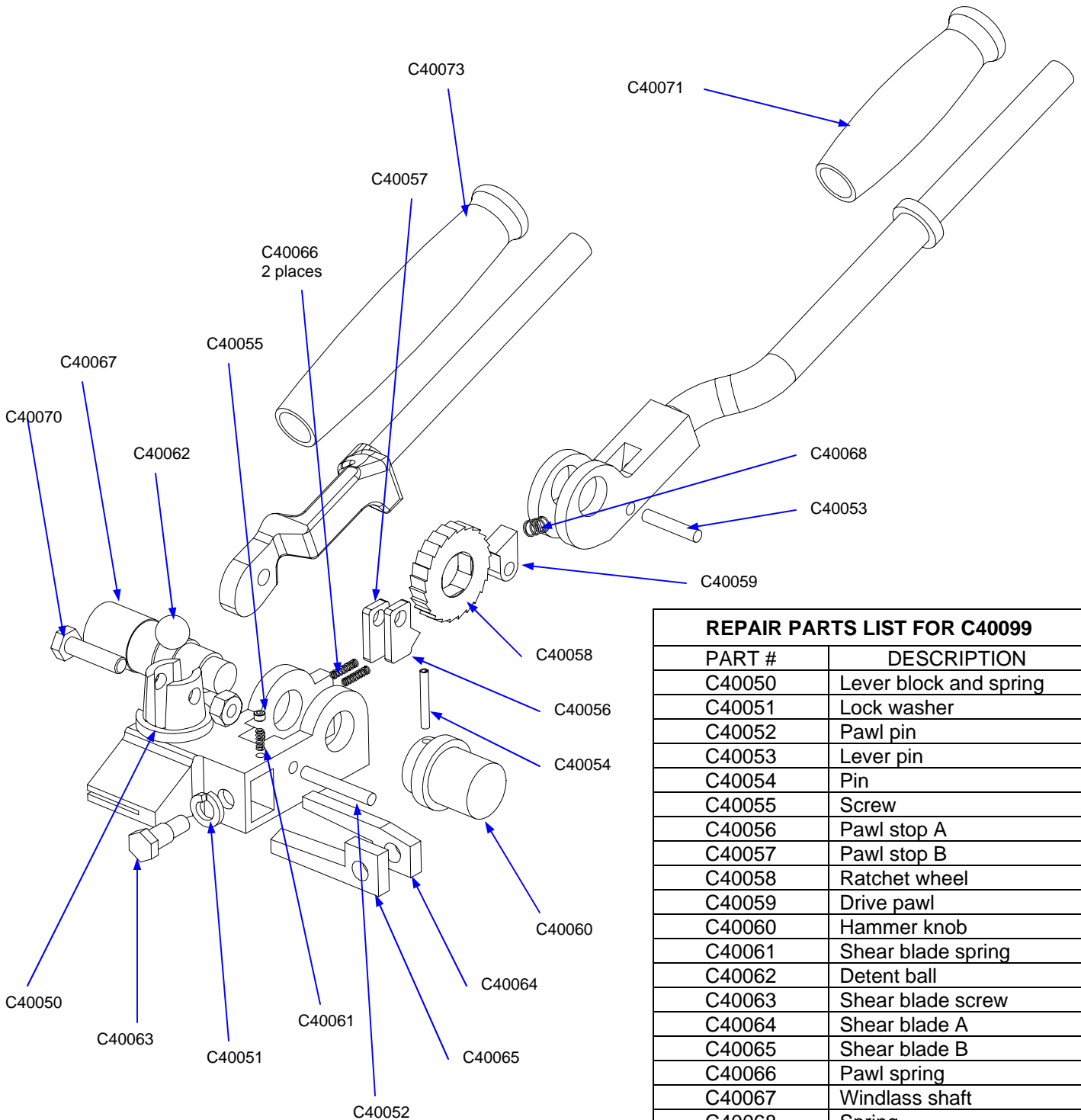

REPAIR PARTS LIST FOR C40099	
PART #	DESCRIPTION
C40050	Lever block and spring
C40051	Lock washer
C40052	Pawl pin
C40053	Lever pin
C40054	Pin
C40055	Screw
C40056	Pawl stop A
C40057	Pawl stop B
C40058	Ratchet wheel
C40059	Drive pawl
C40060	Hammer knob
C40061	Shear blade spring
C40062	Detent ball
C40063	Shear blade screw
C40064	Shear blade A
C40065	Shear blade B
C40066	Pawl spring
C40067	Windlass shaft
C40068	Spring
C40070	Bolt and nut
C40071	Handle grip B
C40073	Handle grip A



CABLE JOINTS, CABLE TERMINATIONS, CABLE GLANDS, CABLE CLEATS
FEEDER PILLARS, FUSE LINKS, ARC FLASH, CABLE ROLLERS, CUT-OUTS

11KV 33KV CABLE JOINTS & CABLE TERMINATIONS
FURSE EARTHING
www.cablejoints.co.uk
Thorne and Derrick UK
Tel 0044 191 490 1547 Fax 0044 191 477 5371
Tel 0044 117 977 4647 Fax 0044 117 9775582